

O'KELLY CHAPEL ROAD  
STATION 83+41 TO 90+00

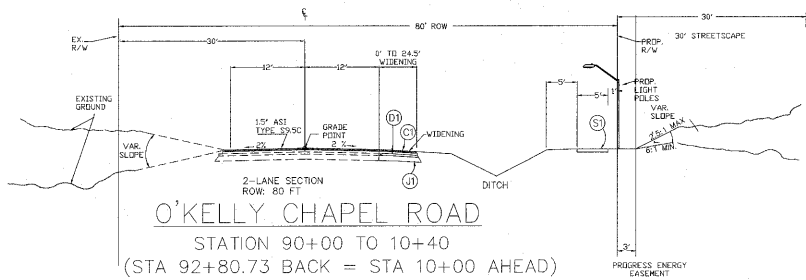

O'KELLY CHAPEL ROAD  
STATION 90+00 TO 10+40  
(STA 92+80.73 BACK = STA 10+00 AHEAD)

PAVEMENT SCHEDULE			
DESCRIPTION	THICKNESS	AVERAGE RATE	MAXIMUM LAYER PLACEMENT
C1 ASPHALT CONCRETE SURFACE COURSE TYPE S9.5C	3"	112 LBS./SQ. YD./1" DEPTH	1.5"
D1 ASPHALT CONCRETE BASE COURSE TYPE B25.0C	4"	114 LBS./SQ. YD./1" DEPTH	4.0"
J1 AGGREGATE BASE COURSE	10"		TWO LIFTS
T EARTH MATERIAL			
S1 5' SIDEWALK	4"		
S2 10' GREENWAY TRAIL	SEE DETAIL		
R1 1'-6" CONCRETE CURB & GUTTER			
R2 2'-6" CONCRETE CURB & GUTTER			
R3 MONOLITHIC ISLAND			
X1 REMOVE 1' 6" CURB AND GUTTER			

MEDIAN NOTE:  
USE NCDOT STANDARD ROADWAY DETAIL 852.01  
"CONCRETE ISLANDS" FOR ALL MONOLITHIC CONCRETE ISLANDS.

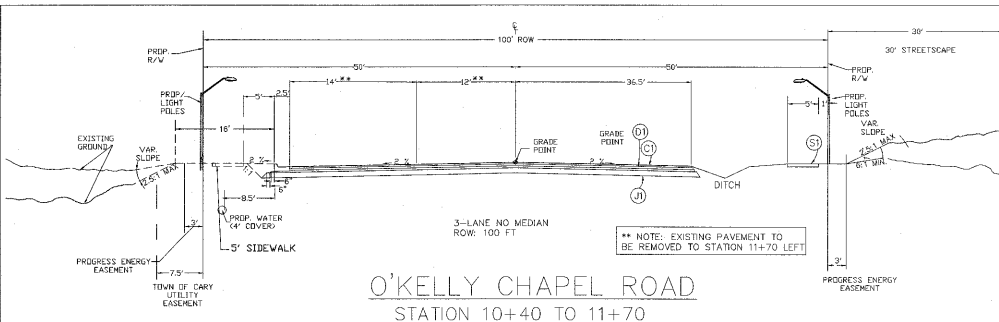

O'KELLY CHAPEL ROAD  
STATION 10+40 TO 11+70

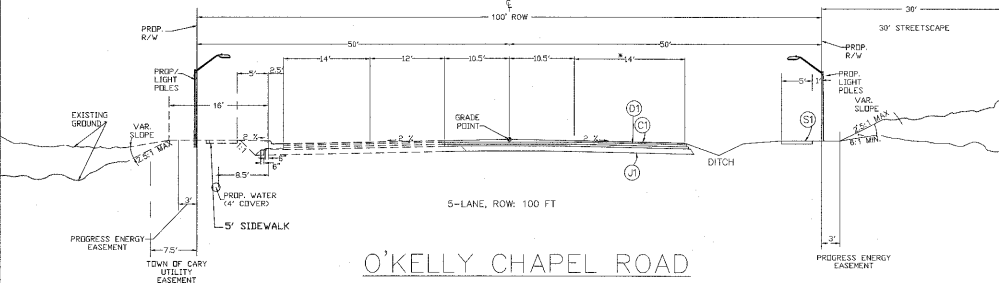

O'KELLY CHAPEL ROAD  
STATION 11+70 TO 13+25

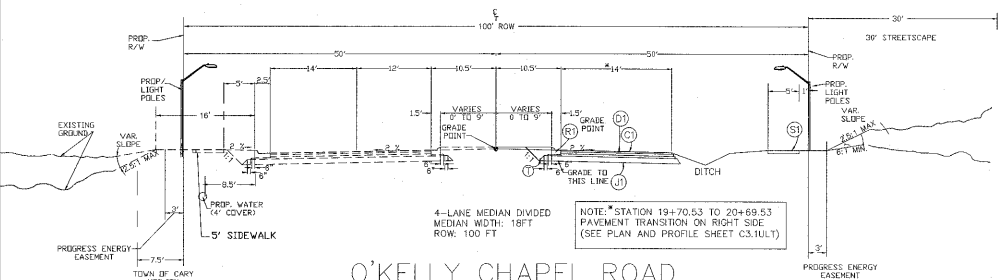

O'KELLY CHAPEL ROAD  
STATION 13+25 TO 20+69.53

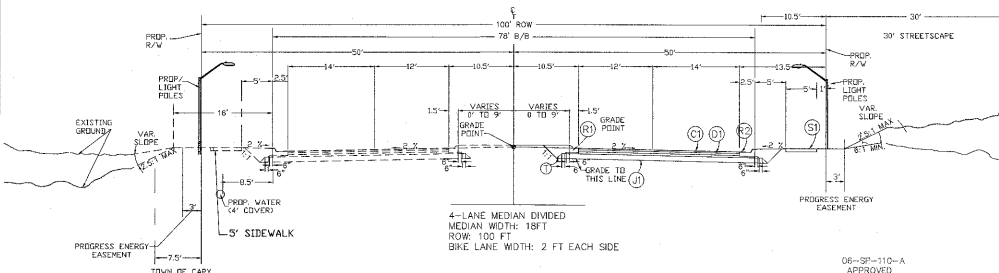

O'KELLY CHAPEL ROAD  
STATION 20+69.53 TO 21+50

Approved by: **DRc** Date: **03-03-09**  
 Planning: **JG6** Date: **03-16-09**  
 Engineering: **S9** Date: **03-26-09**

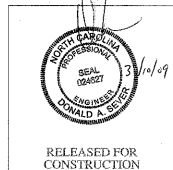

REVISIONS	
1	PHASE 2 REVISED TYPICAL SECTIONS 12/10/2009

PROJECT #: 04-007 DATE: 02/26/09  
 DRAWN BY: MB CHECKED BY: DS  
 TITLE

TYPICAL SECTIONS  
 SHEET  
**C0.3**