

© JERRY TURNER & ASSOCIATES, INC. THIS DOCUMENT IS THE PROPERTY OF JERRY TURNER & ASSOCIATES. ALL RIGHTS ARE RESERVED AND ANY REPRODUCTION, REPRODUCTION, OR OTHER USE OF THIS DOCUMENT WITHOUT THE PRIOR PERMISSION OF JERRY TURNER & ASSOCIATES IS EXPRESSLY PROHIBITED.

**PHASE I SITE 'D' (AS PREVIOUSLY APPROVED)
HENDRICK CHEVROLET**

ZONING	PEC
SITE AREA	4.82 AC
IMPERVIOUS SURFACE AREA	3.10 AC
GROSS BLDG. SQ. FT.	41,710 SF
DISTURBED AREA	4.40 AC
PARKING BREAKDOWN	
EMPLOYEE/CUSTOMER REQUIRED	36
EMPLOYEE/CUSTOMER PROVIDED	36
SERVICE REQUIRED	130
SERVICE PROVIDED	130
VEHICLE DISPLAY PROVIDED	102
HC SPACES REQUIRED	2
HC SPACES PROVIDED	2
TOTAL PROVIDED	268

SITE 'D1'

ZONING	B-2
TOTAL AC	1.2 AC
IMPERVIOUS SURFACE AREA	35,580 SF
VEHICULAR USE AREA	35,580 SF
PROPOSED PARKING SPACES	112

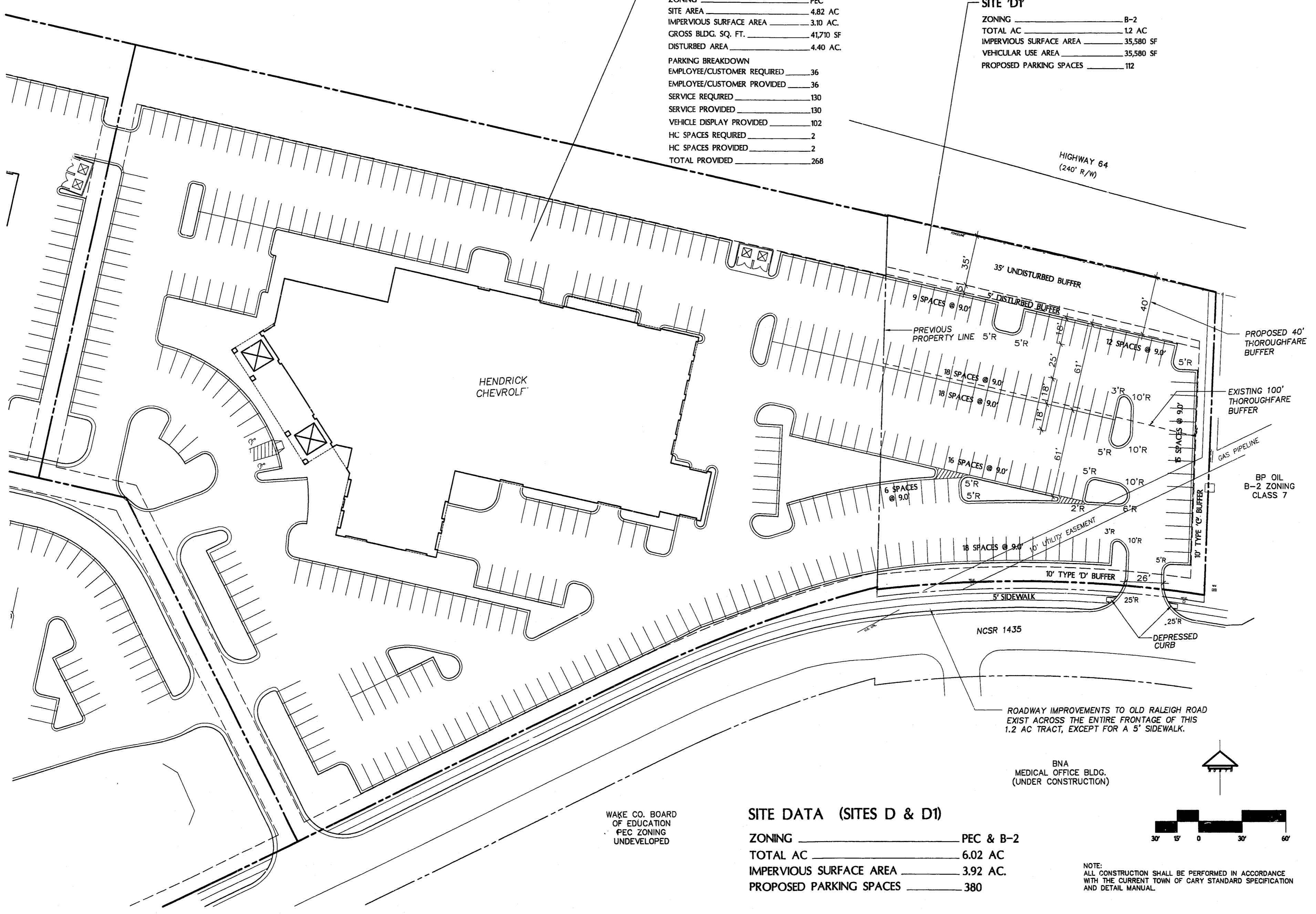

WAKE CO. BOARD
OF EDUCATION
PEC ZONING
UNDEVELOPED

SITE DATA (SITES D & D1)

ZONING	PEC & B-2
TOTAL AC	6.02 AC
IMPERVIOUS SURFACE AREA	3.92 AC
PROPOSED PARKING SPACES	380

NOTE:
ALL CONSTRUCTION SHALL BE PERFORMED IN ACCORDANCE
WITH THE CURRENT TOWN OF CARY STANDARD SPECIFICATION
AND DETAIL MANUAL.



JERRY TURNER & ASSOCIATES

LANDSCAPE ARCHITECTURE
LAND PLANNING
ENVIRONMENTAL DESIGN

905 JONES FRANKLIN ROAD
RALEIGH, NORTH CAROLINA 27606
(919) 851-7150
62 S.E. 6TH AVENUE
DELRAY BEACH, FLORIDA 33483
(407) 276-0453

PROJECT

**CARY AUTOMALL
EXPANSION**

CARY, NORTH CAROLINA

REVISIONS

1/25/95	FIRST REVIEW
2/9/95	2ND REVIEW
2/17/95	ADDTL PARKING

DRAWN CHECKED

TAS ML

SCALE DATE

1"=30' 12/29/94

TITLE

**LAYOUT
PLAN**

FILE NO. JOB NO.

2227.0

SEAL SHEET NO.

