

PLANTING DETAILS
Tree Planting

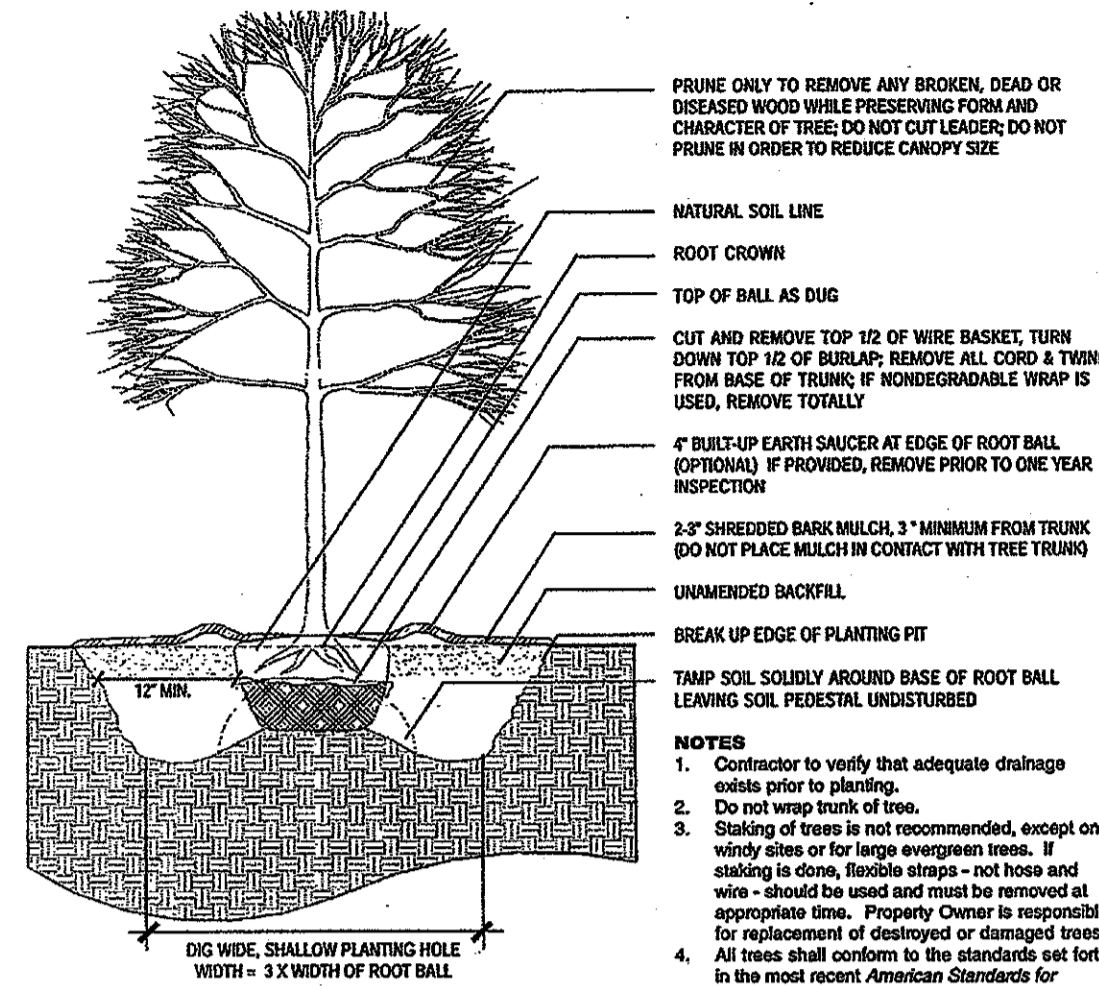

- NOTES**
- Contractor to verify that adequate drainage exists prior to planting.
 - Do not tamp trunk of tree.
 - Staking of trees is not recommended, except on windy sites or for large evergreen trees. If staking is done, flexible straps - not hose and wire - should be used and must be removed at appropriate time. Property Owner is responsible for replacement of damaged or destroyed trees.
 - All trees shall conform to the standards set forth in the most recent American Standards for Nursery Stock published by the American Association of Nurserymen (A.A.N.S.).
 - Trees with root flare covered by more than 1.5" of soil will be rejected prior to installation.
 - A root collar excavation for all trees specified will be done by the Town Arborist to ensure that trees were not planted too deeply at the source (nursery). Landscape contractor shall have supplier mark ground level line above rootball. If Town Arborist determines that there is excessive soil over root crown, these trees will be rejected.

REF: ALL
REVISED:

DETAIL NO:
LA-24

LANDSCAPE
Town of Cary Community Appearance Manual
TREE PLANTING
(FOR SINGLE AND MULTI-STEM TREES)
NOT TO SCALE

PLANTING DETAILS
Shrub, Groundcover, and Perennial Planting

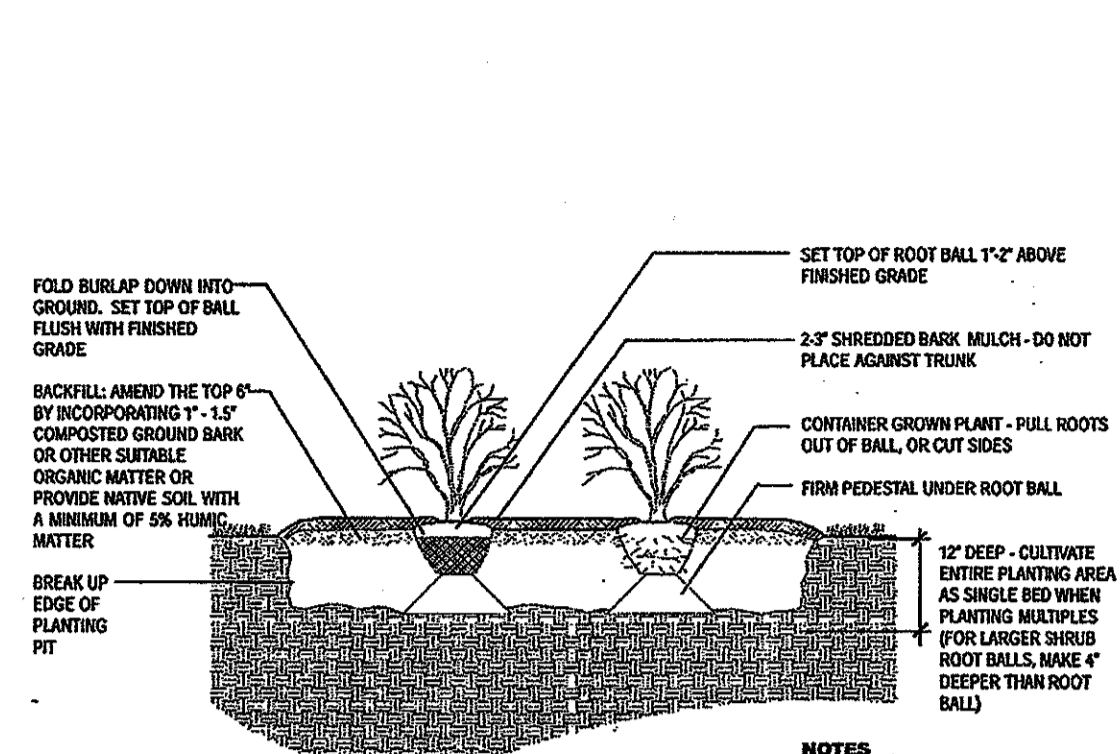

- NOTES**
- All shrubs shall conform to the standards set forth in the most recent American Standards for Nursery Stock published by the American Association of Nurserymen (A.A.N.S.).
 - Soil analysis shall be obtained prior to planting. Soil shall be amended as recommended.
 - Sheet preparation of beds is highly preferred to individual dug holes.

REF: ALL
REVISED:

DETAIL NO:
LA-25

LANDSCAPE
Town of Cary Community Appearance Manual
TYPICAL PLANTING BED DETAIL
NOT TO SCALE

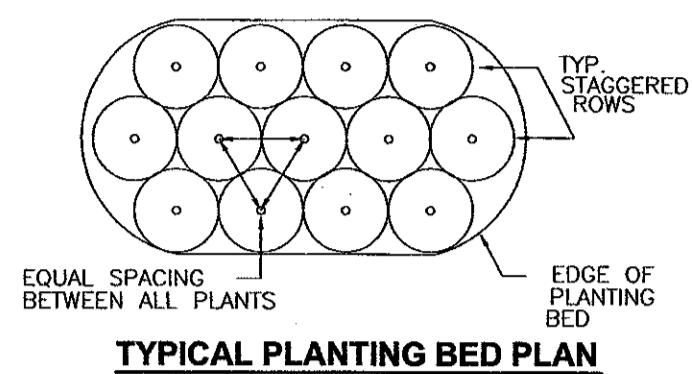
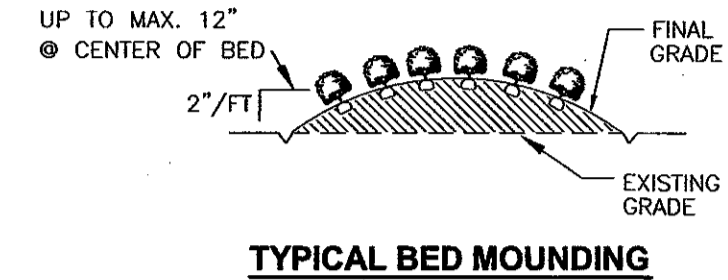

SHRUB PLANTING BED
NOT TO SCALE

- NOTES:**
- 200 SF MIN. TOTAL REQUIRED AREA PER TREE.
 - FOR NEW PLANTING AREAS, REMOVE ALL PAVEMENT, GRAVEL SUB-BASE AND CONSTRUCTION DEBRIS BEFORE PREPARING SOIL AND PLANTING TREES.
 - REMOVE COMPACTED SOIL AND ADD 24" NEW TOPSOIL/PLANTING MIX OR UNCOMPACT AND AMEND TOP 24" OF EXISTING SOIL TO MEET TOPSOIL/PLANTING MIX STANDARDS FOR TREES.

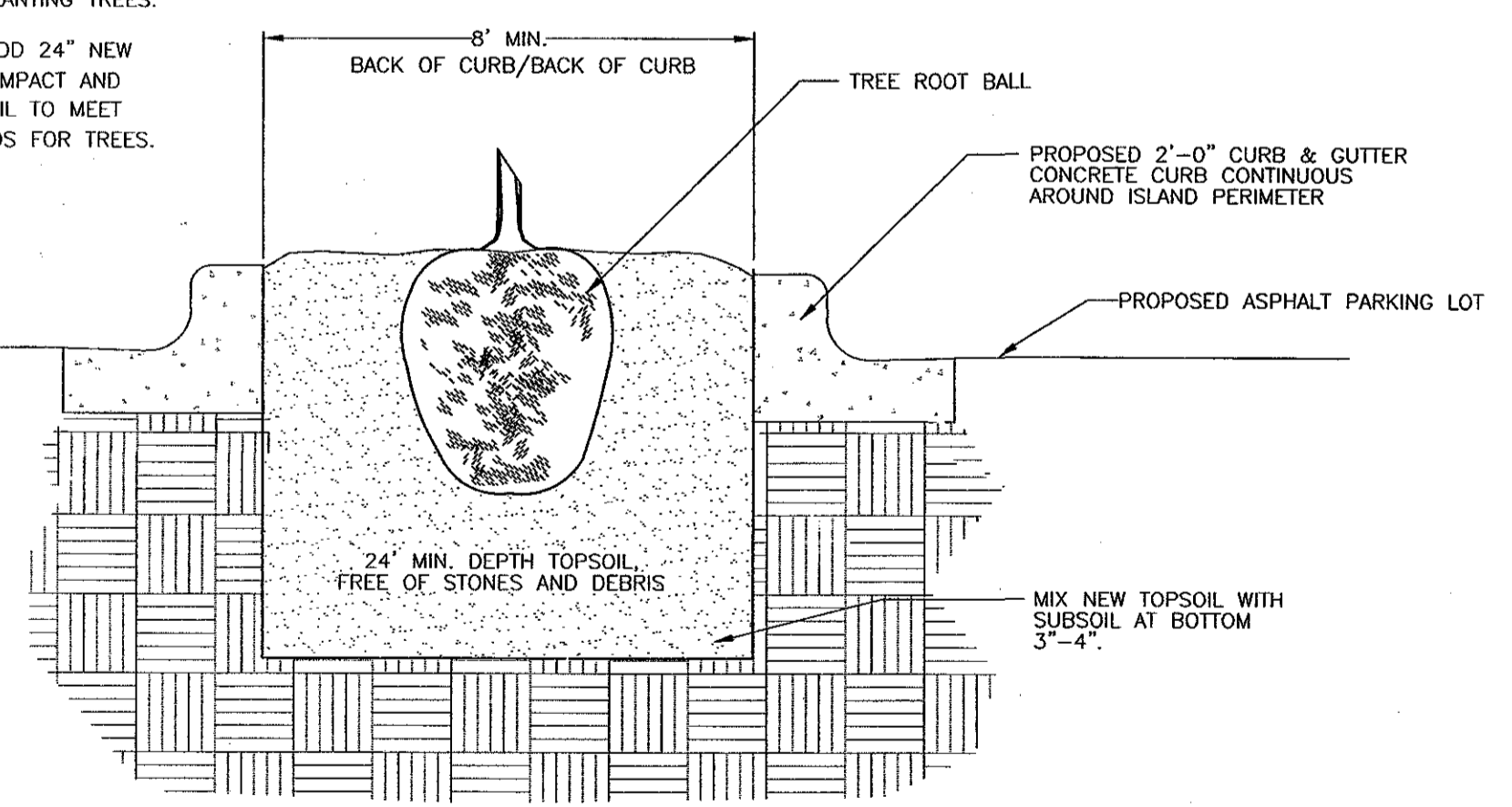

DETAIL FOR TREE PLANTING ISLAND
IN PARKING LOTS
NOT TO SCALE

NOTES:

- INSTALL TOP OF PLANT BALL 2"-3" ABOVE ADJACENT GRADE.
- TAMP PLANTING MIX FIRMLY AS PIT IS FILLED AROUND EACH PLANT BALL.
- SOAK EACH PLANT BALL AND PIT IMMEDIATELY AFTER INSTALLATION.
- SEE PLANS FOR OTHER PLANTING REQUIREMENTS.

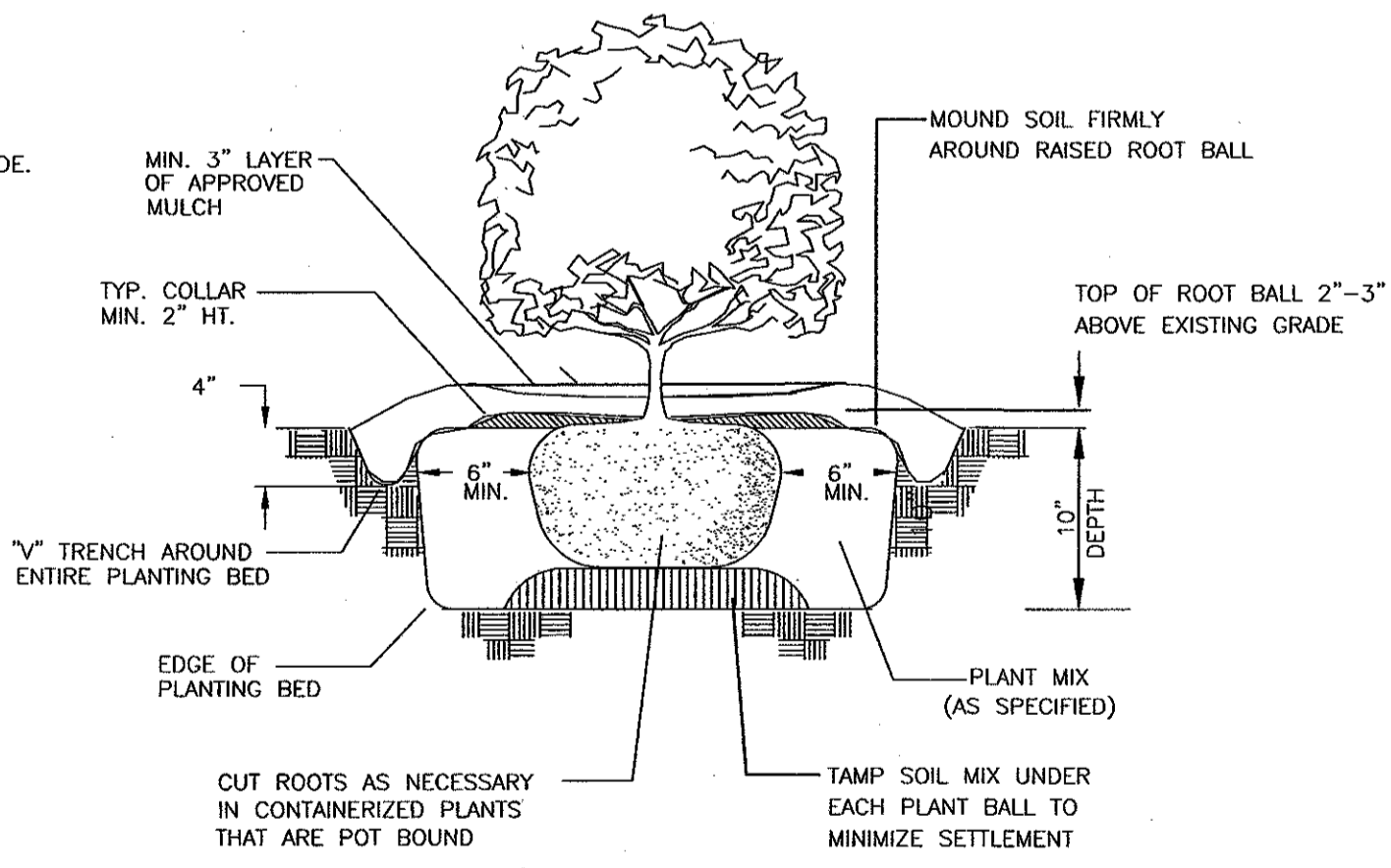

SHRUB PLANTING DETAIL
NOT TO SCALE

07-SP-019
APPROVED
TOWN OF CARY

Approved by: **DRC** Date: **07-20-07**
Planning: **JGB** Date: **08-15-07**
Engineering: **TS** Date: **08-17-07**

1	4-17-07	PER TOWN OF CARY COMMENTS
---	---------	---------------------------

REV.	ISSUED DATE	DESCRIPTION
		KEYPLAN

PROJECT TITLE
DAVIS DRIVE STORAGE
228 DAVIS GROVE CIR
CARY, NC

LANDSCAPE DETAILS

ARCADIS
G&M OF NORTH CAROLINA, INC.
128 SOUTH TRYON STREET, SUITE 1100
CHARLOTTE, NC 28202
704-752-4258 MAIN
704-752-0271 FAX
WWW.ARCADIS-US.COM

SEAL
LEON W. BAKELY
ENGINEER
4-25-07

PROJECT MANAGER S. STONE	DEPARTMENT MANAGER L. BAKELY
LEAD DESIGN PROF. L. BAKELY	CHECKED BY L. BAKELY
TASK/PHASE NUMBER 00001	DRAWN BY C. ATUNCAR
PROJECT NUMBER CNEDF003.0001	DRAWING NUMBER C-11

Acad Version : R16.0s (LMS Tech)
 User Name : catarcar
 Date/Time : Wed, 25 Apr 2007 1:23:37pm
 Path/Name : C:\Users\catarcar\Desktop\Drawings\07_DETAILS.dwg
 Current Plot Style : By Color
 Layout Tab: C-11 LANDSCAPE DETAILS