

NO FILL SLOPES TO BE GREATER THAN 2:1.

PAVEMENT WIDENING NOTE:
PAVEMENT WIDENING (INCLUDING PAVED SHOULDER) SHALL MATCH
EXISTING CROSS SLOPE OF ADJACENT WEST-BOUND LANE.

NOTE:
EDGE OF PAVEMENT ELEVATIONS AND OFF-PAVEMENT TOPO FROM
FIELD SURVEY BY WITHERS AND RAVENEL. ON-PAVEMENT CONTOURS
ADJACENT TO PROPOSED PAVEMENT WIDENING, AND CROSS-SECTIONS
ARE BASED ON INTERPOLATION OF FIELD MEASUREMENTS OF
REPRESENTATIVE PAVEMENT CROSS-SLOPES BY WILLIAM G. DANIEL &
ASSOCIATES.

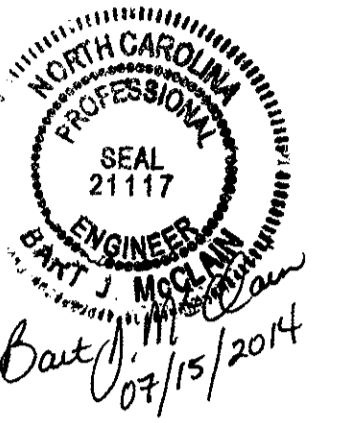
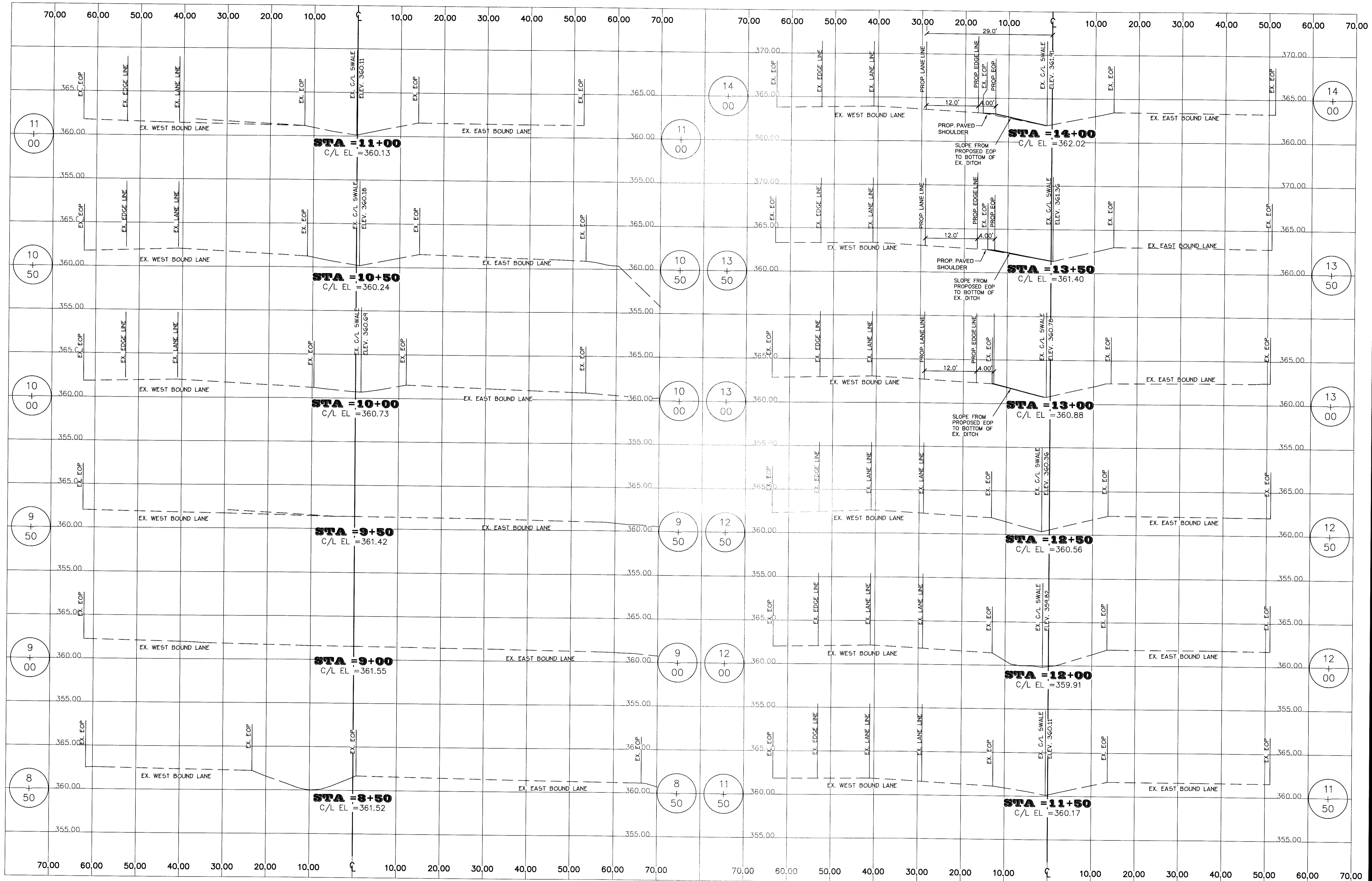

Revisions

05/28/2014 Per ToC first review.

07/15/2014 Per ToC second review.

14-SP-031
HTE #: 14-1455
Approved by the Town of Cary
Development Review Committee

Planner: K.W.L. Date: 8/1/2014

DEVELOPER:
Triad Educational Services
700 Creek Ridge Rd.
Greensboro NC 27406
(336) 505-9665

Project
MacKenan Drive
& Highway 64
Road Improvements

U.S. Highway 64
Cross Sections
Sta. 8+50 - 14+00

Date
May 8, 2014

Scale
Horiz: 1" = 10'
Vert: 1" = 5'

Sheet