

PRELIMINARY PLAT - NOT FOR RECORDATION  
 THIS MAP DOES NOT MEET ALL THE REQUIREMENTS AS SET FORTH IN N.C.G.S. 47-30 AMENDED.

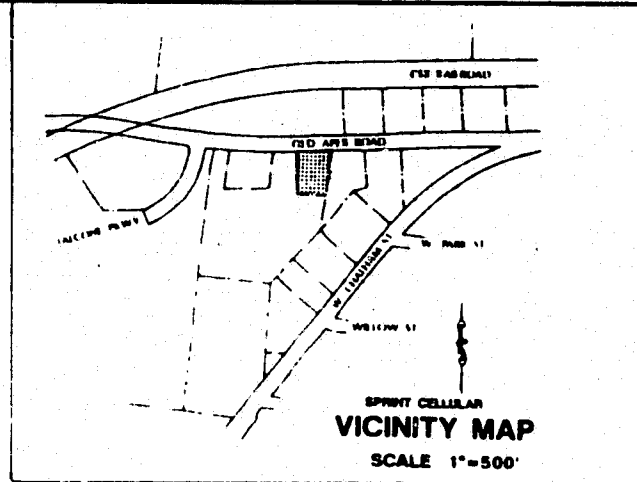
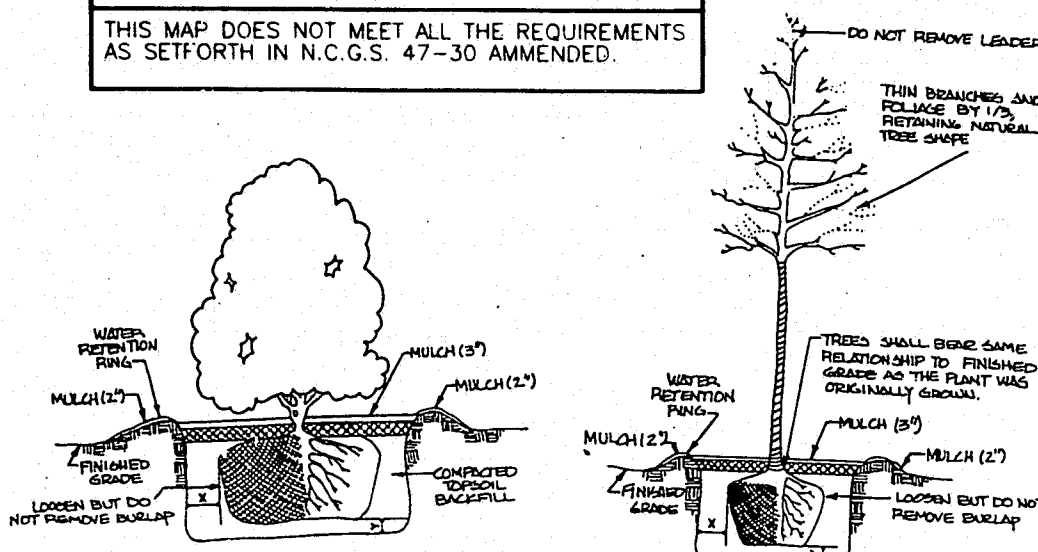

R-30 VACANT  
 N/F OPHELIA MORGAN  
 DB 1031 PG. 63

DEVELOPER REQUESTS THAT ANY REIMBURSEMENTS BE USED AGAINST TRANSPORTATION IMPACT FEES.

LANDSCAPE NOTES:

- NORTH - 15' CLASS 'C' BUFFER  
 SOUTH - 45' CLASS 'A' BUFFER  
 EAST - 15' CLASS 'C' BUFFER  
 WEST - 45' CLASS 'A' BUFFER
- SITE IS WOODED ALONG SOUTHERN PROPERTY LINE AND A PORTION OF THE EASTERN LINE.
- EXISTING TREES TO REMAIN AND SHALL BE USED TO FULFILL BUFFER REQUIREMENTS.
- VIA IS LESS THAN 8,000 SQ. FT., THEREFORE NO INTERIOR LANDSCAPING IS REQUIRED.

CHATHAM STREET SITE  
 CARY, NORTH CAROLINA  
 SEPTEMBER 20, 1993  
 BEGINNING at an iron stake in the southern line of Chatham Street, said iron marking the northwest corner of now or formerly John E. & Sally T. Smith, heirs land, thence from said corner on a bearing of S02°02'31"E for a distance of 106.81' along the western line of John E. & Sally T. Smith, heirs land to an iron stake; thence continuing along the western line of John E. & Sally T. Smith, heirs land and S02°49'58"W, 71.98' to an iron stake, thence along the line of now or formerly Ophelia Morgan land on a bearing of S83°00'47"W for 198.11' to an iron stake, thence along the western line of James H. Morgan N07°01'25"W, 176.25' to an iron stake located in the southern line of Chatham Street, thence along the southern line of Chatham Street N82°55'15"E, 129.55' to the place and POINT OF BEGINNING containing 0.49 acres more or less

N/F EDWARD G. & ELIZABETH G. BATTE  
 DB 3309 PG. 463

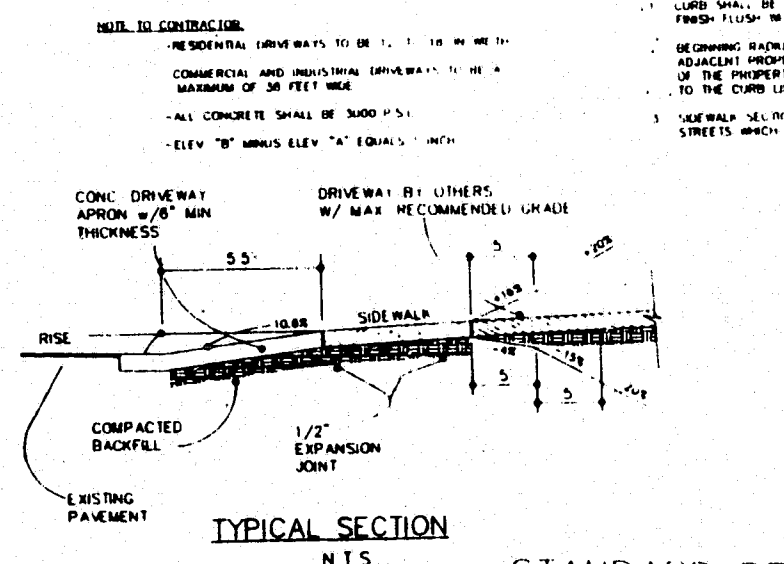
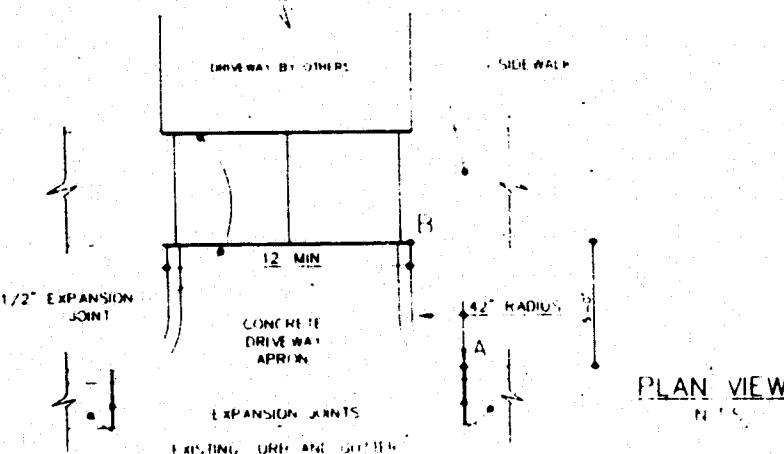
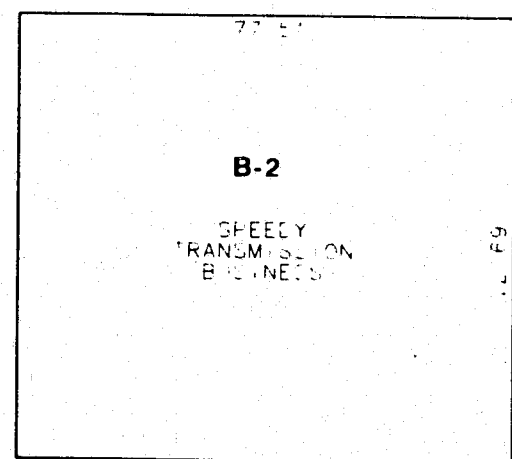

STANDARD DRIVEWAY APRON

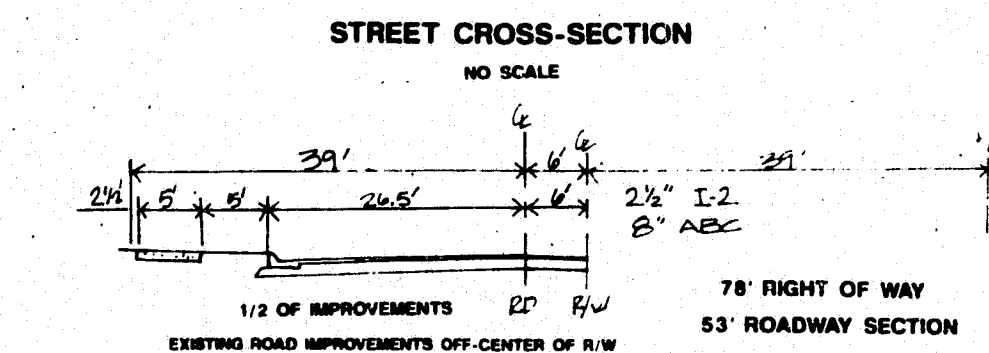

NOTE: BENCHMARK USED CHATHAM' NGVD 29 ELEV 484.3478' LOCATED 300' NORTH OF INTERSECTION OF OLD US 1 AND 64.

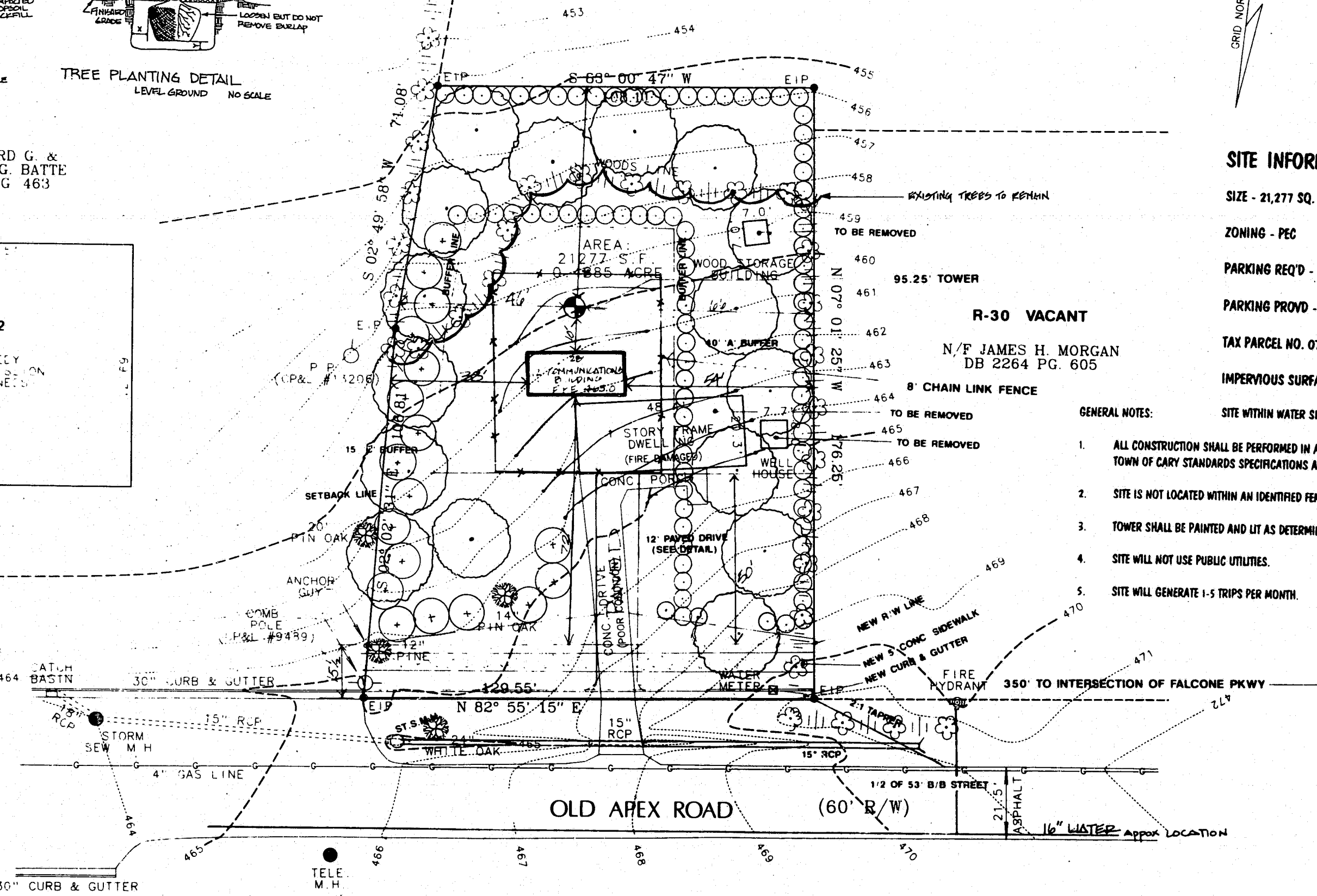
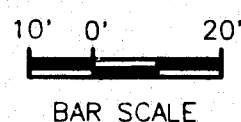

SITE INFORMATION

- SIZE - 21,277 SQ. FT. (0.49 AC)
- ZONING - PEC
- PARKING REQ'D - 0
- PARKING PROVD - 1
- TAX PARCEL NO. 0764.17.22.5057
- IMPERVIOUS SURFACE
- SITE WITHIN WATER SHED PROTECTION AREA

GENERAL NOTES:

- ALL CONSTRUCTION SHALL BE PERFORMED IN ACCORDANCE WITH THE CURRENT TOWN OF CARY STANDARDS SPECIFICATIONS AND DETAILS.
- SITE IS NOT LOCATED WITHIN AN IDENTIFIED FEMA FLOOD HAZARD ZONE.
- TOWER SHALL BE PAINTED AND LIT AS DETERMINED BY THE FCC AND FAA.
- SITE WILL NOT USE PUBLIC UTILITIES.
- SITE WILL GENERATE 1-5 TRIPS PER MONTH.

KEY	QUANTITY	PLANT NAME (LATIN)	PLANT NAME (COMMON)	SIZE	REMARKS
○	87	Myrica Cerifera	Wax Myrtle	3 GAL	5' O.C.
○	18	Juniperus Virginiana	Eastern Red Cedar	10' B&B	10' O.C., STAGGERED
○	16	Acer Rubrum	Red Maple	2 1/2" CAL.	25' O.C.

REFERENCES:  
 D.B. 1136 PG. 435  
 D.B. 1031 PG. 63  
 TAX MAP No. 27  
 PARCEL No. 23

JOSEPH T. JOHNSTON & ASSOCIATES  
 ENGINEERING ▲ SURVEYING ▲ PLANNING  
 5029 FALLS OF NEUSE RD., SUITE 212, RALEIGH, N.C. 27609 (919) 790-8860

TOPOGRAPHIC SURVEY OF:  
 SPRINT CELLULAR  
 CARY SITE

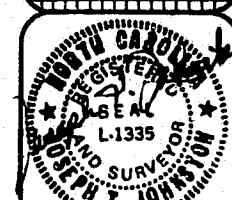
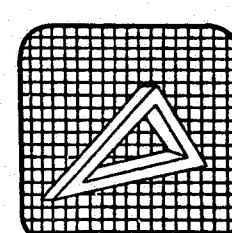
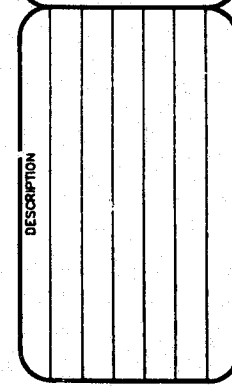

DATE	09/20/93	SCALE	1"=20'
DRAWN BY	W.B.F.	CHECKED BY	J.T.J.
REVISIONS	10-26-93		
PROJECT NUMBER			
SHEET	2 OF 3		

LANDSCAPE PLAN