

POURED IN PLACE CONCRETE RETAINING WALL, SEE DETAIL 1/L-1. PAINT TO MATCH EXISTING WALLS ON-SITE

TREE PROTECTION FENCE

BOW 369.25 (TYP.)

TC 368.75 (TYP.)

EROSION CONTROL FENCE

INSTALL +/- 120 LF 30\"/>

INSTALL 6\"/>

NOTE:
1) THE EXISTING TREES TO REMAIN ARE SATISFYING THE LANDSCAPING REQUIREMENTS IN PARKING AND VEHICULAR USE AREAS; SECTION 14.1.8 SUBSECTION (b) and (c) PER THE TOWN OF CARY.

2) NO KNOWN UTILITIES EXIST IN THE PROPOSED AREAS TO BE DISTURBED.

1 WEST PARKING LOT - ENLARGEMENT PLAN

SCALE 1" = 20'-0"

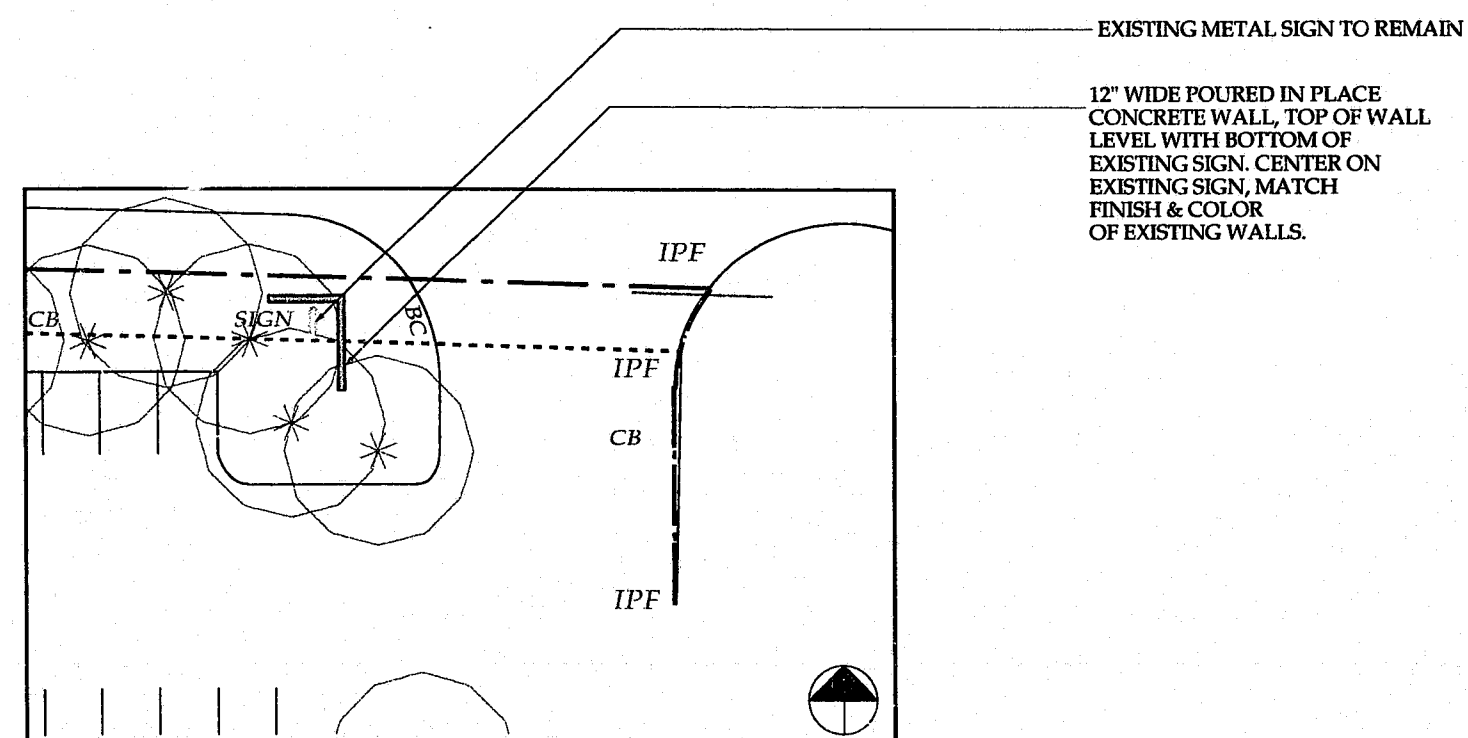

EXISTING METAL SIGN TO REMAIN

12\"/>

2 EAST PARKING LOT CONCRETE WALL- ENLARGEMENT PLAN

SCALE 1" = 20'-0"

NOTES:

1) REPAIR / REPLACE EXISTING IRRIGATION MAINLINE AS REQUIRED. PROVIDE NEW VEHICULAR STRENGTH VALVE BOXES AS REQUIRED FOR EXISTING VALVES.

2) ALL DISTURBED LANDSCAPE AREAS SHALL BE COVERED WITH MIN. 3\"/>

3) TREE PROTECTION FENCING SHALL BE PROVIDED PER DETAIL 2/L-4.

4) SEE SHEET L-1 FOR OVERALL SITE PLAN.

5) ALL CONSTRUCTION SHALL BE IN ACCORDANCE WITH CURRENT TOWN OF CARY STANDARD SPECIFICATIONS AND DETAILS.

6) ALL EXPOSED LAND AREAS SHALL HAVE EROSION CONTROL MEASURES AS MAY BE REQUIRED BY NORTH CAROLINA DEPARTMENT OF NATURAL RESOURCES AND COMMUNITY DEVELOPMENT.

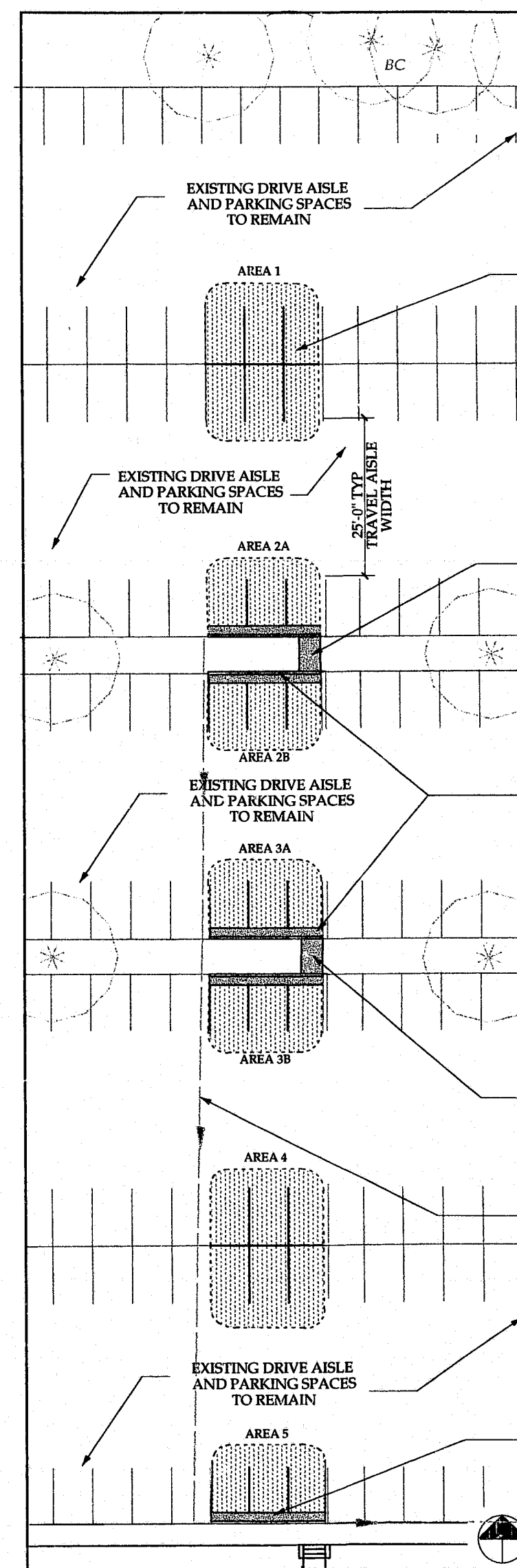

(5) AREAS TO PROVIDE 6\"/>

INSTALL 5\"/>

INSTALL +/- 120 LF 30\"/>

NOTE:
PROVIDE EROSION CONTROL PROTECTION MEASURES AS MAY BE REQUIRED TO PREVENT SEDIMENTATION ONTO PAVED AREAS.

INSTALL 5\"/>

EXISTING 15\"/>

INSTALL +/- 30 LF 30\"/>

3 EAST PARKING LOT - ENLARGEMENT PLAN

SCALE 1" = 20'-0"

Revisions:
1/2/01 - 2nd Submittal

Project:
Regency Park - Additional Parking
Cary, North Carolina

Client:
Grubb Management, Inc.

Date:
November 20, 2000

Scale:
1"=20'-0"

Drawing Title:
LAYOUT AND GRADING ENLARGEMENT PLANS

Sheet No.: