

SITE DATA TABLE		
PROPERTY OWNER	① HASSELBOROUGH CORPORATION	② TOWN OF CARY
PROPERTY ADDRESS	7000 REGENCY PARKWAY CARY, NC 27518	4101 REGENCY PARKWAY CARY, NC 27518
WAKE COUNTY PIN #	0762202260	0762204660
WAKE COUNTY REAL ESTATE ID	0119562	0068804
TOTAL DEEDED ACREAGE OF ALL PROPERTIES	14.77 ACRES	
BASE ZONING DISTRICT	17 - REGENCY PARK PLANNED DEVELOPMENT DISTRICT	
OVERLAY ZONING DISTRICT	SWIFT CREEK WATERSHED PROTECTION OVERLAY DISTRICT - EXISTING URBAN	
LAND AREA TO BE DISTURBED	0.655 ACRES	
AREA OF ADDITIONAL PROP. IMPERVIOUS SURFACES	0.309 ACRES	
AREA OF IMPERVIOUS SURFACES TO BE REMOVED	0.035 ACRES	
LINEAR FOOTAGE OF PROPOSED FIRE LANE	0	
LINEAR FOOTAGE OF PROPOSED WATER LINES	0	
LINEAR FOOTAGE OF PROPOSED SEWER LINES	0	
LINEAR FOOTAGE OF PROPOSED RECLAIMED WATER LINES	0	
NUMBER OF PROPOSED WATER TAPS	0	
NUMBER OF PROPOSED SEWER TAPS	0	
BUFFER ZONE 1 IMPACTS	0.008 ACRES	
BUFFER ZONE 2 IMPACTS	0.026 ACRES	

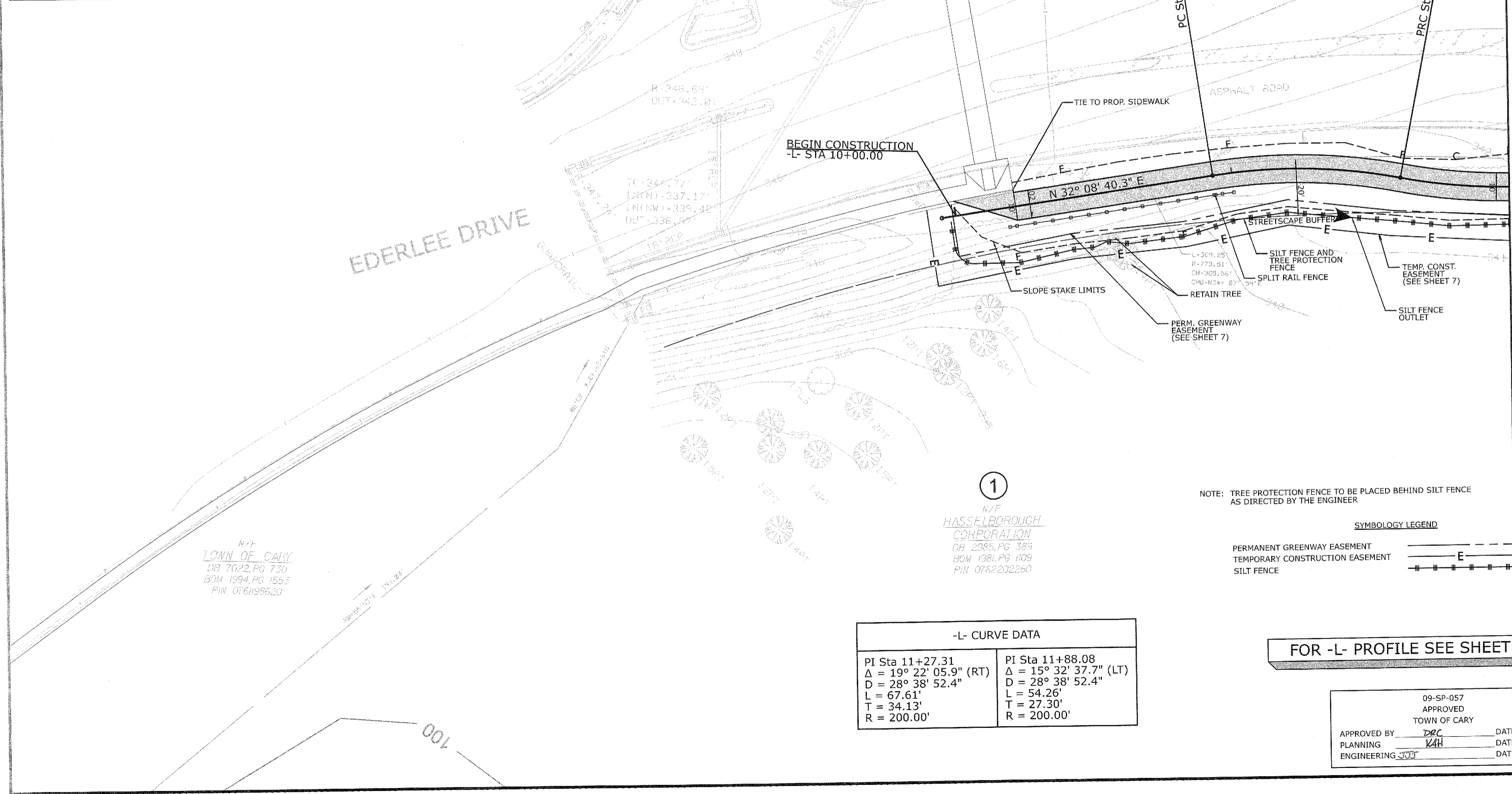

-L- CURVE DATA	
PI Sta 11+27.31	PI Sta 11+88.08
$\Delta = 19^\circ 22' 05.9''$ (RT)	$\Delta = 15^\circ 32' 37.7''$ (LT)
D = 28° 38' 52.4"	D = 28° 38' 52.4"
L = 67.61'	L = 54.26'
T = 34.13'	T = 27.30'
R = 200.00'	R = 200.00'

SYMBOLGY LEGEND

PERMANENT GREENWAY EASEMENT	---
TEMPORARY CONSTRUCTION EASEMENT	-E-
SILT FENCE	--- --- --- --- ---

FOR -L- PROFILE SEE SHEET 8

APPROVED BY: DRC DATE: 8/23/2010
 PLANNING: KAH DATE: 8/23/2010
 ENGINEERING: JOT DATE: 8/23/2010

09-SP-057
 APPROVED
 TOWN OF CARY

MATCHLINE -L- STA. 12+00.00 SEE SHEET 5

TOWN OF CARY
 PARKS, RECREATION, AND CULTURAL RESOURCES
 316 N. ACADEMY STREET, CARY, NC 27512
 919-469-4061, FAX: 919-469-4344
 CONTACT: PAUL KUHN, SENIOR PARKS PLANNER

SWIFT CREEK GREENWAY AND PEDESTRIAN BRIDGE
 CONSTRUCTION DESIGN DOCUMENTS

PLANS PREPARED BY:
 STEWART

SEAL: 35016
 7-1-10

DATE: JULY 1, 2010
 DRAWN BY: JCH
 CHECKED BY: SAB

REVISIONS:

NO.	DATE

PROJECT NO.:
B8011.00

SCALE: 1"=20'

4

DWG. NO.: 4 OF 19