

LANDSCAPE BUFFER CALCULATIONS

TYPE A OPAQUE - BUFFER WIDTH = 35'		
WESTERN SIDE OF COMPOUND = 120'		
TYPE OF VEGETATION	CALCULATION FOR REQUIRED QUANTITY	QTY.
CANOPY TREES	120' / 40' = 3	3
ORNAMENTAL TREES	120' / 20' = 6	6
SHRUBS	120' / 10' = 12	12
NORTHERN SIDE OF COMPOUND = 120'		
TYPE OF VEGETATION	CALCULATION FOR REQUIRED QUANTITY	QTY.
CANOPY TREES	120' / 40' = 3	3
ORNAMENTAL TREES	120' / 20' = 6	6
SHRUBS	120' / 10' = 12	12
EASTERN SIDE OF COMPOUND = 108'		
TYPE OF VEGETATION	CALCULATION FOR REQUIRED QUANTITY	QTY.
CANOPY TREES	108' / 40' = 2.7	3
ORNAMENTAL TREES	108' / 20' = 5.4	6
SHRUBS	108' / 10' = 10.8	11
EASTERN SIDE OF COMPOUND = 120'		
TYPE OF VEGETATION	CALCULATION FOR REQUIRED QUANTITY	QTY.
CANOPY TREES	120' / 40' = 3	3
ORNAMENTAL TREES	120' / 20' = 6	6
SHRUBS	120' / 10' = 12	12

LANDSCAPE NOTES:

1. TOPSOIL TO BE PROVIDED BY SITE CONTRACTOR IN ROUGH GRADE TO WITHIN 1" OF FINISH GRADE.
2. EACH PLANT TO BE FREE FROM DISEASE, INSECT INFESTATION, AND MECHANICAL INJURIES, AND IN ALL RESPECTS BE SUITABLE FOR FIELD PLANTING.
3. ALL PLANTS TO BE FULLY GUARANTEED (LABOR AND MATERIALS) FOR A PERIOD OF NOT LESS THAN ONE (1) YEAR FROM DATE OF INSTALLATION.
4. ALL PLANTS SHALL CONFORM TO THE AMERICAN STANDARD FOR NURSERY STOCK, ANSI Z60.1-1973 IN REGARD TO SIZING, GROWING, AND B&B SPECIFICATIONS.
5. THE CONTRACTOR SHALL PROTECT ALL EXISTING TREES AND SHRUBS WITHIN THE CONSTRUCTION AREA IDENTIFIED AS "TO REMAIN" FROM DAMAGE BY EQUIPMENT AND CONSTRUCTION ACTIVITIES.
6. LANDSCAPING PLAN TO PRESERVE AS MUCH EXISTING VEGETATION AS POSSIBLE AND TO BE SUPPLEMENTED BY 7.2.4 OF THE TOWN OF CARY ORDINANCE.

TOWN OF CARY NOTES:

1. WHERE EXISTING OR PROPOSED VEGETATION FAILS TO FUNCTION ADEQUATELY AS REQUIRED, THE TOWN OF CARY SITE INSPECTOR RESERVES THE RIGHT TO REQUIRE SUPPLEMENTAL PLANTING IN ADDITION TO THOSE SHOWN ON THE LANDSCAPING PLAN BASED ON ACTUAL FIELD CONDITIONS.
2. PRIOR TO THE ISSUANCE OF A CERTIFICATE OF OCCUPANCY, A CERTIFIED STATEMENT SHALL BE PROVIDED TO TOWN STAFF CARY SITE INSPECTOR ATTESTING TO THE FACT THAT THE SOIL AMENDMENT SCHEDULE WAS FOLLOWED AS SPECIFIED IN THE APPROVED SITE AND/OR SUBDIVISION PLAN. THIS STATEMENT SHALL BE CERTIFIED BY A REGISTERED LANDSCAPE ARCHITECT, CERTIFIED ARBORIST, OR OTHER SPECIALIST AS DETERMINED ACCEPTABLE BY THE PLANNING DIRECTOR.
3. UPON ESTABLISHMENT OF FINISHED GRADES AND PRIOR TO BEGINNING INSTALLATION OF ANY TREES, A SOIL AMENDMENT SCHEDULE FOR ALL TREE PLANTING SHALL BE PREPARED BY A CERTIFIED LANDSCAPE ARCHITECT AND BE PROVIDED TO THE TOWN OF CARY PLANNING DEPARTMENT.

LANDSCAPE MAINTENANCE PLAN:

THE OWNERS OF THE PROPERTY AND THEIR AGENTS, HEIRS, OR ASSIGNS SHALL BE RESPONSIBLE FOR THE INSTALLATION, PRESERVATION AND MAINTENANCE OF ALL PLANTING AND PHYSICAL FEATURES SHOWN ON THIS PLAN. THE OWNERS SHALL BE RESPONSIBLE FOR ANNUAL MAINTENANCE OF THE VEGETATION TO INCLUDE BUT NOT BE LIMITED TO:

- PRUNING: THE PRUNING OF SHRUBS SHALL BE LIMITED TO THE PRUNING NECESSARY TO MAINTAIN THE NATURAL SHAPE OF THE PLANT EXCEPT FOR SHEARED HEDGES.
- MULCHING: MULCHING SHALL BE MAINTAINED AT A DEPTH OF 2"-3" WITHIN BUFFERYARD.
- PLANT PROTECTION: AVOID EXCESS INTRUSION INTO THE ROOT ZONE AREA OF ESTABLISHED PLANTINGS.
- WATERING: IF ANY IRRIGATION SYSTEM IS UTILIZED, THE SYSTEM SHALL BE REGULATED TO PROVIDE APPROXIMATELY 1" OF RAINFALL PER WEEK DURING THE GROWING SEASON.

FAILURE TO MAINTAIN ALL PLANTINGS IN ACCORDANCE WITH THIS PLAN MAY CONSTITUTE A VIOLATION OF THE LAND DEVELOPMENT ORDINANCE AND MAY RESULT IN FINES.

TREE SURVEY NOTES:

1. TREE SURVEY NOT REQUIRED. PROPOSED LANDSCAPE AND STREETSCAPE PLANS MEET THE TOWN OF CARY REQUIREMENTS AS DEFINED IN THE LAND DEVELOPMENT ORDINANCE. ALL EXISTING VEGETATION THAT IS TO BE REMOVED WILL BE REPLACED BY VEGETATION MEETING ALL REQUIREMENTS OUTLINED IN THE LDO.
2. THERE ARE NO TREES IN EXCESS OF 30 INCHES WITHIN THE DISTURBED AREA OF THE PROJECT.

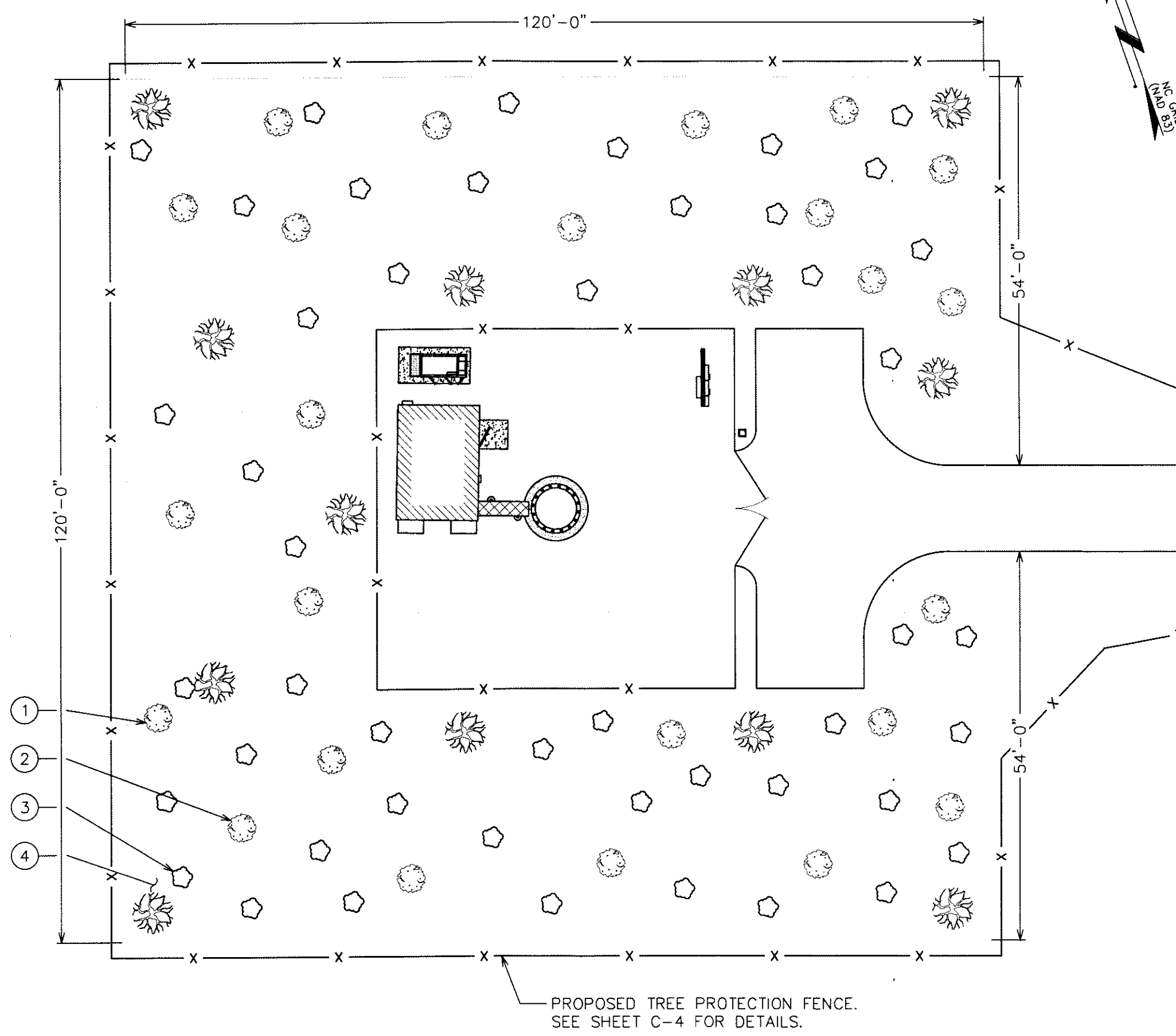

LANDSCAPING PLAN

SCALE: 1/8" = 1'-0"

LANDSCAPE PLANTING SCHEDULE

ITEM	QTY.	BOTANICAL NAME	COMMON NAME	HEIGHT @ PLANTING	HEIGHT @ 3 YRS.	SPREAD/CALIPER	SPACING	REMARKS
EVERGREEN TREE								
1	12	(PINUS PALUSTRIS)	LONGLEAF PINE	8'-0" (MIN)	-	-	25' (MIN)	SHOWN AS [Symbol]
EVERGREEN UNDERSTORY								
2	24	(LLEX X ATTENUATA)	FOSTERS HOLLY	6'-0" (MIN)	-	-	10' (MIN)	SHOWN AS [Symbol]
SHRUBS								
3	47	(MORELLA CERIFERA)	WAX MYRTLE	18" (MIN)	-	-	STAGGERED	SHOWN AS [Symbol]
MULCH								
4	-	-	MULCH	-	-	-	-	APPLY 3"-4" DEEP FROM THE TRUNKLINE TO THE DRIPLINE. FOR GROUND COVER - APPLY 1"-2" DEEP

STREETSCAPE PLANTING SCHEDULE

ITEM	QTY.	BOTANICAL NAME	COMMON NAME	HEIGHT @ PLANTING	HEIGHT @ 3 YRS.	SPREAD/CALIPER	SPACING	REMARKS
EVERGREEN TREE								
1	18	(PINUS PALUSTRIS)	LONGLEAF PINE	8'-0" (MIN)	-	-	25' (MIN)	SHOWN AS [Symbol]
EVERGREEN UNDERSTORY								
2	33	(LLEX X ATTENUATA)	FOSTERS HOLLY	6'-0" (MIN)	-	-	10' (MIN)	SHOWN AS [Symbol]
SHRUBS								
3	66	(MORELLA CERIFERA)	WAX MYRTLE	18" (MIN)	-	-	STAGGERED	SHOWN AS [Symbol]
MULCH								
4	-	-	MULCH	-	-	-	-	APPLY 3"-4" DEEP FROM THE TRUNKLINE TO THE DRIPLINE. FOR GROUND COVER - APPLY 1"-2" DEEP

STREETSCAPE BUFFER CALCULATIONS

NEWLY PLANTED STREETSCAPE		
FRONTAGE = 220' STREETSCAPE WIDTH = 30'		
TYPE OF VEGETATION	CALCULATION FOR REQUIRED QUANTITY	QTY.
CANOPY TREES	220' / 40' = 5.5 6 X 3 = 18	18
ORNAMENTAL TREES	220' / 20' = 11 11 X 3 = 33	33
SHRUBS	220' / 10' = 22 22 X 3 = 66	66

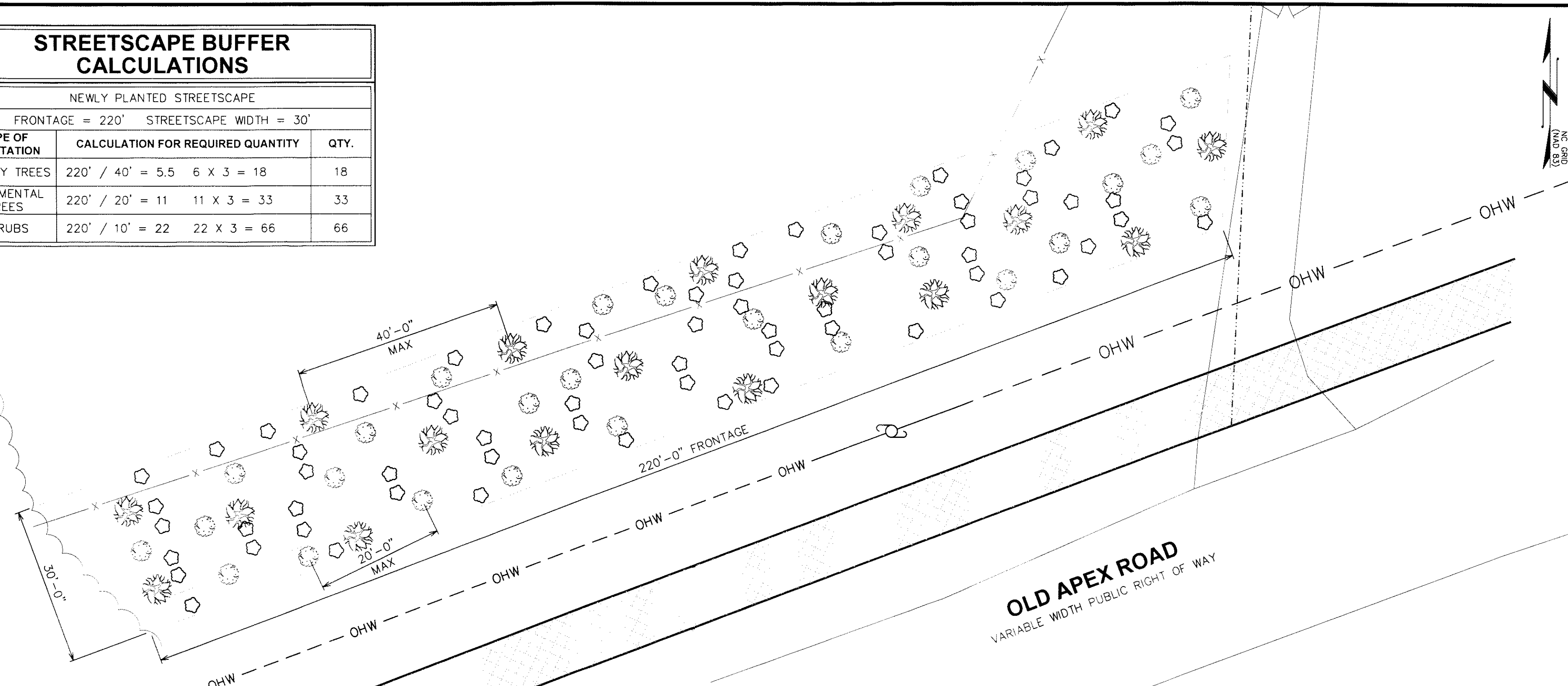

STREETSCAPE PLAN

SCALE: 1/8" = 1'-0"

PLANS PREPARED FOR:

Mastec
Network Solutions

PLANS PREPARED BY:

TOWER ENGINEERING PROFESSIONALS
3703 JUNCTION BOULEVARD
RALEIGH, NC 27605-5663
OFFICE: (919) 661-6351
FAX: (919) 661-6350
N.C. LICENSE # C-1794

SEAL:

REV	DATE	ISSUED FOR:
7	06-16-14	CONSTRUCTION
6	05-20-14	CONSTRUCTION
5	04-07-14	CONSTRUCTION
4	02-26-14	CONSTRUCTION
3	01-22-14	CONSTRUCTION
2	09-25-13	CONSTRUCTION
1		ISSUED FOR:

DRAWN BY: C5N CHECKED BY: KSM

14-SP-027
HTEA-14-1322
APPROVED BY THE TOWN OF CARY
DEVELOPMENT REVIEW COMMITTEE
PLANNER: K. L. L. DATE: 7/1/14

PROJECT INFORMATION:

AT&T #: 368-501

1670 OLD APEX ROAD
APEX, NC 27501
(WAKE COUNTY)

SHEET TITLE:

LANDSCAPE & STREETSCAPE PLAN

SHEET NUMBER: **L-1**

REVISION: **7**

TEP #: 131509