

LEGEND

- Iron pin found
- Iron pin set
- ▲ P.K.Nail found
- △ P.K.Nail set
- ⊙ Traverse point
- ⊕ Planted stone found
- ⊗ Concrete monument set
- ⊙ Concrete monument found
- ⊗ Concrete monument found
- ⊕ Concrete right-of-way monument found
- ⊗ Concrete right-of-way monument set
- ⊕ Iron pin set by found planted stone
- ⊗ Iron pin set (with stones)
- ⊙ N.C.G.S. Monument found
- Utility pole
- R/W--Right-of-way
- Property line
- Fence
- Existing San. Swr.
- Proposed San. Swr.
- Existing Storm Swr.
- Proposed Storm Swr.
- Ovhd. Elec. Pow.Line
- Buried Elec. Pow.Line
- Ovhd Telephone Line
- Buried Telephone Line
- Existing gas main
- Existing water main
- Proposed water main
- Center line

Specifications					
SOIL AND FERTILIZER REQUIREMENTS					
AREA	PLANTING SOIL	FERTILIZER	LIME		
	TOPSOIL	PEAT MOSS	MATURE		
Lawns		8-8-8 @ 30 lbs. per 1000 sq. ft.		40 lbs. per 1000 sq. ft.	
Plant Pits	(3) parts	(1) part	(1) part	8-8-8 @ 1.5 lbs. per cu. yd.	
Tree Pits				40 lbs. per 1000 sq. ft.	
GRASSING TYPES AND SEEDING REQUIREMENTS					
COMMON NAME	PROPORTION (WT.)	MINIMUM PURITY	MINIMUM CLEM.	RATE OF SOWING	RECOMMENDED SEASON
Kentucky 31 Fescue	70%	98%	80%	8 lbs. per 1000 sq. ft.	Sept. 1 - Oct. 30 or April 15 - July 1
Periwinkle Fescue	30%	98%	80%		
Alta Fescue (for overseeding only)	100%	98%	80%	1 lbs. over seeding/1000 sq. ft.	Sept. 1 - Oct. 30 or April 15 - July 1

PLANTING PLAN

SCALE 1" = 30'

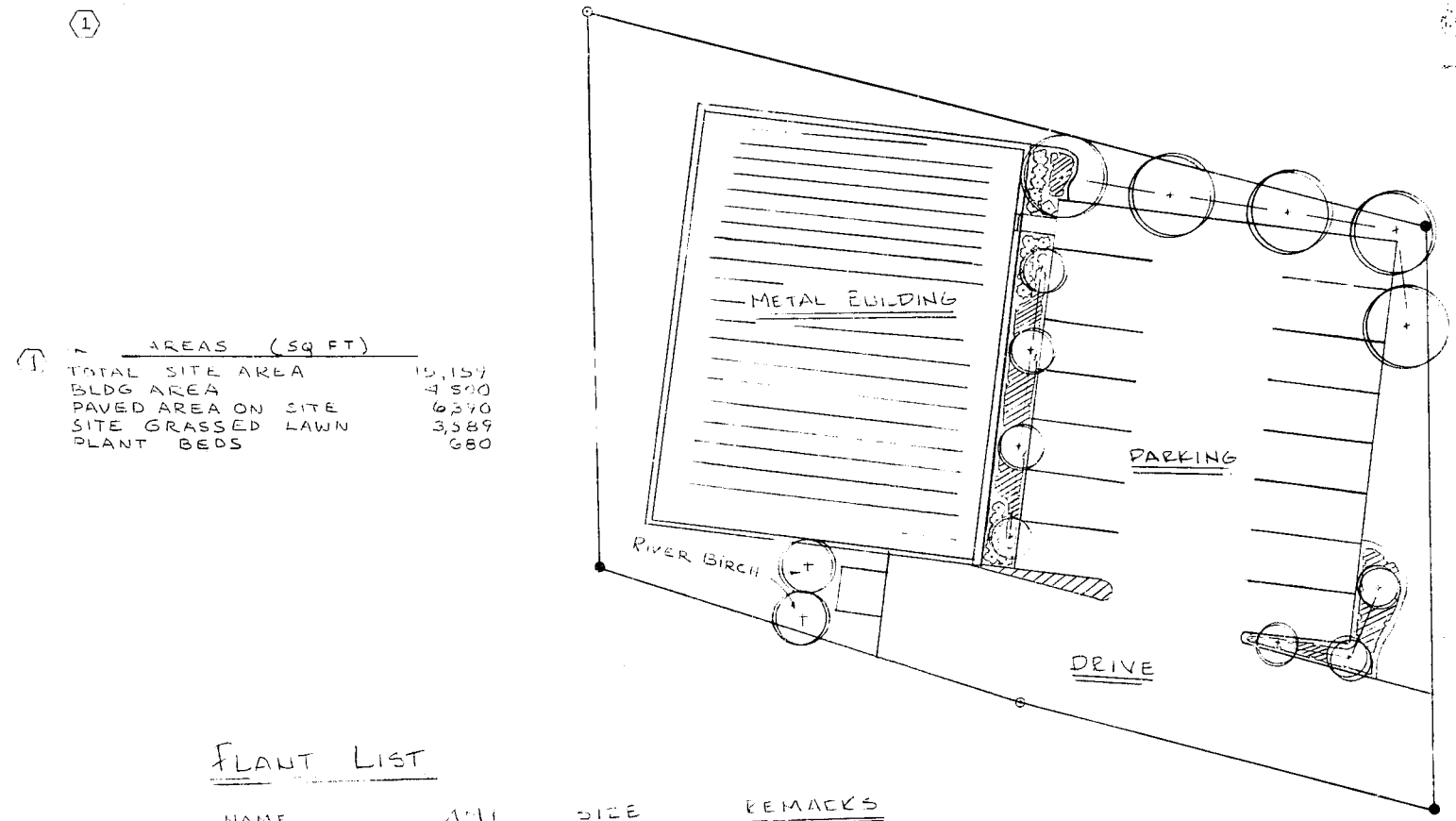

AREAS (SQ. FT.)	
TOTAL SITE AREA	15,157
BLDG AREA	4,800
PAVED AREA ON SITE	6,270
SITE GRASSED LAWN	3,389
PLANT BEDS	680

General Landscaping Notes

- KEY LETTERS REFER TO PLANT LIST. WHERE KEY LETTERS ARE CONNECTED TO A SINGLE PLANT, THE QUANTITY IS ONE.
- GROUP PLANTINGS HAVE KEY LETTERS FOLLOWED BY THE QUANTITY OF THAT PLANT IN THAT PARTICULAR AREA OR GROUP.
- QUANTITIES SHOWN FOR GROUND COVER PLANTING OR MASS PLANTING AREAS ARE FOR REFERENCE ONLY. EXACT QUANTITY TAKE-OFF IS THE RESPONSIBILITY OF THIS CONTRACTOR.
- LOCATIONS FOR PROPOSED PLANT BEDS AND TREES CAN BE ESTABLISHED BY USING SCALED DIMENSIONS TAKEN FROM PLANTING PLAN. USE WALKS, DRIVES, BUILDINGS, ETC. AS REFERENCES.
- ALL PLANTS SHALL BE COMPACT, UNIFORM, AND WELL GROWN. PLANTS SHALL NOT BE LOOSE, OPEN PLANTS.
- ALL AREAS DISTURBED BY GRADING OPERATIONS AND UTILITY LINE PLACEMENT SHALL BE GRASSED.
- ALL PLANTING BEDS SHALL RECEIVE A MINIMUM OF 2" APPROVED MULCH.
- EXISTING AND PROPOSED TREES SHALL BE TRIMMED AS INSTRUCTED BY LANDSCAPE ARCHITECT, AND AS DETAILED.
- ALL PLANTS SHALL MEET OR EXCEED THE MINIMUM STANDARDS SET FORTH IN THE AMERICAN STANDARD FOR NURSERY STOCK BY THE AMERICAN ASSOCIATION OF NURSERMEN, INC., WASHINGTON, DC.

PLANT LIST

SYMBOL	NAME	HT	SIZE	REMARKS
⊕	RIVER BIRCH	5	2' 14" HT	ALLTI-STEM
⊙	DEEPE MYRTLE	7	3-4' HT	"CAROLINA BEAUTY"
⊗	DWARF BURROCK HOLEY	8	15-18" HT	WELL SHAPED
⊕	PAC HABEBO HAWPEE	52	15-17" SP.	GROUND COVER
⊗	KYEESON EYING		20 SECTIONS	"BLACK DIAMOND"

NOTE: ALL PLANT BEDS TO BE MULCHED WITH 100% FINE BARK MULCH

CLERO LANDSCAPING & DESIGN
 400 FOREST ROAD
 OXFORD N.C. 27505
 PHONE # 693-3959

REVISED SEPT 6, 1986

SHEET 3 of 3

I, John Lee Hamme, County North Carolina land surveyor, personally appeared before me this day and acknowledged the execution of the foregoing instrument. Witness my hand and official stamp or seal this day of _____, 19____.

Notary Public

I, a Notary Public of the County and State aforesaid certify that John Lee Hamme, a registered

land surveyor, personally appeared before me this day and acknowledged the execution of the foregoing instrument. Witness my hand and official stamp or seal this day of _____, 19____.

Notary Public

My commission expires _____

JOHN L. HAMME
 CIVIL ENGINEER & LAND SURVEYOR
 151 BELLE ST.
 HENDERSON, N.C. 27536

Prepared by CLERO LANDSCAPING & DESIGN
 Date AUG 20, 1986
 Scale 1" = 30'

LANDSCAPE PLAN
 "ACTION GRAPHICS"
 CITY OF CARY
 WAKE COUNTY, N.C.

FILE D-1-116-B