

- SEEDBED PREPARATION**
1. CHISEL COMPACTED AREAS AND SPREAD TOPSOIL 3 INCHES DEEP OVER ADVERSE SOIL CONDITIONS, IF AVAILABLE.
 2. RIP THE ENTIRE AREA TO 6 INCHES DEPTH.
 3. REMOVE ALL LOOSE ROCK, ROOTS, AND OTHER OBSTRUCTIONS LEAVING SURFACE REASONABLY SMOOTH AND UNIFORM.
 4. APPLY AGRICULTURAL LIME, FERTILIZER, AND SUPERPHOSPHATE UNIFORMLY AND MIX WITH SOIL (SEE BELOW).
 5. CONTINUE TILAGE UNTIL A WELL-PULVERIZED, FIRM, REASONABLE UNIFORM SEEDBED IS PREPARED 4 TO 6 INCHES DEEP.
 6. SEED ON A FRESHLY PREPARED SEEDBED AND COVER SEED LIGHTLY WITH SEEDING EQUIPMENT OR CULTIPACK AFTER SEEDING.
 7. MULCH IMMEDIATELY AFTER SEEDING AND ANCHOR MULCH.
 8. INSPECT ALL SEEDED AREAS AND MAKE NECESSARY REPAIRS OR RESEEDINGS WITHIN THE PLANTING SEASON, IF POSSIBLE. IF STAND SHOULD BE OVER 60% DAMAGED, REESTABLISH FOLLOWING ORIGINAL LINE, FERTILIZER, AND SEEDING RATES.
 9. CONSULT CONSERVATION INSPECTOR ON MAINTENANCE TREATMENT AND FERTILIZATION AFTER PERMANENT COVER IS ESTABLISHED.

*APPLY: AGRICULTURAL LIMESTONE-3TONS/ACRE
 FERTILIZER - 10-10-10 ANALYSIS AT 800 - 1,000 LBS/ACRE
 SUPERPHOSPHATE - 500 LBS/ACRE OF 20% ANALYSIS SUPERPHOSPHATE
 MULCH - 2 TONS (APPROX. 80 BALES) SMALL GRAIN STRAW/ACRE
 ANCHOR - TACK WITH LIQUID ASPHALT AT 400 GALLONS/ACRE
 OR EMULSIFIED ASPHALT AT 300 GALLONS/ACRE

SEEDING SPECIFICATIONS

1. Lime: Apply 3 tons/acre (135 bls./1000 SF). Disc into top 6".
2. Fertilizer: Apply 1000 lbs./acre 10-10-10. Apply 800 lbs./acre 20% Super Phosphate. Disc into top 6".
3. Seed:

SEEDING TIME	SEED
August - October	200 lbs./acre Fescue "Rebel"
February - May	200 lbs./acre Fescue "Rebel"
November - February	200 lbs./acre Fescue "Rebel" and 25 lbs./acre Rye.
June - August	12 lbs./acre Common Bermuda Grass (hulled).
4. Mulch: Apply 1-1/2 tons/acre wheat straw on all seeded areas.
5. Tack: All slopes exceeding 3:1 to have asphalt tack applied at the rate of 22.5 gal/acre.

PLANT LIST

Key	Botanical Names	Common Names	Quantity	Size	Remarks
Shade Trees - all trees B & B					
⊙	Lagerstroemia indica	Crape Myrtle	132	8'-10'	Wall matched tree form
⊙	Pyrus calleryana	Bradford pear	48	2 1/2"	"Bradford"
Shrubs					
⊙	Prunus laurocerasus "Schipkeensis"	Skip laurel	44	3 gal	

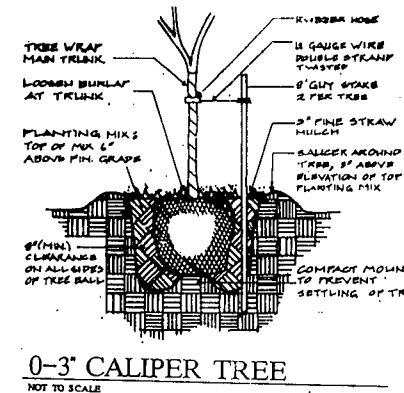
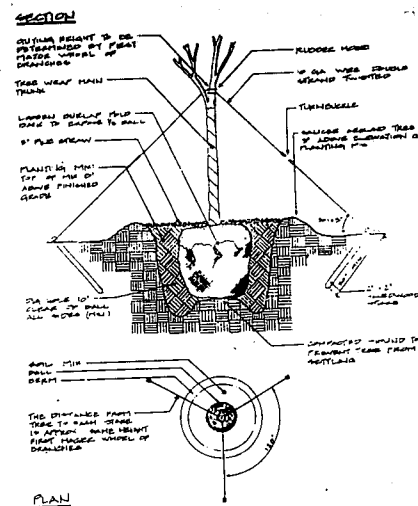

0-3' CALIPER TREE

NOT TO SCALE

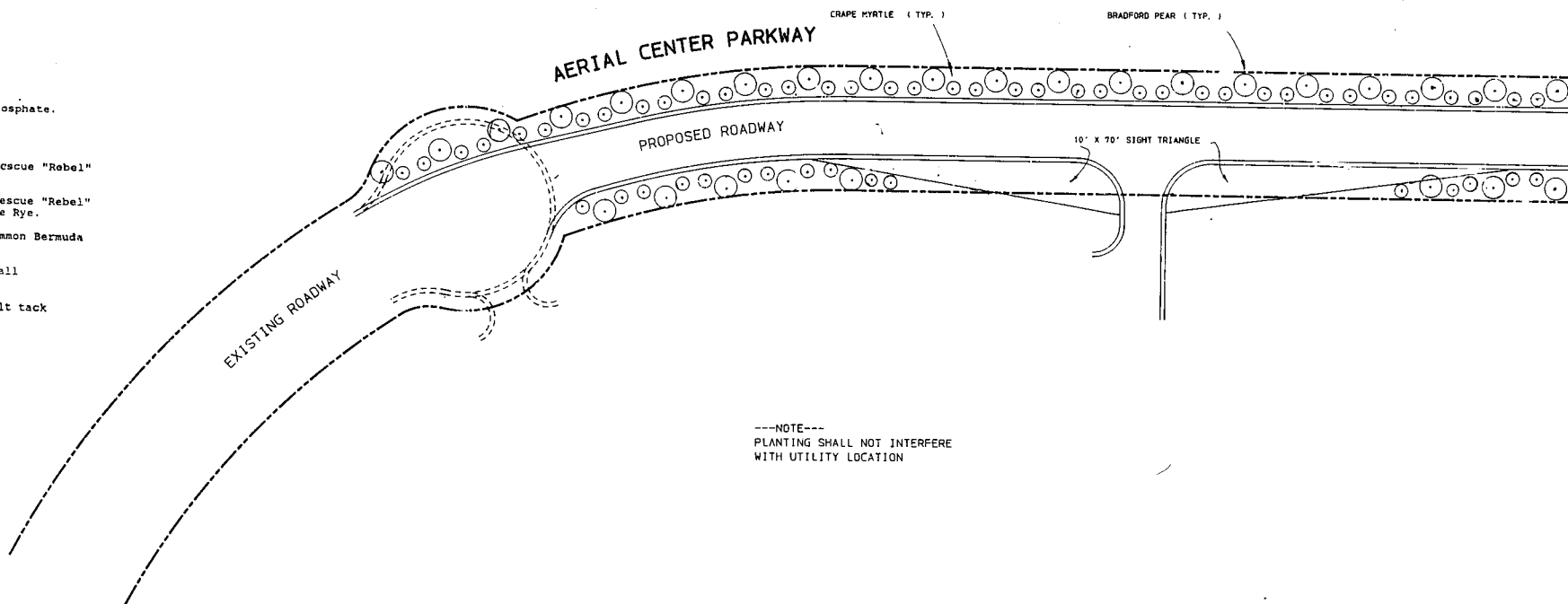
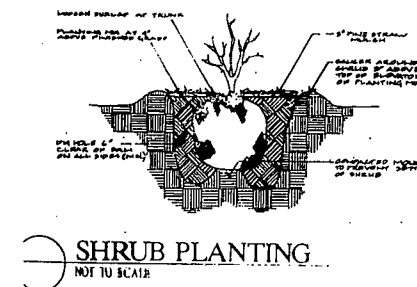

AERIAL CENTER PARKWAY SEC 3
LANDSCAPE PLAN
TOWN OF CARY, WAKE CO. NC
APRIL 1989 SCALE 1" = 40'
 0' 40' 80' 120' 160' 200' 240'

MURPHY YELLE ASSOCIATES, REGISTERED LAND SURVEYORS, RALEIGH NC

SHEET 5

85-348