

- LEGEND**
- W — EXISTING WATER
 - W — PROPOSED WATER
 - S — EXISTING SAN. SEWER
 - S — PROPOSED SAN. SEWER
 - O — EXISTING M.H.
 - O — EXISTING F.H.
 - O — NEW F.H.

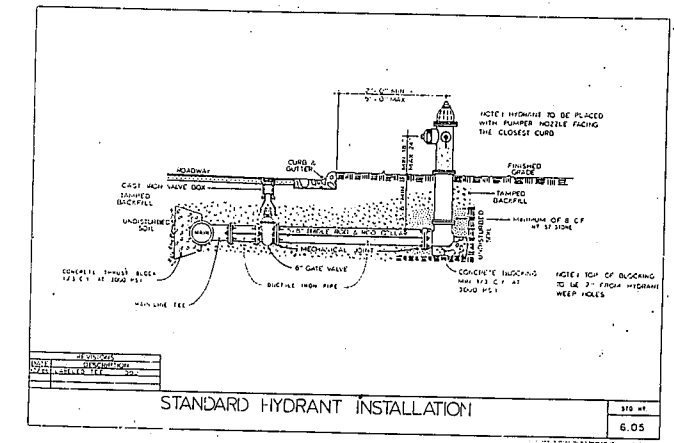

ESTIMATED WATER SERVICE
575 FU - 3" DOMESTIC WATER LINE

ESTIMATED SEWER SERVICE
405 FU - 6" SANITARY SEWER

ESTIMATED DAILY FLOW RATE
4851 GPD (53,900 SQ. FT. OF BLDG. SPACE X .09 FLOW FACTOR)

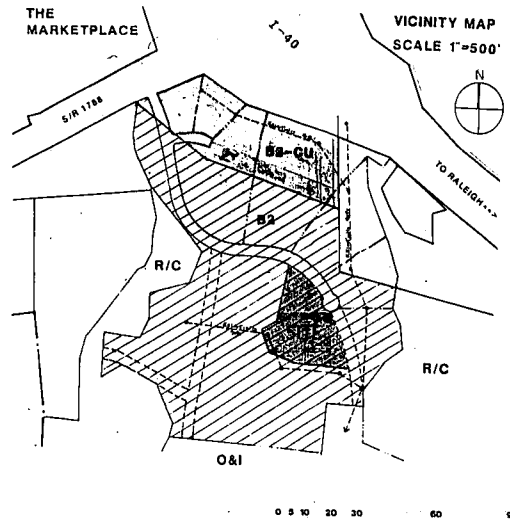

DESIGN CONDITIONS

1. CONCRETE - 4000 PSI STRENGTH MIN IN 28 DAYS.
2. UNDISTURBED SOIL - SHOULD NOT BE FRESH FILL - REMOVE ANY SAFETY CRIBBING DURING POUR.
3. FOUNDATIONS (AND SOIL RESISTANCE) EQUAL OR GREATER IN STRENGTH THAN POLE.
4. "FAIR SOILS" (WHICH INCLUDE MED. CLAY OR ANY MIXTURE OF CLAY WITH SAND AND GRAVEL.) HAVING SUFFICIENT CLAY TO BOND SAND AND GRAVEL.

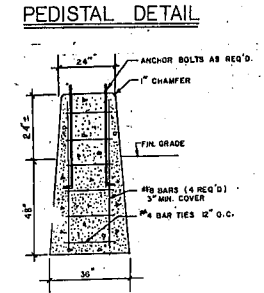

Hager
Smith
and
Huffman
Group
PA
Architecture
Landscape Architecture
Land Planning

PO Box 1308
300 South Elmwood Street
Raleigh
North Carolina 27602
Fax Number 919 820 0550
919 821 5547



Ed. Al. Revised plan
Sent by TOC
Eng. to NCDOT for
water extension
permitting.
SIS

**3000
AERIAL CENTER**

CARY,
NORTH CAROLINA

Client
PIZZAGALLI INVESTMENT CO.
P.O. BOX 13643
RESEARCH TRIANGLE PARK
NORTH CAROLINA 27709

Drawing Title: **UTILITY PLAN**

Revision	Number	Description
	1	AS SHOWN ON SHEET
	2	REVISIONS PER DHS COMMENTS

Drawn by: JWB
Checked by: WLH
Date issued: _____