

**DETAIL**  
**FIRE, DOMESTIC, AND IRRIGATION.**  
 REFER TO TOWN OF CARY'S PUBLIC UTILITIES  
 HANDBOOK FOR BACKFLOW PREVENTER AND  
 REDUCED PRESSURE ZONE DEVICE INSTALLATION  
 REQUIREMENTS.

- LEGEND**
- W — EXISTING WATER
  - W — PROPOSED WATER
  - S — EXISTING SAN. SEWER
  - S — PROPOSED SAN. SEWER
  - O — EXISTING M.H.
  - O — NEW F.H.

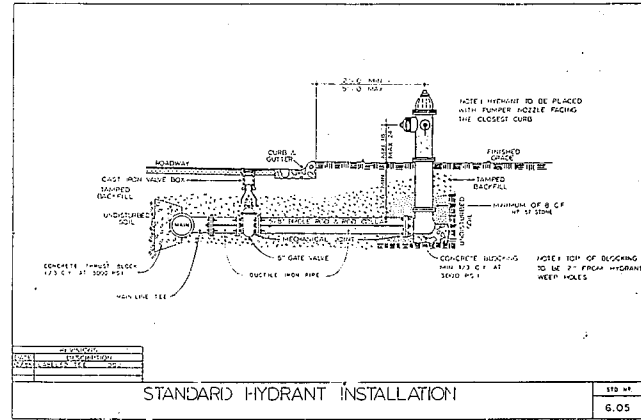

Note: Construction to be performed to Town of Cary standards.

**APPROVED**  
 DATE: 4-27-89  
 BY: *Paul Day*  
 TOWN OF CARY  
 ENGINEERING DEPARTMENT

ESTIMATED WATER SERVICE  
 575 FT - 3" DOMESTIC WATER LINE  
 ESTIMATED SEWER SERVICE  
 405 FT - 6" SANITARY SEWER  
 ESTIMATED DAILY FLOW RATE  
 4851 GPD (53,900 SQ. FT. OF BLDG. SPACE X .09 FLOW FACTOR)

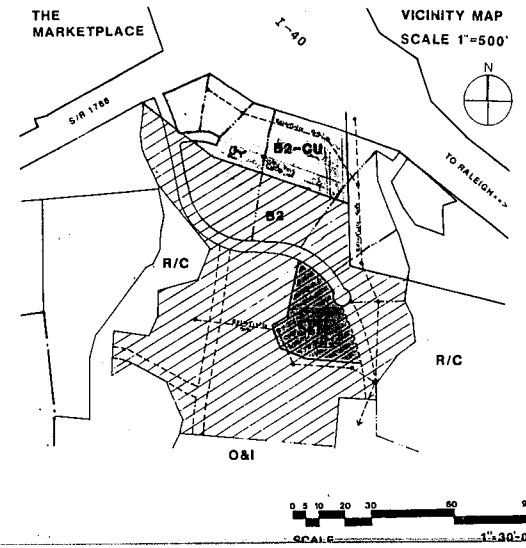

LIMITS OF IRRIGATION COVERAGE ALTERNATE #4

**DESIGN CONDITIONS**  
 1. CONCRETE - 4000 PSI STRENGTH MIN IN 28 DAYS.  
 2. UNDISTURBED SOIL - SHOULD NOT BE FRESH FILL - REMOVE ANY SAFETY CRIBBING DURING POUR.  
 3. FOUNDATIONS (AND SOIL RESISTANCE) EQUAL OR GREATER IN STRENGTH THAN POLE.  
 4. "FAIR SOILS" (WHICH INCLUDES MED. CLAY OR ANY MIXTURE OF CLAY WITH SAND AND GRAVEL.) HAVING SUFFICIENT CLAY TO BOND SAND AND GRAVEL.

**PEDISTAL DETAIL**

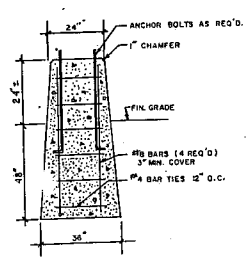

Hager  
 Smith  
 and  
 Huffman  
 Group  
 P.A.  
 Architecture  
 Landscape Architecture  
 Land Planning



3000  
**AERIAL CENTER**  
 CARY,  
 NORTH CAROLINA

Client  
 PIZZAGALLI INVESTMENT CO.  
 P.O. BOX 13643  
 RESEARCH TRIANGLE PARK  
 NORTH CAROLINA 27709

Drawing Title		
UTILITY PLAN		
Number	Description	Date
1	APPROVED	4-27-89
2	FIRE DEPT. CONNECTION	4-17-89
3	METER	4-25-89

Drawn by: JWB  
 Checked by: WLM  
 Date issued: JANUARY 23, 1989

L-3