

TOWN OF CARY  
 DEPARTMENT OF ENGINEERING  
 CARY , NORTH CAROLINA

TOWN PROJECT REFERENCE NO.			SHEET NO.	TOTAL SHEETS
83-009			1	8
DATE REV.	REV. BY	APP'D. BY	DESCRIPTION	

INDEX OF SHEETS

SHEET NO.	DESCRIPTION
1	TITLE SHEET
2-6	PLAN & PROFILE
7	METERING STA. DETAILS
8	PROJECT DETAILS

# PLAN AND PROFILE OF PROPOSED ALAVI SANITARY SEWER MAIN

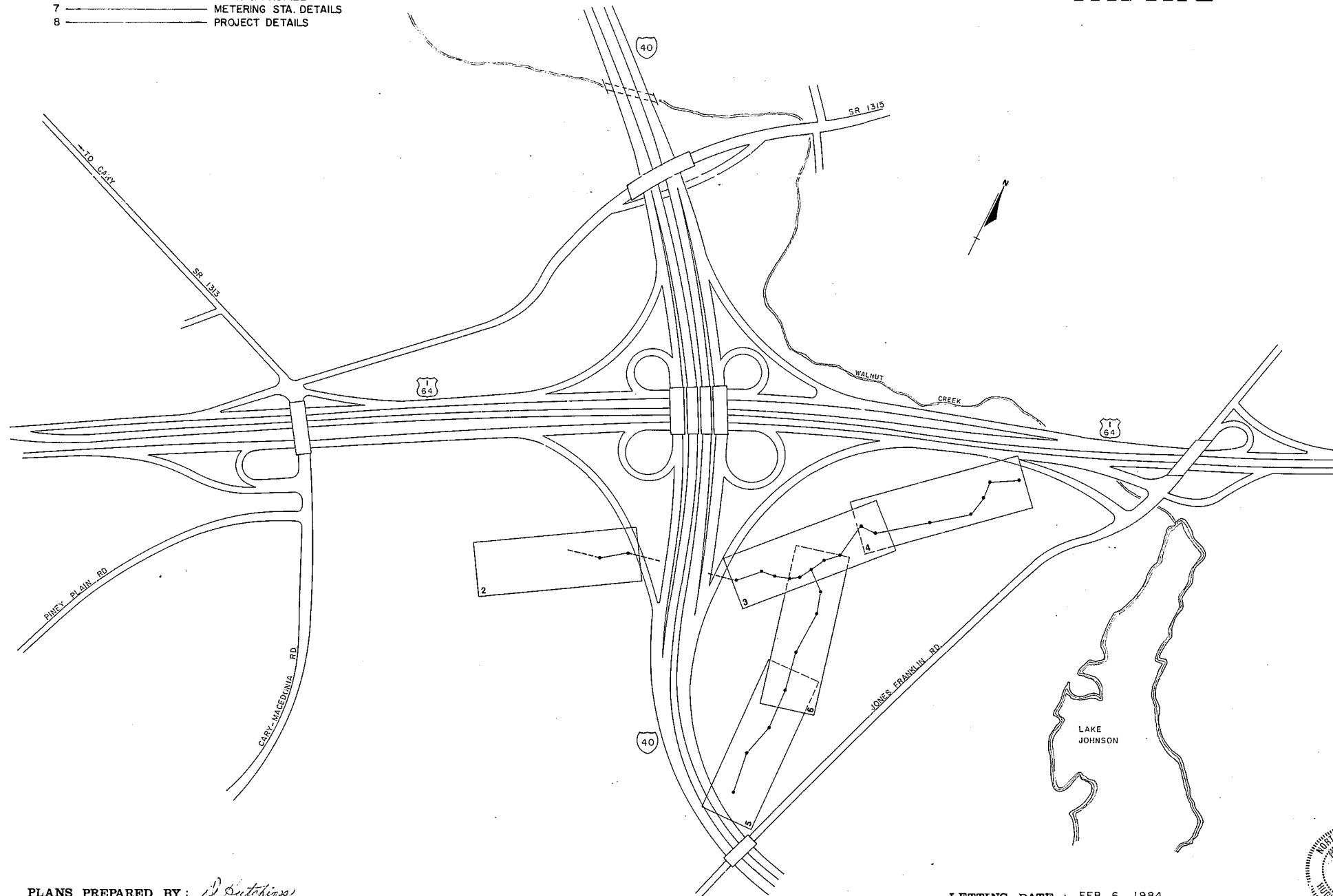

PROJECT : 83-009

PLANS PREPARED BY: D. Sutcliffe

LETTING DATE : FEB. 6, 1984

**CITY OF RALEIGH SANITARY SEWER SYSTEM EXTENSION**

Permission is granted, subject to the issuance of a permit to construct and operate from the N. C. Department of Natural Resources and Community Development, by the City of Raleigh to extend the City's public sewer system as indicated on this plan. No operation of the City's public system is intended to be granted by the City of Raleigh for its ownership, operation and maintenance, except within public sewer right-of-way indicated on the City of Raleigh or the State of North Carolina, or military sewer easements dedicated to the City of Raleigh.

Design approval only by City of Raleigh: [Signature] 3/16/84  
 (not for construction and operation)

N. C. Department of N.R.C.D., Permit No. 10265 3/19/84

Construction approval by the City of Raleigh: [Signature] 5/19/84  
 (subject to all permits, standards, specifications and ordinances.)

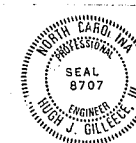

DEPARTMENT OF ENGINEERING  
 TOWN OF CARY

APPROVED: [Signature]  
 TOWN ENGINEER