

15-SP-013  
 HTE#: 15-0993  
 APPROVED BY THE TOWN OF CARY  
 DEVELOPMENT REVIEW COMMITTEE

Planner *K. Allen* Date *1 Apr 2016*

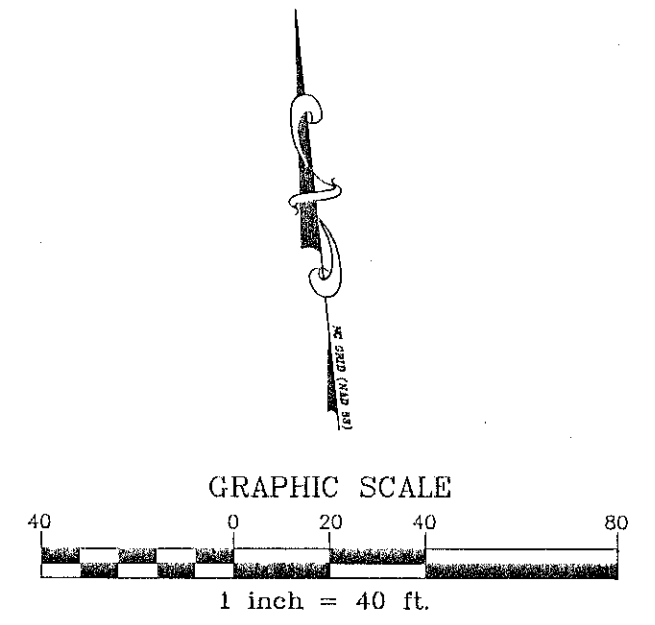

### STUB ROAD EXTENSION

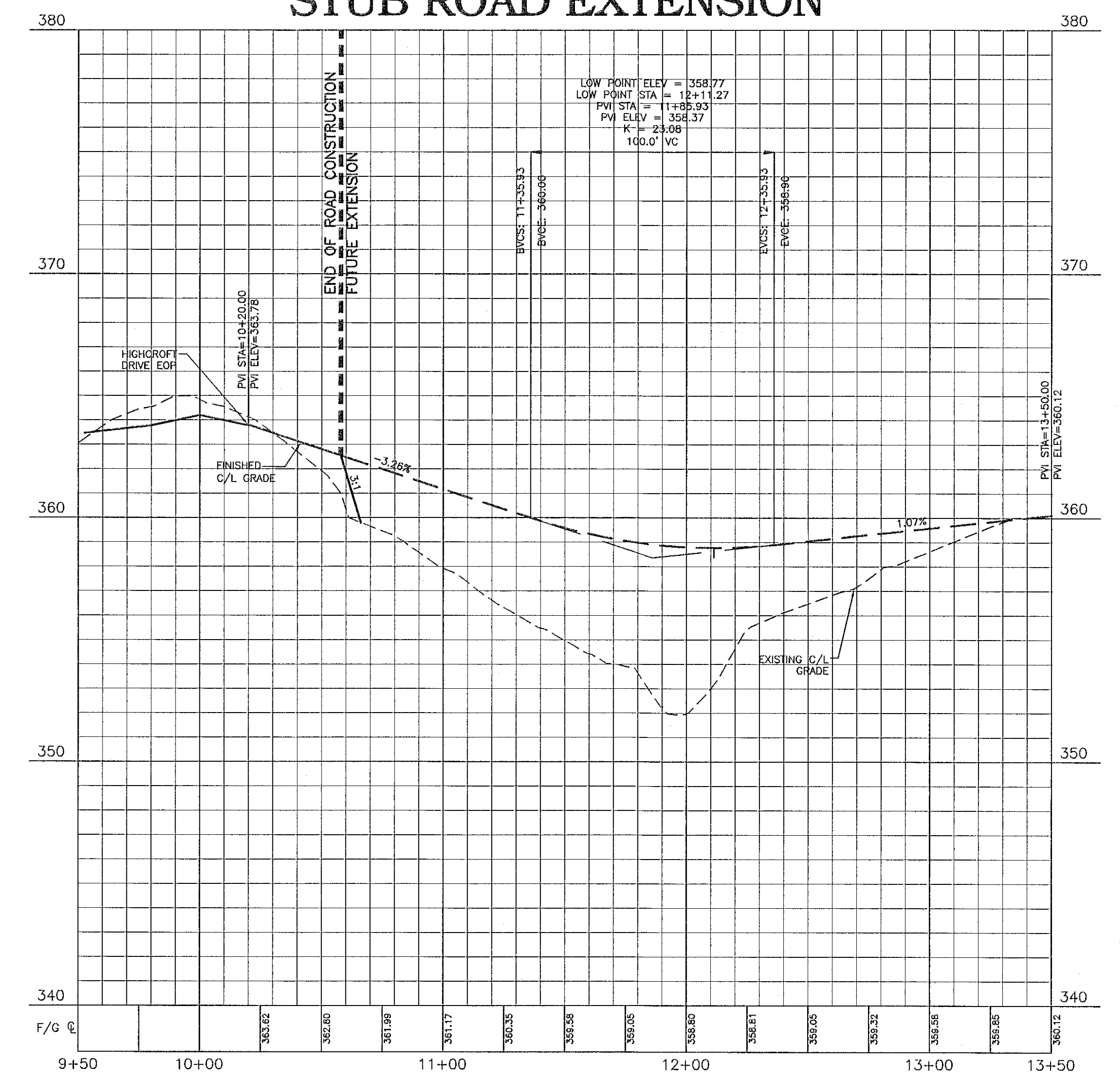

X:\Projects\WDF\14000\Construction Drawings\Current Drawings\WDF14000-P5.dwg, 3/17/2016 11:03:15 AM, Weaver, Lee

| REVISIONS: |
|------------|
| △ -        |
|            |
|            |
|            |

DEVELOPER:  
 WOODFIELD INVESTMENTS, LLC  
 11425 HORSEMAN'S TRAIL  
 RALEIGH, NC 27613

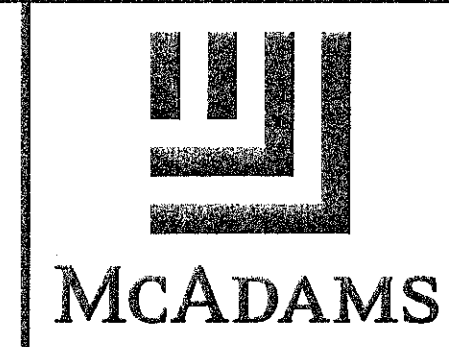

THE JOHN R. McADAMS  
 COMPANY, INC.  
 2905 Meridian Parkway  
 Durham, North Carolina 27713  
 License No.: C-0293  
 (800) 733-5646 • McAdamsCo.com

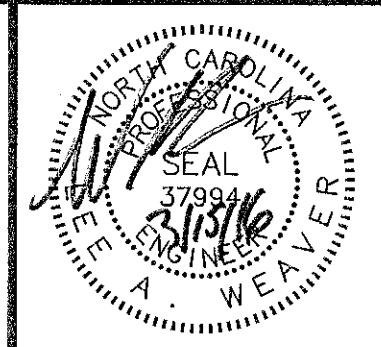

|               |             |
|---------------|-------------|
| PROJECT NO.   | WDF-14000   |
| FILENAME      | WDF14000-P5 |
| DESIGNED BY:  | LAW         |
| DRAWN BY:     | KWH         |
| HORIZ. SCALE: | 1" = 40'    |
| VERT. SCALE:  | 1" = 4'     |
| DATE:         | 03-15-2016  |

**PLAN & PROFILE**  
 STUB ROAD EXTENSION, STA. 10+00 THRU STA. 13+00

**ALSTON VILLAGE**  
 SUBDIVISION AND SITE PLAN  
 CONSTRUCTION DRAWINGS  
 CARY, NORTH CAROLINA

FINAL DRAWING - RELEASED FOR CONSTRUCTION  
 SHEET NO. **P-12**  
 MCDAMAS  
 PRINT DATE: