

**BUFFER PLANTING STANDARDS**

Type A Opaque

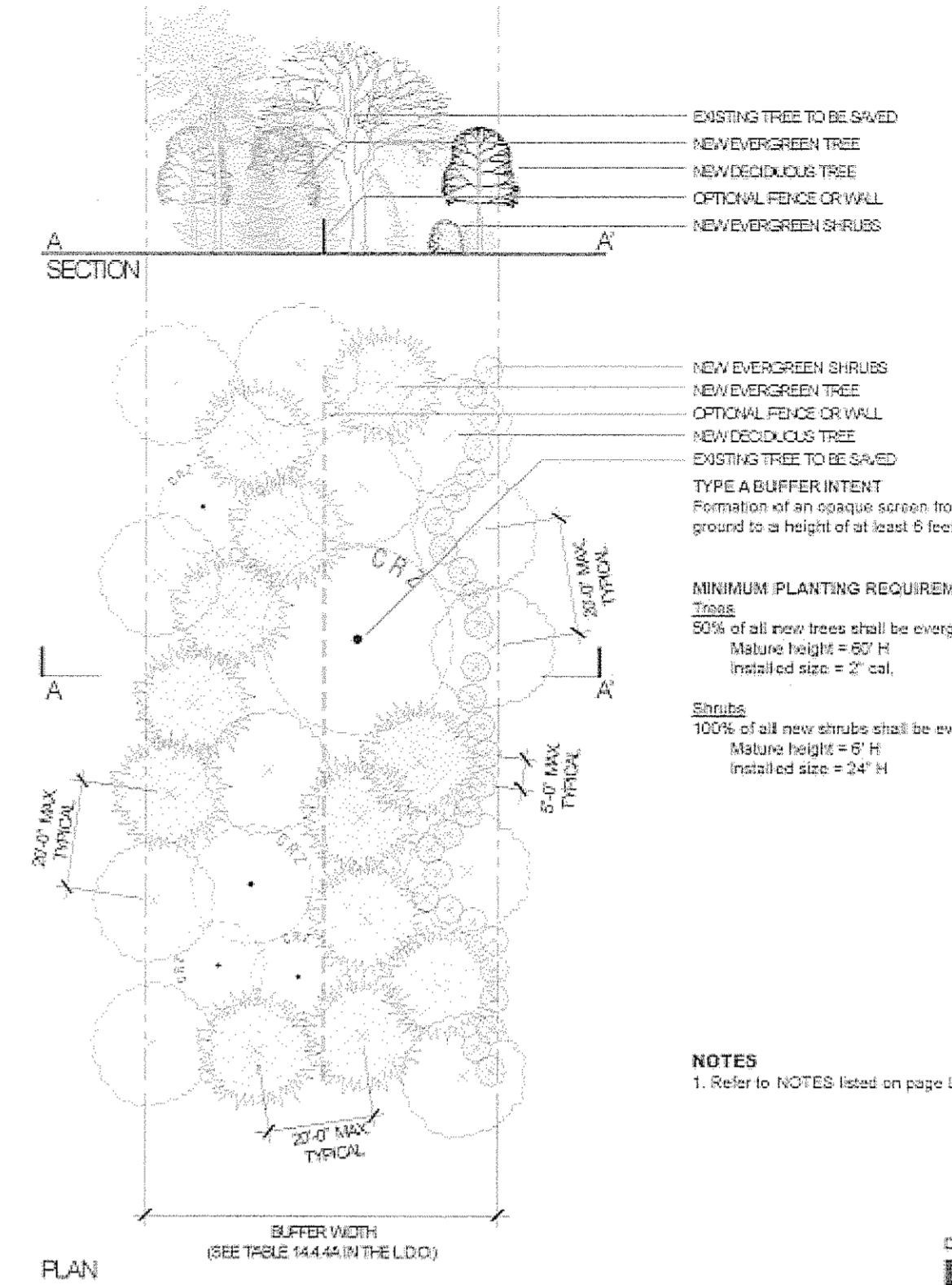

EXISTING TREE TO BE SAVED  
NEW EVERGREEN TREE  
NEW DECIDUOUS TREE  
OPTIONAL FENCE OR WALL  
NEW EVERGREEN SHRUBS

NEW EVERGREEN SHRUBS  
NEW EVERGREEN TREE  
OPTIONAL FENCE OR WALL  
NEW DECIDUOUS TREE  
EXISTING TREE TO BE SAVED

**TYPE A BUFFER INTENT**

Formation of an opaque screen from the ground to a height of at least 6 feet.

**MINIMUM PLANTING REQUIREMENTS**

**Trees**  
50% of all new trees shall be evergreen.  
Mature height = 80' H  
Installed size = 2" cal.

**Shrubs**  
100% of all new shrubs shall be evergreen.  
Mature height = 24' H  
Installed size = 24" H

**NOTES**  
1. Refer to NOTES listed on page LA-6.

REF. SEC:  
14-1, 4B(1)  
REVISED:

DETAIL NO:  
**LA-1**

**LANDSCAPE**

Town of Cary Community Appearance Manual

LAN - 6



**STEWART**  
200 S. COLLEGE ST.  
SUITE 720  
CHARLOTTE, NC 28202  
T 704.334.7925  
F 704.334.7926  
www.stewart-eng.com

**PERKINS EASTMAN**

520 W. SIXTH STREET  
CHARLOTTE, NC 28202  
704.940.0501  
Fax 362.4602

Owner:  
**UNC HOSPITALS**  
101 MANNING DR SUITE 6012  
CHAPEL HILL, NC 27514

Civil / Site:  
**STEWART ENGINEERING**  
200 S. COLLEGE ST SUITE 720  
CHARLOTTE, NC 28202 704.334.7925

Landscaping:  
**STEWART ENGINEERING**  
200 S. COLLEGE ST SUITE 720  
CHARLOTTE, NC 28202 704.334.7925

Structural:  
**STEWART ENGINEERING**  
200 S. COLLEGE ST SUITE 720  
CHARLOTTE, NC 28202 704.334.7925

MECHANICAL, PLUMBING & FIRE PROTECTION  
**PWI**  
4021 STIRRUP CREEK DR SUITE 400  
DURHAM, NC 27703 919.460.1440

ELECTRICAL  
**PWI**  
4021 STIRRUP CREEK DR SUITE 400  
DURHAM, NC 27703 919.460.1440

POOL CONSULTANT  
**COUSHMANN-HUNSAKER**  
10733 SUNSET OFFICE DR SUITE 400  
ST. LOUIS, MO 63129 314.884.1245

PROJECT TITLE:

**AMBERLY WELLNESS CENTER**

**UNC**

**WELLNESS CENTERS**

AMBERLY

CARY, NORTH CAROLINA

PROJECT No: 24911.00

DRAWING TITLE:

**LANDSCAPE**

**DETAILS**

SCALE: NTS

STEWART-X6054.00

SHEET:

**L1.2**

DATE: MARCH 7, 2007

**PLANTING DETAILS**

Tree Planting

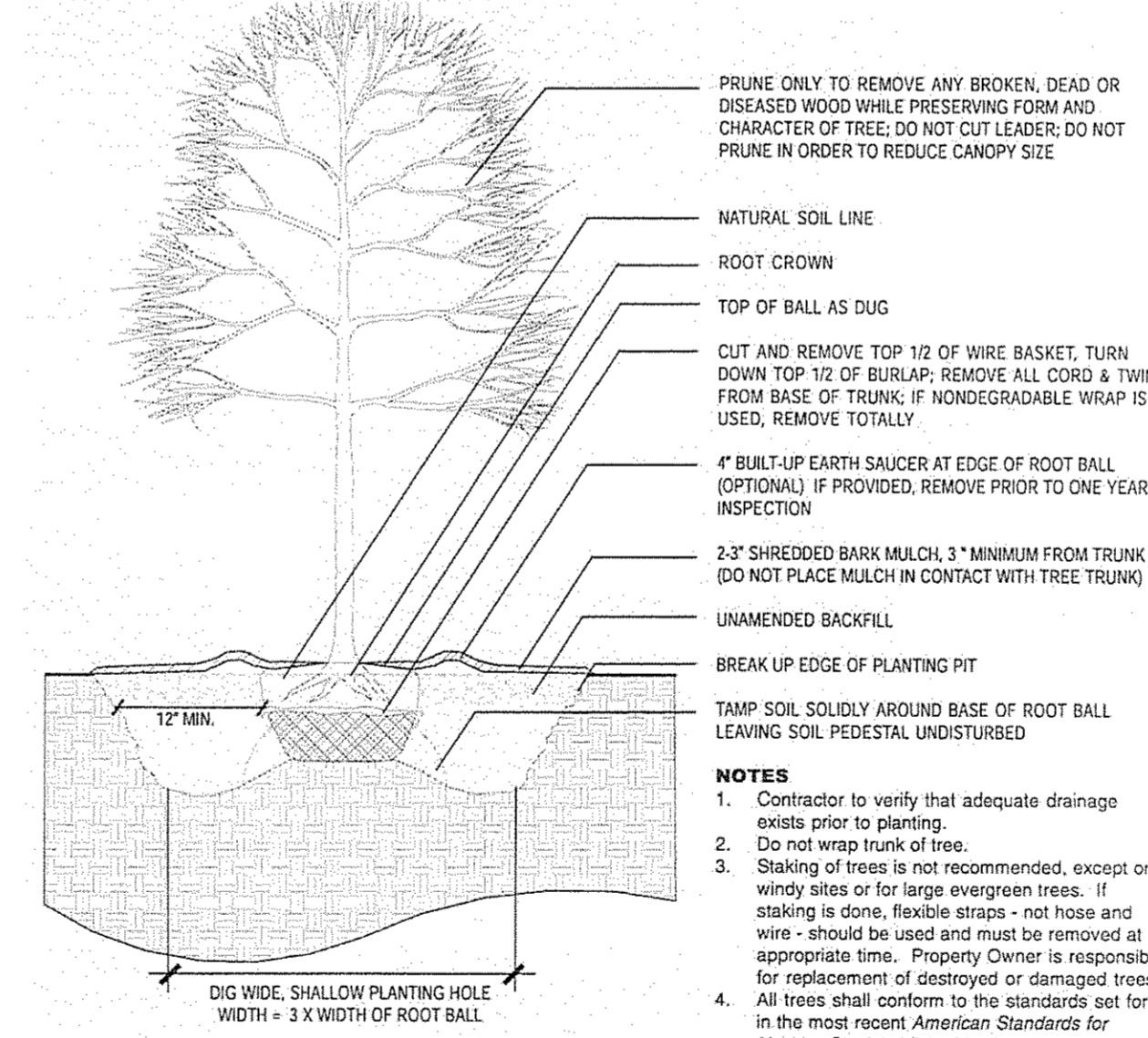

PRUNE ONLY TO REMOVE ANY BROKEN, DEAD OR DISEASED WOOD WHILE PRESERVING FORM AND CHARACTER OF TREE. DO NOT CUT LEADER. DO NOT PRUNE IN ORDER TO REDUCE CANOPY SIZE

NATURAL SOIL LINE

ROOT CROWN

TOP OF BALL AS DUG

CUT AND REMOVE TOP 1/2 OF WIRE BASKET, TURN DOWN TOP 1/2 OF BURLAP. REMOVE ALL CORD & TWINE FROM BASE OF TRUNK. IF NONDEGRADABLE WRAP IS USED, REMOVE TOTALLY.

4" BUILT-UP EARTH SAUCER AT EDGE OF ROOT BALL (OPTIONAL) IF PROVIDED, REMOVE PRIOR TO ONE YEAR INSPECTION

2.5" SHREDDED BARK MULCH. 3" MINIMUM FROM TRUNK (DO NOT PLACE MULCH IN CONTACT WITH TREE TRUNK)

UNAMENDED BACKFILL

BREAK UP EDGE OF PLANTING PIT

TAMP SOIL SOLIDLY AROUND BASE OF ROOT BALL LEAVING SOIL PEDESTAL UNDISTURBED

**NOTES**

1. Contractor to verify that adequate drainage exists prior to planting.

2. Do not wrap trunk of tree.

3. Staking of trees is not recommended, except on windy sites or for large evergreen trees. If staking is done, flexible straps - not hose and wire - should be used and must be removed at appropriate time. Property Owner is responsible for replacement of destroyed or damaged trees.

4. All trees shall conform to the standards set forth in the most recent *American Standards for Nursery Stock* published by the American Association of Nurserymen (A.A.N.).

5. Trees with root flare covered by more than 1.5" of soil will be rejected prior to installation.

6. A root collar excavation for all trees specified will be done by the Town Arborist to ensure that trees were not planted/grown too deeply at the source (nursery). Landscape contractor shall have supplier mark ground level line above rootball. If Town Arborist determines that there is excessive soil over root crown, these trees will be rejected.

REF. SEC:  
ALL  
REVISED:

DETAIL NO:  
**LA-24**

**LANDSCAPE**

Town of Cary Community Appearance Manual

LAN - 37

**PLANTING DETAILS**

Shrub, Groundcover, and Perennial Planting

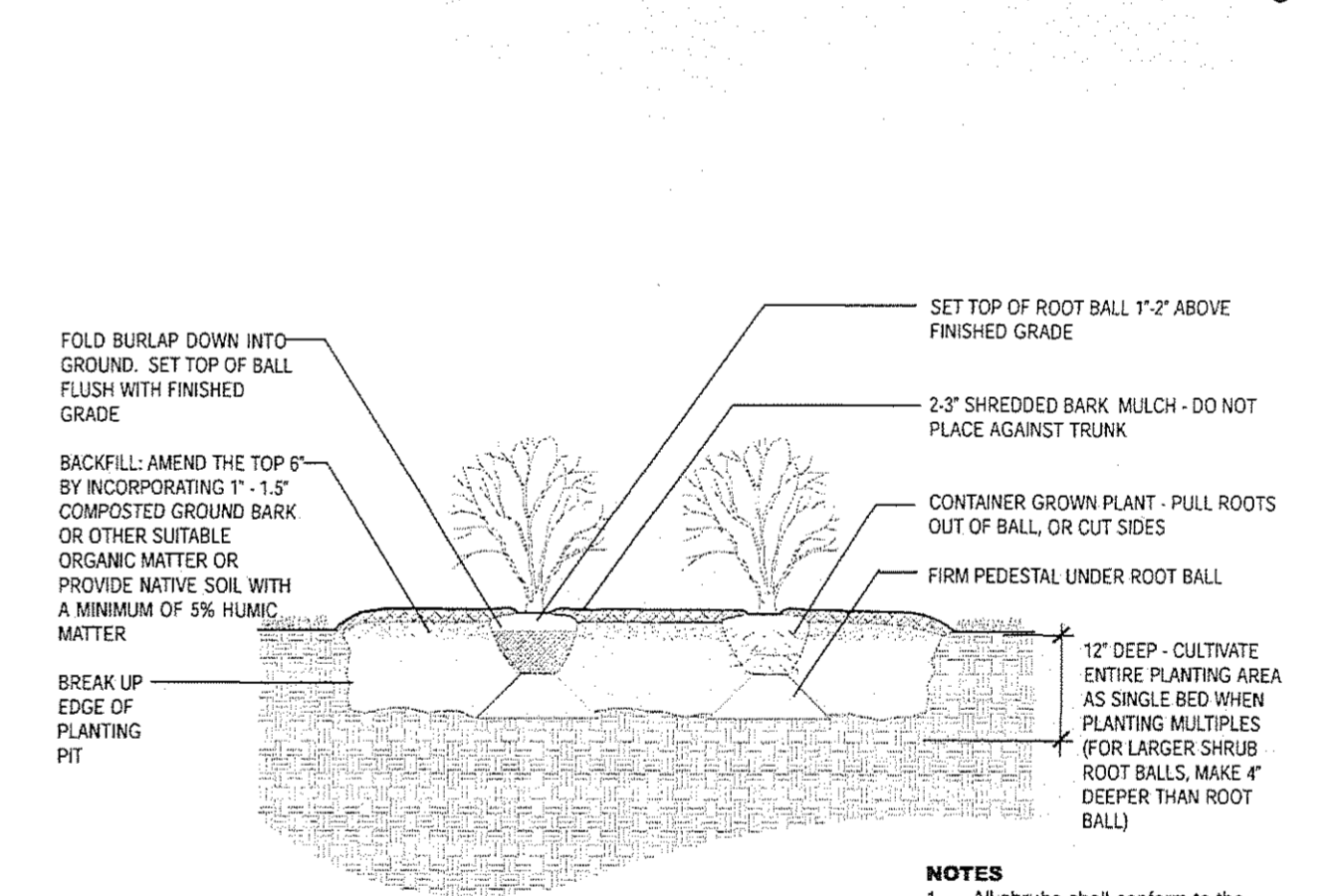

FOLD BURLAP DOWN INTO GROUND. SET TOP OF BALL FLUSH WITH FINISHED GRADE

BACKFILL: AMEND THE TOP 6" BY INCORPORATING 1" 1.5" COMPOSTED GROUND BARK OR OTHER SUITABLE ORGANIC MATTER OR PROVIDE NATIVE SOIL WITH A MINIMUM OF 5% HUMIC MATTER

BREAK UP EDGE OF PLANTING PIT

SET TOP OF ROOT BALL 1/2" ABOVE FINISHED GRADE

2.5" SHREDDED BARK MULCH - DO NOT PLACE AGAINST TRUNK

CONTAINER GROWN PLANT - PULL ROOTS OUT OF BALL, OR CUT SIDES

FIRM PEDESTAL UNDER ROOT BALL

12" DEEP - CULTIVATE ENTIRE PLANTING AREA AS SINGLE BED WHEN PLANTING MULTIPLES (FOR LARGER SHRUB ROOT BALLS MAKE 4" DEEPER THAN ROOT BALL)

**NOTES**

1. All shrubs shall conform to the standards set forth in the most recent *American Standards for Nursery Stock* published by the American Association of Nurserymen (A.A.N.).

2. Soil analysis shall be obtained prior to planting. Soil shall be amended as recommended.

3. Sheet preparation of beds is highly preferred to individually dug holes.

REF. SEC:  
ALL  
REVISED:

DETAIL NO:  
**LA-25**

**LANDSCAPE**

Town of Cary Community Appearance Manual

LAN - 38