

SCALE: HORIZONTAL: 1" = 50'  
 VERTICAL: 1" = 5'

**SANITARY SEWER PLAN/PROFILE  
 STA. 0+00 TO 16+00**

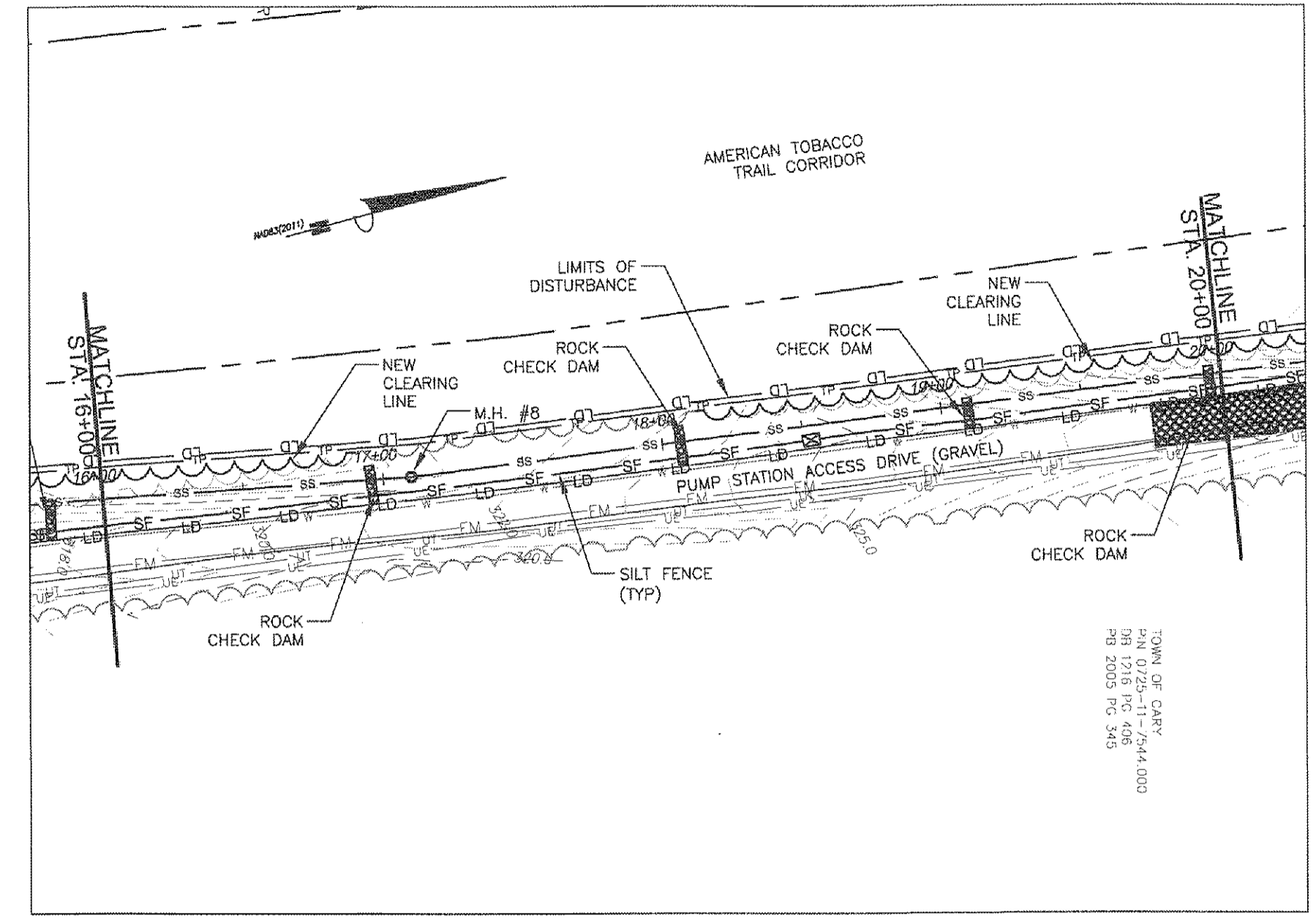

SCALE: HORIZONTAL: 1" = 50'  
 VERTICAL: 1" = 5'

**SANITARY SEWER PLAN/PROFILE  
 STA. 16+00 TO 20+00**

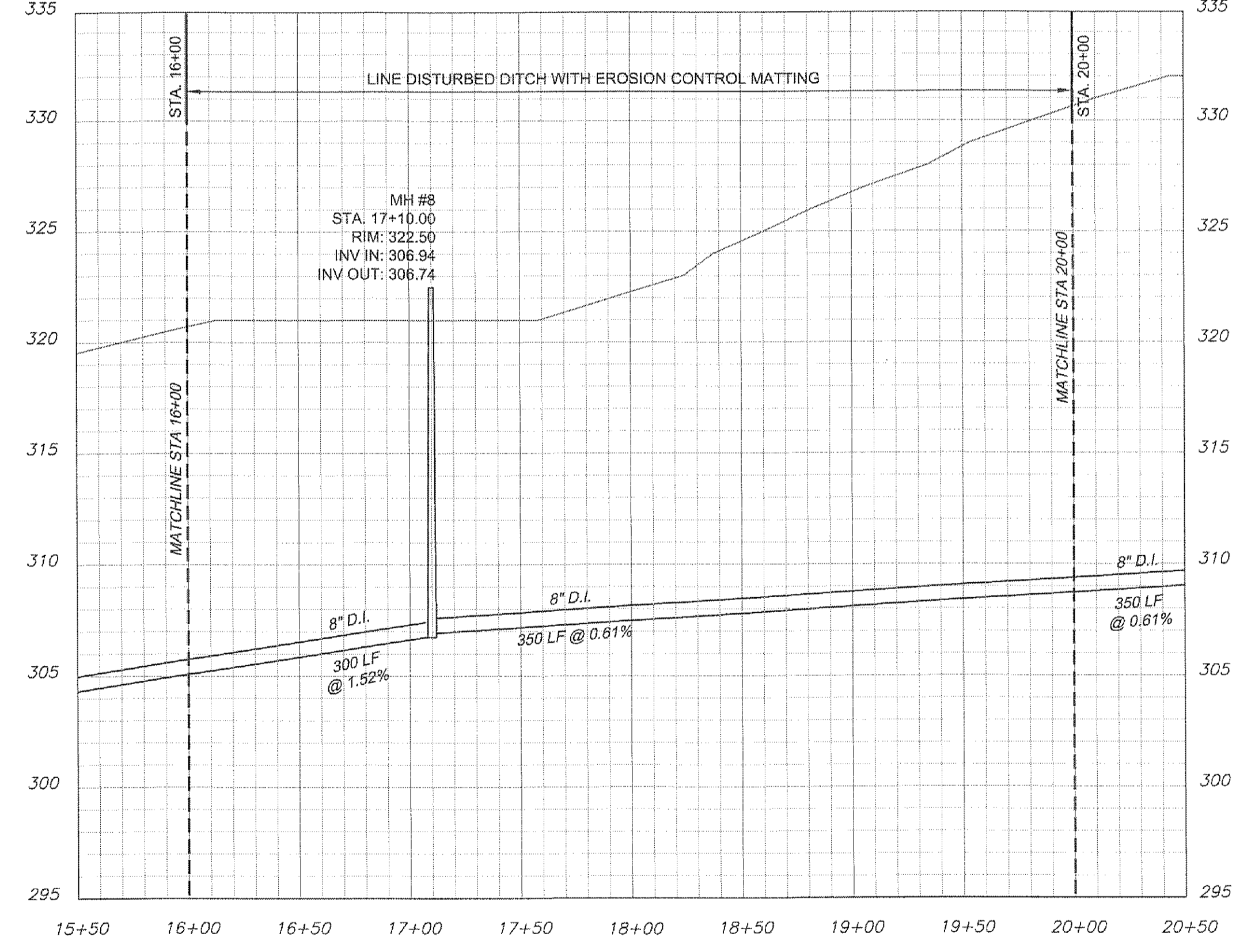
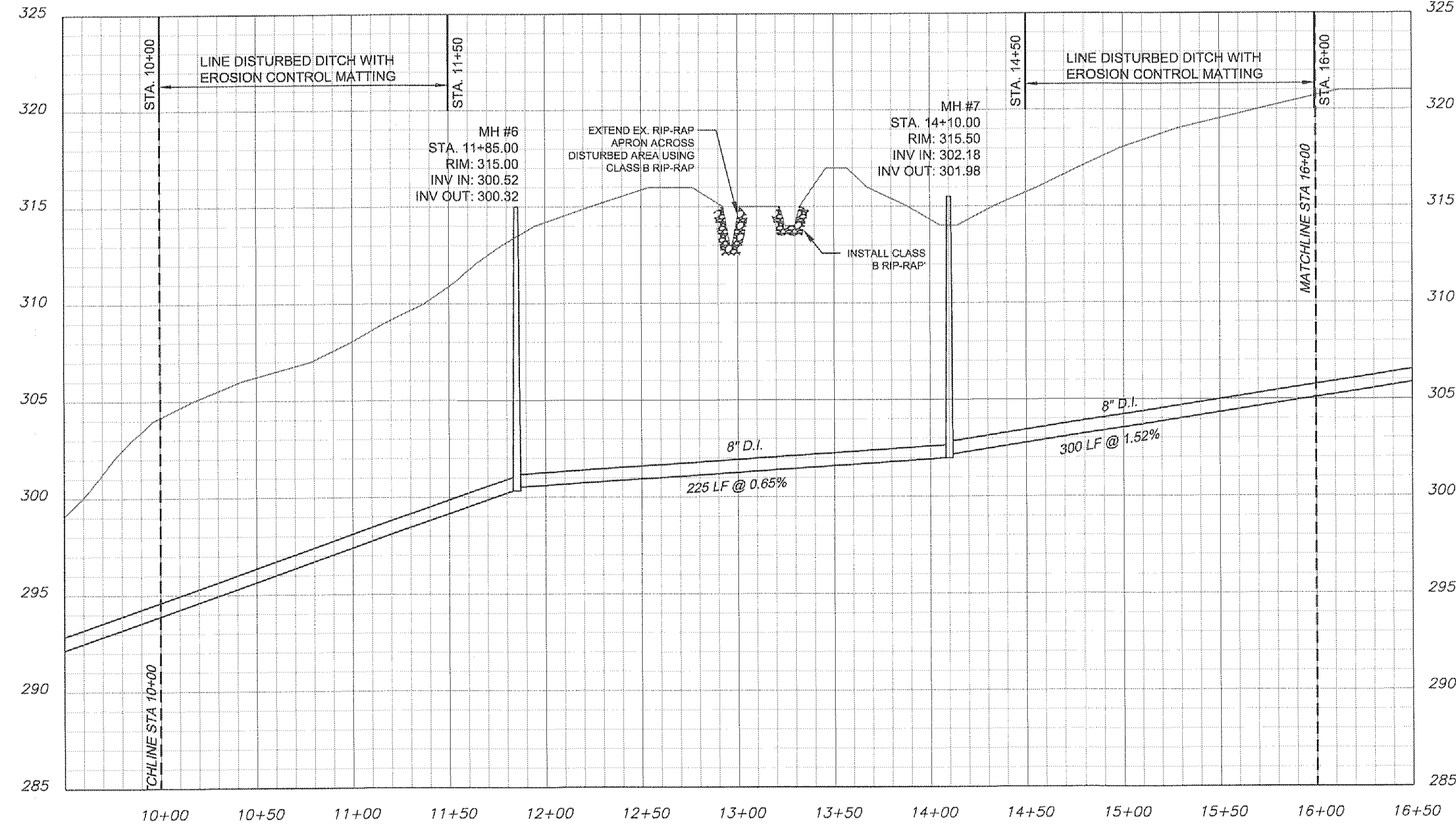

**LEGEND:**

SF - SILT FENCE  
 SS - PROPOSED SANITARY SEWER  
 UT - UNDERGROUND TELEPHONE  
 FM - 8" DUCTILE IRON FORCE MAIN  
 W - 1 1/2" COPPER WATER SERVICE LINE  
 UE - UNDERGROUND ELECTRIC

**NOTES:**

1. THIS DESIGN MEETS ALL CURRENT TOWN OF CARY STANDARD SPECIFICATIONS AND DETAILS EXCEPT WHERE SPECIFICALLY NOTED BELOW:
2. PLACE SOIL FROM EXCAVATION UPHILL OF EXCAVATION.

M.H. NO.	NORTHERN COORDINATE	EASTERN COORDINATE
6	751315.17	2021080.52
7	751316.36	2021305.52
8	751610.97	2021362.15

Project:

**AMERICAN TOBACCO TRAIL - TRAILHEAD**

2575 New Hope Church Rd.  
 Cary, North Carolina

Chatham County  
 North Carolina

TIP Project No. C-1576

PIN:  
 0725-12-7361

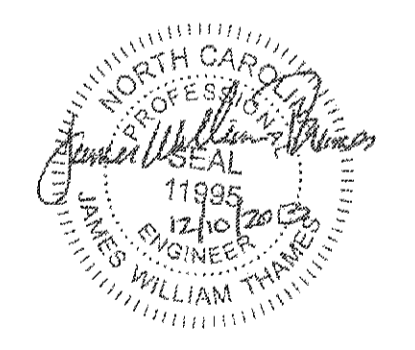

**CONSTRUCTION DOCUMENTS**

Job Number: 1257

Drawn	JSA
Checked	JWT, JSA
Date	07-11-2013: Initial submittal
Revisions	08-22-2013: 1st resubmittal
	09-19-2013: 2nd resubmittal
	11-07-2013: 3rd resubmittal
	12-10-2013: Bid Set

Sheet Title:

**SAN. SEWER PLAN/PROFILE  
 STA. 10+00 TO 20+00**

Sheet Number  
**C502**

Cary Project # 13-SP-037  
 Approved by the Town of Cary  
 Development Review Committee

Planner *[Signature]* Date: 1/22/2014