

CAROLINA POWER & LIGHT

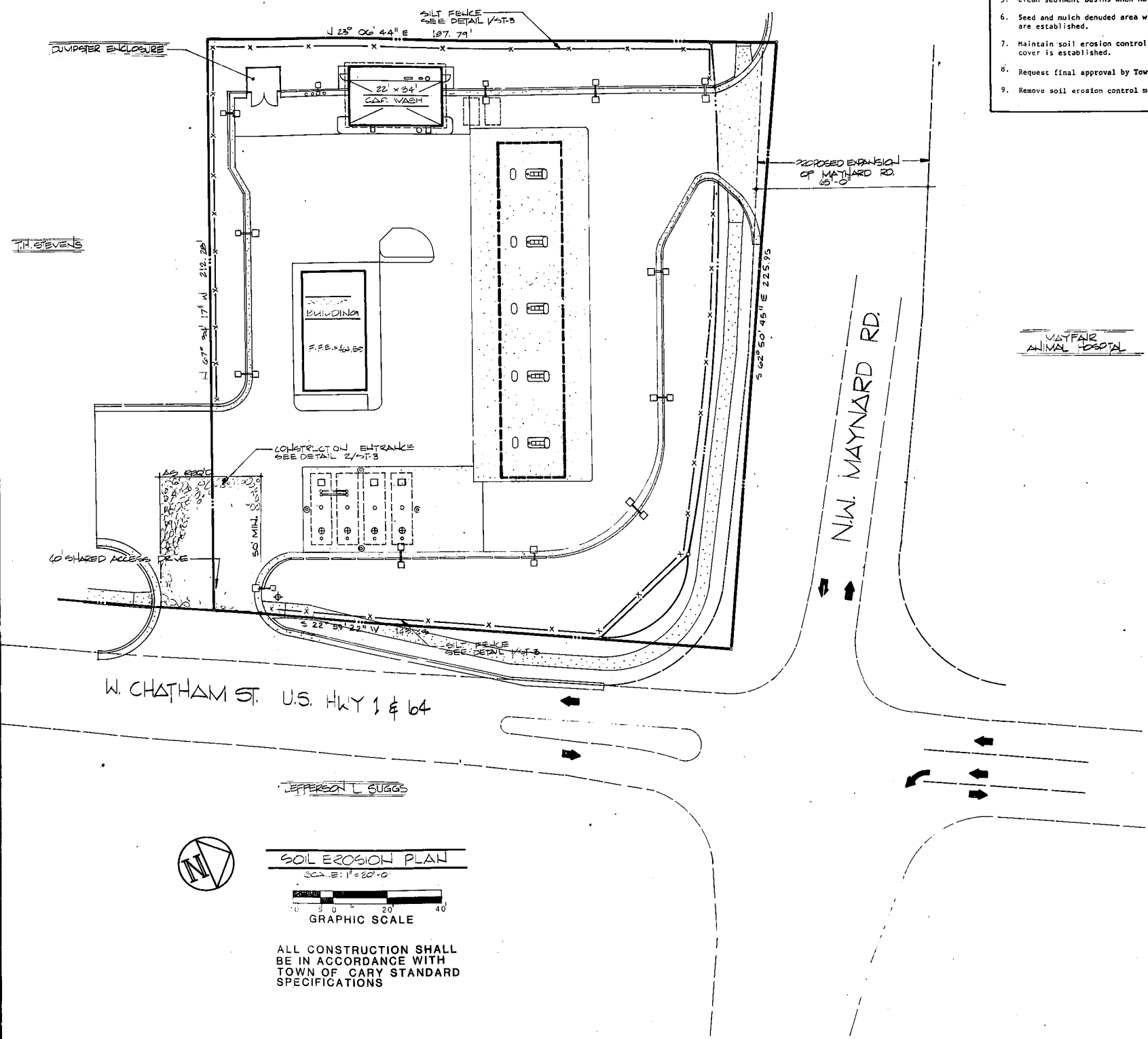

- CONSTRUCTION SEQUENCE**
1. Obtain Grading Permit.
 2. Install all erosion control measures as shown.
 3. Obtain Certificate of Compliance through on-site inspection by Town Erosion Control Engineer.
 4. Proceed with grading.
 5. Clean sediment basins when half full.
 6. Seed and mulch denuded area within 30 days after finished grades are established.
 7. Maintain soil erosion control measures until permanent ground cover is established.
 8. Request final approval by Town Erosion Control Engineer.
 9. Remove soil erosion control measures and stabilize these areas.

- SOIL EROSION NOTES**
- GENERAL NOTES:**
1. SITE CONDITIONS AS SHOWN WERE TAKEN FROM A SURVEY PREPARED BY R. G. GERRING & ASSOCIATES, INC., 2406 W. 5TH ST., WILSON, NC 27893 (919) 291-8887. DATED: JULY, 1988.2.
 2. REFER TO SHEET ST-1 FOR SITE PLAN, SHEET ST-2 FOR GRADING PLAN, SHEET ST-3 FOR SOIL EROSION CONTROL PLAN, SHEET ST-5 AND ST-6 FOR PUMP ISLAND AND UNDERGROUND TANK AND ELECTRIC SUPPLY SITE PLAN.
 3. ALL UTILITY LOCATIONS INCLUDING SEWER, WATER, GAS, ELECTRIC, AND TELEPHONE SHALL BE VERIFIED BY THE CONTRACTOR AT THE SITE PRIOR TO CONSTRUCTION. COORDINATE ALL UTILITY CONNECTIONS WITH LOCAL AUTHORITIES PRIOR TO INSTALLATION.
 4. PROVIDE EROSION CONTROL MEASURES SHOWN ON THIS PLAN AND ADDITIONAL MEASURES WHICH MAY BECOME NECESSARY TO PREVENT EROSION SEDIMENT CLOGGING.
 5. CONTRACTOR SHALL OBEY ALL NATIONAL, STATE, AND LOCAL LAWS CONCERNING SOIL EROSION CONTROL.
 6. EROSION CONTROL MEASURES SHALL BE IN PLACE AT THE INCEPTION OF SOIL DISTURBING ACTIVITIES. THEY SHALL REMAIN IN PLACE AND BE MAINTAINED IN GOOD CONDITION UNTIL THEY ARE NO LONGER REQUIRED BY THE ABOVE SLOPE AREAS HAVE STABILIZED, BY REGRASSING OR PAVING.
 7. AREAS DISTURBED WHICH ARE NOT TO BE PAVED SHALL BE RESEDED WITH GRASS.

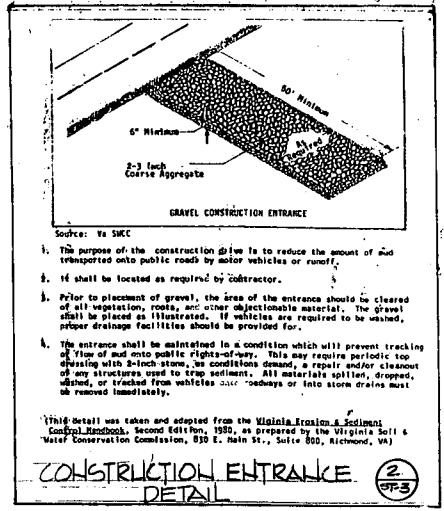
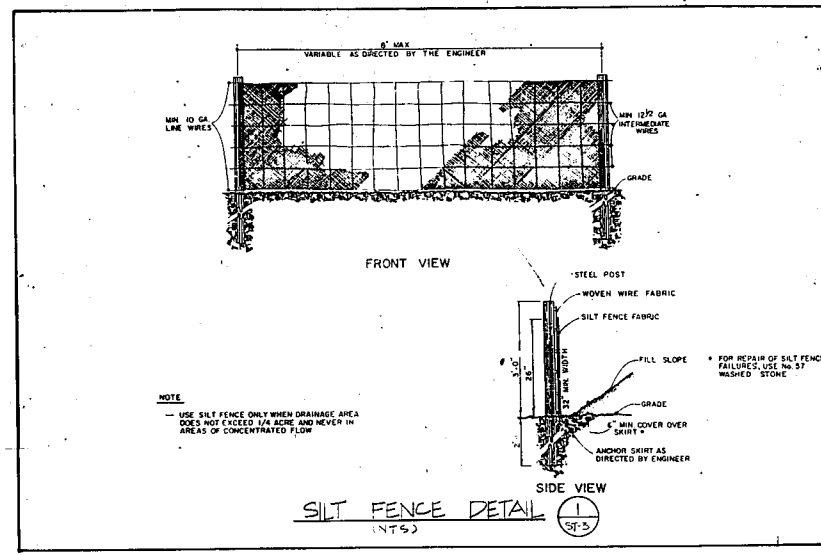

JEFFERSON L. SUGGS

SOIL EROSION PLAN
SCALE: 1" = 20'-0"

0 5 10 20 40
GRAPHIC SCALE

ALL CONSTRUCTION SHALL BE IN ACCORDANCE WITH TOWN OF CARY STANDARD SPECIFICATIONS

R. GARY GUECK, A.I.A.
ARCHITECT - PLANNERS
228 SOUTH CHURCH STREET, POST OFFICE BOX 273
ROCKY MOUNT, NORTH CAROLINA 27801
TELEPHONE (919) 442-1888



CONTRACTOR SHALL VERIFY AND BE RESPONSIBLE FOR ALL DIMENSIONS AT JOB SITE.

SITE DEVELOPMENT PLANS FOR
AMOCO OIL COMPANY
W. CHATHAM ST. & N.W. MAYNARD RD.
CARY, N.C.

REVISIONS	
17 MARK. BY J.S.G. PER TOWN	
31 MARK. BY J.S.G. PER TOWN	
53 MARK. BY J.S.G. PER TOWN	
DRAWN BY J.M.B./J.S.B.	
CHECKED BY R.G.G.	
DATE 18 AUG 1988	
SHEET 3 OF 12	
PROJECT	SHEET NO.
872 ST-3	2
SOIL EROSION PLAN	