

NOTE:
 OF & L STORAGE BUILDING LOCATED
 APPROXIMATELY 200' TOWARD THE SW

CAROLINA POWER & LIGHT

CONTRACTOR SHALL COORDINATE
 CONSTRUCTION & INSTALLATION
 OF CONCRETE DRIVE APRON WITH
 CONSTRUCTION ON MAYNARD RD
 AND SHALL MAKE ANY REQUIRED
 CHANGES AFTER NOTIFICATION &
 APPROVAL OF ARCHITECT & ENGINEER

SITE INFORMATION

TOTAL PARKS: REGULAR 7
 HANDICAP 1
 OTHER 0
 LOT AREA 40,000 SQ FT
 PAVED AREA 14,000 SQ FT
 BUILDING AREA 11,000 SQ FT
 LANDSCAPE AREA 9,900 SQ FT
 WALKS AND OTHER PAVING 5,500 SQ FT

WATER SERVICE 1/2"
 SAN. SEW. SERVICE 4"
 ELECTRICAL SER. 4"
 NATURAL/LP GAS SER. 1/2"
 PRIME SIGN LOCATION 100 FT FROM CURB
 ZONING B-2 C.U.

SETBACK REQUIREMENTS:
 FRONT 50'-0"
 REAR 0'
 RIGHT SIDE 50'-0"
 LEFT SIDE 0'

LEGEND:

[Symbol]	BUILDING(S) NEW OR EXISTING	[Symbol]	SANITARY SEWER NOTE 3
[Symbol]	PROPERTY LINE	[Symbol]	CLEAN OUT (MAX 50' O.C.)
[Symbol]	NEW CONCRETE CURB	[Symbol]	WATER LINE NOTE 3
[Symbol]	NEW CONCRETE DRIVE	[Symbol]	GAS LINE NOTE 3
[Symbol]	UTILITY POLE	[Symbol]	UNDERGROUND ELECTRIC
[Symbol]	EXISTING SPOT ELEVATIONS	[Symbol]	STORM SEWER
[Symbol]	BENCHMARK ELEVATION	[Symbol]	DETAIL REF NUMBER DETAIL SHEET NUMBER
[Symbol]	SETBACK OR EASEMENT LINE	[Symbol]	LANDSCAPING NOTE 11
[Symbol]	EXISTING CONTOURS TO CHANGE	[Symbol]	EXISTING CONTOURS TO REMAIN
[Symbol]	NEW CONTOURS	[Symbol]	NEW SPOT ELEVATION
[Symbol]	ITEMS TO BE REMOVED NOTE 13	[Symbol]	SILT FENCE SEE DETAIL
[Symbol]	GRAVEL CONST. ENTRANCE SEE DETAIL		

SITE NOTES

- EXISTING SITE CONDITIONS AS SHOWN WERE TAKEN FROM SURVEY PREPARED BY R. R. HERRINGS & ASSOCIATES, INC., 2406 WEST N.W. STREET, WILSON, NC. DATED JULY 1988.
- REFER TO ST-1 FOR SITE PLAN, SHEET ST-2 FOR GRADING PLAN, SHEET ST-3 FOR SOIL EROSION CONTROL PLAN, SHEET ST-4 FOR UTILITY PLAN, SHEET ST-5 FOR ELECTRICAL PLAN, SHEET ST-6 FOR LANDSCAPING PLAN, SHEET ST-7 FOR IRRIGATION PLAN.
- ALL UTILITY LOCATIONS INCLUDING SEWER, WATER, GAS, ELECTRIC, AND TELEPHONE SHALL BE VERIFIED BY THE CONTRACTOR AT THE SITE PRIOR TO CONSTRUCTION. COORDINATE ALL UTILITY CONNECTIONS WITH LOCAL AUTHORITIES PRIOR TO INSTALLATION.
- WATER MAIN TAP TO BE 1" METER BASE. WATER LINE FROM METER TO BUILDING SHALL BE 1" COPPER.
- CONNECT BUILDING STORM DRAINAGE INTO STORM DRAINAGE SYSTEM WHERE APPLICABLE.
- CONCRETE PADS TO BE 6" - 4000 PSI CONCRETE WITH FIBERGLASS REINFORCEMENT UNLESS OTHERWISE SPECIFIED. (REFER TO SPECIFICATIONS AND SCOPE OF WORK FOR MORE INFORMATION.) PAVING TO BE LEVEL WITH ASPHALT PAVING OR AS SHOWN.
- CONNECT NEW DRIVE PAVING TO EXISTING STREET PAVING. DRIVES AND APPROACHES SHALL BE CONSTRUCTED ACCORDING TO N. C. STATE HIGHWAY STANDARDS FOR COMMERCIAL DRIVES USING STANDARDS FOR ENTRANCE REQUIREMENTS UNLESS INSTRUCTED OTHERWISE BY GOVERNING OFFICIALS.
- YARD LIGHTS WHEN SHOWN SHALL HAVE BASE INSTALLED BY GENERAL CONTRACTOR AND WIRED BY ELECTRICAL CONTRACTOR. POLES AND FIXTURES SHALL BE SUPPLIED BY OWNER.
- ASPHALT PAVING TO HAVE 2" ASPHALT BINDER WITH 1 1/2" ASPHALT FINISH OVER 4" CRUSHED STONE BASE UNLESS OTHERWISE NOTED. OFF SITE PAVING AT DRIVES SHALL CONFORM TO NORTH CAROLINA DOT SPECIFICATIONS: 8" ABC FILL, 3" N BINDER, AND 2" 1-2.
- ALL PARKING LOT STRIPING SHALL BE WHITE STANDARD TRAFFIC PAINT. PARKING LINES SHALL BE 4" WIDE BY LENGTH SHOWN. HANDICAP SYMBOL SHALL BE PAINTED WHITE STANDARD TRAFFIC PAINT UNLESS OTHERWISE REQUIRED BY LOCAL STANDARDS.
- SITE WORK AND LANDSCAPE CONTRACTOR SHALL COMPLY WITH LOCAL AND STATE CODES IN OBSERVING SOIL EROSION CONTROL MEASURES DURING AND AFTER CONSTRUCTION, ON AND OFF SITE.
- HANDICAP RAMP SHALL NOT EXCEED 5%. RAMP AND PARKING FOR HANDICAP SHALL COMPLY WITH HANDICAP CODE. PROVIDE HANDICAP 8'x8'.
- COMPLETELY REMOVE ALL EXISTING FEATURES NON-CONDUCTIVE TO NEW CONSTRUCTION BY REMOVING AND DISPOSING OF DEBRIS FROM SITE IN A LEGAL MANNER.
- PROVIDE CLEAN FILL AS REQUIRED. FILL SHALL BE PLACED IN 4" MAXIMUM LIFTS AND COMPACTED TO A DENSITY OF 92% MODIFIED PROCTOR. FILL SHALL BE COMPACTED IN SUCH A MANNER AS TO PROVIDE MINIMUM BEARING CAPACITY OF 2,000 PSF.
- CONTRACTOR PRIOR TO SUBMITTING BID SHALL INSPECT SITE FOR WORK TO BE DONE THIS JOB BY HIS RESPECTIVE TRADE. CONTRACTOR(S) PROVIDING SERVICES SHALL VERIFY EXISTING CONDITIONS AND BE RESPONSIBLE FOR ALL DIMENSIONS AND ELEVATIONS ON JOB SITE. DISCREPANCIES NOTED SHALL BE BROUGHT TO THE ATTENTION OF THE ARCHITECT PRIOR TO CONSTRUCTION.
- RELOCATE EXISTING POWER POLE. CONSULT LOCAL AUTHORITIES.
- CONNECT NEW DRIVEWAY CURB AND GUTTER TO EXISTING STREET CURB AND GUTTER.

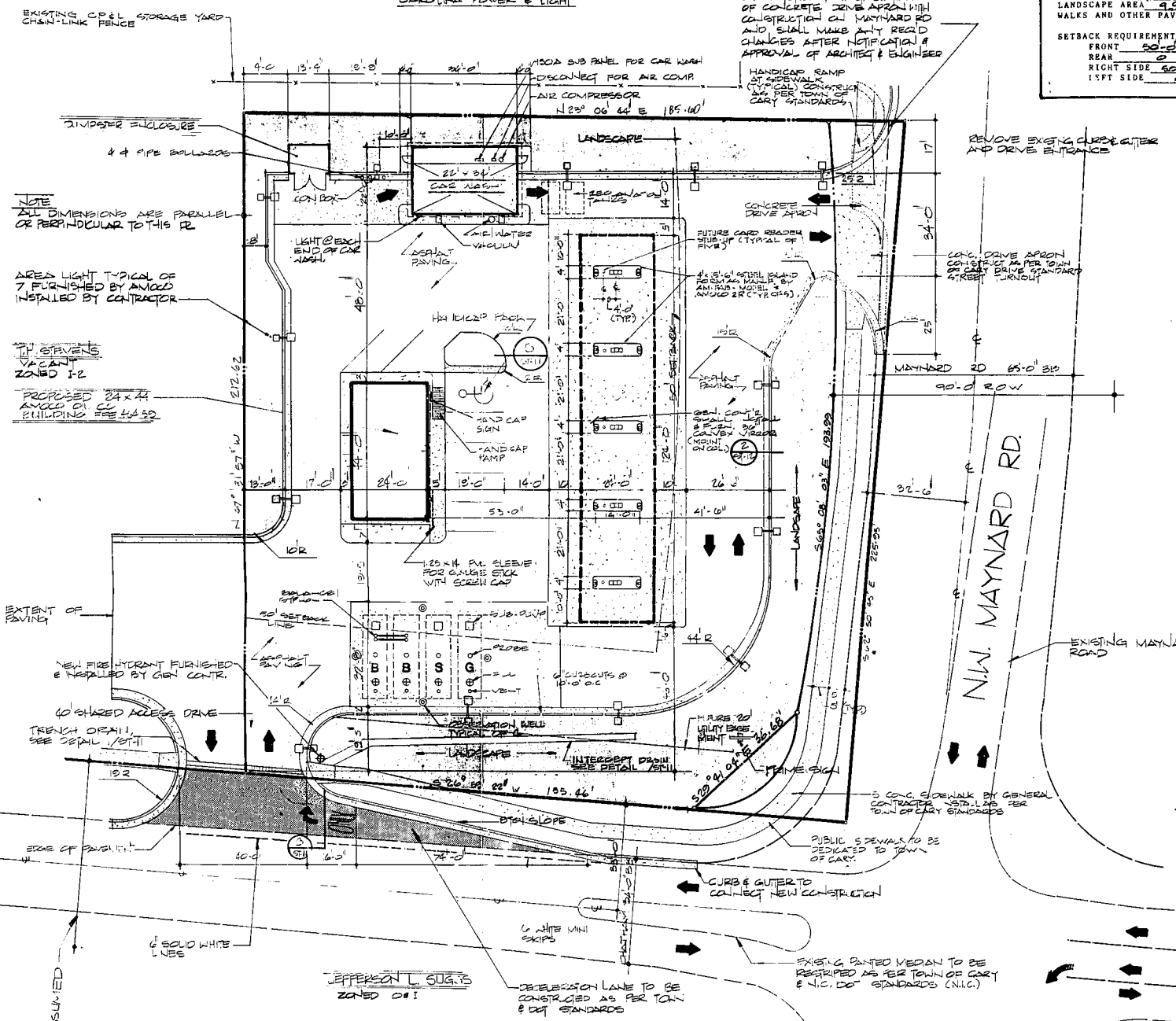

SITE PLAN
 SCALE: 1" = 20'-0"

NOTES:
 1. ALL OFF SITE PAVEMENT MARKS SHALL CONFORM TO THE DOT STANDARDS SEE DETAILS ON SHEET ST-2
 2. REFER TO SHEET ST-7 FOR LOCATION OF EXISTING UTILITIES AND CONNECTION

GRAPHIC SCALE

ALL CONSTRUCTION SHALL BE IN ACCORDANCE WITH TOWN OF CARY STANDARD SPECIFICATIONS

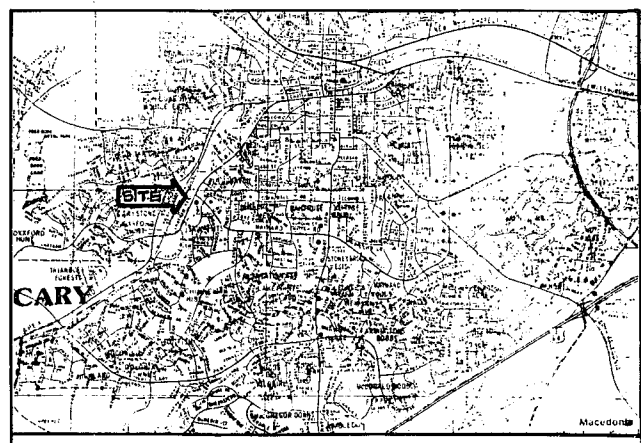

VICINITY MAP
 SCALE: 1" = 1000'-0"

R. GARY GLUCK, A.I.A.
 ARCHITECT - PLANNERS
 228 SOUTH CHURCH STREET, POST OFFICE BOX 273
 ROCKY MOUNT, NORTH CAROLINA 27801
 TELEPHONE (919) 442-1686



CONTRACTOR SHALL VERIFY AND BE RESPONSIBLE FOR ALL DIMENSIONS AT JOB SITE.

SITE DEVELOPMENT PLAN FOR
AMOCO OIL COMPANY
 W. CHATHAM ST. & N.W. MAYNARD RD.
 CARY, N.C.

REVISIONS	17 AUG 1988 AS PER TOWN
3 APRIL 1988 AS PER TOWN	
2 APRIL 1988 AS PER TOWN	
DRAWN BY	BEARD
CHECKED BY	RGG
DATE	10 AUG 1988
SHEET	1 OF 12
PROJECT SHEET NO.	872 ST-1
SITE PLAN	