

PAVEMENT SECTIONS

SERVICE DOCKS 6" 4000 PSI CONCRETE WITH 4" ABC STONE OVER 6" COMPACTED SUBGRADE (SHOWN WITH 15' x 15' CONST. JOINTS)

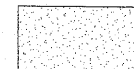

HEAVY DUTY AREA - PRIMARY DRIVES 3" TYPE 1-2, 8" ABC STONE OVER 6" COMPACTED SUBGRADE



LIGHT DUTY AREA - PARKING STALLS 3" TYPE 1-2, 8" ABC STONE OVER 6" COMPACTED SUBGRADE

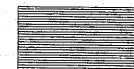

NOTE: THE OWNER MAY CHOOSE TO LEAVE THE FINISHED PAVEMENT GRADE 1" LOW DURING CONSTRUCTION. THIS OPTION WILL REQUIRE THE TOTAL ASPHALT THICKNESS TO BE INCREASED BY ONE-HALF INCH.

FINAL PAVEMENT DESIGN TO BE VERIFIED BY THE GEOTECHNICAL CONSULTANT FOR THE OWNER. FINAL DESIGN CALCULATIONS ARE TO BE SUBMITTED TO THE TOWN OF CARY PRIOR TO PLACEMENT OF ABC.

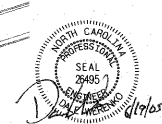
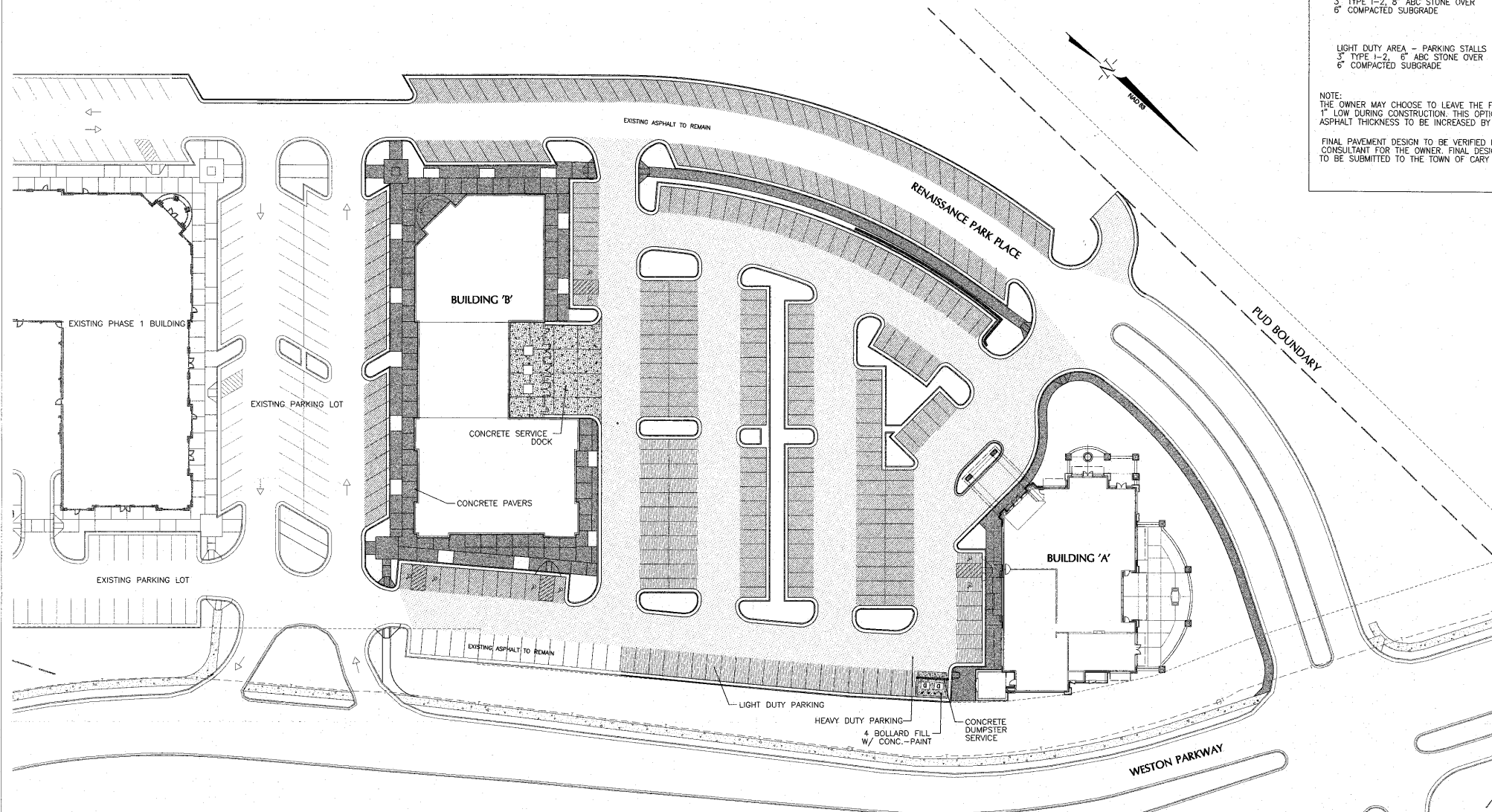

05-SP-001
APPROVED
TOWN OF CARY
DRC Date 06/30/05
Planning Date 06/30/05
Engineering Date 7-1-05

No	Revision	Date	By	Designer	Scale
1	TOC FIRST REVIEW COMMENTS	10/21/05	MVH	WBR	1"=30'
2	TOC SECOND REVIEW COMMENTS	05/06/05	JMA		
3	ADD PARKING, ABANDON TOC COMMENTS	06/20/05	MVH	DW	1/3/05
	Checked By			WK	20102120

THE ARBORETUM
PHASE 2
WAKE COUNTY
NORTH CAROLINA

PAVING PLAN - PHASE 2 RETAIL

WITHERS & RAVENEL
ENGINEERS | PLANNERS | SURVEYORS
111 Wolfenden Blvd Cary, North Carolina 27511 Tel: 919-467-3340 Fax: 919-467-4008 www.withersandravenel.com