

GENERAL NOTES:

1. CONCRETE COMPRESSIVE STRENGTH OF 4,000 P.S.I AT 28 DAYS.
2. CLEAN BOTTOM OF HOLE PRIOR TO PLACEMENT OF CONCRETE.
3. CONCRETE WILL BE PLACED WITHIN 8 HOURS OF DRILLING.
4. MORTAR SHALL BE TYPE "S".
5. CONSTRUCTION SHALL BE IN ACCORDANCE WITH THE REQUIREMENTS OF THE "RECOMMENDED PRACTICE FOR ENGINEERED BRICK MASONRY" BRICK INSTITUTE OF AMERICA.
6. #9 GAUGE WIRE FABRICATED AS SHOWN BETWEEN EACH COURSE OF COLUMN BRICK.
7. BRICK MASON WILL USE BOREN "OLD GUILFORD" OVERSIZE FACE BRICK W/ BUFF COLORED MORTAR.

ARBORETUM

SCREEN WALL
DETAIL

Drawn By: EVC
Checked By: BE
Date: 4-17-00
Proj#: 2901003

Revisions

9A-SR-183-A
APPROVED

5-11-00
JP (en)

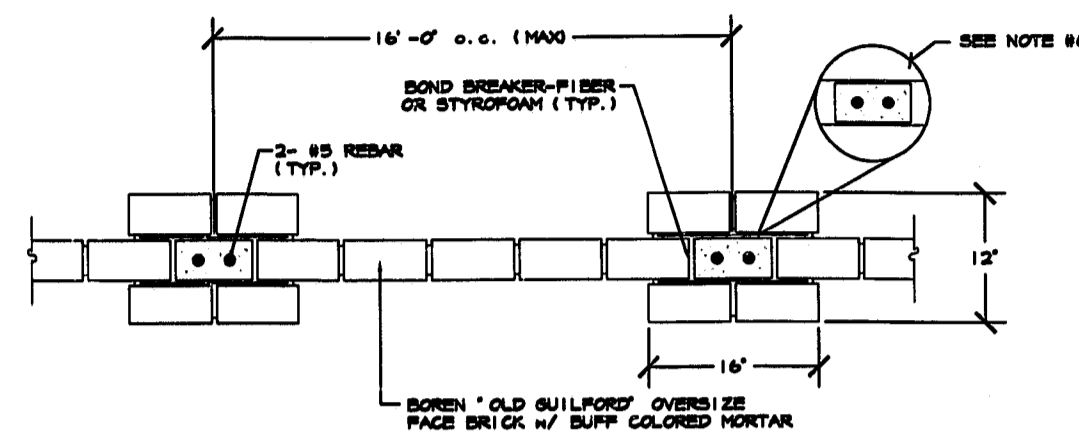

TYPICAL WALL & COLUMN LAYOUT PLAN
SCALE: NOT TO SCALE

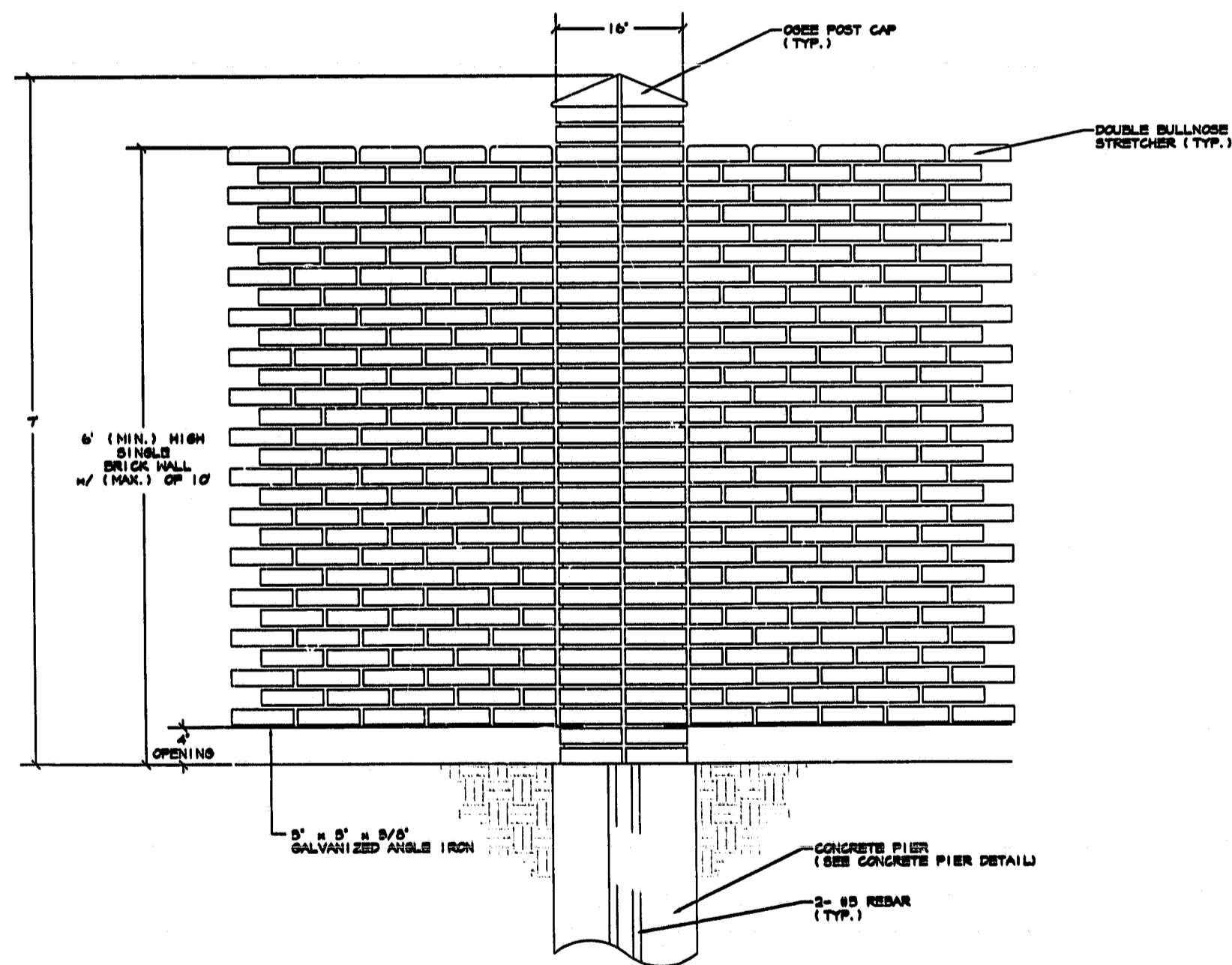

COLUMN & WALL DETAIL (ELEVATION)
SCALE: NOT TO SCALE

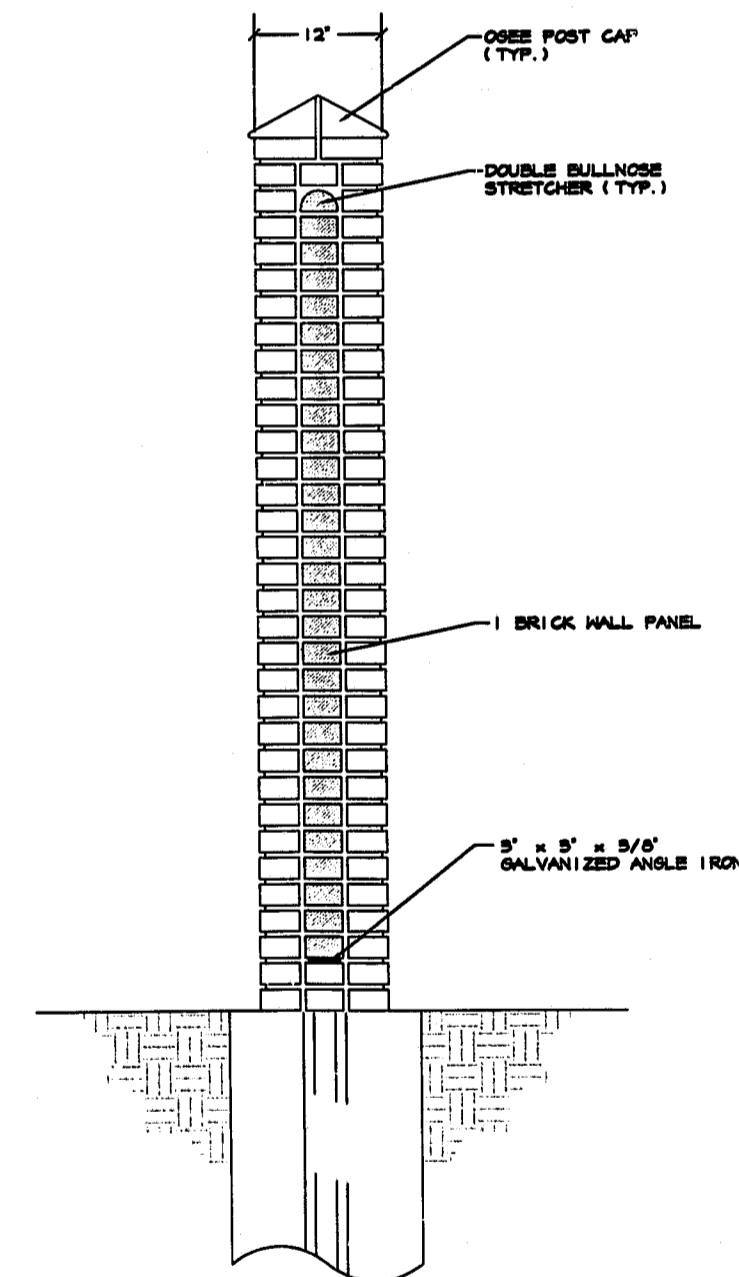

COLUMN & WALL DETAIL (ELEVATION)
SCALE: NOT TO SCALE

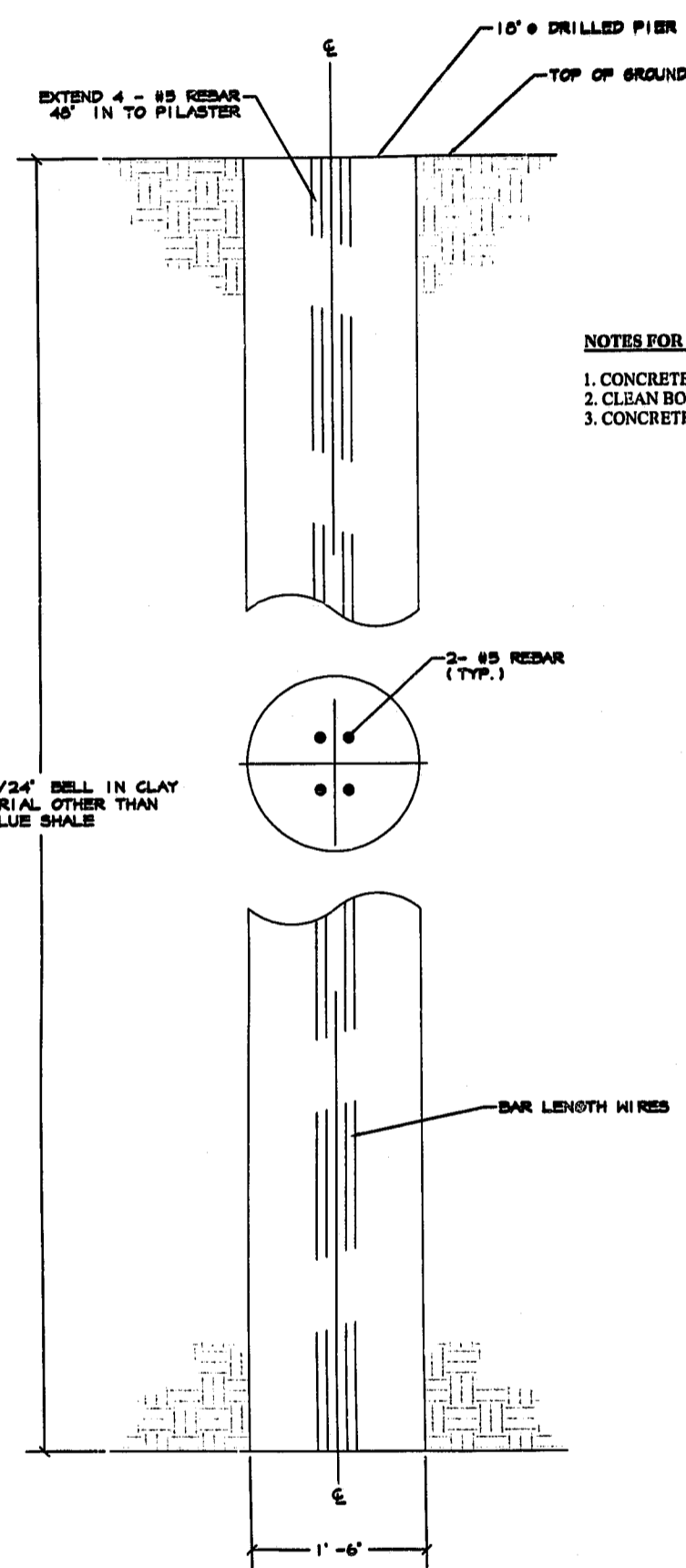

PIER DETAIL
SCALE: NOT TO SCALE

NOTES FOR PIER:

1. CONCRETE COMP. STRENGTH - 4,000 P.S.I.
2. CLEAN BOTTOM OF HOLE PRIOR TO PLACEMENT OF CONCRETE.
3. CONCRETE WILL BE PLACED WITHIN 8 HOURS OF DRILLING.