

LEGEND	
DRUM	•
CONE	▲
STATIONARY SIGN	T
PORTABLE SIGN	z
WORK AREA	▨

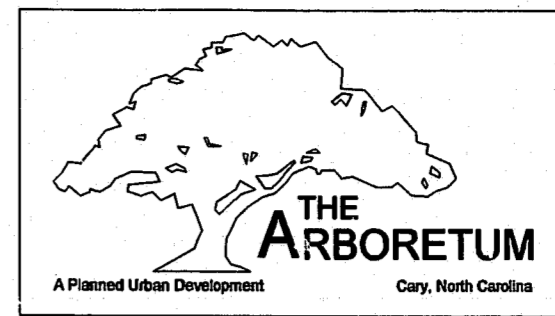
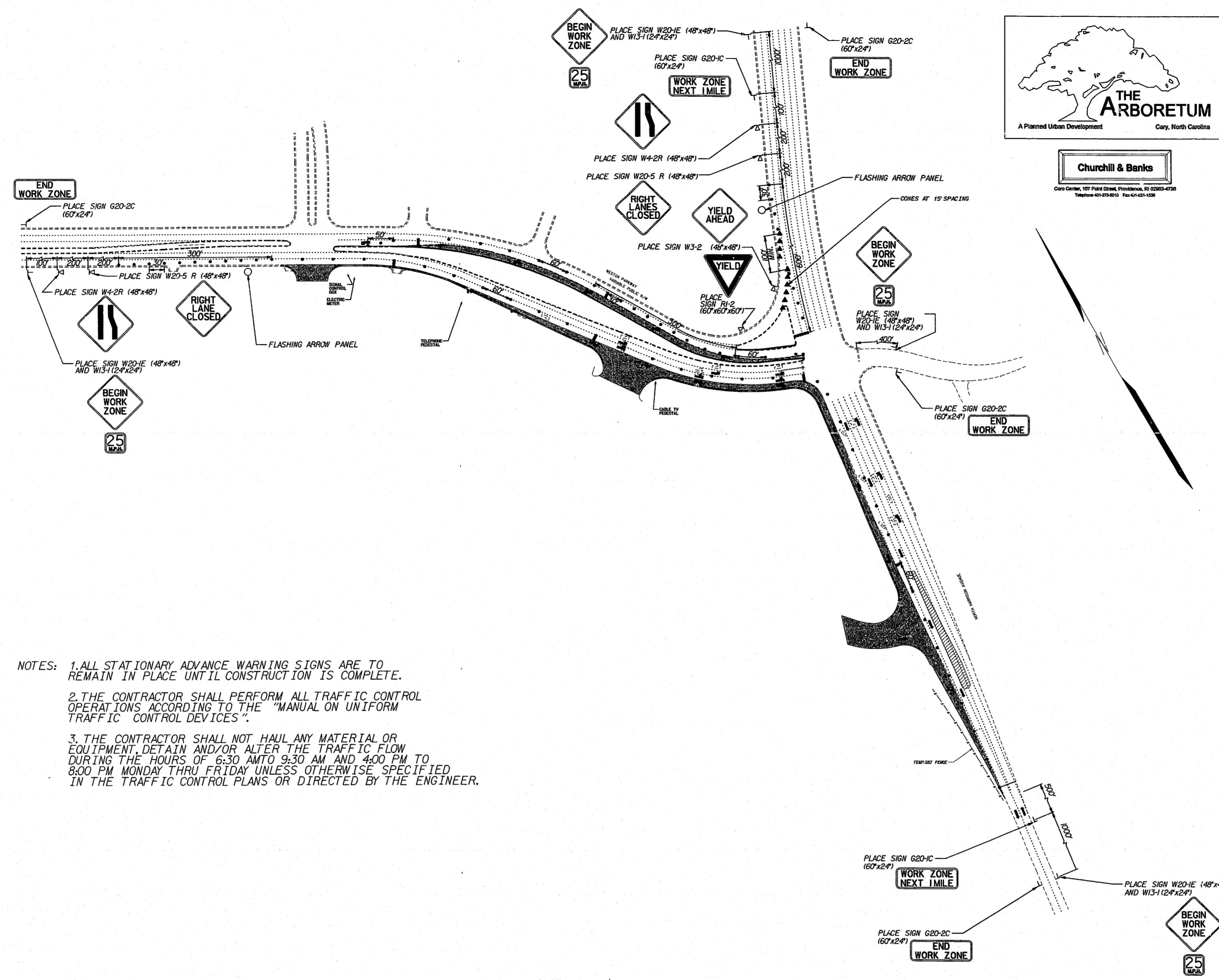

Churchill & Banks
 Caro Center, 187 Park Street, Providence, RI 02903-4738
 Telephone 401-279-8010 Fax 401-251-1039

NOTES: 1. ALL STATIONARY ADVANCE WARNING SIGNS ARE TO REMAIN IN PLACE UNTIL CONSTRUCTION IS COMPLETE.
 2. THE CONTRACTOR SHALL PERFORM ALL TRAFFIC CONTROL OPERATIONS ACCORDING TO THE "MANUAL ON UNIFORM TRAFFIC CONTROL DEVICES".
 3. THE CONTRACTOR SHALL NOT HAUL ANY MATERIAL OR EQUIPMENT, DETAIN AND/OR ALTER THE TRAFFIC FLOW DURING THE HOURS OF 6:30 AM TO 9:30 AM AND 4:00 PM TO 8:00 PM MONDAY THRU FRIDAY UNLESS OTHERWISE SPECIFIED IN THE TRAFFIC CONTROL PLANS OR DIRECTED BY THE ENGINEER.

98-SP-183
 APPROVED
 8/31/99
 JPP 9/2/99

NOTES:

REV. #	REV. BY	DATE	DESCRIPTION
1	8/24/99	AS PER TOWN OF CARY COMMENTS	

Charles M. Elam & Associates
 Urban Planning / Landscape Architecture
 675 Walnut Street - Suite 201 - Cary, North Carolina 27511
 919-487-0577 - FAX 919-487-0591

MCKIM & CREED
 5625 Dillard Road, Suite 117
 Cary, North Carolina

DRAWN: J. NICHOLS	PROJECT
DESIGN: J. NICHOLS	NUMBER: 1423-0002
CHECK: D. COCHRAN	SCALE: 1" = 100'
APPROVED: D. COCHRAN	DATE: 20 NOVEMBER 1999
FILE NAME: PLANTC2.DGN	

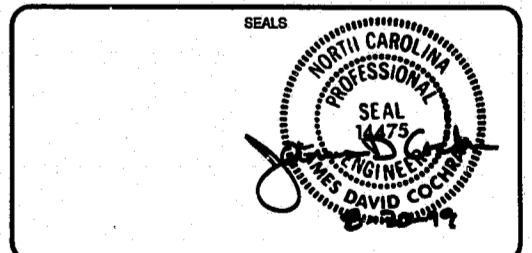

W. Marvin Widdo
KANE
 KANE REALTY CORPORATION
 400 NorthChase Boulevard, Suite 400
 Raleigh, North Carolina 27607
 919-833-1755 Fax 919-833-2143

THE ARBORETUM

Traffic Control
 Phase I for
 Roadway Modifications

CLIENT DRAWING NUMBER C17	MAC DRAWING NUMBER
-------------------------------------	--------------------