

LEGEND	
DRUM	•
CONE	▲
STATIONARY SIGN	T
PORTABLE SIGN	⊠
WORK AREA	

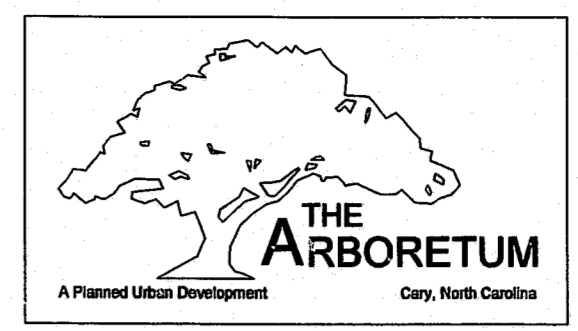
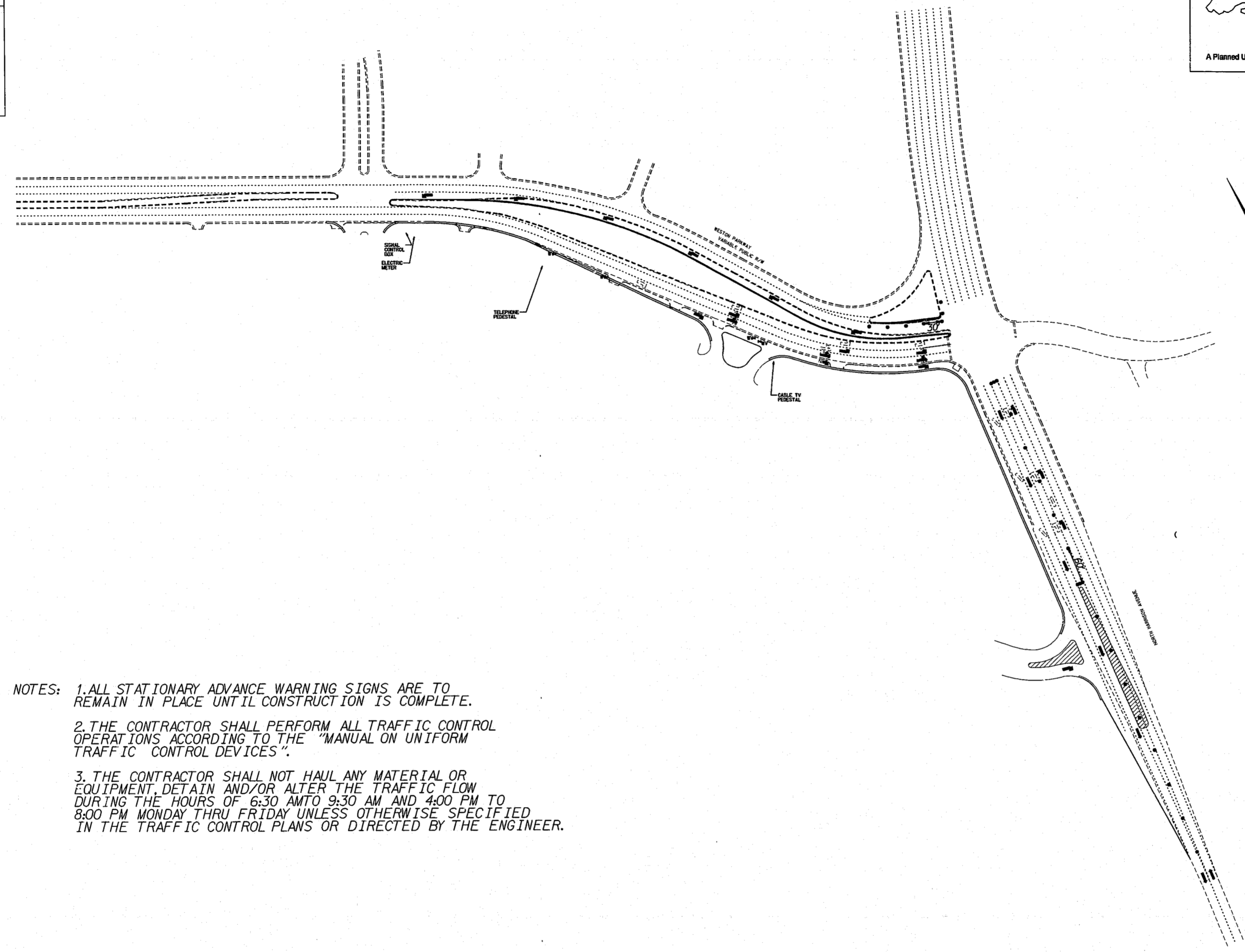

Churchill & Banks
 Caro Center, 107 Picket Street, Providence, RI 02903-4736
 Telephone 401-273-8010 Fax 401-221-1820

- NOTES:
1. ALL STATIONARY ADVANCE WARNING SIGNS ARE TO REMAIN IN PLACE UNTIL CONSTRUCTION IS COMPLETE.
 2. THE CONTRACTOR SHALL PERFORM ALL TRAFFIC CONTROL OPERATIONS ACCORDING TO THE "MANUAL ON UNIFORM TRAFFIC CONTROL DEVICES".
 3. THE CONTRACTOR SHALL NOT HAUL ANY MATERIAL OR EQUIPMENT, DETAIN AND/OR ALTER THE TRAFFIC FLOW DURING THE HOURS OF 6:30 AM TO 9:30 AM AND 4:00 PM TO 8:00 PM MONDAY THRU FRIDAY UNLESS OTHERWISE SPECIFIED IN THE TRAFFIC CONTROL PLANS OR DIRECTED BY THE ENGINEER.

NOTES:

REV. #	REV. BY DATE	DESCRIPTION
REVISIONS		

Charles M. Elam & Associates
 Urban Planning / Landscape Architecture
 875 Walnut Street - Suite 201 - Cary, North Carolina 27511
 919-487-0277 - FAX 919-487-0281

MCKIM & CREED
 5625 Dillard Road; Suite 117
 Cary, North Carolina

DRAWN: J. NICHOLS	PROJECT
DESIGN: J. NICHOLS	NUMBER: 1423-0002
CHECK: D. COCHRAN	SCALE: 1" = 100'
APPROVED: D. COCHRAN	DATE: 20 NOVEMBER 1998
FILE NAME: PLANTC.DGN	

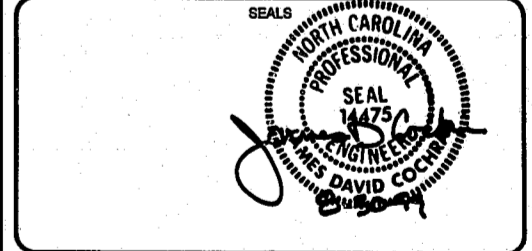

W. Marvin Waldo

KANE
 KANE REALTY CORPORATION
 4020 WestChase Boulevard, Suite 400
 Raleigh, North Carolina 27607
 919-433-7755 Fax 919-433-2143

THE ARBORETUM

**Traffic Control
 Phase II for
 Roadway Modifications**

CLIENT DRAWING NUMBER C18	M&C DRAWING NUMBER
-------------------------------------	--------------------

98-SP-183
APPROVED
 8/21/99
 Jvr 9/2/99