

VICINITY MAP
SCALE 1"=500'

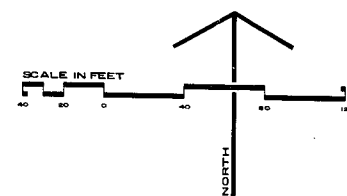

NOTE - ALL DRAINAGE INLETS SHALL BE SURROUNDED BY SILT FENCE IN ACCORDANCE WITH T.O.C. STD DETAIL NO. 2.01 DURING THE PERIOD OF CONSTRUCTION
REFER TO SHEET 5 FOR STORM DRAINAGE PROFILES

- CONSTRUCTION SEQUENCE**
1. OBTAIN GRADING PERMIT FROM TOWN OF CARY
 2. CLEAR ALL AREAS TO BE GRADED
 3. INSTALL SILT FENCE & CONST ACCESS PAD WHERE SHOWN
 4. CALL FOR INSPECTION BY TOWN OF CARY
 5. BRING BUILDING PADS TO GRADE & STONE
 6. BRING PARKING LOTS TO GRADE & STONE
 7. SEED & MULCH ALL UNIMPROVED, DISTURBED AREAS
 8. AFTER STABILIZATION OF ALL AREAS IS COMPLETED CALL FOR INSPECTION BY TOWN OF CARY
 9. AT COMPLETION OF SITEWORK REMOVE ALL TEMPORARY EROSION CONTROL DEVICES

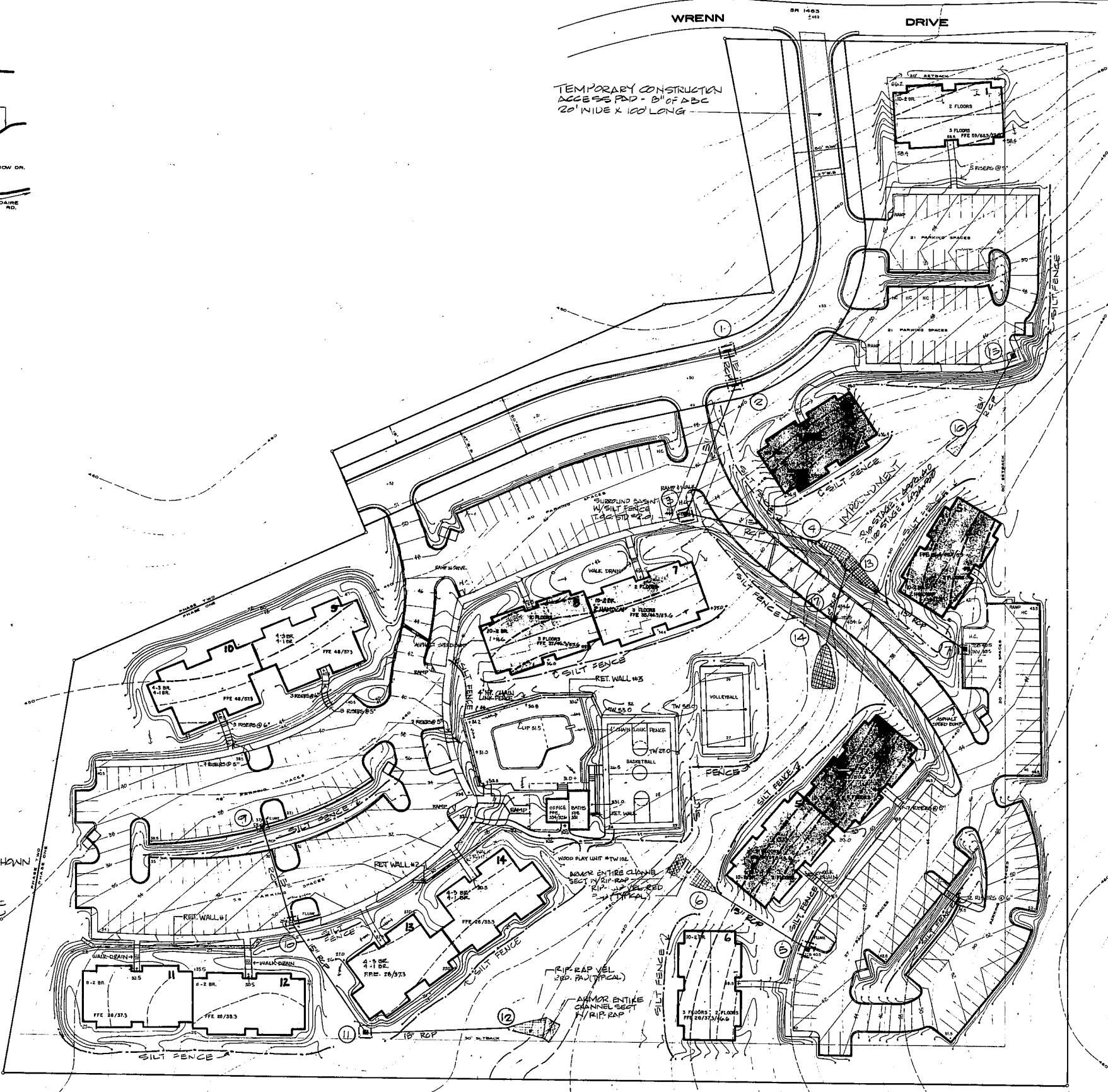

William G. Daniel and Associates
William G. Daniel, P.E.
Cary, North Carolina



REVISIONS:
2/20/01
2/19/01
11/15/00
10/22/00

PATON ASSOCIATES
LANDSCAPE ARCHITECTURE / SITE PLANNING
214 EAST CHATHAM STREET
CARY, NORTH CAROLINA 27511

GRADING & STORM DRAINAGE
ASHTON WOODS APARTMENTS
CARY, NORTH CAROLINA
ASHTON WOODS ASSOCIATES