

BUILDING #7 AND #8

**foundation plan 01**

SCALE - 1/8" = 1'-0"

← BUILDING NUMBER 7 BUILDING NUMBER 8 →

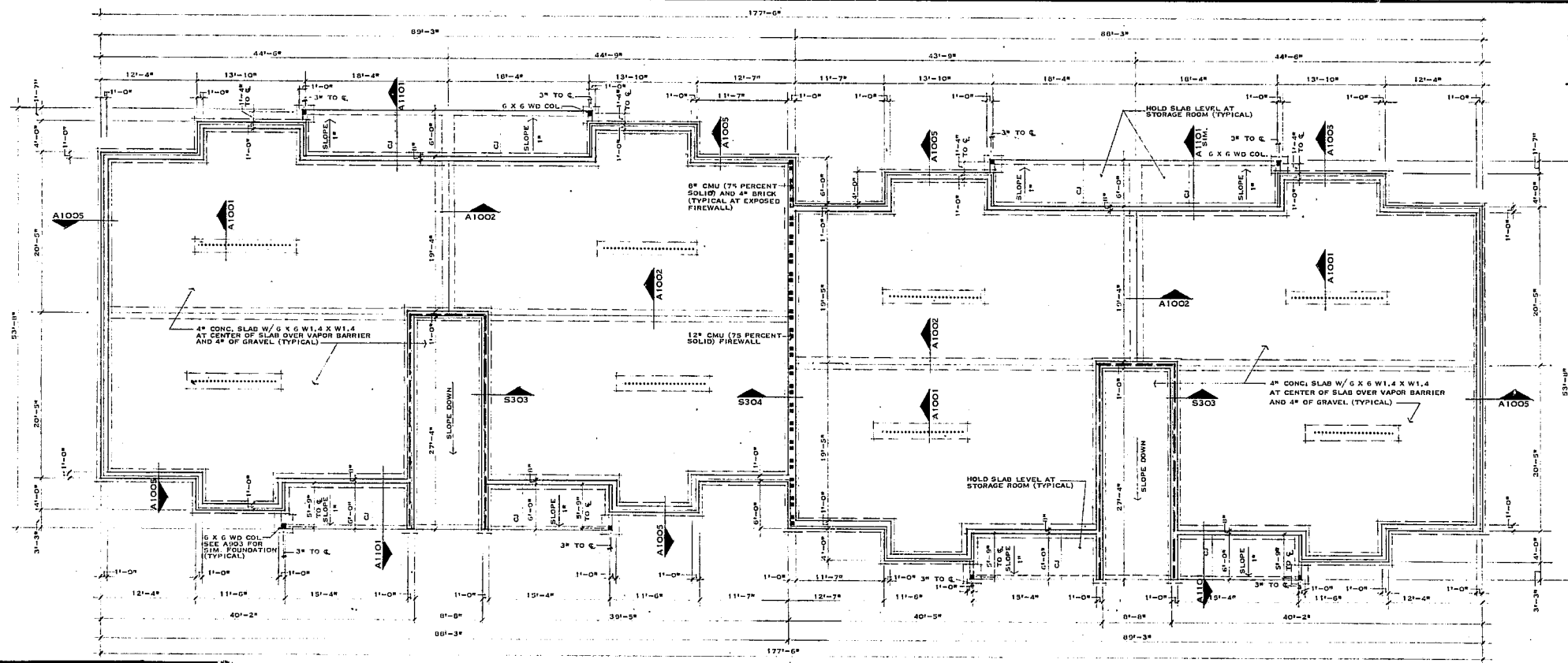

BUILDING #11 AND #12

**foundation plan 02**

SCALE - 1/8" = 1'-0"

← BUILDING NUMBER 12 BUILDING NUMBER 11 →



revisions

REVISED	MARCH 2, 1981
---------	---------------

**atai**

**architects associates inc**  
 fred tolson  
 suite 200 3301 executive drive  
 raleigh, n. c. 27609 919-876-8400

**architects fred tolson**

project  
 ASHTON WOODS APARTMENTS  
 owner  
 ASHTON WOODS ASSOCIATES  
 location  
 CARY, N. C.  
 job number  
 8002-04  
 drawn by  
 ATAI  
 date  
 NOVEMBER 1980  
 FOUNDATION PLANS

ISSUED FOR CONSTRUCTION  
 MARCH 2, 1981

SHEET NUMBER  
**S2**  
 OF 6 SHEETS

THIS DOCUMENT IS THE PROPERTY OF ARCHITECTS FRED TOLSON ASSOCIATES, INC. TO REUSE THIS DOCUMENT FOR ANY PURPOSE OTHER THAN THE EXECUTION OF THE ABOVE TITLED PROJECT IS PROHIBITED WITHOUT PRIOR WRITTEN PERMISSION OF THE ARCHITECT. RETURN ALL COPIES TO THE ARCHITECT UPON REQUEST.