

VICINITY MAP
SCALE: 1" = 500'

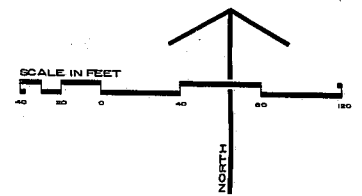

NOTE - ALL DRAINAGE INLETS SHALL BE SURROUNDED BY SILT FENCE IN ACCORDANCE W/ T.O.C. STD DETAIL NO. 2.01 DURING THE PERIOD OF CONSTRUCTION

- CONSTRUCTION SEQUENCE**
1. OBTAIN GRADING PERMIT FROM TOWN OF CARY
 2. CLEAR ALL AREAS TO BE GRADED
 3. INSTALL SILT FENCE & CONST ACCESS PAD WHERE SHOWN
 4. CALL FOR INSPECTION BY TOWN OF CARY
 5. BRING BUILDING PADS TO GRADE & STONE
 6. BRING PARKING LOTS TO GRADE & STONE
 7. SEED & MULCH ALL UNIMPROVED, DISTURBED AREAS
 8. AFTER STABILIZATION OF ALL AREAS IS COMPLETED CALL FOR INSPECTION BY TOWN OF CARY
 9. AT COMPLETION OF SITEMARK REMOVE ALL TEMPORARY EROSION CONTROL DEVICES

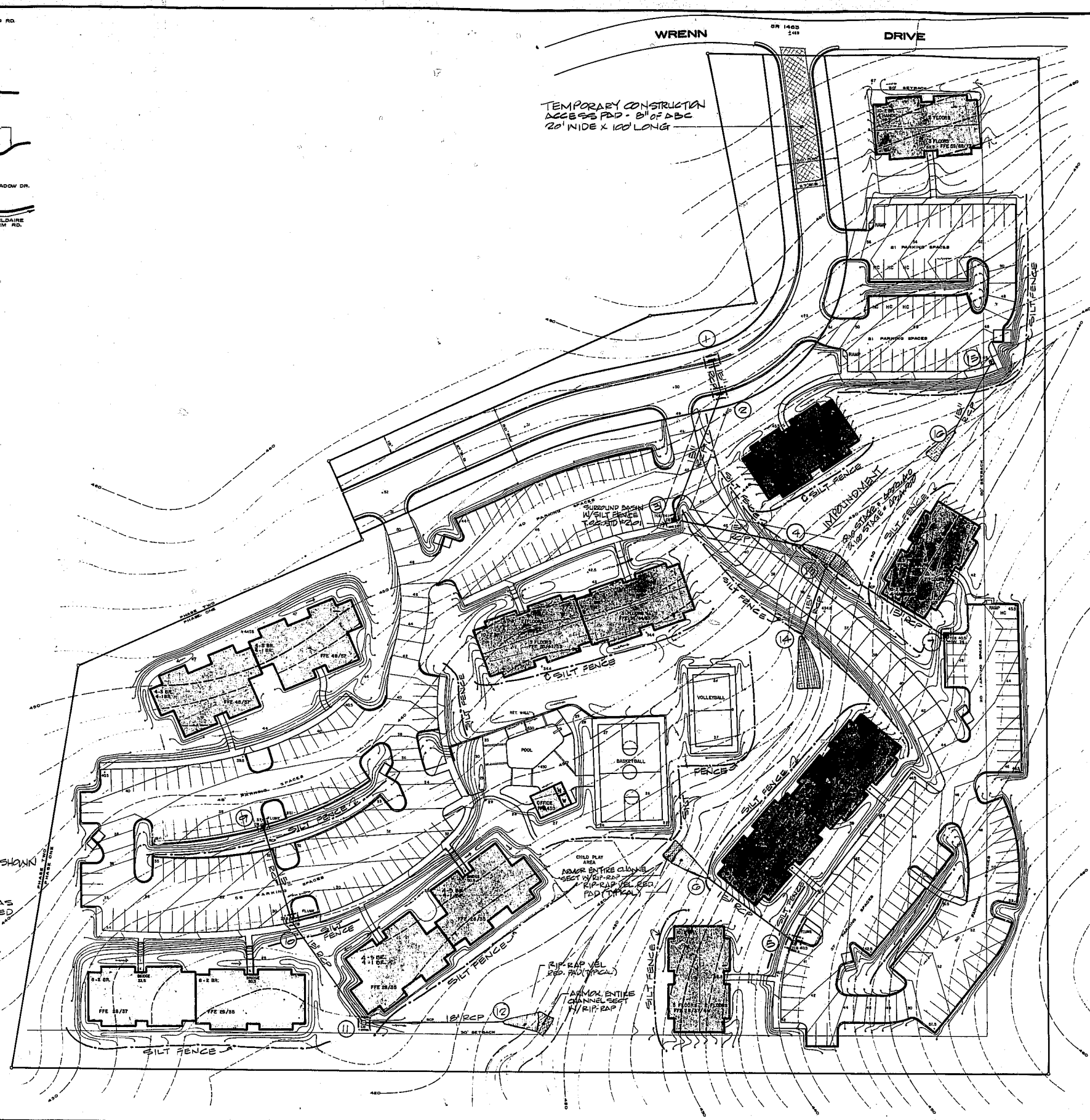

William G. Daniel and Associates
 William G. Daniel, P.E.
 Cary, North Carolina

REVISIONS:
10/24/80

PATON ASSOCIATES
 LANDSCAPE ARCHITECTURE / SITE PLANNING
 214 EAST CHATHAM STREET
 CARY, NORTH CAROLINA 27511

GRADING & STORM DRAINAGE
ASHTON WOODS APARTMENTS
 CARY, NORTH CAROLINA
 ASHTON WOODS ASSOCIATES