

PLANT LIST

QUANT.	BOTANICAL	COMMON	SIZE	ROOT	REMARKS
TREES					
6	ACER RUBRUM	RED MAPLE	10-12' 5-6' 2 1/2"	B&B	
20	CORNUS FLORIDA	FLOWERING DOGWOOD	6-8' 3-4'	B&B	
23	ILEX VOMITORIA	YAUPOH HOLLY	5-6' 2-3'	B&B	
14	KOELREUTERIA PANICULATA	GOLDENRAIN TREE	6-8' 3-4'	B&B	
19	LAGERSTROEMIA INDICA	CRAPE MYRTLE	6-8' 4-5'	B&B	3 TRUNK MIN. RED.
8	ERIODORVA JAPONICA	LOQUAT	3-3 1/2' 24-30"	CONT.	PLANT AGAINST FENCE
11	MAGNOLIA VIRGINIANA	SWEETBAY	5-6' 2-3'	B&B	
17	PRUNUS CAROLINIANA	CHERRY LAUREL	4-5' 2-3'	B&B	
5	QUERCUS PHELLOS	WILLOW OAK	10-12' 5-6' 2 1/2"	B&B	
4	QUERCUS RUBRA	NORTHERN RED OAK	10-12' 5-6' 2 1/2"	B&B	
1	TILIA CORDATA	LITTLELEAF LINDEN	10-12' 5-6' 2 1/2"	B&B	
3	TSUGA CAROLINIANA	CAROLINA HEMLOCK	5-6' 3-4'	B&B	
SHRUBS AND GROUNDCOVERS					
7	CLEYERA JAPONICA	CLEYERA	18-24" 18-24"	CONT.	
200	HEDERA HELIX	IVY	2 1/2" POTS		
15	ILEX CRENATA 'CONVEXA'	CONVEX LEAF HOLLY	2-2 1/2' 2-2 1/2'	CONT.	
32	ILEX CRENATA 'REPANDENS'	REPANDENS HOLLY	18-24" 2 1/2-3'	CONT.	
25	FORSYTHIA SUSPensa	WEeping FORSYTHIA	18-24" 3-3 1/2'	CONT.	
35	ILEX CORNUTA 'BURFORDII'	BURFORD HOLLY	2-2 1/2' 2-2 1/2'	CONT.	
44	I. CORNUTA 'BURFORDII NANA'	DWARF BURFORD HOLLY	18-24" 15-18"	CONT.	
52	JUNIPERUS CHINENSIS 'PFIETZERIANA COMPACTA'	DWARF PFIETZER JUNIPER	2-2 1/2' 2-2 1/2'	CONT.	
252	J. CONFERTA 'BLUE PACIFIC'	BLUE PACIFIC JUNIPER	6-10" 1 1/2-2"	CONT.	3" O.C.
230	LIRIOPE SPICATA	LIRIOPE		1 GAL.	12" O.C.
45	MYRTICA CERIFERA	WAX MYRTLE	3-3 1/2' 3-3 1/2'	CONT.	
7	OSMANTHUS FRAGRANS	FRAGRANT TEA OLEAF	3-3 1/2' 2-2 1/2'	CONT.	
11	SANTOLINA CHAMAECYPARISSUS	LAVENDER-COTTON	8-12" 18-24"	CONT.	
12	VIBURNUM RHYTIDOPHYLLUM	LEATHER-LEAF VIBURNUM	3-3 1/2' 2-2 1/2'	CONT.	
12	VIBURNUM VIRGINIS	LAURESTINUS	3-3 1/2' 12-18"	CONT.	

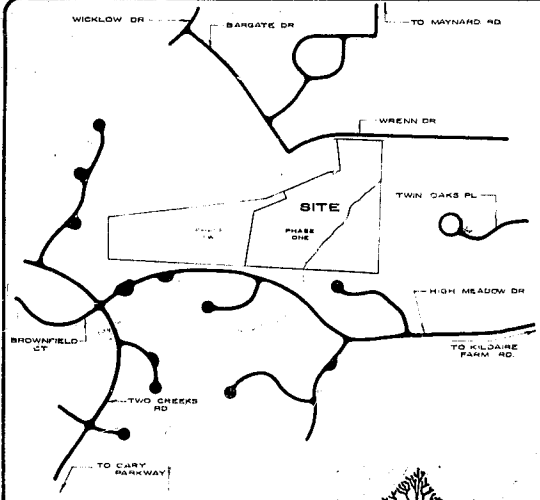

VICINITY MAP
SCALE 1"=100'

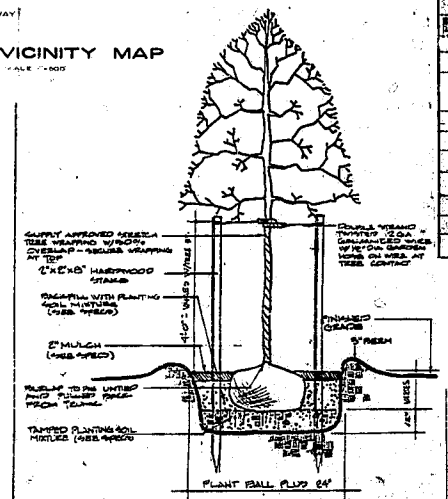

SMALL TREE PLTG
NO. SCALE

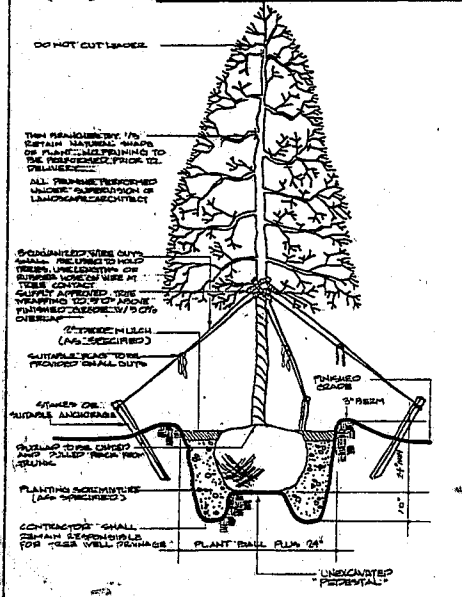

TREE PLANTING
NO. SCALE

SHRUB PLANTING
NO. SCALE

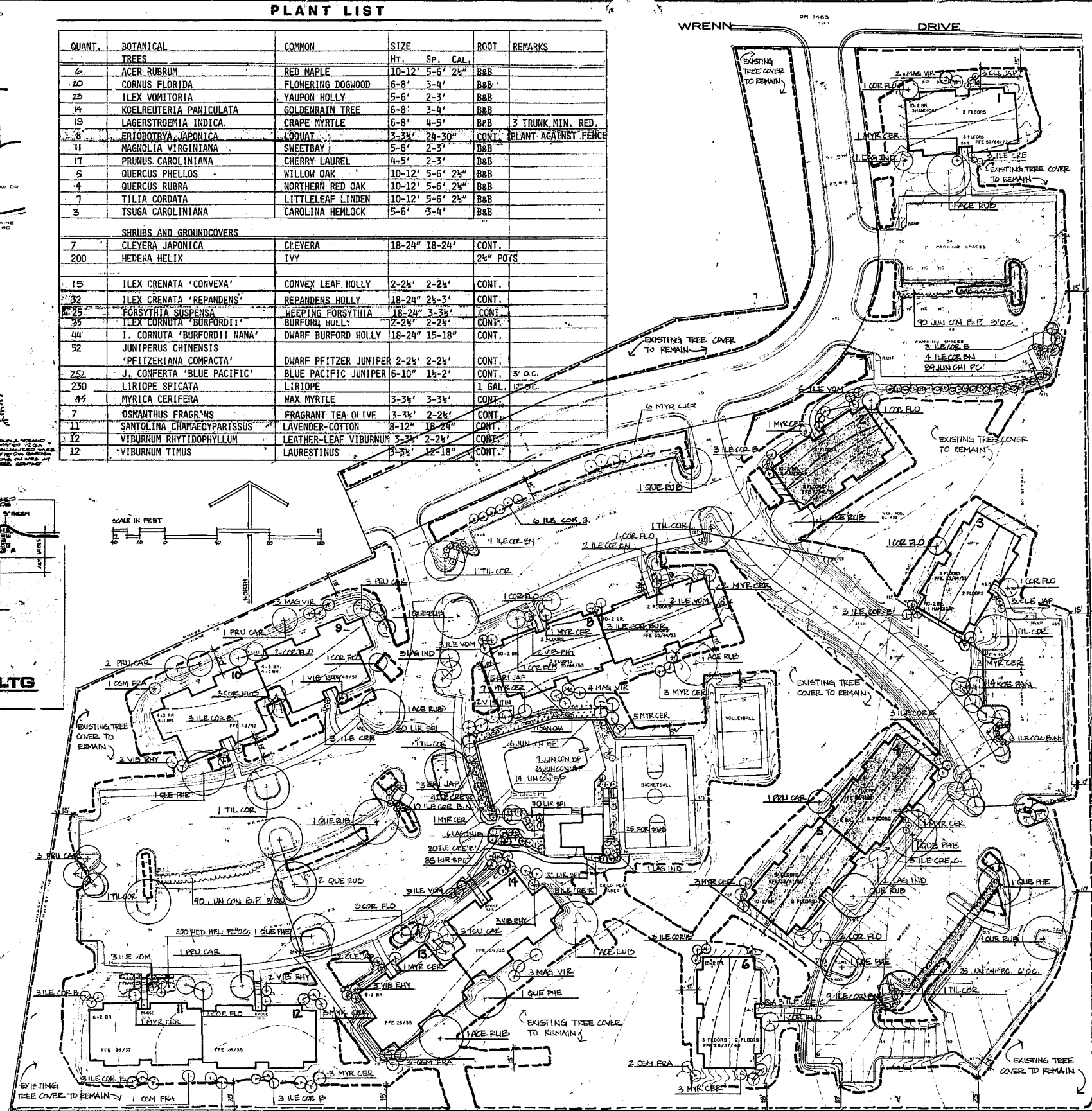

LAWN PREPARATION:
Cultivation: Cultivate all lawn areas.

LAWN PREPARATION:
Cultivation: Cultivate all lawn areas to a minimum depth of four inches, removing all loose rocks, stones, trash and debris. Roll and rake to a smooth friable condition suitable for planting.

Lime: Include dolomitic limestone at the rate of two tons per acre and thoroughly mix to a depth of 4".

Fertilization: Apply a balanced fertilizer (5-10-10) at the rate of 1400 lbs/acre at the time of planting with sufficient time laps between liming and fertilizing to prevent chemical reaction.

LAWN: All areas of disturbed and/or destabilized soil not otherwise noted shall be referred to as lawn and shall be seeded with the following mixture:
Kentucky 31 Tall Fescue

Seeding: Rate shall be 5 lbs/1000 square feet (220 lbs/acre). Grass shall be planted in such a fashion as to give a uniform cover of seed over the specified area.

Mulch: Lawn areas shall be covered after seeding with clean wheat straw at 30 bales (60 lbs.) per acre and all banks exceeding 4:1 slopes at the rate of one 60 lb. bale per 800 sq. ft. to aid in germination and to prevent erosion.

TREES AND SHRUBS: All trees to have straight, strong main trunk and full growth habit. All plants to be mulched minimum 18" from trunk/stem with a minimum 2" depth of pine bark mulch. All plants shall be healthy, free of pests and diseases, and shall have habits of growth typical of the species. Requirements for the quality and handling of plants shall be as recommended in the American Standards for Nursery Stock.

STABILIZATION OF SEEDED SLOPES AND DRAINAGE SWALES:
In addition to standard criteria indicated in the specifications, the following will be required:
All seeded banks having slopes of over 3:1, and all drainage swales shall be seeded with the following mixture:
Kentucky 31 Tall Fescue: 10 lbs/1000 sq. ft.
Rye (except June-Sept.): 5 lbs/1000 sq. ft.
Lespedeza: 1 lb./1000 sq. ft.

These areas shall be mulched with wheat straw at the rate of (1) 60 lb. bale/500 sq. ft., and be covered with overlapped jute matting securely stapled at all edges. Frequent light watering in these areas will be required until lawn is established.

NOTE: Should specifications vary from above data, the higher standard shall prevail.

□ Outline of existing tree cover to remain.

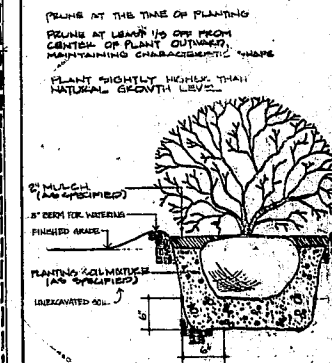

REVISIONS:
3/17/83
2/20/81
11/10/80
10/16/80

PATON ASSOCIATES
LANDSCAPE ARCHITECTURE / SITE PLANNING
214 EAST CHATHAM STREET, CARY, NORTH CAROLINA 27511

PLANTING WOODS APARTMENTS
ASHTON WOODS ASSOCIATES
CARY, NORTH CAROLINA