

STORM DRAINAGE DEVICE		LENGTH OF APRON		PIPE		ELEVATIONS		REMARKS
TYPE & NO.	Q	Total	DIAMETER	VEL.	HW	RIM or INVERT	INV.	
CI 1	1.0	1.0	15" R.C.P.	5.0	3.1	CI 1	451.54	
CI 2	2.1	4.0	60" P.I.	1.0%	5.8	CI 2	449.88	447.08
FES. 1	4.0	4.0	15" FES	5.8		FES. 1	448.40	448.40

NOTE: CI (Curb Inlet Top) ELEVATIONS are identical to elevations of adjacent top of curb.

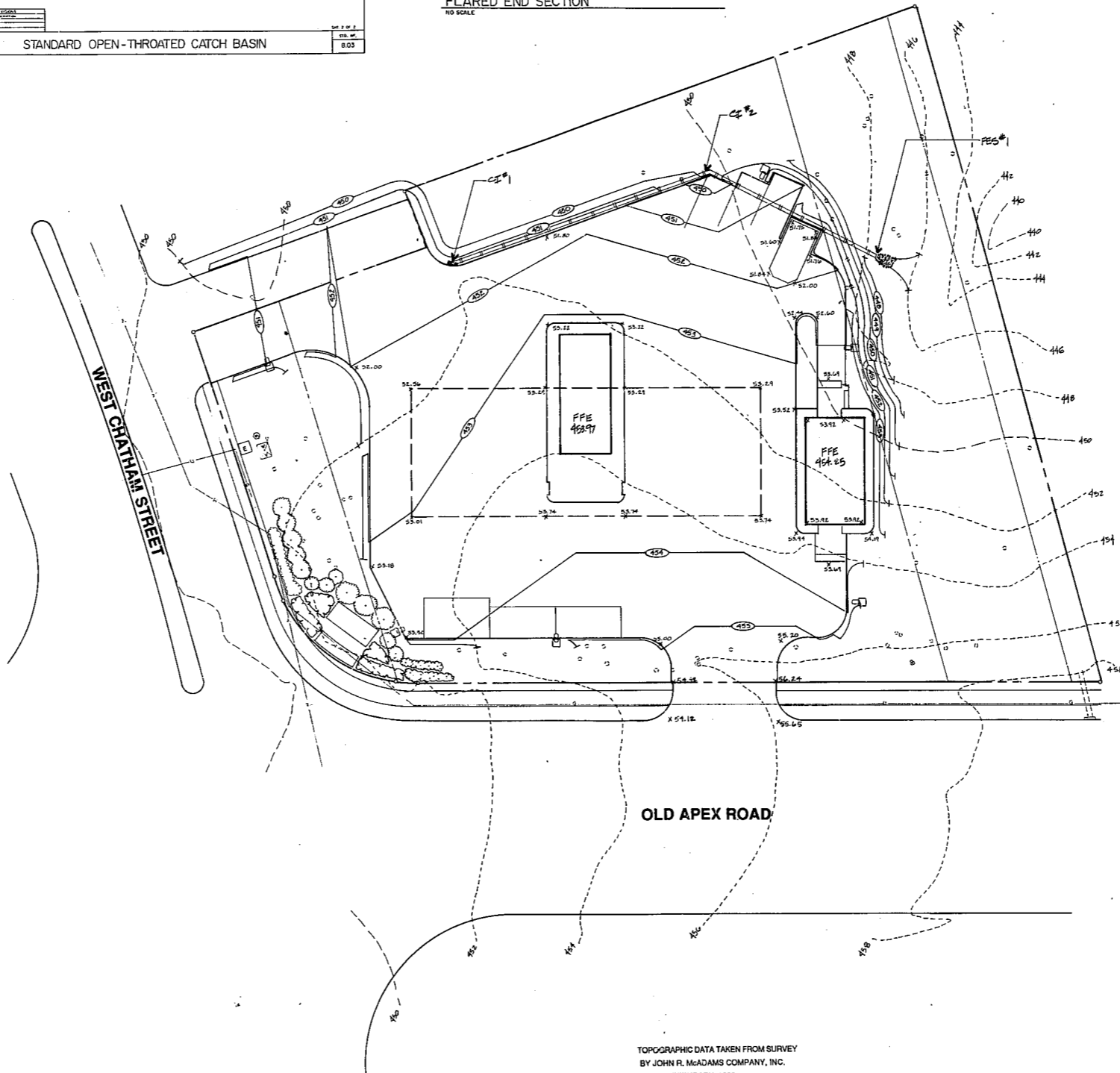

TOPOGRAPHIC DATA TAKEN FROM SURVEY
BY JOHN R. McADAMS COMPANY, INC.
DATED: FEBRUARY 1989



FACILITY AT
OLD APEX & WEST CHATHAM
CARY, NORTH CAROLINA
B.P. OIL COMPANY

Grading



Date
1 FEBRUARY 1990
15 MARCH 1990 (1st REVIEW)
6 APRIL 1990 (2nd REVIEW)

Sheet: **LA-1**

Job Number: 3800 DK

42- 890-053
5/1/91
5/17/91