

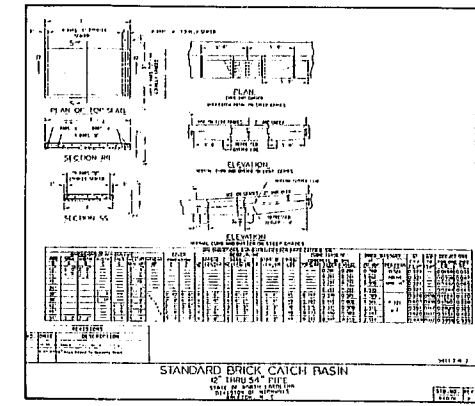

Revisions  
JUNE 24, 1987  
1<sup>st</sup> T.O.C. REVIEW COMMENTS  
JULY 9, 1987  
2<sup>nd</sup> T.O.C. REVIEW COMMENTS

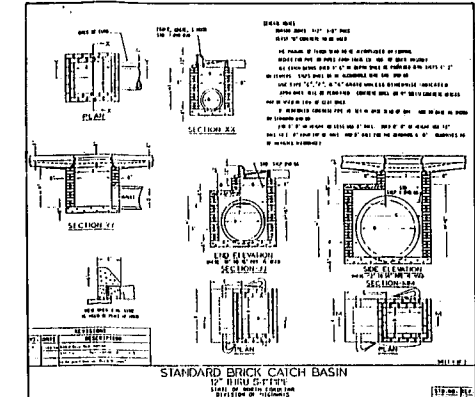
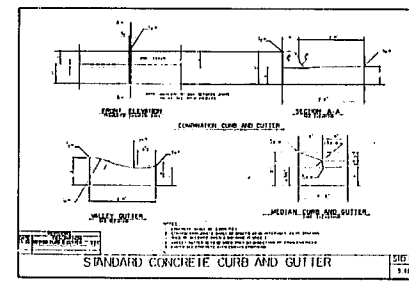
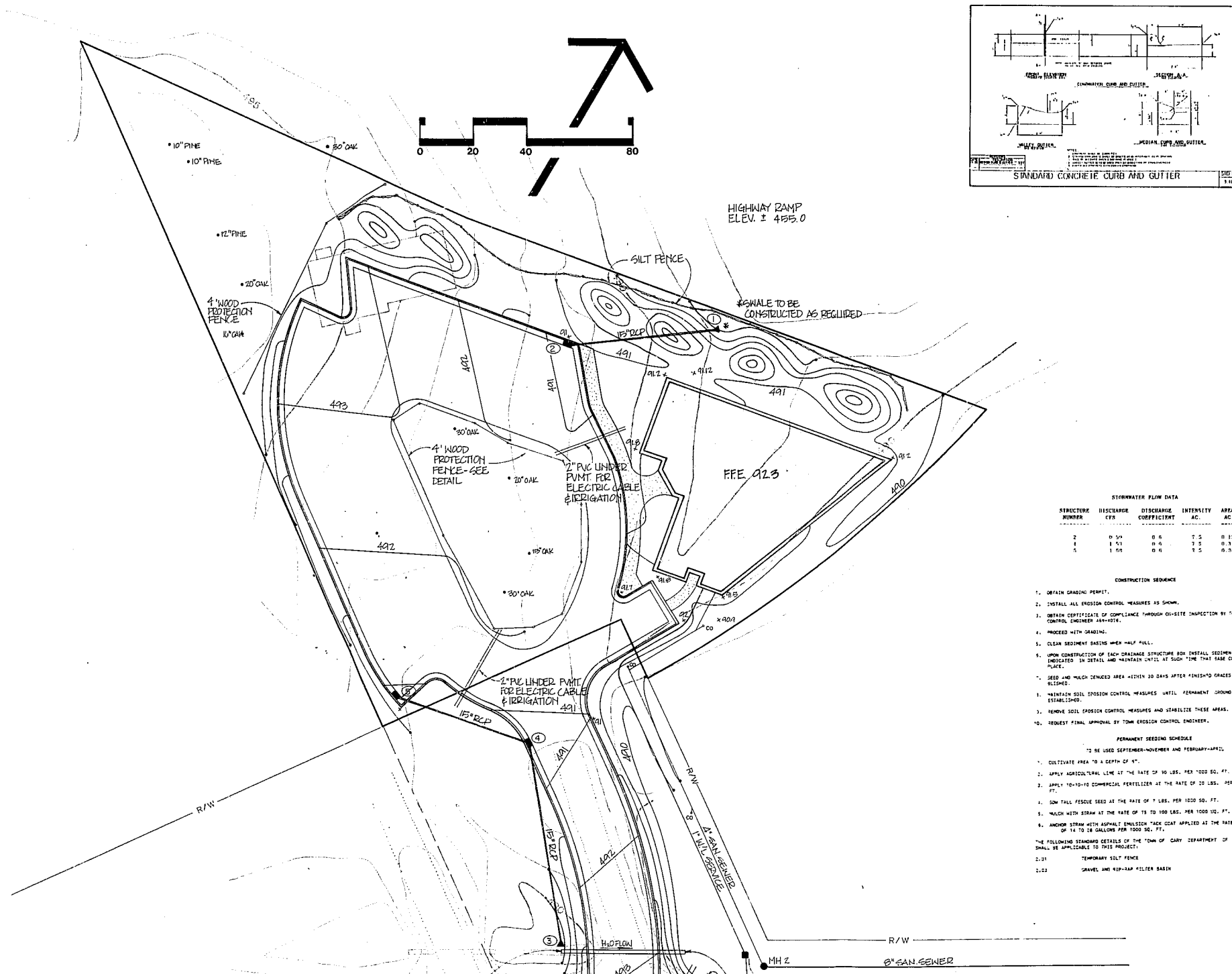

STORMWATER FLOW DATA

STRUCTURE NUMBER	DISCHARGE CFS	DISCHARGE COEFFICIENT	INVERT ELEV. AC.	AREA AC.
2	0.54	0.6	7.5	0.33
4	0.53	0.6	7.5	0.34
5	1.54	0.6	7.5	0.34

- CONSTRUCTION SEQUENCE
- OBTAIN GRADING PERMIT.
  - INSTALL ALL EROSION CONTROL MEASURES AS SHOWN.
  - OBTAIN CERTIFICATE OF COMPLIANCE THROUGH ON-SITE INSPECTION BY TOWN EROSION CONTROL ENGINEER REPRESENTATIVE.
  - PROCEED WITH GRADING.
  - CLEAN SEDIMENT BASINS WHEN HALF FULL.
  - UPON COMPLETION OF EACH DRAINAGE STRUCTURE SOON INSTALL SEDIMENT FILTER AS INDICATED IN DETAIL AND MAINTAIN UNTIL AT LEAST THE FIRST RAIN COMES TO PLACE.
  - SEED AND MULCH DENuded AREA WITHIN 20 DAYS AFTER FINISHING GRADES ARE ESTABLISHED.
  - MAINTAIN SOIL EROSION CONTROL MEASURES UNTIL PERMANENT GRASS COVER IS ESTABLISHED.
  - REMOVE SOIL EROSION CONTROL MEASURES AND STABILIZE THESE AREAS.
  - REQUEST FINAL APPROVAL BY TOWN EROSION CONTROL ENGINEER.

- PERMANENT SEEDING SCHEDULE
- TO BE USED SEPTEMBER-NOVEMBER AND FEBRUARY-APRIL
- CULTIVATE AREA TO A DEPTH OF 4".
  - APPLY AGRI-CULTURAL LIME AT THE RATE OF 50 LBS. PER 1000 SQ. FT.
  - APPLY 10-10-10 COMMERCIAL FERTILIZER AT THE RATE OF 20 LBS. PER 1000 SQ. FT.
  - SOFT FALL FESCUE SEED AT THE RATE OF 1 LBS. PER 1000 SQ. FT.
  - MULCH WITH STRAW AT THE RATE OF 75 TO 100 LBS. PER 1000 SQ. FT.
  - ANCHOR STRAW WITH ASPHALT EMULSION TACK COAT APPLIED AT THE RATE OF 14 TO 24 GALLONS PER 1000 SQ. FT.
- THE FOLLOWING STANDARD DETAILS OF THE TOWN OF CARY DEPARTMENT OF ENGINEERING SHALL BE APPLICABLE TO THIS PROJECT.
- 2.01 TEMPORARY SILT FENCE
  - 2.02 GRAVEL AND RIP-RAP FILTER BASIN

TEMPORARY SEDIMENT BASIN AND OUTLET PROTECTION DIMENSIONS

Structure	Desired Flow (cfs)	Flow Velocity (ft/s)	Basin Length (ft)	Basin Width (ft)	Basin Depth (ft)	Outlet Length (ft)	Outlet Width (ft)
1	0.12	0.4	220	3	11	11	10
2	0.24	0.1	420	3	11	11	10

STORMWATER COLLECTION SYSTEM

Summary of Pipes

FROM	TO	DIAMETER (INCHES)	LENGTH (FEET)	SLOPE	INVERT ELEVATION (FEET)	OUTLET ELEVATION (FEET)
1	2	18	50	0.38	0.860	0.860
2	4	18	70	0.33	0.823	0.823
3	5	18	50	1.34	0.500	0.480

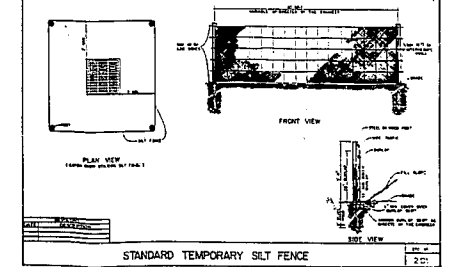
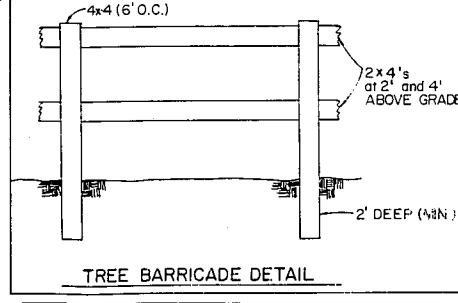
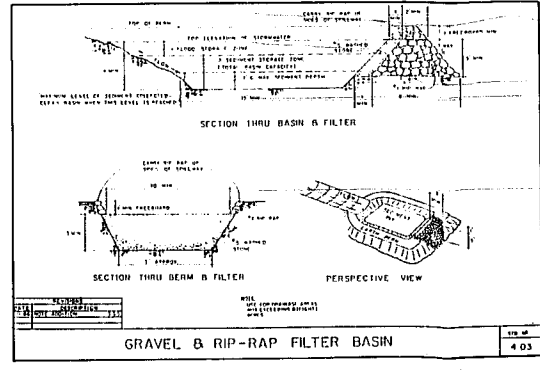

- NOTES:
- WOOD PROTECTION FENCE AROUND TREE SAVES AREAS MUST BE CONSTRUCTED BY CONTRACTOR & APPROVED BY LANDSCAPE ARCHITECT BEFORE ANY CLEARING & GRADING EQUIPMENT CAN BE BROUGHT ON SITE.
  - NO GRADING, STORAGE, DUMPING, VEHICULAR OR PEDESTRIAN ACTIVITY SHALL OCCUR WITHIN THE PROTECTION FENCE AREAS.
  - WHERE POSSIBLE, PROTECTION FENCE SHALL BE PLACED 1" CUT FROM TRUNK OF TREE FOR EVERY CALIPER INCH.

Project  
**BAKER-BROWN PROFESSIONAL BUILDING**

GRADING, UTILITIES, STORM DRAINAGE, EROSION CONTROL

Date  
JUNE 10, 1987

Scale  
1" = 20'

Sheet  
**2**