

Revisions

06/26/2014 Per ToC second review comments.

14-SB-007
 HTE # 14-1089
 Approved by the Town of Cary
 Development Review Committee

Planner: *R.H.H.* Date: *8/24/2014*

DEVELOPER:
 Premier Homes II, Inc
 8310 Bandford Way
 Raleigh, NC 27615
 919-781-4177

Project
**Balmoral
 at MacGregor**
 Subdivision and Site Plan

Queensferry Road
 (Alignment Reference Line)

Date
MARCH 13, 2002

Scale
 HORIZ: 1" = 50'
 VERT: 1" = 5'

Sheet
 23+00
5

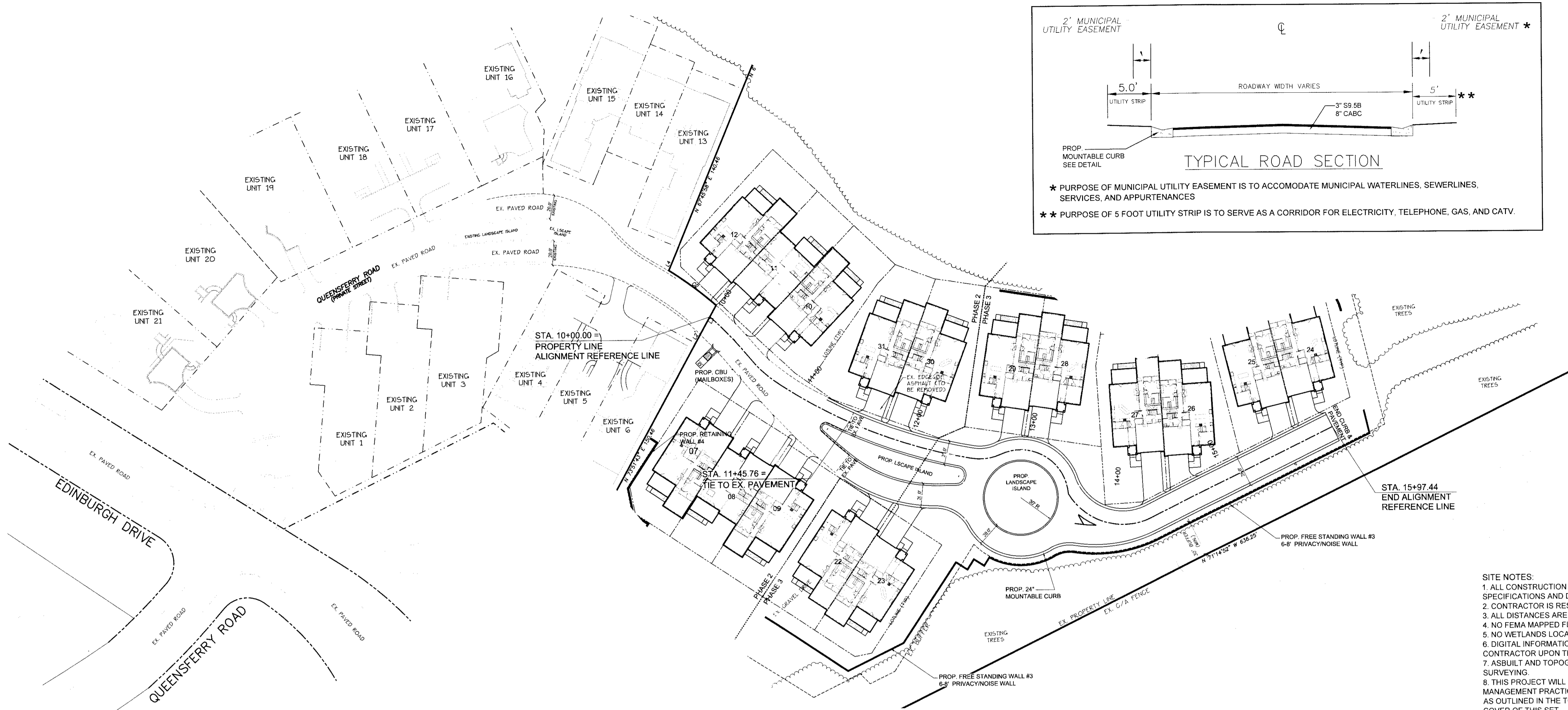
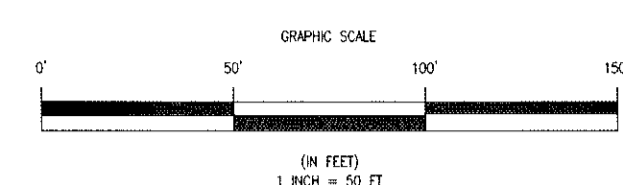
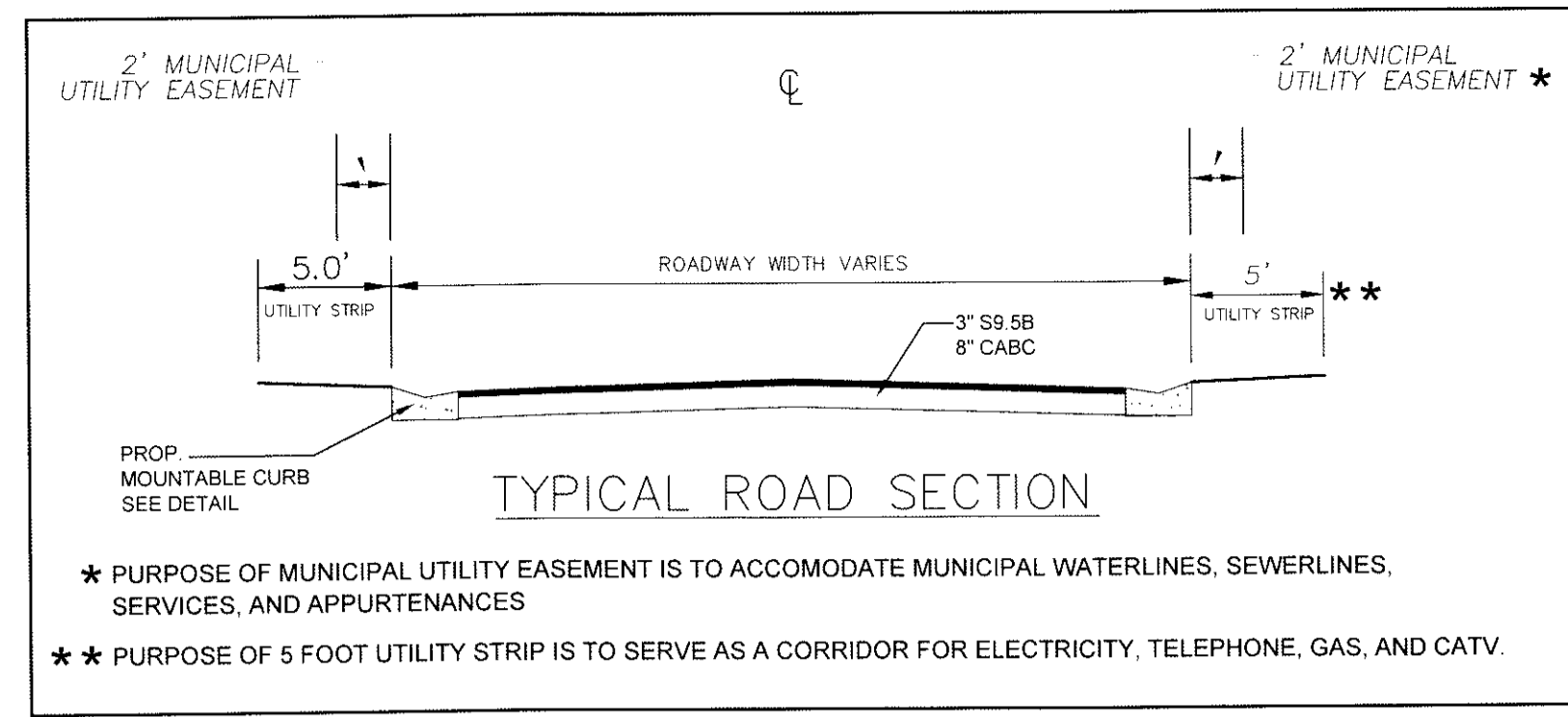

- SITE NOTES:**
1. ALL CONSTRUCTION TO BE IN ACCORDANCE WITH TOWN OF CARY STANDARD SPECIFICATIONS AND DETAILS.
 2. CONTRACTOR IS RESPONSIBLE FOR FIELD VERIFICATION OF ALL EXISTING UTILITIES.
 3. ALL DISTANCES ARE TO BACK OF CURB UNLESS OTHERWISE SPECIFIED.
 4. NO FEMA MAPPED FLOOD HAZARD AREAS LOCATED ON THIS SITE.
 5. NO WETLANDS LOCATED ON THIS SITE.
 6. DIGITAL INFORMATION AND A STAKING PLAN WILL BE PROVIDED TO THE CONTRACTOR UPON THEIR REQUEST.
 7. ASBUILT AND TOPOGRAPHIC INFORMATION WAS SURVEYED BY TURNING POINT SURVEYING.
 8. THIS PROJECT WILL MEET ALL OF THE REQUIREMENTS RELATIVE TO BEST MANAGEMENT PRACTICES AND ENGINEERED STORMWATER CONTROL STRUCTURES AS OUTLINED IN THE TOWN OF CARY LAND DEVELOPMENT ORDINANCE. SEE NOTE ON COVER OF THIS SET.
 9. NO TOPSOIL/SUBSOIL STOCKPILE AREA WILL BE REQUIRED.
 10. ALL STORM DRAIN FRAMES AND GRATES TO BE MARKED "DRAINS TO RIVER" IN ACCORDANCE WITH TOWN OF CARY STANDARD SPECIFICATIONS.
 11. A GRADING PERMIT WILL NOT BE ISSUED UNTIL THE TOWN OF CARY HAS RECEIVED NOTIFICATION FROM THE ECOSYSTEM ENHANCEMENT PROGRAM OR AN APPROVED NUTRIENT OFFSET BANK THAT A RECEIPT HAS BEEN ISSUED TO THE DEVELOPER AND THE LOCAL GOVERNMENT STATING THAT THE NITROGEN BUY-DOWN HAS BEEN COMPLETED.
 12. NO PORTIONS OF THIS SITE ARE SUBJECT TO NEUSE BASIN RIPARIAN BUFFER RULES.
 13. WHEELCHAIR RAMP LOCATIONS ARE APPROXIMATE ONLY. WHEELCHAIR RAMPS SHOULD BE LOCATED AND CONSTRUCTED IN ACCORDANCE WITH THE TOWN OF CARY AND NCDOT STANDARDS AFTER THE LOCATIONS OF THE PROPOSED STOP BARS AND/OR PEDESTRIAN CROSSWALKS HAVE BEEN STAKED OUT.
 14. ALL FIRE LANES TO BE INSTALLED PER TOWN OF CARY STANDARD 3050-D (THERMOPLASTIC PAINT REQUIRED)
 15. ALL SIGNS WILL USE PRISMATIC SHEETING AND WILL ADHERE TO THE RETROREFLECTIVITY STANDARDS FOUND IN THE LATEST EDITION OF THE MUTCD.

QUEENSFERRY ROAD

