

- NOTES:
- SANITARY SEWER:**
1. BACKLAP JOINTS SHALL BE PROVIDED FOR ALL UNITS WITH FINAL FLOOR ELEVATION OF BUILDING LESS THAN 3'-0" ABOVE FINISH.
 2. MINIMUM COVER DEPTH OF 3 FEET TO BE PROVIDED FOR ALL SANITARY SEWER COLLECTION LINES 4 INCHES AND LARGER.
 3. MINIMUM SLOPE FOR 4 INCH SANITARY SEWER COLLECTION LINES SHALL BE NO LESS THAN 1.00 VERT CLEANOUTS EVERY 50 LINEAL FEET.
 4. MINIMUM SLOPE FOR 6 INCH SANITARY SEWER COLLECTION LINES SHALL BE NO LESS THAN 0.80 VERT CLEANOUTS EVERY 100 LINEAL FEET.
- VEINS:**
1. VEIN MAIN TO BE INSTALLED AT A DEPTH WITH A MINIMUM COVER OF 36 INCHES, WITH 18 INCHES VERTICAL CLEARANCE BETWEEN FROM OTHER UNDERGROUND UTILITIES AND 18 FEET HORIZONTAL CLEARANCE FROM ALL OTHER UTILITIES.
 2. PRESSURE REDUCING VALVE SHALL BE PROVIDED IF PRESSURE IS IN EXCESS OF 80 PSI.
- GENERAL:**
1. ALL WATER AND SEWER MAINS WITHIN PUBLIC RIGHT-OF-WAY TO BE OPEN, OPERATED AND MAINTAINED BY THE PUBLIC AUTHORITY.
 2. ALL CONSTRUCTION TO BE OF THE LOCAL AUTHORITY STANDARD.
 3. ALL UNDERGROUND UTILITIES ARE APPROXIMATELY LOCATED. ACTUAL LOCATION AND DEPTH TO BE CONFIRMED IN FIELD BEFORE CONSTRUCTION.
 4. BEFORE STARTING ANY CONSTRUCTION OF IMPROVEMENTS WITHIN ANY CITY OR TOWN, STREET OR HIGHWAY RIGHT-OF-WAY THE FOLLOWING PROCEDURES SHOULD BE OBSERVED: CITY RIGHT-OF-WAY CONTACT LOCAL AUTHORITIES TRAFFIC ENGINEERING DEPT. FOR CLOSURE OR REDUCTION OF CLOSURE OF STREETS OR FOR ANY CONSTRUCTION WITHIN RIGHT-OF-WAY. N.C.D.O.T. RIGHT-OF-WAY CONTACT PROJECT ENGINEER AND OBTAIN ALL PERMITS AND ENCROACHMENT/DEEP CUTS OF CONSTRUCTION SITE. ALSO CONTACT N.C.D.O.T. DISTRICT OFFICE IN ADVANCE BEFORE PLACING CURB AND CUTTING.

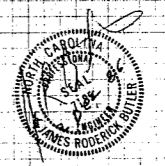
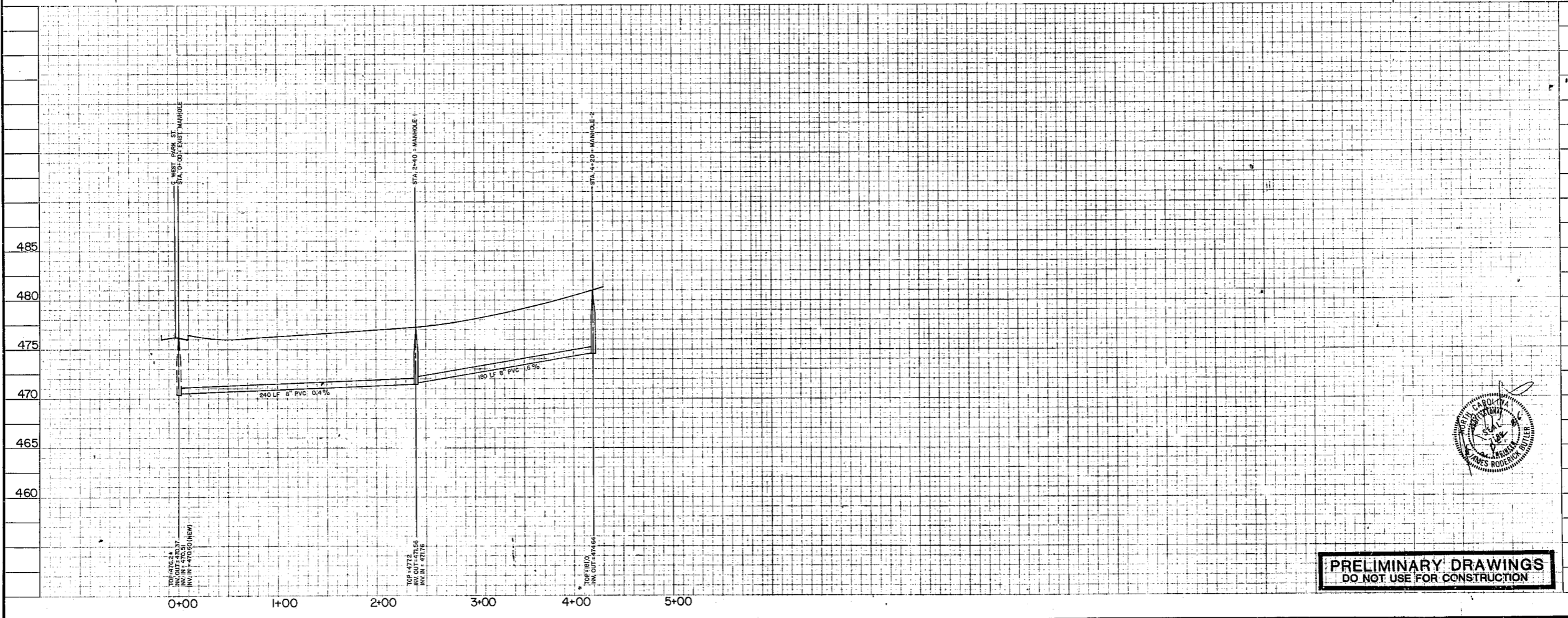

**PRELIMINARY DRAWINGS
DO NOT USE FOR CONSTRUCTION**

BANK

BASS, NI-LON & KENNEDY, INC., CONSULTING ENGINEERS
919 / 851-4422 / 7416 CHAPEL HILL ROAD, RALEIGH, N. C. 27607

**PARKSIDE RESIDENTIAL CONDOMINIUM AND
COMMERCIAL DEVELOPMENT**
CARY, NORTH CAROLINA

SCALE: HOR. 1" = 50' VERT. 1" = 5'

NO. DATE NO. DATE
REVISIONS

DESIGNED BY: DATE: DRAWN BY: DATE:

PLAN AND PROFILE

SHEET 3 OF 5