

SHIRLEY O LIGGINS
ZONING: R20
CURRENT USE: VACANT
PIN#: 0772-26-5872
PARCEL AREA: 0.57 AC

BISHOP BYZANTINE CATHOLIC
DIOCESE OF PASSAIC
ZONING: R20
CURRENT USE: SINGLE FAMILY
PIN#: 0772-26-7787
PARCEL AREA: 1.44 AC

VIOLA S CAMPBELL
ZONING: R20
CURRENT USE: SINGLE FAMILY
PIN#: 0772-36-1843
PARCEL AREA: 0.63 AC

HJ FAMILY PROPERTIES LLC
ZONING: R20
CURRENT USE: VACANT
PIN#: 0772-36-1714
PARCEL AREA: 0.68 AC

HJ FAMILY PROPERTIES LLC
ZONING: R20
CURRENT USE: SINGLE FAMILY
PIN#: 0772-36-3914
PARCEL AREA: 1.03 AC

BYZANTINE CATHOLIC DIOCESE OF
PASSAIC
ZONING: R40
CURRENT USE: CHURCH
PIN#: 0772-26-6570
PARCEL AREA: 1.34 AC

REBECCA G PRINCE
ZONING: R20
CURRENT USE: SINGLE FAMILY
PIN#: 0772-36-1615
PARCEL AREA: 0.75 AC

MARY E METTLER
ZONING: R20
CURRENT USE: VACANT
PIN#: 0772-36-1553
PARCEL AREA: 0.48 AC

MARY E METTLER
ZONING: R20
CURRENT USE: SINGLE FAMILY
PIN#: 0772-36-3574
PARCEL AREA: 0.51 AC

MARY E METTLER
ZONING: R20
CURRENT USE: VACANT
PIN#: 0772-36-2574
PARCEL AREA: 0.50 AC

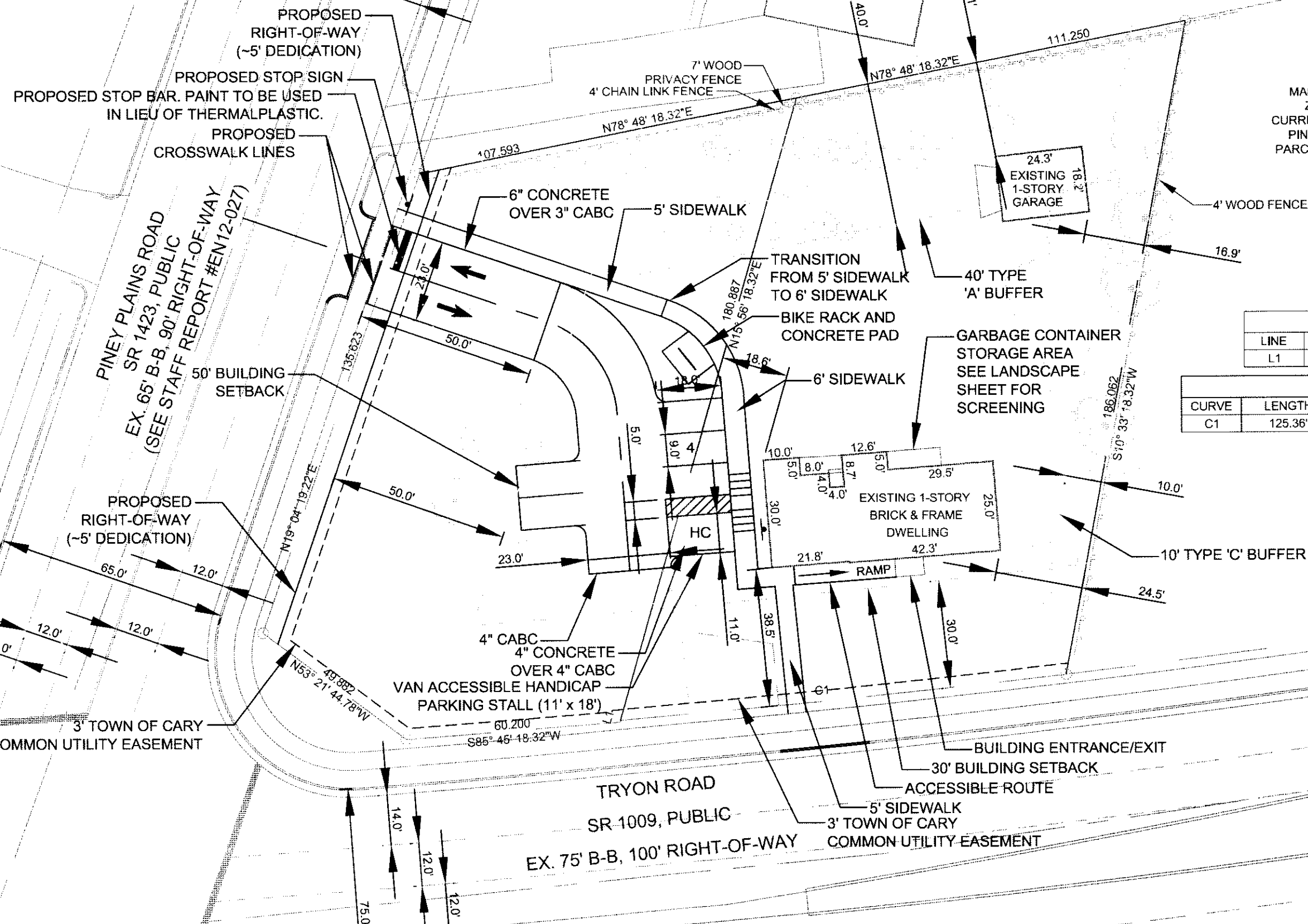

LINE TABLE		
LINE	LENGTH	BEARING
L1	0.46'	S15°56'18.29"W

CURVE TABLE			
CURVE	LENGTH	RADIUS	DELTA
C1	125.36'	4531.62'	1°58'50"

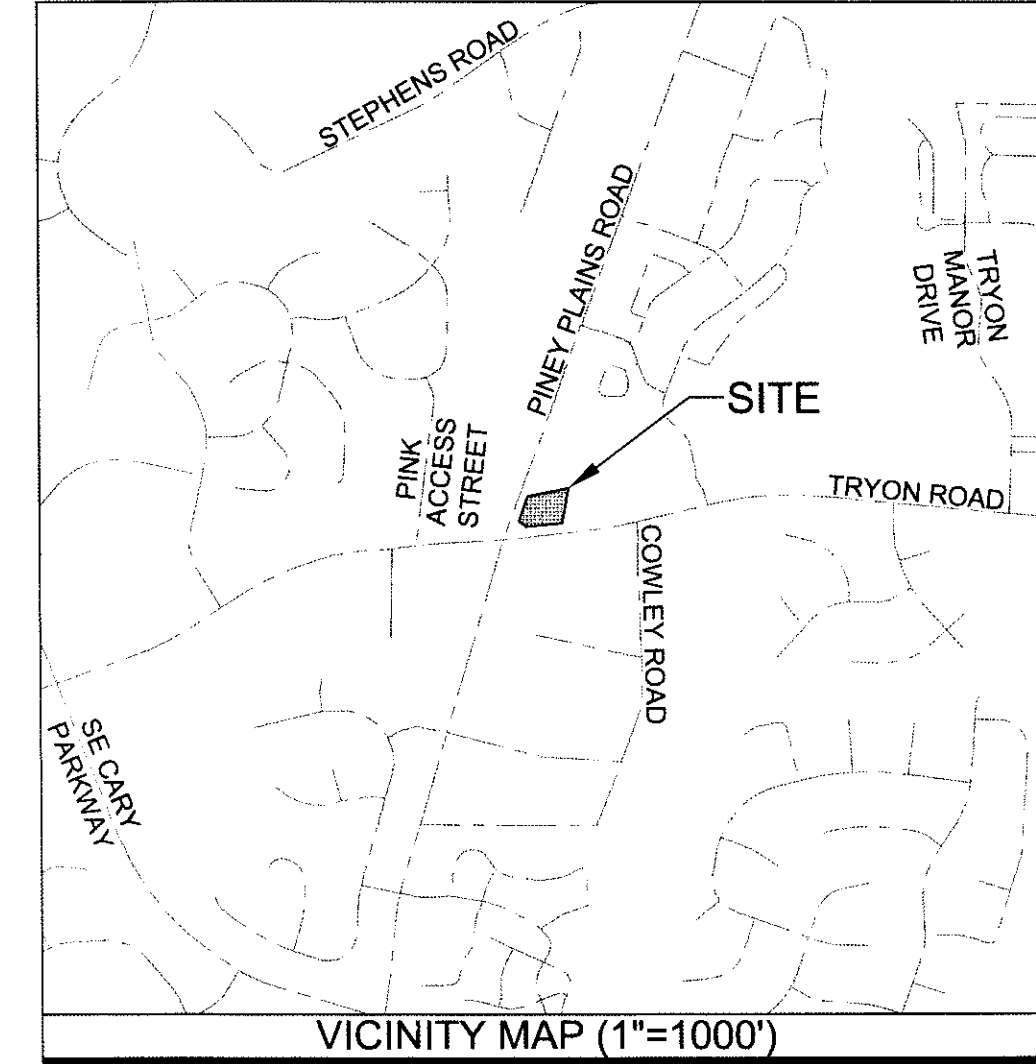

DATA SOURCES

- SITF BOUNDARIES, SITE BUILDINGS, AND SITE UTILITIES PROVIDED BY TURNING POINT SURVEYING, PLLC ON MARCH 31, 2011.
- ADJACENT PROPERTY CADASTRAL, ROW, TOPOGRAPHIC, AND HYDROLOGIC DATA DOWNLOADED FROM WAKE COUNTY GIS ON MAY 3, 2011.
- STREET CENTERLINES, WATER, SEWER, AND IMPERVIOUS SURFACE DATA DOWNLOADED FROM TOWN OF CARY FTP ON MAY 3, 2011.
- STREET DATA, SIDEWALK, STORM, AND EASEMENT DATA PROVIDED BY KIMLEY-HORN AND ASSOCIATES ON JUNE 2, 2011.

GENERAL NOTES

- THE DEVELOPER WILL BE RESPONSIBLE FOR ALL INSTALLATION COSTS ASSOCIATED WITH STREET LIGHTING ALONG PROPOSED STREETS, ADJACENT STREETS AND THOROUGHFARES AS REQUIRED PER TOWN OF CARY POLICY STATEMENT NO. 13. THE DEVELOPER SHALL CONTACT PROGRESS ENERGY AFTER PLAN APPROVAL AND PRIOR TO CONSTRUCTION IN ORDER TO DEVELOP A STREET LIGHTING PLAN FOR THE SITE/SUBDIVISION PLANS.
- ALL DUMPSTER AND CARDBOARD RECYCLING LOCATIONS WILL BE SCREENED FROM OFF-SITE VIEWS.
- ALL VEHICULAR USE AREAS (DRIVES AND PARKING AREAS) SHALL BE SCREENED FROM OFF-SITE VIEWS.

FOR REVIEW ONLY - NOT FOR CONSTRUCTION
PLAN IS SUBJECT TO REVISIONS DURING THE PRELIMINARY APPROVAL PROCESS

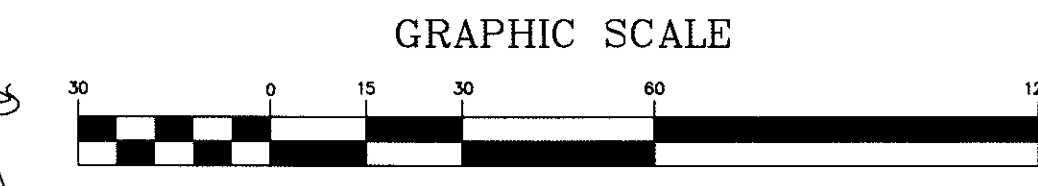

11-SP-030
HTE #: 11-1096
APPROVED BY THE TOWN OF CARY
DEVELOPMENT REVIEW COMMITTEE
PLANNER: *[Signature]* DATE: 11/17/2011

NO.	REVISION	DATE
1	PER CARY COMMENTS	09/05/11
2	PER CARY COMMENTS	09/27/11
3	PER CARY COMMENTS	11/07/11

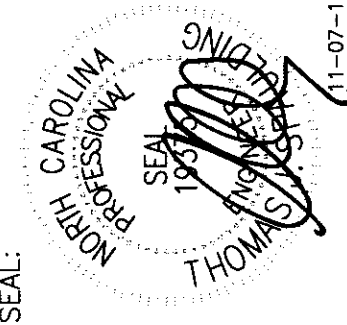

SPAULDING & NORRIS, PA
Design Consultants
972 Trinity Road
Raleigh, North Carolina 27607
Phone (919) 854-7990 Fax (919) 854-7925



PREPARED FOR:
BE ALL YOU CAN BE, INC.
214 BRIDLE CREEK DRIVE
CARY, NORTH CAROLINA 27513
DATE: 11-07-2011
SCALE: AS SHOWN
PROJECT ENGINEER:
TOM J. SPAULDING, PE
PROJECT CAD DESIGNER:
BRANN W. DOMINS
PROJECT SURVEYOR:
TURNING POINT SURVEYING, PLLC

BARBER PROPERTY
6944 TRYON ROAD, CARY, NC 27519
TOWN OF CARY, WAKE COUNTY, NORTH CAROLINA

SITE LAYOUT PLAN
SHEET 3 OF 11

DRAWING SHEET
C-1.1
PROJECT NUMBER
723-11