

CONSULT PRJ. NO.  
737132-21020  
SUB-CONSULT PRJ. NO.  
BEST PRJ. NO.



CONSULTANT  
**PARSONS**  
4701 HEDGEMORE DR  
CHARLOTTE, NC 28209  
704-529-6246

SUB-CONSULTANT

NO.	DATE	DESCRIPTION	CHKD/APPD
0	02/15/01	ISSUED FOR CONSTRUCTION	JES/ASF
1	04/25/01	REVISED PER TOWN OF CARY COMMENTS	JES/MEF

PROJECT TITLE  
**BUILDING ADDITION  
CARY ACADEMY CO**  
401 NORTH ACADEMY STREET  
CARY, NORTH CAROLINA 27511

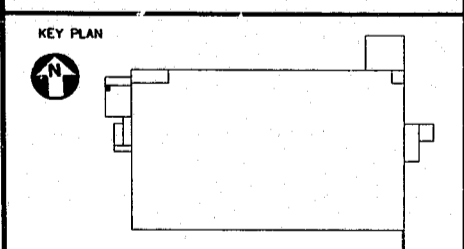

DATE: 02/15/01  
DRAWN BY: R. POSEY  
CHECKED BY: J. BEATTY  
APPROVED BY: M. FLEMING

NOT FOR CONSTRUCTION   
RELEASED FOR CONSTRUCTION   
AS-BUILT DRAWING

DATABASE: 21211C1001

DRAWING TITLE  
**CIVIL  
EXISTING CONDITIONS**

GLC NO. 21211 DRAWING NO. C1001

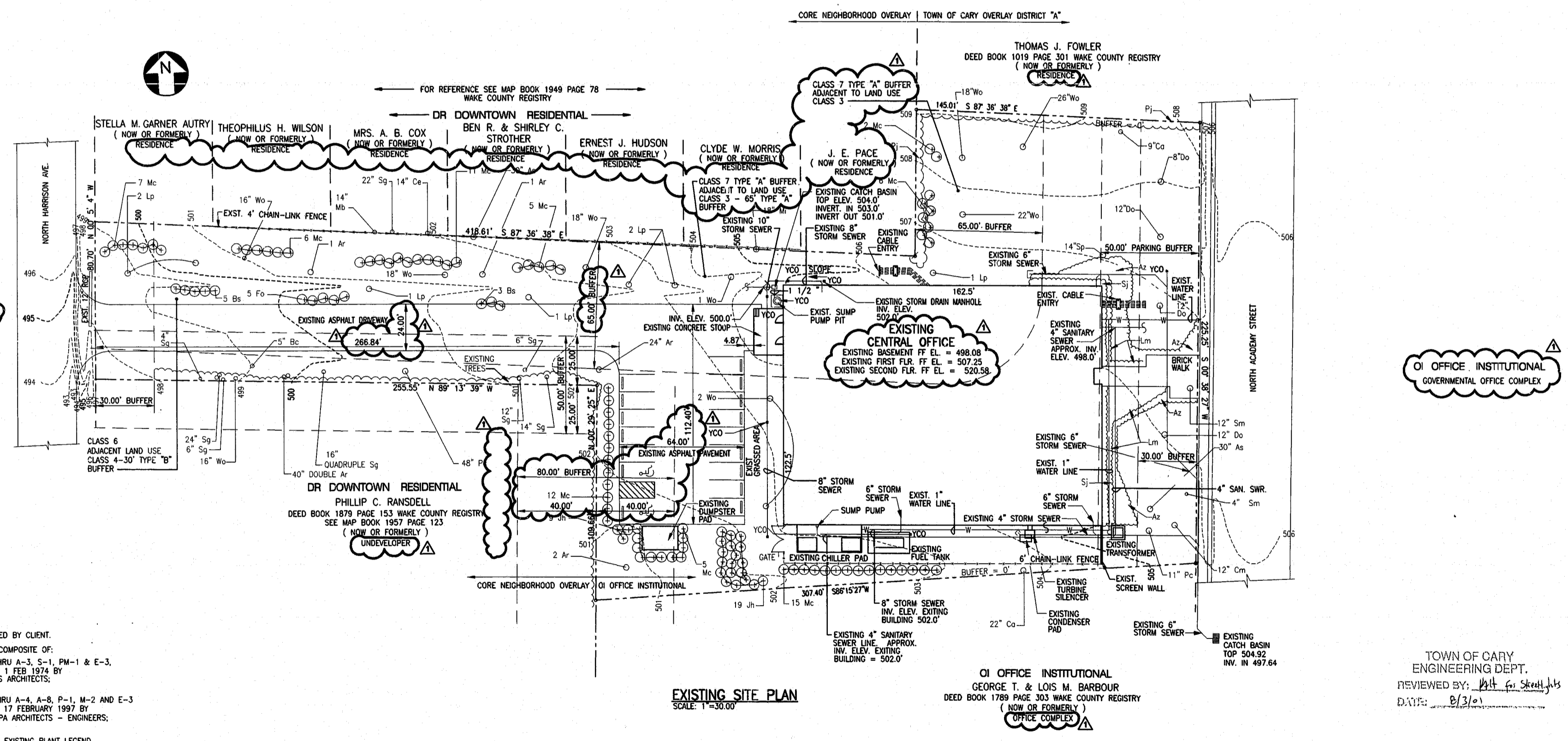
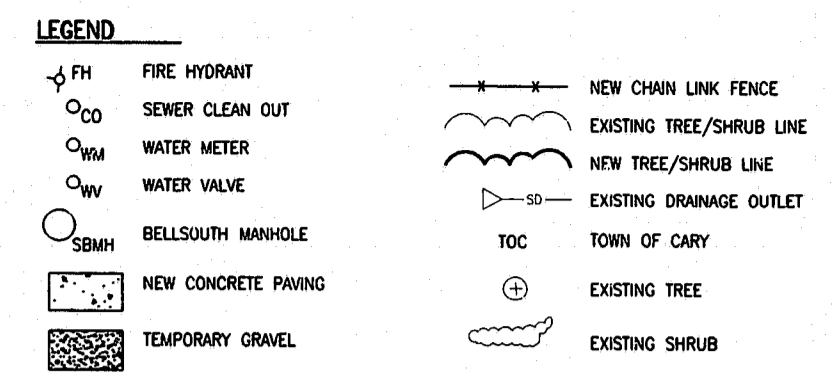
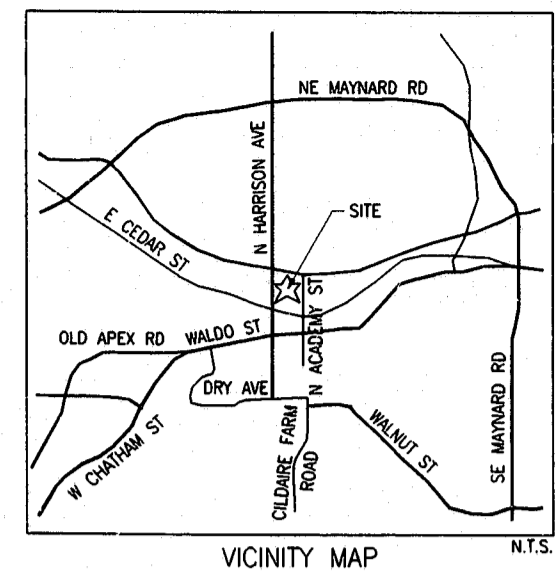

- NOTES**
- 1.) INFORMATION PROVIDED BY CLIENT.
  - 2.) THIS DRAWING IS A COMPOSITE OF:
    - a. DRAWINGS A-1 THRU A-3, S-1, PM-1 & E-3, ORIGINALLY DATED 1 FEB 1974 BY HOLLOWAY-REEVES ARCHITECTS, RALEIGH, NC
    - b. DRAWINGS A-1 THRU A-4, A-8, P-1, M-2 AND E-3, ORIGINALLY DATED 17 FEBRUARY 1997 BY H.R. ASSOCIATES PA ARCHITECTS - ENGINEERS, RALEIGH, NC.
  - 3.) SEE SHEET L01 FOR EXISTING PLANT LEGEND.

**EXISTING SITE PLAN**  
SCALE: 1"=30.00'

OI OFFICE INSTITUTIONAL  
GEORGE T. & LOIS M. BARBOUR  
DEED BOOK 1789 PAGE 303 WAKE COUNTY REGISTRY  
(NOW OR FORMERLY)  
OFFICE COMPLEX

TOWN OF CARY  
ENGINEERING DEPT.  
REVIEWED BY: *[Signature]*  
DATE: 8/3/01

01-SP-023  
**APPROVED**  
BY: *[Signature]* DATE: 5/24/01  
BY: *[Signature]* DATE: 8/18/01  
TOWN OF CARY  
DEVELOPMENT REVIEW GROUP