

OUTDOOR LIGHTING PLAN

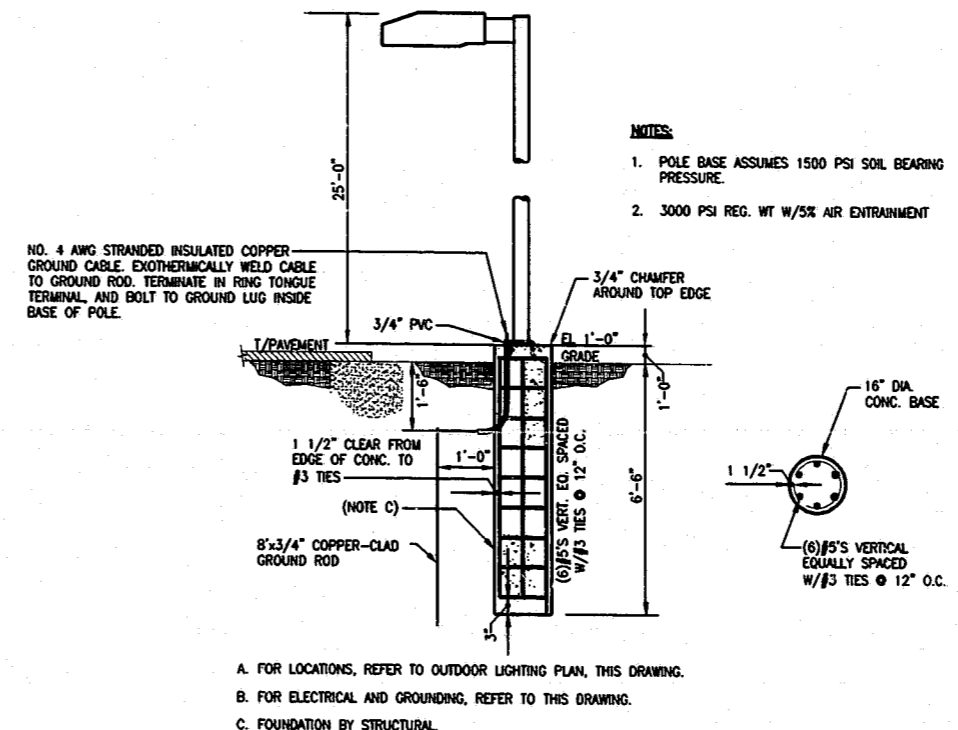

LIGHT POLE BASE DETAIL

SECTION A  
SCALE: NTS

LIGHTING FIXTURE SCHEDULE							
FIXTURE TYPE	MANUF.	CATALOG NUMBER	LAMPS		BALLAST		FIXTURE DESCRIPTION/REMARKS
			QTY.	WATTS	QTY.	WATTS	
G	KIM	1A-AR4-250MHZ08-HS, A-25	1	MH 250	1	HPF 274	POLE KIM POLE CAT#PRK25-6188 (6\"/>

LIGHTING STATISTICS				
AREA	MINIMUM fc	MAXIMUM fc	AVERAGE fc	AVG/MIN
PARKING LOT	0.47	2.43	1.42	3:1

NOTES:

- FOR GENERAL NOTES AND LEGEND, SEE DRAWING E0000.
- A SEPARATE NEUTRAL SHALL BE ROUTED WITH EACH CIRCUIT FROM THE LIGHTING OR RECEPTACLE PANEL TO THE FIRST FIXTURE, SWITCH OR RECEPTACLE (NO COMMON NEUTRAL).
- ALL LIGHTING/RECEPTACLE CONDUCTORS SHALL BE #12 AWG IN 1/2\"/>



CONSULT PRL NO. 737132-21020  
 SEAL THIS DOCUMENT ORIGINALLY ISSUED AND SEALED BY PHILIP B. HARPER P.E. NUMBER 022726 ON 04-23-01. THIS DOCUMENT SHOULD NOT BE CONSIDERED A CERTIFIED DOCUMENT.

CONSULTANT  
**PARSONS**  
 4701 HEDGEMORE DR  
 CHARLOTTE, NC 28209  
 704-528-6246

NO.	DATE	DESCRIPTION	DRG/APP
0	04/23/01	ISSUED FOR CONSTRUCTION	RLH/ECW

PROJECT TITLE  
**BUILDING ADDITION  
 CARY ACADEMY C.O.  
 401 NORTH ACADEMY STREET  
 CARY, NORTH CAROLINA 27511**

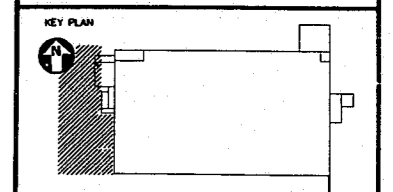

DATE 04/23/01  
 DRAWN BY T.E. COLLINS  
 CHECKED BY R.L. HOLLAND  
 APPROVED BY E.C. WEATHERLY

NOT FOR CONSTRUCTION   
 RELEASED FOR CONSTRUCTION   
 AS-BUILT DRAWING

DATABASE 21211e1011

DRAWING TITLE  
**ELECTRICAL  
 OUTDOOR LIGHTING PLAN  
 PARKING LOT**

OLC NO. 21211  
 DRAWING NO. E1011

**FOR INFORMATION ONLY**

01-59-033  
**APPROVED**  
 6/19/01  
 TS 6-19-01

**WARNING**  
 ASBESTOS AND/OR POLLUTANTS ARE HAZARDOUS TO YOUR HEALTH  
 PORTIONS OF THIS PROJECT MAY CONTAIN ASBESTOS AND/OR OTHER POLLUTANTS. VERIFICATION OF EITHER CAN BE ACCOMPLISHED ONLY BY LABORATORY TESTING. DO NOT TOUCH OR STAY NEAR SUSPECTED HAZARDS, BUT REPORT THEIR PRESENCE TO YOUR BELLSOUTH PROJECT REPRESENTATIVE FOR TESTING AND VERIFICATION. RETURN TO WORK IN SUCH AREAS ONLY AFTER TESTING VERIFIES THAT IT IS SAFE TO DO SO.

SCALE: 1"=10'-0"