

NOTE: COORDINATE FOUNDATION INSTALLATION WITH GROUNDING INSTALLATION
 * - SEE MONOPOLE VENDOR'S DRAWINGS FOR INFO NOT SHOWN

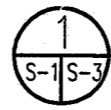

SECTION @ MONOPOLE FOUNDATION
 NO SCALE

NO.	DATE	REVISION DESCRIPTION	BY
A	12-05-97	ISSUED FOR PERMITTING, RFP AND OWNER REVIEW	B.R.

BELLSOUTH
Carolinas PCS, L.P.

09-368-142-H

SECTIONS, AND
 DETAILS

copyright © 19 97.

Richard Oseri-Hensley
 PROFESSIONAL ENGINEER
 2301 Ramoths Drive
 Post Office Box 31305, Raleigh, NC 27622-1305
 Tel: 919/782-5311 Fax: 919/782-5825



SEAL NOT VALID UNLESS SIGNED AND DATED

PROJECT MANAGER	DEPARTMENT MANAGER
J. LATHAM	J. BAKER
LEAD DESIGN PROJ.	CHECKED
B. ROSS	J. BAKER
DRAWN	DATE
B.R.	JAN 15, 1997
PROJECT NUMBER	DRAWING NUMBER
22597-02	S-3

CONSTRUCTION DOCUMENTS
 RALEIGH OFFICE

ROSS
 9/20/97

- NOTES:
1. PROVIDE 2 PULL STRINGS SECURELY FASTENED AT EACH END OF THE CONDUIT. PULL STRING TO BE 200LB TEST POLYETHYLENE CORD. PROVIDE CAP ON END OF THE CONDUITS AND MARK AS SHOWN ON THE ENLARGED SITE PLAN.
 2. PROVIDE MARKER (REBAR) AT END OF THE TELCO CONDUIT. MARKER SHALL BE DRIVEN SO THAT A MINIMUM OF 2 FEET REMAINS EXPOSED ABOVE GRADE. EXPOSED PORTION TO BE PAINTED BRIGHT ORANGE.
 3. CONTACT MS. MARY MILLS (PH: 919-481-6186) WITH CP&L BEFORE BEGINNING UTILITY TRENCH CONSTRUCTION TO VERIFY ROUTING AND SERVICE CONNECTION.
 4. CONTACT MS. JILL MAXWELL (PH: 919-571-2050) WITH BELLSOUTH BEFORE CONSTRUCTION BEGINS TO COORDINATE TELCO CONNECTION.

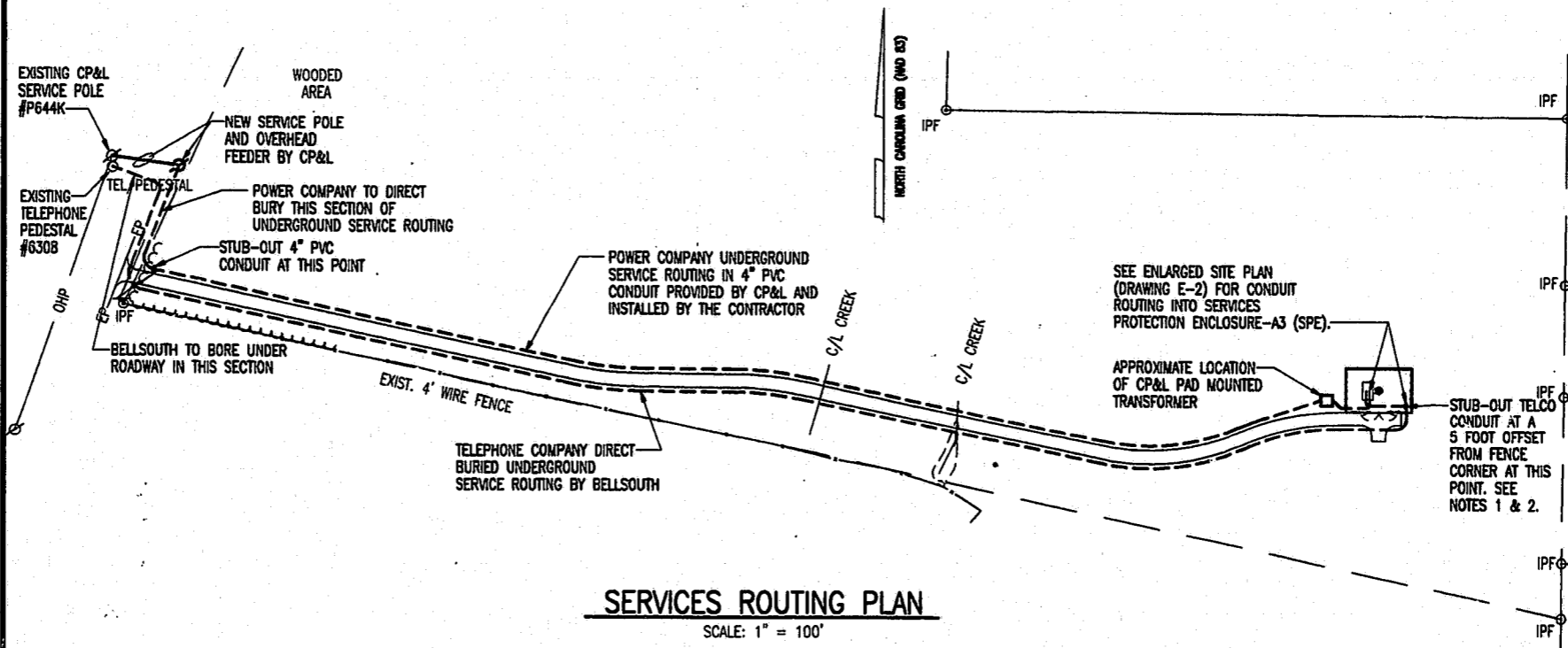

SERVICES ROUTING PLAN
 SCALE: 1" = 100'

NO.	DATE	REVISION DESCRIPTION	BY
A	1/31/97	ISSUED FOR PERMITTING, RFP AND OWNER REVIEW	AA

BELLSOUTH
Carolinas PCS, L.P.

09-368-142-H

SERVICES ROUTING
 PLAN

copyright © 19 97.

Richard Oseri-Hensley
 PROFESSIONAL ENGINEER
 2301 Ramoths Drive
 Post Office Box 31305, Raleigh, NC 27622-1305
 Tel: 919/782-5311 Fax: 919/782-5825

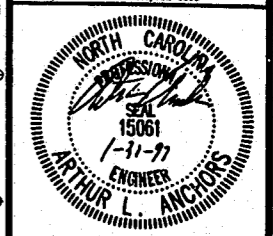

SEAL NOT VALID UNLESS SIGNED AND DATED

PROJECT MANAGER	DEPARTMENT MANAGER
J. LATHAM	A. ANCHORS
LEAD DESIGN PROJ.	CHECKED
R. WHITT	A. ANCHORS
DRAWN	DATE
G. SUMERLIN	1/15/97
PROJECT NUMBER	DRAWING NUMBER
22597-02	E-1

91-57-024
APPROVED
 3/3/97
 TM 4-3-97