

Hugh J. Gilleece
and Associates
875 Walnut Street
Suite 360
Cary, NC 27511
BUSINESS LIC. # C-496
Phone: (919)469-1101
Fax: (919)460-7637

NO.	DATE	REVISION
1	08/26/13	TOWN OF CARY ENGINE DATED 05/15/13
2	08/26/13	PANEL SET

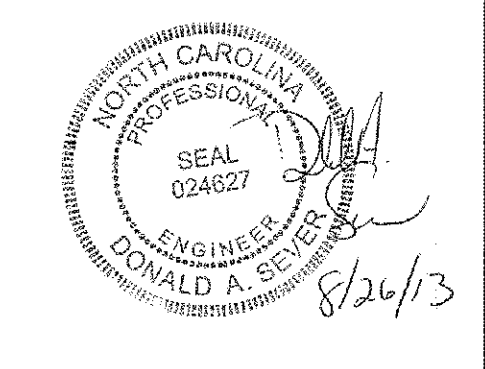

**GREEN LEVEL CHURCH RD.
STRIPING PLAN**
FOR
BELLEWOOD MANOR
SITUATED AT
CARY
WAKE COUNTY, NORTH CAROLINA

JOB # 9900.10
DSN/CHK BY: DAS
DWN BY: BAH
DATE: 04/03/2013
HRZ SCALE: 1"=40'
VRT SCALE: NONE

SHEET NO.
C24

ANN M. RICHARDS AND
GRIFFIS P. DIETER
PIN NO. 0724956922
D.B. 13484 PG. 1145

**GREEN LEVEL CHURCH ROAD
SOUTHBOUND TURN LANE
DETAIL PER NCDOT 1205.05
(TURN BAYS LESS THAN 125')
RIGHT TURN LANE AS PER
NCDOT 1205.06 SHEET 1**

**GREEN HOPE SCHOOL RD. WESTBOUND
LEFT TURN LANE TO BE BUILT WITH THE
FRYER GATE DEVELOPMENT (12-SP-024)
IF NOT CONSTRUCTED BY THE TIME OF
PHASE 1 RECORDING WE WILL BUILD
PER THE APPROVED FRYER GATE PLAN.**

**GREEN LEVEL CHURCH ROAD
NORTHBOUND TURN LANE
DETAIL PER NCDOT 1205.05
(TURN BAYS LESS THAN 125')
GREEN LEVEL CHURCH ROAD
(S.R. 1600)
(60' PUBLIC R/W)**

TOWN OF CARY
PIN NO. 0734056653

BENCH MARK
ON FIRE HYDRANT
PAINTED FLANGE BOLT
ELEV. 356.03'
NAVD 88

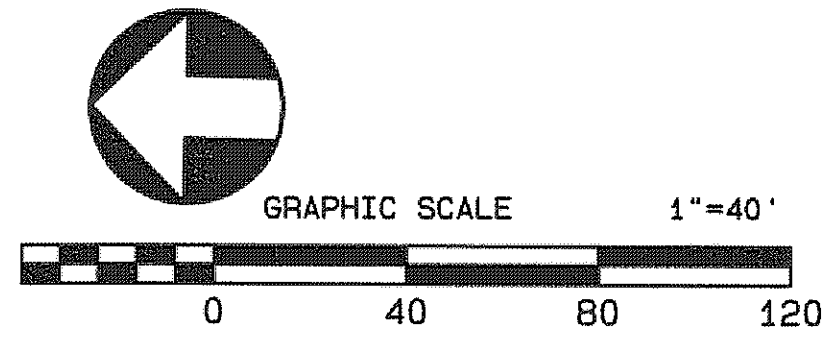
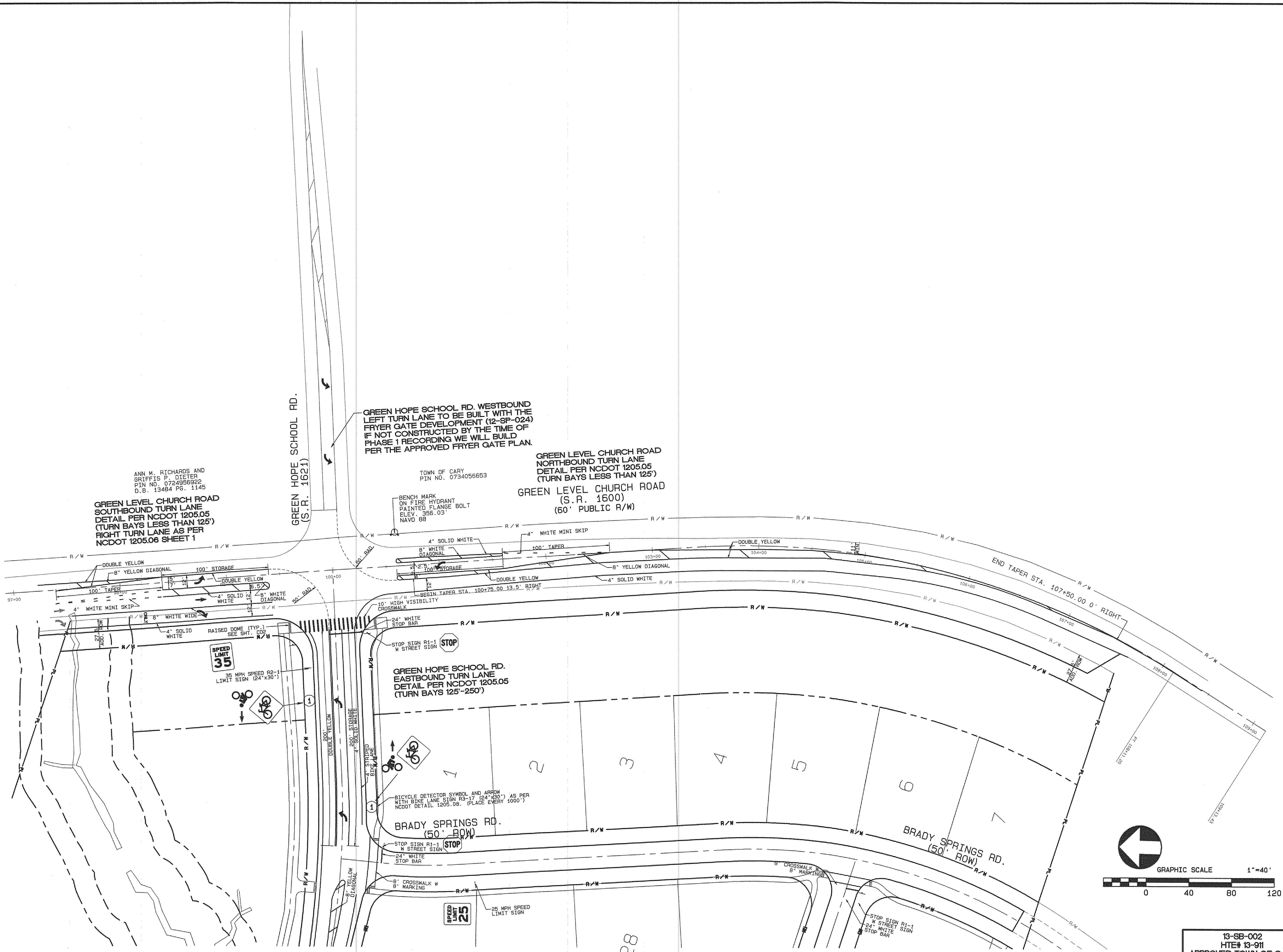

13-SB-002
HTE# 13-911
APPROVED TOWN OF CARY

PLANNER *R. Miller* DATE 9/6/2013

Plot Date: 8/26/2013 Time: 1:09PM