

Hugh J. Gilleece and Associates
 875 Walnut Street
 Suite 360
 Cary, NC 27511
 Phone: (919)469-1101
 Fax: (919)460-7637

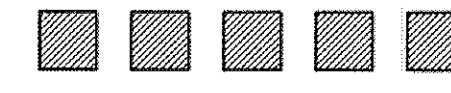

HIGH SIDE IS FOR REFERENCE ONLY, ALL WORK FROM CENTERLINE TO LOW SIDE
 PROFILE IS FOR EDGE 41.5' FROM CENTERLINE

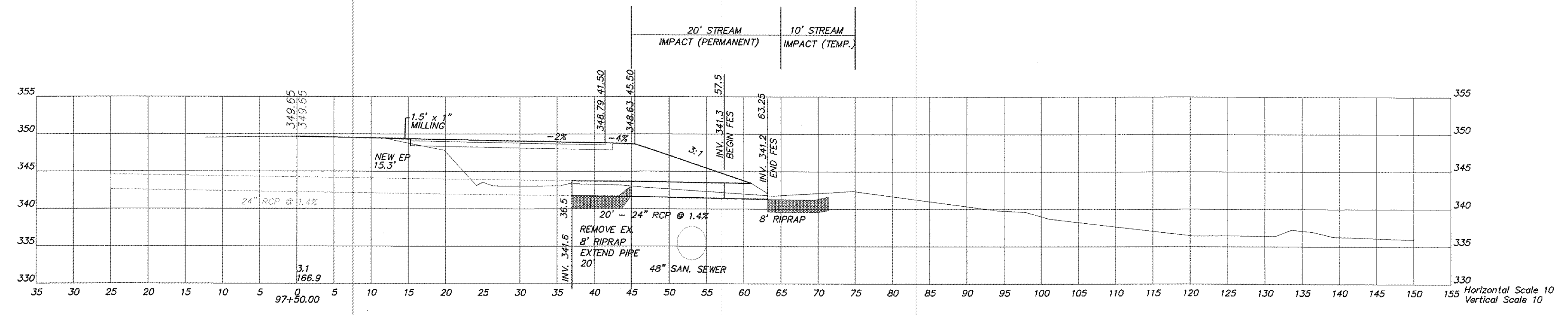
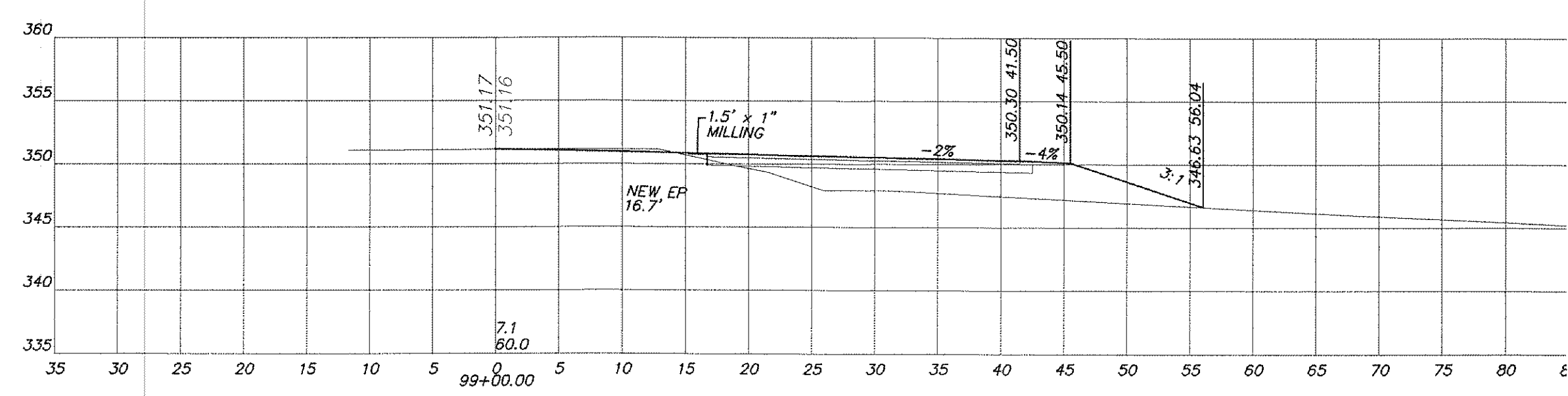
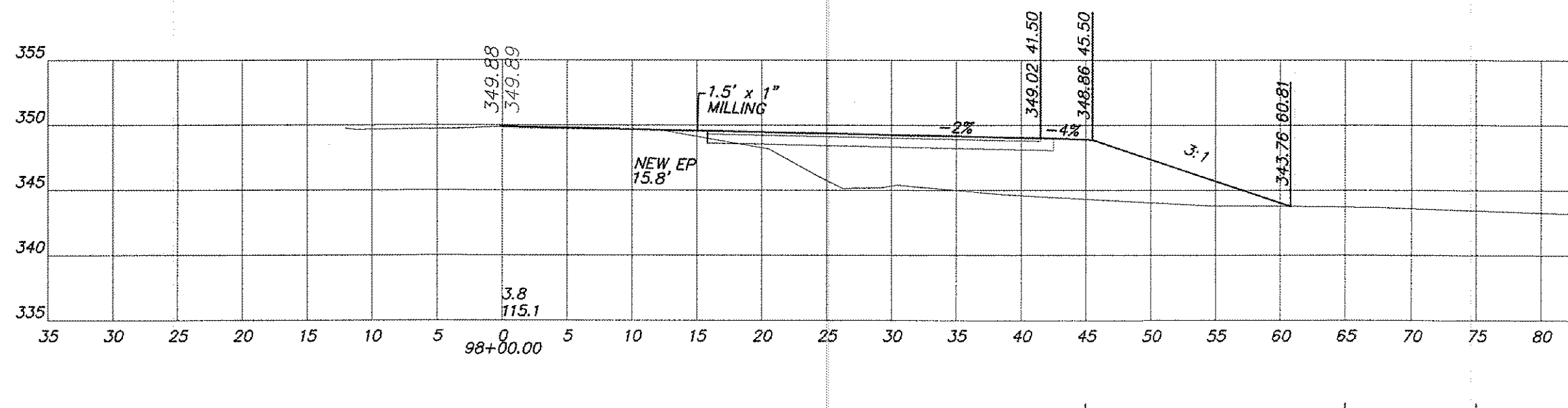
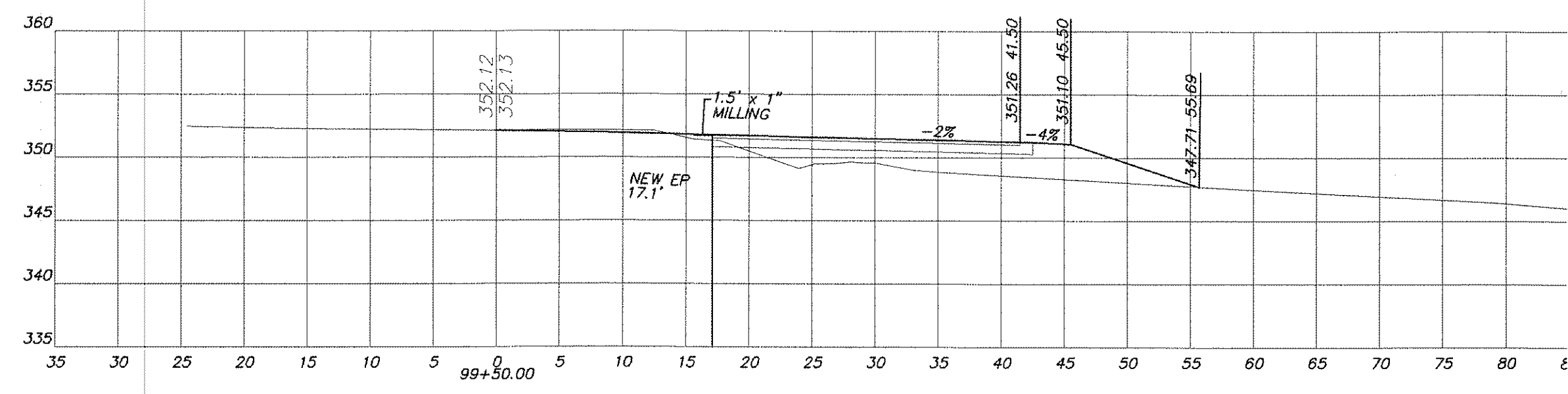
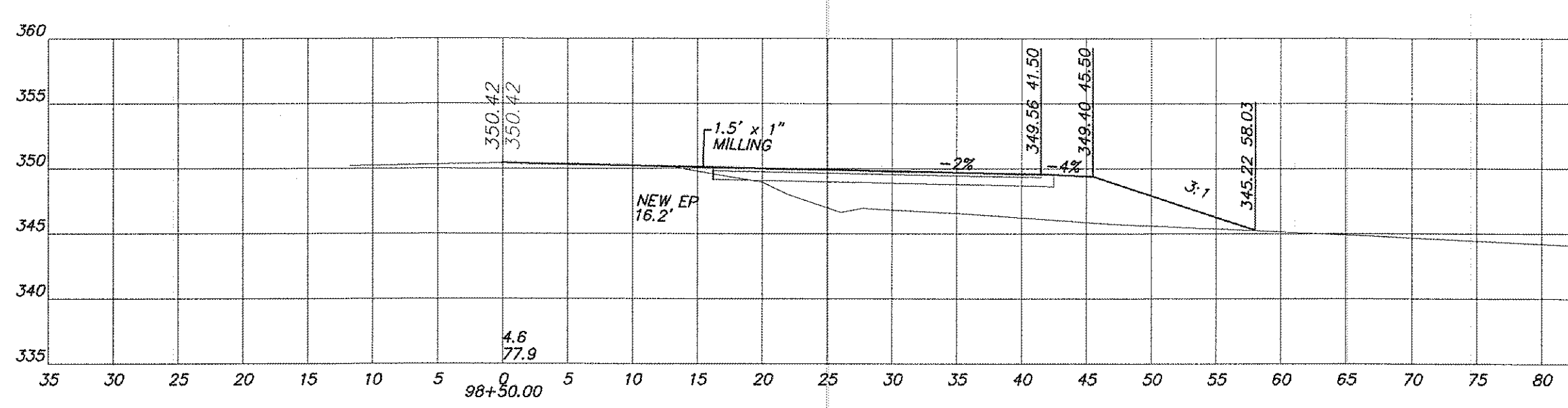
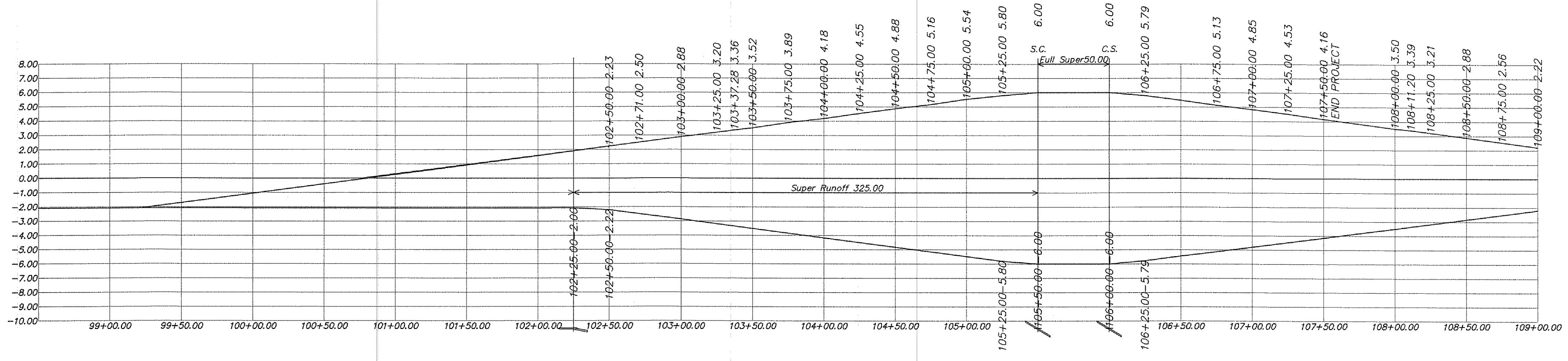

NO.	DATE	REVISION
1	5/2/2013	TOWN OF CARY REVIEW COMMENTS 3/19/2013
2	6/17/2013	TOWN OF CARY REVIEW COMMENTS 5/28/2013
3	8/17/2013	TOWN OF CARY REVIEW COMMENTS 7/25/2013
		FINAL SET

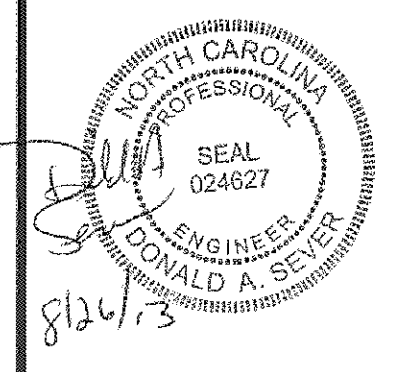

GREEN LEVEL CHURCH RC CROSS SECTIONS
 STA. 97+50 TO 99+50
 FOR
BELLEWOOD MANOR
 SITUATED AT
 CARY
 WAKE COUNTY, NORTH CAROLINA

JOB #	3690.90
DSN/CHK BY:	DS/DS
DWN BY:	DS
DATE:	4/1/2013
HRZ SCALE:	1"=10'
VRT SCALE:	1"=10'

HTE# 13-911
 13-SB-002
 APPROVED BY TOWN OF CARY
 DEVELOPMENT REVIEW COMMITTEE
 PLANNER *K. H. H.* DATE 9/16/2013

SHEET NO.

C25