

**Hugh J. Gillece  
and Associates**

875 Walnut Street  
Suite 360  
Cary, NC 27511  
Phone: (919)469-1101  
Fax: (919)460-7637

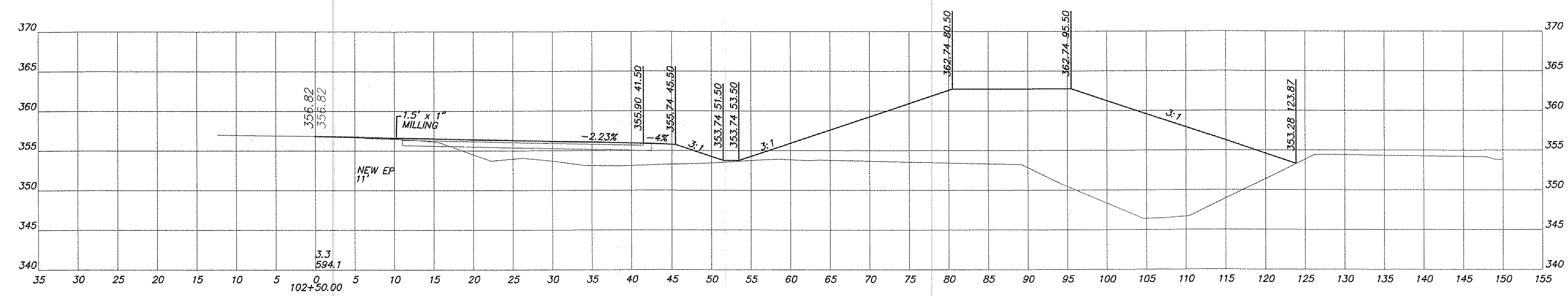

NO.	DATE	REVISION
1	5/27/2013	TOWN OF CARY REVIEW COMMENTS 5/19/2013
2	6/13/2013	TOWN OF CARY REVIEW COMMENTS 5/29/2013
3	8/1/2013	TOWN OF CARY REVIEW COMMENTS 7/2/2013
	8/28/2013	FINAL SET

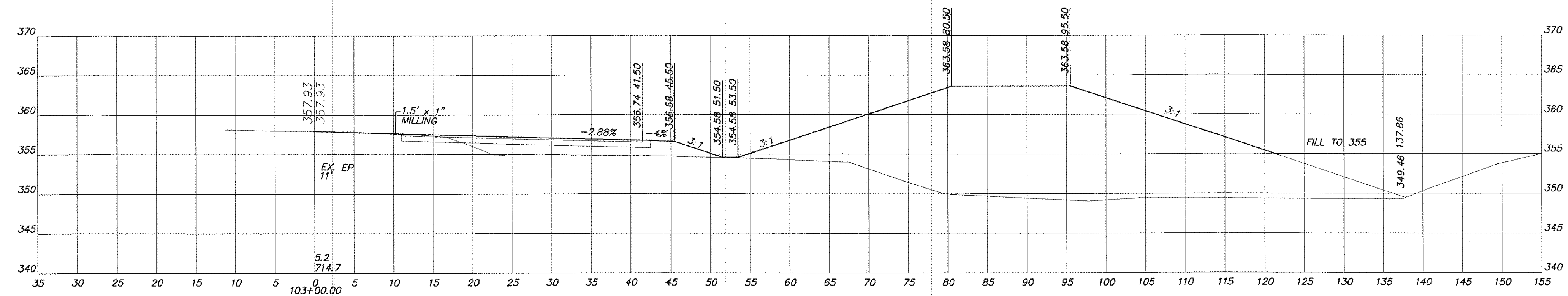
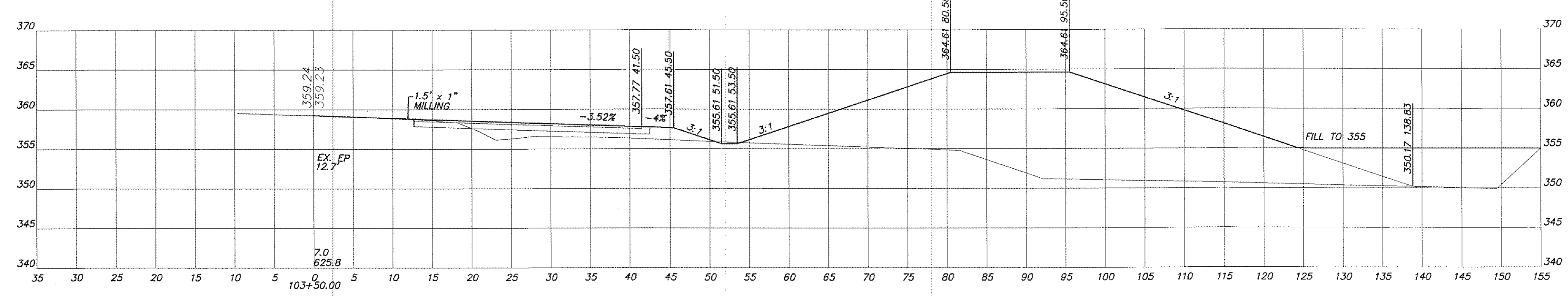
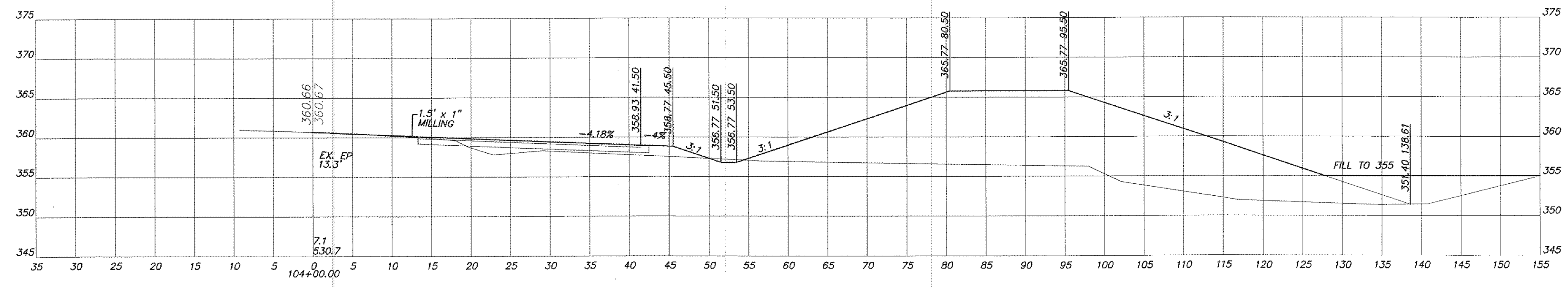
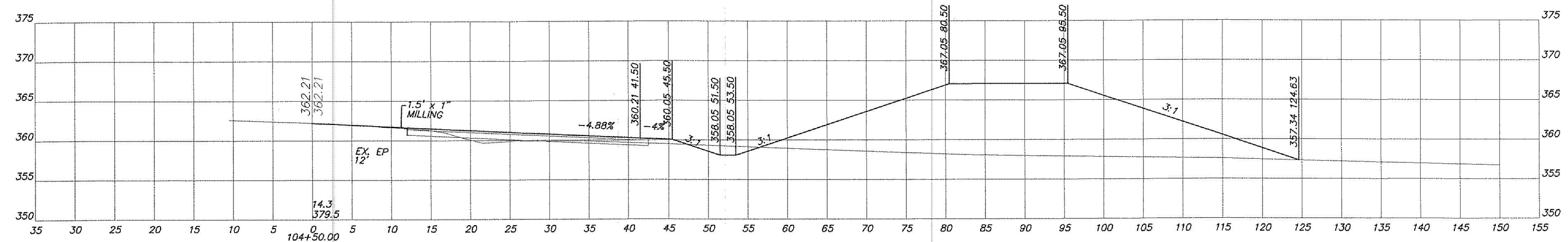
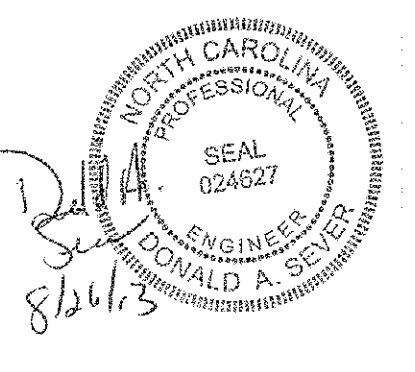

**GREEN LEVEL CHURCH FC CROSS SECTIONS  
STA. 102+50 TO 104+50**  
FOR  
**BELLEWOOD MANOR**  
SITUATED AT  
CARY  
WAKE COUNTY, NORTH CAROLINA

JOB # 3690.90
DSN/CHK BY: DS/DS
DWN BY: DS
DATE: 4/1/2013
HRZ SCALE: 1"=10'
VRT SCALE: 1"=10'

SHEET NO.  
**C27**

HTE# 13-911  
13-SB-002  
APPROVED BY TOWN OF CARY  
DEVELOPMENT REVIEW COMMITTEE  
PLANNER *KJH* DATE 9/6/2013