

**General Notes :**

- All work shall be done in conformance with Wake County Standards and Specifications.
- It is the contractor's responsibility to verify the location of all existing utilities before beginning construction.
- No FEMA delineated 100 year floodplain on-site as per map #37103 C 0680 E and 37103 C 0685 E, effective date 3/2/12.
- Lots 48 and 49 shall not be permitted to have direct access to Optimist Farm Rd. - NCSR 1340.
- Topography obtained from Wake County G.I.S.
- No construction shall be started until a grading permit is obtained from Wake County Erosion Control.

\* A 4 : 1 slope or guardrail is required at fill sections 10 feet or greater.

**APPROVED**  
**TOWN OF CARY**

DRC **DRC** Date **4/15/02**  
 Planning **DRC** Date **4/23/02**  
 Engineering **TS** Date **4-18-02**

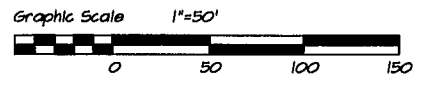
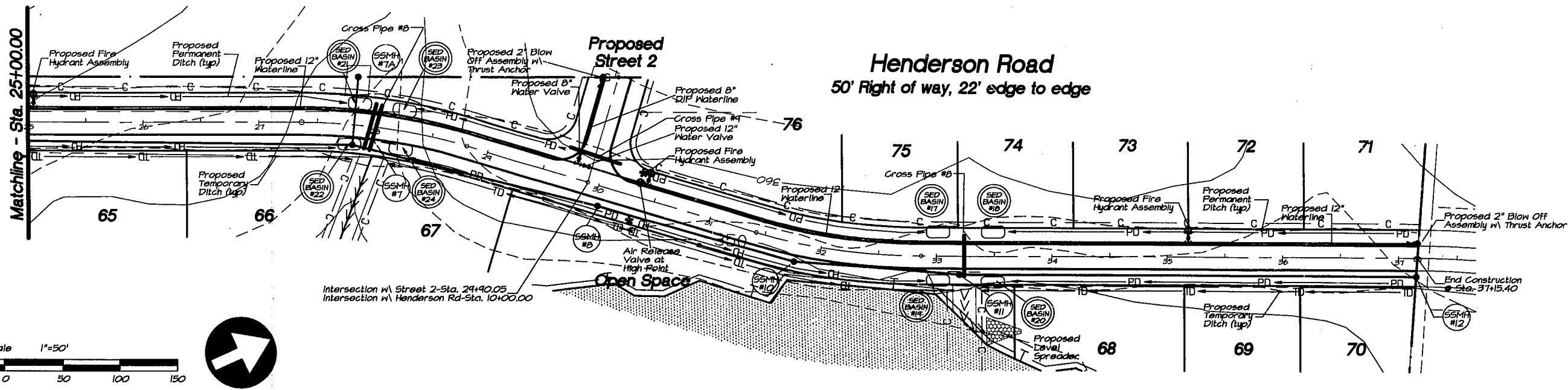
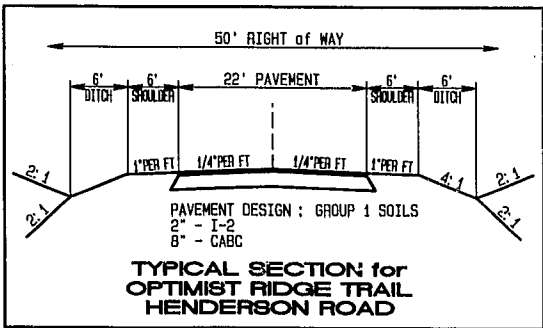

NO.	DATE	DESCRIPTION
1	01-15-02	PRELIMINARY
2	02-15-02	CONSTRUCTION
3	03-15-02	CONSTRUCTION
4	04-15-02	CONSTRUCTION
5	05-15-02	CONSTRUCTION
6	06-15-02	CONSTRUCTION
7	07-15-02	CONSTRUCTION
8	08-15-02	CONSTRUCTION
9	09-15-02	CONSTRUCTION
10	10-15-02	CONSTRUCTION
11	11-15-02	CONSTRUCTION
12	12-15-02	CONSTRUCTION

**S & N**  
**SPAULDING & NORRIS, PA**  
Design Consultants

972 Trinity Road  
Raleigh, North Carolina 27607  
Phone (919) 854-7980 Fax (919) 854-7925

PREPARED FOR: **THE HARRIS, LLC**  
 2520 BENTFIELD DRIVE  
 RALEIGH, NC 27606

DATE: **Tue Mar 5, 2002**  
 PROJECT NUMBER: **309-2001**  
 DRAWN BY: **ANDREW J. JAMES**  
 PROJECT DESIGNER: **ANDREW J. JAMES**  
 PROJECT SUPERVISOR: **ANDREW J. JAMES**  
 DATE CHECKED: **010-061-2004**

**Covington Meadows Subdivision  
& Cluster Community**  
Wake County, North Carolina

**Henderson Road Plan and Profile**  
Wake County, North Carolina

\\wv-server\sys301 - 250 Projects\309-01 District Form Sub. Cary, NC & SS\309-2002.dwg

DRAWING SHEET  
**C-5.2**

PROJECT NUMBER  
**309-2001**

