

DILLARD & ANITA POWELL  
LOT 12 KITTY HAWK  
ZONE N.B.  
VACANT

DILLARD & ANITA POWELL  
LOT 10 KITTY HAWK  
ZONE N.B.  
VACANT

DILLARD & ANITA POWELL  
LOT 6 KITTY HAWK  
ZONE N.B.  
VACANT

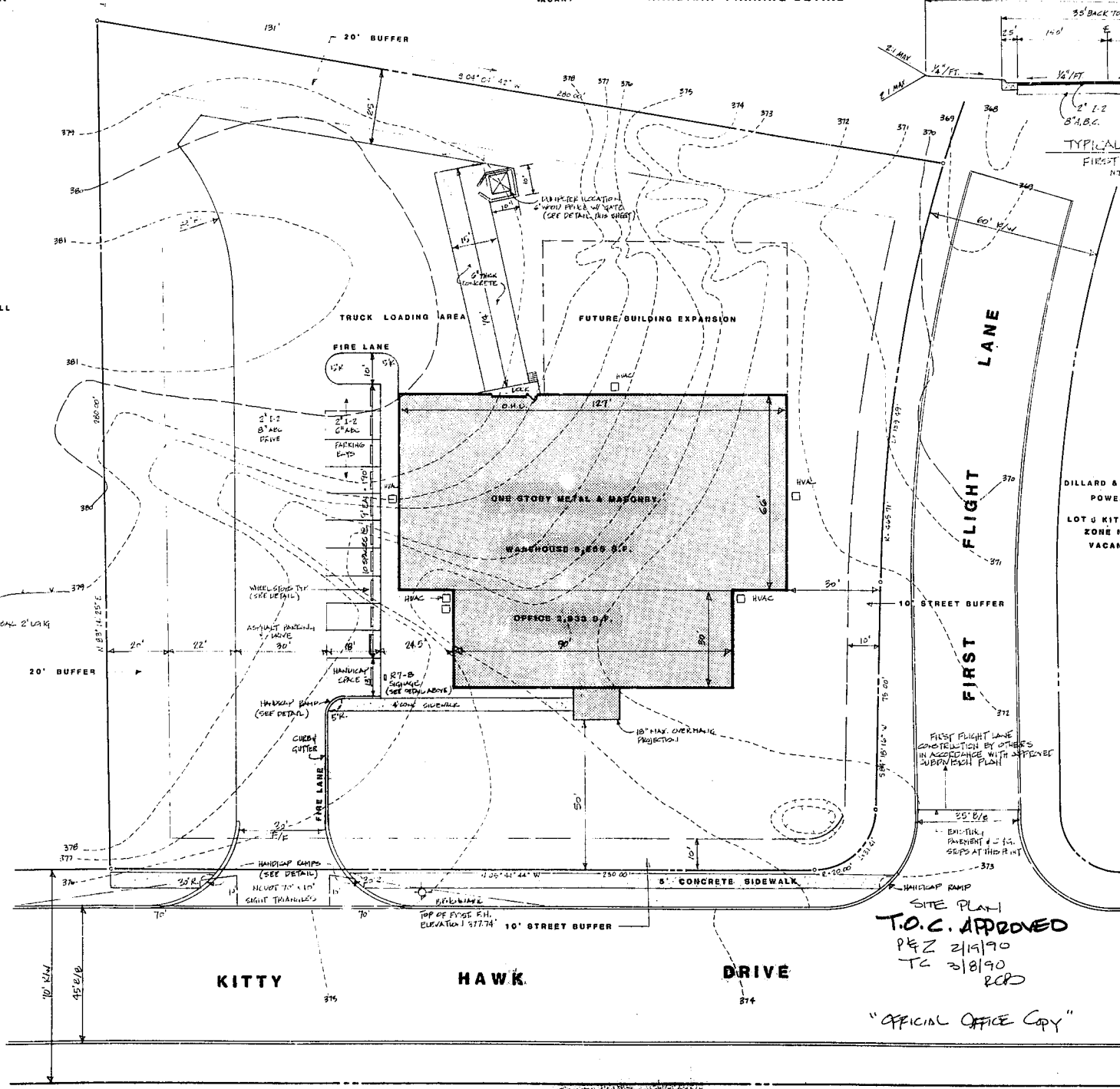

SITE DATA	
TOTAL AREA	1.515 ACRES
ZONE	B-2
TOTAL BUILDING FLOOR AREA	11,188 S.F.
OFFICE 2,933 S.F. WAREHOUSE 8,255 S.F.	
PARKING REQUIRED (1/1 EMPLOYEE=0 EMPLOYEES)	6 SPACES
PARKING PROVIDED	11 SPACES
HANDICAP SPACES PROPOSED	1 SPACE
VEHICULAR USE AREA	16,026 S.F.
TOTAL LANDSCAPE AREA	38,346 S.F.
IMPERVIOUS AREA	27,647 S.F.
DENUDED AREA	43,560 S.F.
OWNER OF TRACT- STEVE OWENS	
TAX MAP 318	PARCEL PORTION OF 1

- NOTES
- Boundary information and claim to public information prepared by Larry L. Scott, RLS # 3155, dated January 21, 1959.
  - All construction to be in conformance with Town of Cary standards and ordinances.
  - This site has a tree cover consisting of loblolly pines of up to 12 inch caliper spaced at approximately 20 feet on center. There are very few understory trees a 10% coverage and heights of from 1 inch to 3 inch caliper. There are no extremely large caliper specimen trees on this site.
  - Sanitary sewage flow is approximately 100 gpd based on 4 employees at 25 gpd/employee.

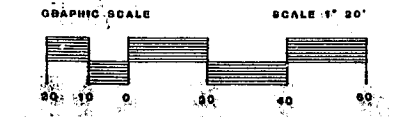
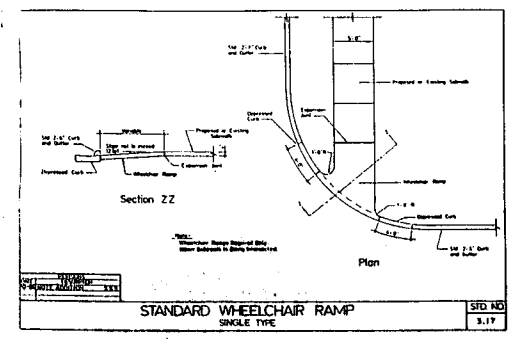

SITE PLAN  
T.O.C. APPROVED  
P&Z 2/14/90  
TC 3/8/90  
RCD

"OFFICIAL OFFICE COPY"



BLAKELY DESIGN GROUP  
Landscape Architecture Land Planning

16 E. Jansen St., Suite 208, Raleigh, NC 27601  
Telephone (919) 287-0007

BETTER BUSINESS FORMS

Preliminary Plan  
not for construction

Date	Dec. 29, 1989
Scale	1" = 20'
Drawn	TT, BTB
Job	
Sheet	01