

VICINITY MAP
1" = 500'

LANDSCAPE CALCULATIONS

VEHICULAR USE AREA 10,028 S.F.
 TOTAL LANDSCAPED AREA 38,346 S.F.
 IMPERVIOUS AREA 27,647

LOT 10 KITTY HAWK
 ZONE B-2
 VACANT

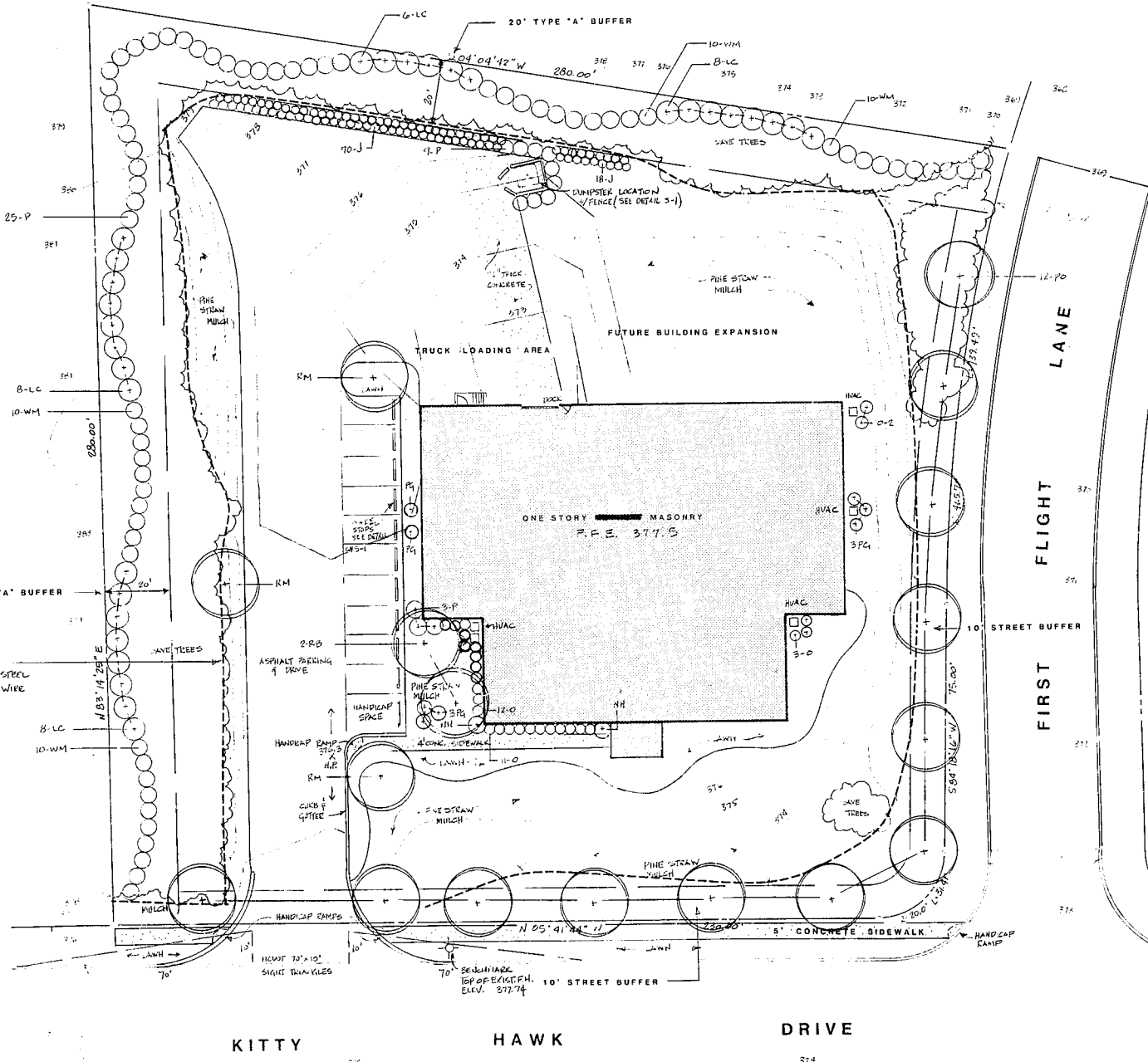

BUFFER RECONSTRUCTION PLAN

The following list of plant materials shall be installed at the sites and quantities shown, whenever buffers are disturbed by grading or other construction activity.

MINIMUM REQUIRED PLANTS IN BUFFERS:

- a) Two (2) upper story canopy trees of 2.5" caliper minimum
- b) Two (2) understorey trees of 1.5" caliper and 7' height, minimum
- c) Two (2) evergreen trees of 3.5" caliper, and 5' height minimum
- d) Seven (7) deciduous shrubs 18" in height and 3 gallon container size, minimum
- e) Eight (8) deciduous shrubs 18" in height and 3 gallon container size, minimum
- f) Twenty-two (22) ground covers with a container size of one gallon, installed on slopes equal or greater than 2:1 (2:1) minimum.

NOTE: These types and quantities shall be used per 2,000 square feet of disturbed buffer area.

LOT 12 KITTY HAWK
 ZONE B-2
 VACANT

WARNING: TREE PROTECTION + SILT FENCE
 TREE PROTECTION FENCE TO BE CONSTRUCTED OF STEEL PIPES, 8" O.C. MAX. 4" I.D. GA. 1/4" WELDED WIRE HOOKED INTO PRECAST CHANNELS

PLANT LIST

KEY	BOTANICAL NAME	COMMON NAME	SIZE	ROOT	QUAN.	REMARKS
RM	ACEQ BARBUM	RED MAPLE	24" CAL.	D2B	3	8" MIN. HT.
RB	BETULA NIGRA	RIVER BIRCH	"	"	2	MULTI-STEM 8" MIN. HT.
LB	QUERCUS PALUMBERIS	HICKORY	"	"	12	8" MIN. HT. 35' SPACING
LC	CUPRESSOCYPRIS LEYLANDII	LEYLAND CYPRESS	18" HT	CONT.	32	7' SPACING
WM	HIBEA CERIFERA	WAX MYRTLE	"	"	40	5' SPACING
P	PRUNUS FRASERI	FRAGRANT PRUNELLA	"	"	27	5' SPACING
NH	HEX NELLE E. STEVENS HOPE	NELLE E. STEVENS HOPE	4'-5" HT	"	2	
J	JUNIPERUS CONFERTA 'BLUE PACIFIC'	BLUE PACIFIC JUNIPER	1 GAL.	"	30	3' SPACING
O	PANAM LAUNCE PASCUS 'TWO LINES'	OPUNTIA CHESTNUTLEAF	3 GAL.	"	25	3' SPACING
M	LOCTRODIA SELWYI	PHOENIX GRASS	5 GAL.	"	3	3' SPACING

GENERAL NOTES

- All trees have been located with respect to proposed or existing facilities.
- Verification of total quantities as shown in the Plant List shall be the responsibility of the Landscape Contractor, and the total quantities shall be as required on the Planting Plan.
- All trees, shrubs and plants shall conform to accepted standards established by the American Association of Nurserymen.
- All shrubs shall be soaked with water and mulched immediately following planting.
- Pruning - thin branches and foliage of deciduous trees (not all end tips) by 1/3, retaining natural plant shape. Never cut a leader.
- All plants shall bear the same relationship to finished grade as it bore to previous existing grade.
- All root balls removed from containers shall be scarified prior to backfilling.
- Batch - 3" clean pine needles.

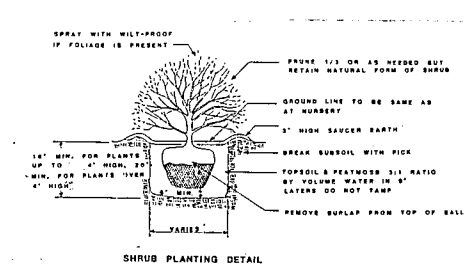

SHRUB PLANTING DETAIL

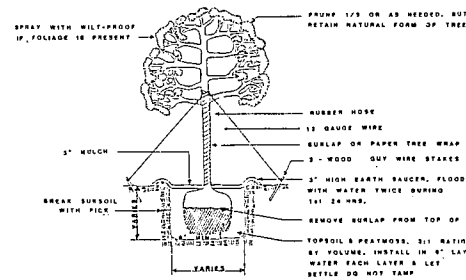

TREE PLANTING DETAIL

NOTES

- Boundary information and field topographic information shown on this plan prepared by Barry L. Scott, RLS # 3153, dated December 21, 1987.
- All construction to be in conformance with Town of Cary standards.
- This site has a tree cover consisting of loblolly pines of up to 1" inch caliper spaced at approximately 20 feet on center. There are very few understorey trees; a few sweetgums and maples of 1" from 1 inch to 3 inch caliper. There are no extremely large caliper specimen trees on this site.
- Sanitary sewage flow is approximately 150 pd based on 6 employees at 25 gpd/employee.

GRAPHIC SCALE SCALE 1" = 20'

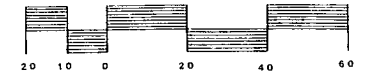

REVISED 3-8-80, RFD
 ADD 75'x57' AT LANE AND
 REVISED 1-8-87 RFD



BLAKELY DESIGN GROUP
 Landscape Architecture
 Land Planning

18 E. Rowan St., Suite 208, Raleigh, NC 27609
 Telephone (919) 827-0807

LANDSCAPE PLAN

BETTER BUSINESS FORMS

DATE: 02/29/88
 SHEET NO: 5
 SHEET TOTAL: 5
 SHEET: **S-3**
 OF: 5 Sheets