

UTILITY NOTES

1. ALL CONSTRUCTION SHALL BE IN ACCORDANCE WITH CURRENT TOWN OF CARY STANDARD SPECIFICATIONS AND DETAILS AT TIME OF PLAN APPROVAL.
2. ALL WATER SERVICES SHALL BE 1 1/2" TYPE K COPPER AND ALL SEWER SERVICES SHALL BE 6" SCHEDULE 40 PVC UNLESS OTHERWISE NOTED.
3. CONTRACTOR SHALL VERIFY LOCATION OF ALL EXISTING UTILITIES PRIOR TO CONSTRUCTION. LOCATION OF EXISTING UTILITIES SHOWN ON PLANS IS BASED ON BEST AVAILABLE INFORMATION BUT CAN BE CONSIDERED ONLY AS APPROXIMATE.
4. WHERE THE STATIC WATER PRESSURE IS IN EXCESS OF 80 PSI, A PRESSURE REDUCING VALVE SHALL BE PROVIDED INSIDE THE BUILDING IN ACCORDANCE WITH THE REQUIREMENTS OF THE PLUMBERS CODE.
5. MINIMUM SLOPE FOR 6" SANITARY SEWER SERVICES SHALL BE THE CLEANOUTS SHALL BE PROVIDED AS SHOWN ON THE PLANS BUT SHALL BE SPACED AT NO GREATER THAN 100 LF FOR 6" SERVICES. ALL CLEANOUTS SHALL EXTEND A MINIMUM OF 6 INCHES ABOVE FINISH GRADE OR MEET THE OPTIONAL CLEANOUT REQUIREMENT METERS AS SPECIFIED IN CARY STANDARD 7.01. CLEANOUTS LOCATED IN PAVED AREAS MUST HAVE CAST IRON RISERS, FITTINGS & BRASS CAPS.
6. A PRECONSTRUCTION MEETING MAY BE REQUIRED FOR THIS CONSTRUCTION.

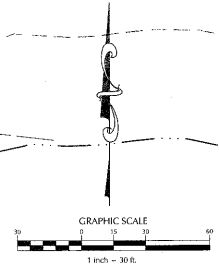
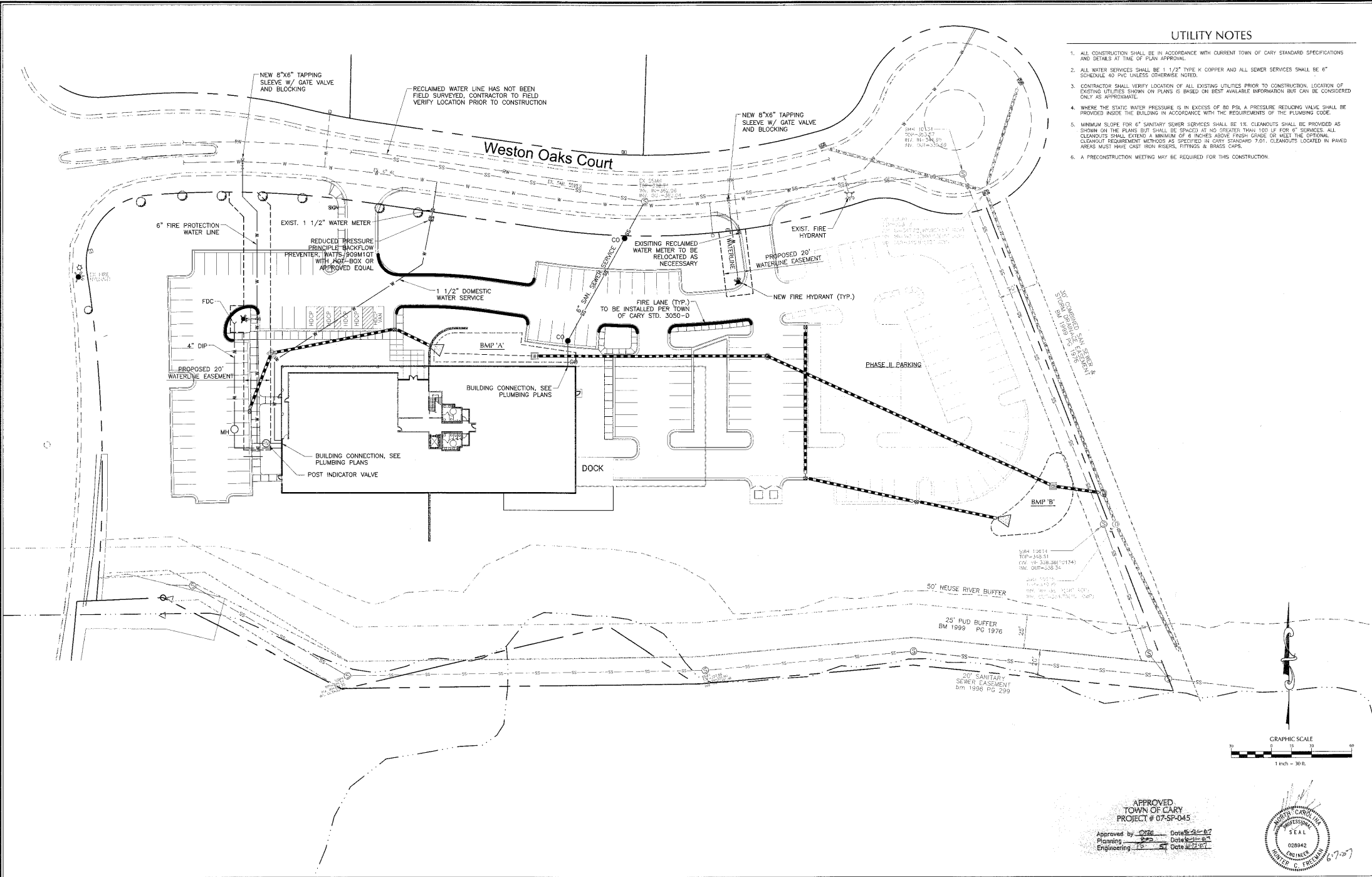

APPROVED
TOWN OF CARY
PROJECT # 07-SP-045

Approved by: *[Signature]* Date: 4-12-07
 Planning: *[Signature]* Date: 4-12-07
 Engineering: *[Signature]* Date: 4-12-07



No.	Revision	Date	By	Designer	Scale
				W&R	1"=30'
				Drawn By: P&P	Date: 4/12/07
				Checked By: W&R	Job No: 2070278.00

BIOLOGICS - WESTON OAKS SITE
 CARY WAKE COUNTY NORTH CAROLINA

SITE UTILITIES

WITHERS & RAVENEL
 ENGINEERS | PLANNERS | SURVEYORS
 111 MacArthur Drive, Cary, North Carolina 27511, Tel: 919-469-3300, Fax: 919-462-6808, www.witwithers.com

Sheet No. **C-101**

K:\SP\07\070707\070707.dwg - Revision: 04/12/07 - Wednesday, June 06, 2007 1:48:45 PM - PLOTTER: PETERSON