

RAILSCAPE BERM SECTION

NOT TO SCALE

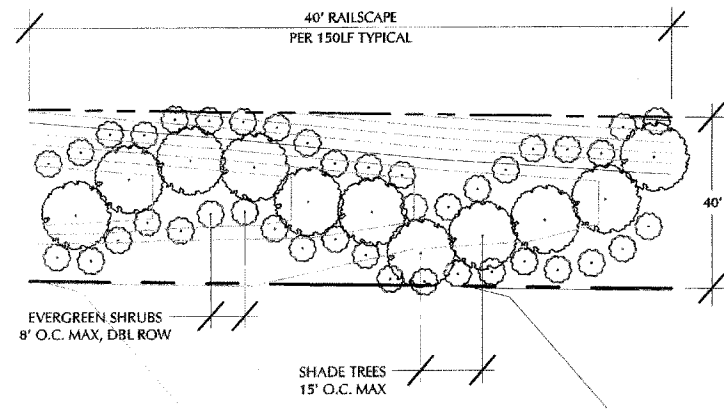

40' RAILSCAPE - DOUBLE TYPE 'B' SEMI-OPAQUE BUFFER

NOT TO SCALE

TYPICAL SHADE TREES (NOT TO BE MORE THAN 50% OF ANY SPECIES)

BOTANICAL NAME	COMMON NAME	SIZE	HT.	ROOT
ACER RUBRUM	OCTOBER GLORY RED MAPLE	2"-2.5" CAL.	10'-12'	B&B
NYSSA SYLVATICA	BLACK TUPELO	2"-2.5" CAL.	10'-12'	B&B
QUERCUS PALUSTRIS	PIN OAK	2"-2.5" CAL.	10'-12'	B&B
QUERCUS COCCINEA	SCARLET OAK	2"-2.5" CAL.	10'-12'	B&B

TYPICAL EVERGREEN SHRUBS (NOT TO BE MORE THAN 50% OF ANY SPECIES)

BOTANICAL NAME	COMMON NAME	SIZE	HT.	ROOT
MYRTICA CERIFERA	WAX MYRTLE	24"-30"	CONT.	CONT.
ILEX GLABRA	INKBERRY HOLLY	24"-30"	CONT.	CONT.
PRINUS VIRGINIANA	VIRGINIA PINE	24"-30"	CONT.	CONT.
LOROPETALUM CHINENSE	LOROPETALUM	24"-30"	CONT.	CONT.

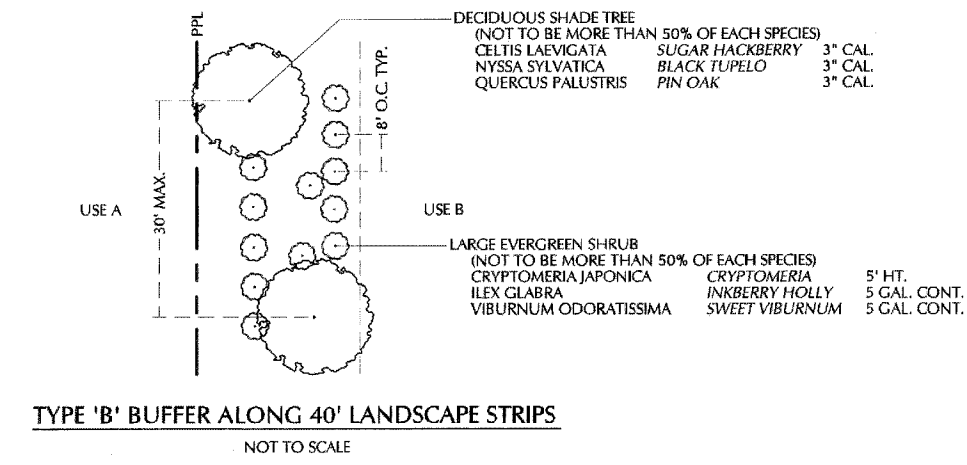
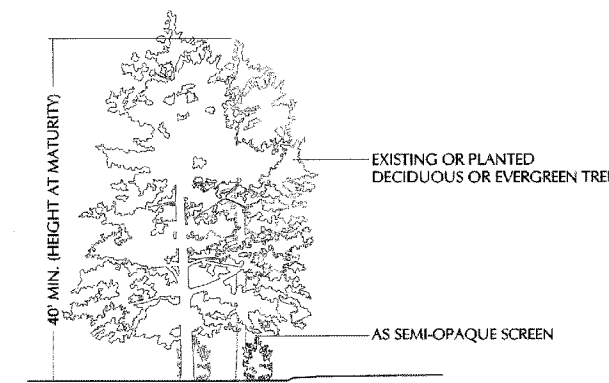

TYPE 'B' BUFFER ALONG 40' LANDSCAPE STRIPS

NOT TO SCALE

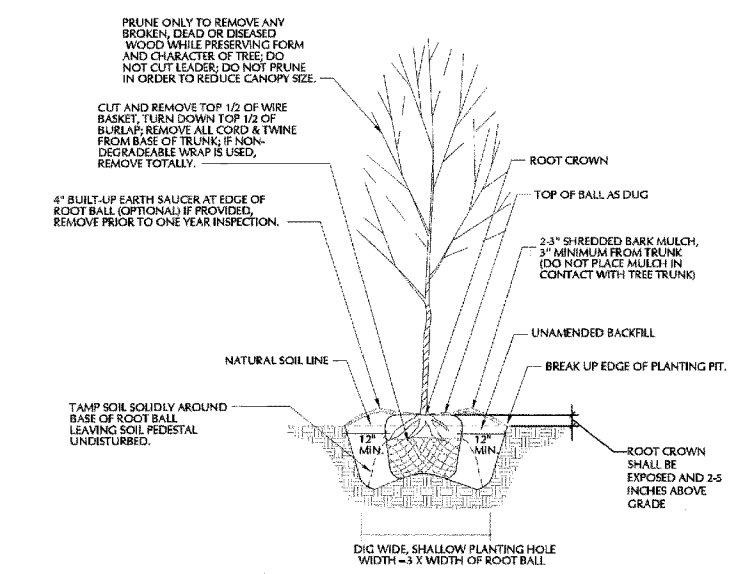

- NOTES:**
- CONTRACTOR TO VERIFY THAT ADEQUATE DRAINAGE EXISTS PRIOR TO PLANTING.
 - DO NOT WEEP TRUNKS OF TREES.
 - STAKING OF TREES IS NOT RECOMMENDED, EXCEPT ON WINDY SITES OR FOR LARGE EVERGREEN TREES. IF STAKING IS USED, PLUMBING STRIPS, NOT HOPE AND WIRE, SHOULD BE USED AND MUST BE REMOVED AT APPROPRIATE TIME. PROPERTY OWNER IS RESPONSIBLE FOR REPLACEMENT OF DESTROYED OR DAMAGED TREES.
 - ALL TREES SHALL CONFORM TO THE STANDARDS SET FORTH IN THE MOST RECENT AMERICAN STANDARDS FOR NURSERY STOCK PUBLISHED BY THE AMERICAN ASSOCIATION OF NURSERMEN.
 - TREES WITH ROOT FLARE COVERED BY MORE THAN 1.5" OF SOIL WILL BE REJECTED.
 - A ROOT COLLAR CUTAWAY FOR ALL TREES SPECIFIED WILL BE DONE BY THE SUPPLIER AT THE POINTS OF DELIVERY. TREES WILL NOT BE PLANTED DOWN TO THE SUPPLIER MARK GROUND LEVEL LINE ABOVE ROOTBALL. IF TOWN AEROSOL DETERMINES THAT THERE IS EXCESSIVE SOIL OVER ROOT CROWN, THESE TREES WILL BE REJECTED.

TREE PLANTING

NOT TO SCALE

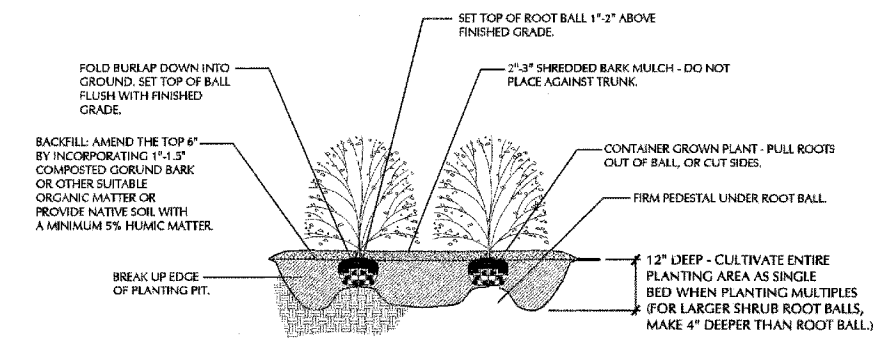

- NOTES:**
- ALL SHRUBS SHALL CONFORM TO THE STANDARDS SET FORTH IN THE MOST RECENT AMERICAN STANDARDS FOR NURSERY STOCK PUBLISHED BY THE AMERICAN ASSOCIATION OF NURSERMEN.
 - SOIL ANALYSIS SHALL BE OBTAINED.
 - SHEET PREPARATION OF BEDS IS HIGHLY PREFERRED TO INDIVIDUALLY DUG HOLES.

SHRUB PLANTING BED

NOT TO SCALE

LANDSCAPE MAINTENANCE

THE OWNERS OF THE PROPERTY AND THEIR AGENTS, HEIRS OR ASSIGNS SHALL BE RESPONSIBLE FOR THE INSTALLATION, PRESERVATION AND MAINTENANCE OF ALL PLANTINGS AND PHYSICAL FEATURES SHOWN ON THIS PLAN. THE OWNERS SHALL BE RESPONSIBLE FOR ANNUAL MAINTENANCE OF THE VEGETATION TO INCLUDE BUT NOT LIMITED TO:

LAWN AREA

- THE LAWN AREA WILL BE MOWED 40 TIMES PER YEAR TO PROVIDE A NEAT AND UNIFORMLY FINISHED LAWN.
- FOR AREAS INACCESSIBLE TO MOWERS, A STRING TRIMMER WILL BE USED TO CLIP GRASS TO SAME HEIGHT AS MOWER.
- CURB, SIDEWALK, AND BED EDGES WILL BE MECHANICALLY EDGED 13 TIMES PER YEAR DURING THE GROWING SEASON.
- ALL DEBRIS WILL BE REMOVED FROM TURF PRIOR TO MOWING AND FROM TURF AND PAVEMENT AREAS FOLLOWING EDGING.
- THE ENTIRE LAWN WILL BE CORE AERIFIED IN THE FALL.
- SEEDING AND FERTILIZATION WILL BE PERFORMED IN CONJUNCTION WITH AERIFICATION.
- THE LAWN AREA WILL BE OVERSEEDDED WITH A HYBRID FESCUE BLEND AT A RATE OF 75 POUNDS PER ACRE.
- THE TURF WILL BE FERTILIZED THREE TIMES DURING THE YEAR (MARCH, SEPTEMBER, AND NOVEMBER). A SLOW RELEASE NITROGEN PRODUCT WILL BE USED AT A RATE OF 1-2 POUNDS OF NITROGEN PER 100 SQUARE FEET.
- A PRE-EMERGENT GRASS CONTROL WILL BE APPLIED TO THE LAWN WHEN SOIL TEMPERATURES REACH 48 DEGREES.

PLANT BEDS AND SMALL ORNAMENTAL TREES

- ALL PLANT BEDS WILL BE SPRAYED AND WEEDED BY HAND TO MAINTAIN THEM FREE OF WEEDS AT ALL TIMES.
- ALL SHRUBS WILL BE FERTILIZED AS REQUIRED WITH A SLOW-RELEASE FERTILIZER AT A RATE ACCORDING TO PLANT TYPE.
- ALL TREES WILL BE FERTILIZED BY DEEP ROOT FEEDING WITH A SLOW-RELEASE FERTILIZER DESIGNED TO FEED FOR TWO YEARS.
- ALL SHRUBS AND TREES WILL BE PRUNED WITH HAND PRUNERS TO ENCOURAGE GROWTH AND REMOVE DEAD MATERIAL.
- REPLACE PINE STRAW MULCH ANNUALLY.
- FORMAL HEDGES WILL BE TRIMMED TO AN INVERT 'V' SHAPE TO ENCOURAGE LOW LIMB STRUCTURE AND DENSE GROWTH.
- AN I.P.M. (INTEGRATED PEST MANAGEMENT) PROGRAM WILL BE ESTABLISHED AND IMPLEMENTED.

LEAVES

- ALL LEAVES WILL BE REMOVED FROM THE LAWN AREAS WEEKLY AND FOUR TIMES A YEAR FROM THE PLANT BEDS. LEAVES MAY BE PLACED IN ADJACENT WOODED AREAS.

NATURAL AREAS

- NATURAL AREAS WILL BE MAINTAINED FREE OF BRUSH AND WEEDS WITHIN THE FIRST TEN FEET OF THE NATURAL AREA.

04-SP-065

APPROVED
TOWN OF CARY

Approved by DRC Date 9/21/04
 Planning RE Date 10/20/04
 Engineering TS Date 10/19/04

No.	Revision	Date	By	Designer	Scale
1	PER TOWN OF CARY 1ST REVIEW	05-07-04	CRP	W&R	1" = 30'
				Drawn By: XXX	Date: 05/14/2004
				Checked By: XXX	Job No: 204017

BISHOP'S GATE P.U.D. - PARCEL AR-4
 CARY WAKE COUNTY NORTH CAROLINA

PLANTING DETAILS

WITHERS & RAVENEL
 ENGINEERS | PLANNERS | SURVEYORS
 111 Mockanan Drive Cary, North Carolina 27511 tel: 919-469-3340 fax: 919-467-6008 www.witthersravenel.com

Sheet No. **8**