

**SETBACKS:**

FRONT 18'  
 REAR 15'  
 SIDE AGGREGATE 15'  
 (MIN. 5')

PERIMETER BUFFER=30'  
 AROUND BOUNDARY

NOTE: A Maintenance Easement must be obtained when a sight triangle encroaches onto private property.

NOTE: Carpenter Fire Station Road and Yates Store Road to be completed as part of the Amberly PUD Roadway project, to be completed by December 8, 2004, including sidewalks.

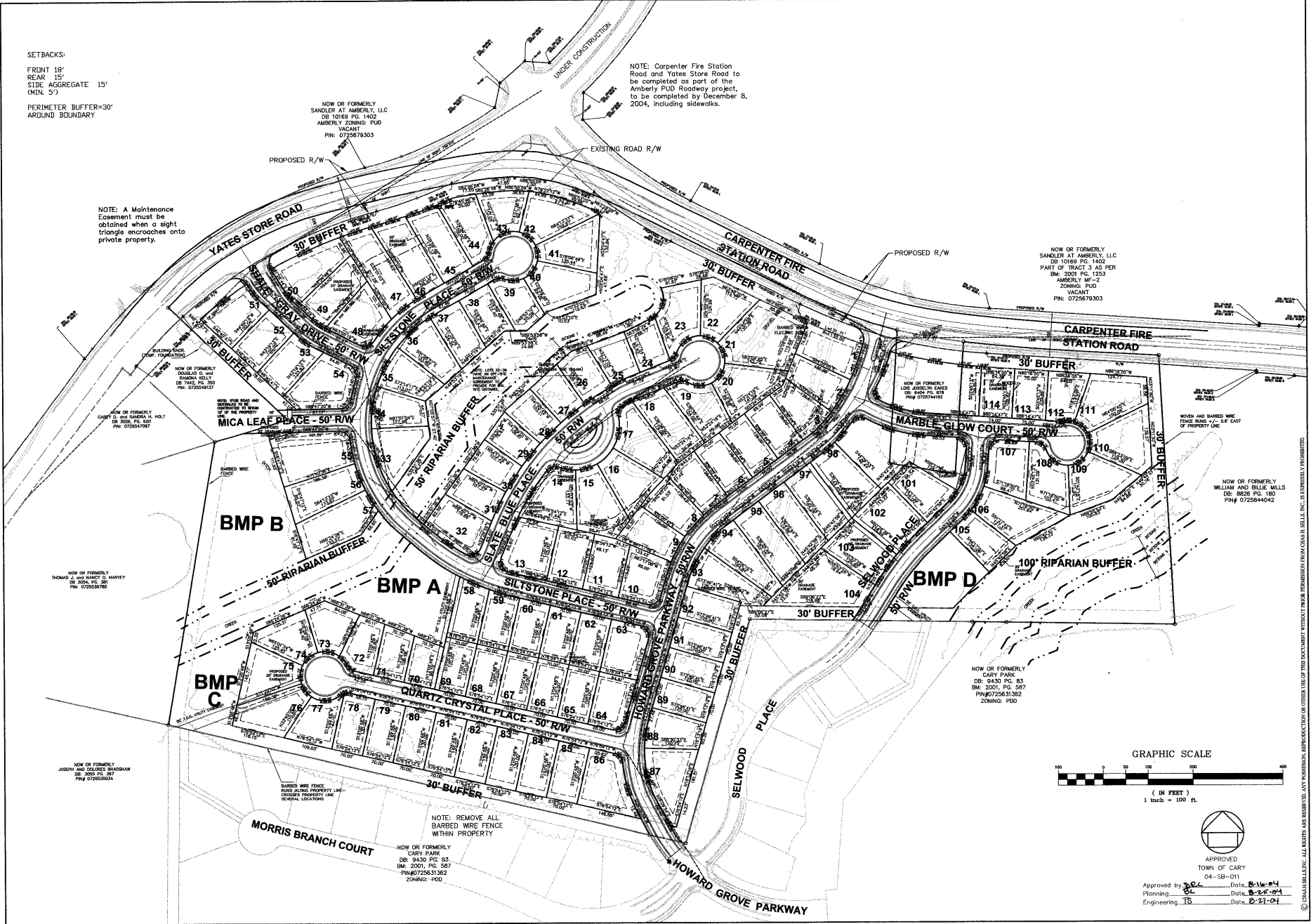

**CHAS. H. SELLS, INC.**  
 Consulting Engineers - Surveyors - Photogrammetrists

15300 Weston Parkway  
 Suite 200  
 Cary, NC 27513  
 Tel: 919-678-0035  
 Fax: 919-678-0206  
 www.chasells.com



**Blackstone at Amberly**  
 1890 Yates Store Road - Cary, NC

Public Home Corporation  
 801 Corporate Center Drive, Suite 118  
 Raleigh, NC 27607

REVISIONS	

PROJECT # 04-008 DATE 8/20/04  
 DRAWN BY: WF CHECKED BY: DS  
 TITLE  
**OVERALL LAYOUT**  
 SHEET  
**C1.0**

APPROVED  
 TOWN OF CARY  
 04-08-011  
 Approved by: J.C. Date: 8/20/04  
 Planning: DL Date: 8-20-04  
 Engineering: TB Date: 8-27-04

C:\Projects\Site Plans\04-008 Public Home\_Amberly\_PUD\Blackstone-Project-File\Map\04-008.dwg, 10, 8/17/2004 11:26:01 AM