

UTILITY KEY NOTES

- ① OMITTED
- ② 2" SERVICE TAP TO TERMINATE AT CURB STOP IN VALVE BOX (FUTURE EXTENSION WILL REQUIRE ABOVE GRADE RPZ ON PRIVATE SIDE OF METER)
- ③ 1" SERVICE TAP, 1" METER, 1" DOMESTIC WATER SERVICE TO BUILDING
- ④ 4" SERVICE TAP, 4" METER, 4" DOMESTIC WATER SERVICE TO BUILDING, RPZ LOCATED IN BUILDING
- ⑤ OMITTED
- ⑥ 6" FIRE LINE WITH 6" GATE VALVE
- ⑦ 8" FIRE LINE
- ⑧ FIRE DEPARTMENT CONNECTION (BUILDING MOUNTED)
- ⑨ FIRE DEPARTMENT CONNECTION (CURB SIDE)
- ⑩ POST INDICATOR VALVE
- ⑪ FIRE HYDRANT ASSEMBLY
- ⑫ AIR VALVE MANHOLE
- ⑬ BLOW-OFF ASSEMBLY
- ⑭ 12"x12" TAPPING SLEEVE & VALVE
- ⑮ 16"x12" TAPPING SLEEVE & VALVE
- ⑯ BORE AND JACK, PAVEMENT CUT 3'x5' FOR TAPPING PURPOSES ONLY
- ⑰ 8" GATE VALVE
- ⑱ 12" GATE VALVE
- ⑲ 8"x6" REDUCER
- ⑳ 8"x4" REDUCER
- ㉑ 4" CLEANOUT, SANITARY SEWER SERVICE
- ㉒ 6" CLEANOUT, SANITARY SEWER SERVICE
- ㉓ 8" CLEANOUT, SANITARY SEWER SERVICE
- ㉔ 6" CLEANOUT WITH TRAFFIC BEARING COVER
- ㉕ OMITTED
- ㉖ OMITTED
- ㉗ TRANSFORMER PAD

UTILITY LEGEND

- FIRE HYDRANT
- ⊕ FIRE DEPARTMENT CONNECTION
- ⊕ POST INDICATOR VALVE
- ⊕ WATER VALVE
- ⊕ WATER METER
- ⊕ BACK FLOW PREVENTER (BFP)
- ⊕ AIR VALVE MANHOLE
- ⊕ BLOW-OFF ASSEMBLY
- ⊕ REDUCER
- ⊕ CURB STOP IN VALVE BOX
- ⊕ MANHOLE
- ⊕ CLEAN OUT
- W WATER LINE
- SS SANITARY SEWER EASEMENT

NOTE: SEE UTILITY NOTES ON SHEET C3.0

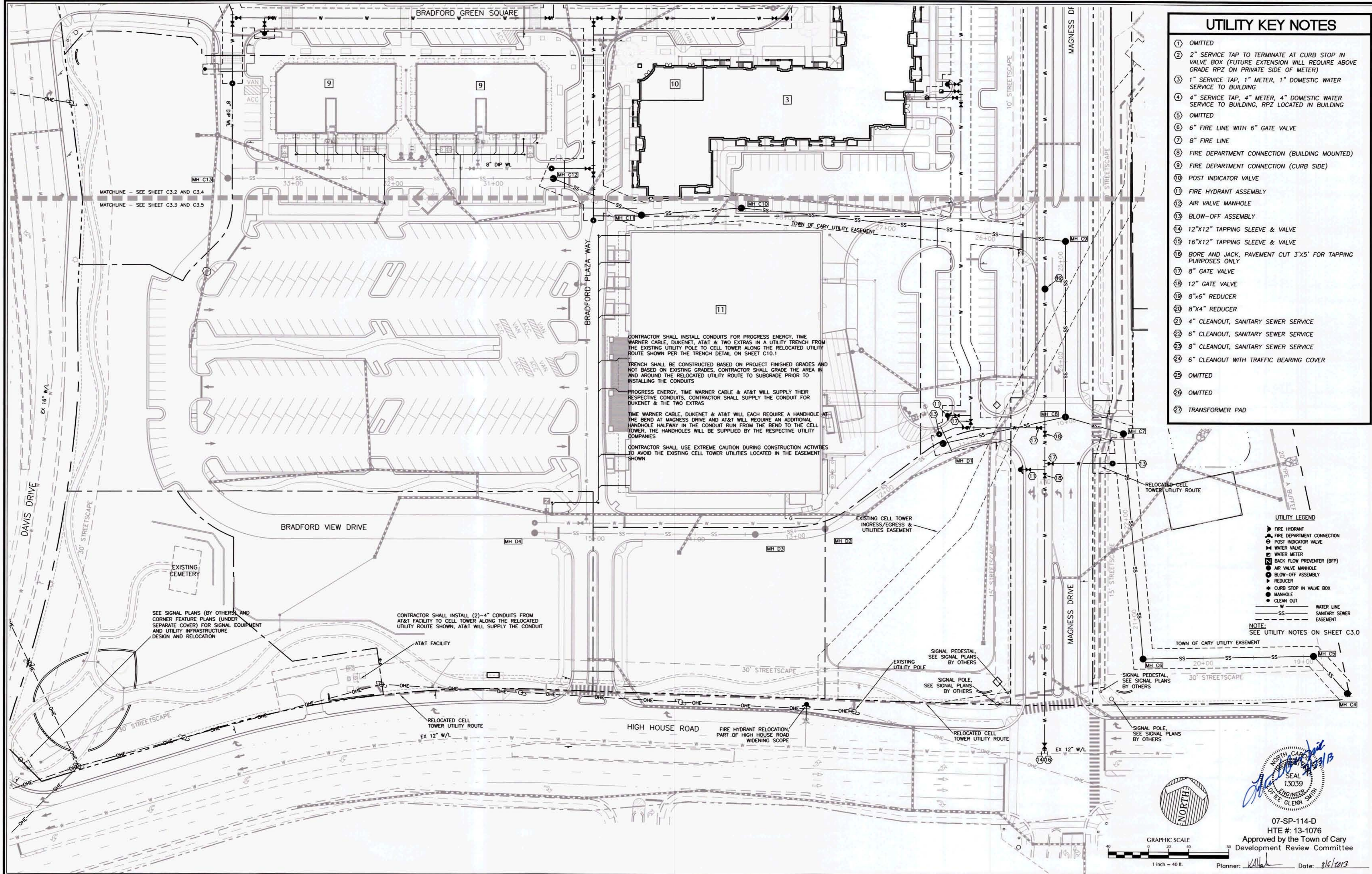

CONTRACTOR SHALL INSTALL CONDUITS FOR PROGRESS ENERGY, TIME WARNER CABLE, DUKENET, AT&T & TWO EXTRAS IN A UTILITY TRENCH FROM THE EXISTING UTILITY POLE TO CELL TOWER ALONG THE RELOCATED UTILITY ROUTE SHOWN PER THE TRENCH DETAIL ON SHEET C10.1

TRENCH SHALL BE CONSTRUCTED BASED ON PROJECT FINISHED GRADES AND NOT BASED ON EXISTING GRADES, CONTRACTOR SHALL GRADE THE AREA IN AND AROUND THE RELOCATED UTILITY ROUTE TO SUBGRADE PRIOR TO INSTALLING THE CONDUITS

PROGRESS ENERGY, TIME WARNER CABLE & AT&T WILL SUPPLY THEIR RESPECTIVE CONDUITS, CONTRACTOR SHALL SUPPLY THE CONDUIT FOR DUKENET & THE TWO EXTRAS

TIME WARNER CABLE, DUKENET & AT&T WILL EACH REQUIRE A HANDHOLE AT THE BEND AT MAGNESS DRIVE AND AT&T WILL REQUIRE AN ADDITIONAL HANDHOLE HALFWAY IN THE CONDUIT RUN FROM THE BEND TO THE CELL TOWER, THE HANDHOLES WILL BE SUPPLIED BY THE RESPECTIVE UTILITY COMPANIES

CONTRACTOR SHALL USE EXTREME CAUTION DURING CONSTRUCTION ACTIVITIES TO AVOID THE EXISTING CELL TOWER UTILITIES LOCATED IN THE EASEMENT SHOWN

CONTRACTOR SHALL INSTALL (2)-4" CONDUITS FROM AT&T FACILITY TO CELL TOWER ALONG THE RELOCATED UTILITY ROUTE SHOWN, AT&T WILL SUPPLY THE CONDUIT

SEE SIGNAL PLANS (BY OTHERS) AND CORNER FEATURE PLANS (UNDER SEPARATE COVER) FOR SIGNAL EQUIPMENT AND UTILITY INFRASTRUCTURE DESIGN AND RELOCATION

No.	Revision	Date	By
1	07-SP-114-D 1st SUBMITTAL	03/14/13	PMO
2	07-SP-114-D 2nd SUBMITTAL	05/02/13	TLM
3	PSM 1st SUBMITTAL	06/05/13	TLM
4	07-SP-114-D 3rd SUBMITTAL	06/13/13	TLM
5	TOC APPROVAL	07/22/13	TLM

BRADFORD
WAKE COUNTY
NORTH CAROLINA

CARY

Designer: PMO
Scale: AS NOTED
Date: 03/14/13
Job No.: 2061284.30

DETAILED UTILITY PLAN - PHASE 1

WITHERS & RAVENEL
ENGINEERS | PLANNERS | SURVEYORS

111 MacKenzie Drive, Cary, North Carolina 27511 | tel: 919-469-3340 | www.withersravenel.com | License No. C-0832

Seal: NORTH CAROLINA PROFESSIONAL ENGINEER SEAL 13039
GLENN SMITH

07-SP-114-D
HTE #: 13-1076
Approved by the Town of Cary
Development Review Committee

Planner: KALL Date: 8/6/2013

Sheet No. **C3.3**

K:\06\05-120\02\134-30-Bradford Phase 1\04\Construction Drawings\07.13.13 TOC (Approved)\C3.1-3.5.dwg - Monday, July 22, 2013 2:56:29 PM - MICROSOFT TUCDER