

UTILITY KEY NOTES

- ① OMITTED
- ② 2" SERVICE TAP TO TERMINATE AT CURB STOP IN VALVE BOX (FUTURE EXTENSION WILL REQUIRE ABOVE GRADE RPZ ON PRIVATE SIDE OF METER)
- ③ 1" SERVICE TAP, 1" METER, 1" DOMESTIC WATER SERVICE TO BUILDING
- ④ 4" SERVICE TAP, 4" METER, 4" DOMESTIC WATER SERVICE TO BUILDING, RPZ LOCATED IN BUILDING
- ⑤ 2" SERVICE TAP, 2" METER, 2" DOMESTIC WATER SERVICE TO BUILDING, RPZ LOCATED IN BUILDING
- ⑥ 6" FIRE LINE WITH 6" GATE VALVE
- ⑦ 8" FIRE LINE
- ⑧ FIRE DEPARTMENT CONNECTION (BUILDING MOUNTED)
- ⑨ FIRE DEPARTMENT CONNECTION (CURB SIDE)
- ⑩ POST INDICATOR VALVE
- ⑪ FIRE HYDRANT ASSEMBLY
- ⑫ AIR VALVE MANHOLE
- ⑬ BLOW-OFF ASSEMBLY
- ⑭ 12"x12" TAPPING SLEEVE & VALVE
- ⑮ 16"x12" TAPPING SLEEVE & VALVE
- ⑯ BORE AND JACK, PAVEMENT CUT 3'x5' FOR TAPPING PURPOSES ONLY
- ⑰ 8" GATE VALVE
- ⑱ 12" GATE VALVE
- ⑲ 8"x6" REDUCER
- ⑳ 8"x4" REDUCER
- ㉑ 4" CLEANOUT, SANITARY SEWER SERVICE
- ㉒ 6" CLEANOUT, SANITARY SEWER SERVICE
- ㉓ 8" CLEANOUT, SANITARY SEWER SERVICE
- ㉔ 6" CLEANOUT WITH TRAFFIC BEARING COVER
- ㉕ 2000 GALLON GREASE INTERCEPTOR
- ㉖ OMITTED
- ㉗ TRANSFORMER PAD

UTILITY LEGEND

- FIRE HYDRANT
- FIRE DEPARTMENT CONNECTION
- POST INDICATOR VALVE
- WATER VALVE
- WATER METER
- BACK FLOW PREVENTER (BFP)
- AIR VALVE MANHOLE
- BLOW-OFF ASSEMBLY
- REDUCER
- CURB STOP IN VALVE BOX
- MANHOLE
- CLEAN OUT
- W — WATER LINE
- SS — SANITARY SEWER
- - - - - EASEMENT

NOTE:
SEE UTILITY NOTES ON SHEET C3.0

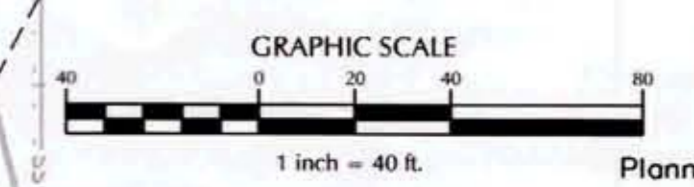
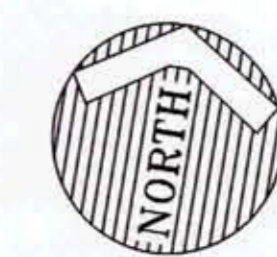

07-SP-114-D
HTE # 13-1076
Approved by the Town of Cary
Development Review Committee

Planner: [Signature] Date: 8/6/2013

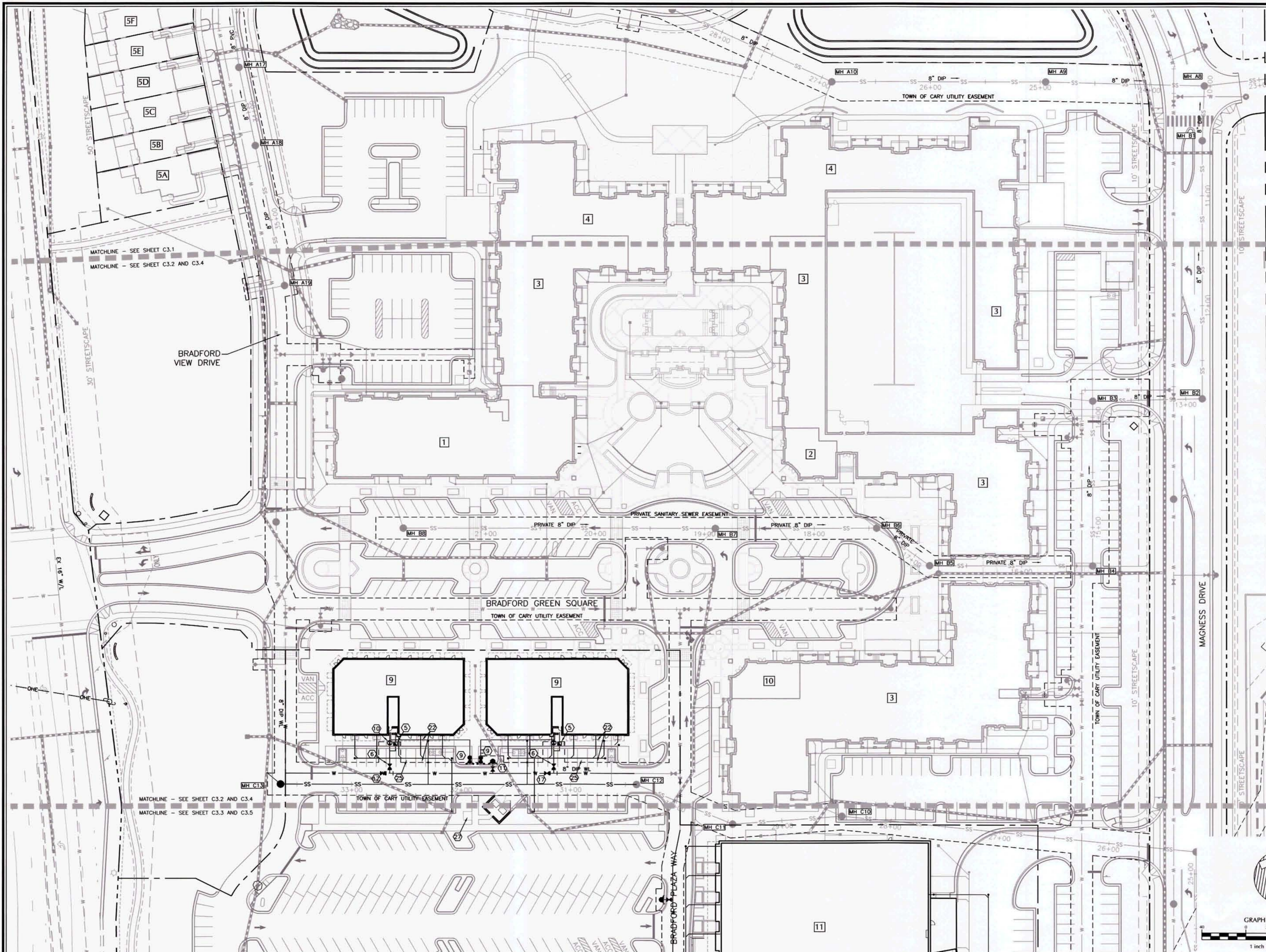

No.	Revision	Date	By
1	07-SP-114-D 1st SUBMITTAL	03/14/13	PMO
2	07-SP-114-D 2nd SUBMITTAL	05/02/13	TLM
3	PSM 1st SUBMITTAL	06/05/13	TLM
4	07-SP-114-D 3rd SUBMITTAL	06/13/13	TLM
5	TOC APPROVAL	07/22/13	TLM

Designer	PMO	Scale	AS NOTED
Drawn By	TFW	Date	03/14/13
Checked By	PMO	Job No.	2061284.30

BRADFORD

CARY WAKE COUNTY NORTH CAROLINA

DETAILED UTILITY PLAN - PHASE 2

WITHERS & RAVENEL
ENGINEERS | PLANNERS | SURVEYORS

111 MacKinnon Drive, Cary, North Carolina 27511 | tel: 919-469-3340 | www.wITHERSRAVENEL.com | License No. C-0832

Sheet No.
C3.4

K:\07-1280\081284-30-Bradford Phase 2\CAD\Construction Drawings\071213 TOC (Approved)\C3.1-13.dwg - Monday, July 22, 2013 2:57:00 PM - MCKENZIE, TUCKER