

BRAKES PLUS ADDITION

SWIFT CREEK SHOPPING CENTER 5817 HOLLY SPRINGS RD. RALEIGH, NC

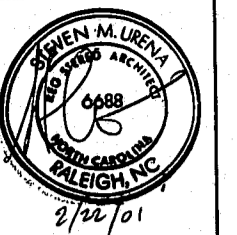

Steven M. Urena, Architect
3402 Hillborough Street
Suite 102
Raleigh, NC 27607
919/831-1868 Fax 919/831-1868

Garrett Building Corporation
P.O. Box 17605
Raleigh, NC 27619
919/782-1147

**BRAKES PLUS ADDITION
SWIFT CREEK SHOPPING CENTER
5817 HOLLY SPRINGS RD.
RALEIGH, NC**

REVISIONS

BUILDING CODE SUMMARY
02-22-01

T1
0104-T1DC5

ENERGY REQUIREMENTS:

THE FOLLOWING DATA SHALL BE CONSIDERED MINIMUM AND ANY SPECIAL ATTRIBUTE REQUIRED TO MEET THE ENERGY CODE SHALL ALSO BE PROVIDED. EACH DESIGNER SHALL FURNISH THE REQUIRED PORTIONS OF THE PROJECT INFORMATION FOR THE PLAN DATA SHEET AND SHALL SIGN THE DESIGNER'S STATEMENT FOR THE APPROPRIATE PORTION AS REQUIRED BY G.S. 143-151.33. IF ENERGY COST BUDGET METHOD, STATE THE ANNUAL ENERGY COST BUDGET VS ALLOWABLE ANNUAL ENERGY COST BUDGET.

THERMAL ENVELOPE

METHOD OF COMPLIANCE:
 PRESCRIPTIVE PERFORMANCE ENERGY COST BUDGET

ROOF/CEILING ASSEMBLY (EACH ASSEMBLY) METAL ROOF PANELS W/ VINYL FACED BATT INSUL.
 DESCRIPTION OF ASSEMBLY W/ LAY-IN CEILING & 6" BATT INSULATION
 U-VALUE OF TOTAL ASSEMBLY 0.035
 R-VALUE OF INSULATION R-4 & R-10
 SKYLIGHTS IN EACH ASSEMBLY N/A
 U-VALUE OF SKYLIGHT N/A
 TOTAL SQUARE FOOTAGE OF SKYLIGHTS IN EACH ASSEMBLY N/A

EXTERIOR WALLS (EACH ASSEMBLY) 4" BRICK VENEER W/ AIR SPACE, SHEATHING BD &
 DESCRIPTION OF ASSEMBLY 6" METAL STUDS W/ 6" BATT INSULATION
 U-VALUE OF TOTAL ASSEMBLY 0.029
 R-VALUE OF INSULATION R-13
 OPENINGS (WINDOWS OR DOORS WITH GLAZING)
 U-VALUE OF ASSEMBLY 0.38
 SHADING COEFFICIENT 0.54
 PROTECTION FACTOR N/A
 LOW E REQUIRED, IF APPLICABLE N/A
 DOOR R-VALUES N/A

WALLS ADJACENT TO UNCONDITIONED SPACE (EACH ASSEMBLY)
 DESCRIPTION OF ASSEMBLY N/A
 U-VALUE OF TOTAL ASSEMBLY N/A
 R-VALUE OF INSULATION N/A
 OPENINGS (WINDOWS OR DOORS WITH GLAZING)
 U-VALUE OF ASSEMBLY N/A
 SHADING COEFFICIENT N/A
 PROTECTION FACTOR N/A
 LOW E REQUIRED, IF APPLICABLE N/A
 DOOR R-VALUES N/A

WALLS BELOW GRADE (EACH ASSEMBLY) N/A
 DESCRIPTION OF ASSEMBLY N/A
 U-VALUE OF TOTAL ASSEMBLY N/A
 R-VALUE OF INSULATION N/A

FLOOR OVER UNCONDITIONED SPACE (EACH ASSEMBLY) N/A
 DESCRIPTION OF ASSEMBLY N/A
 U-VALUE OF TOTAL ASSEMBLY N/A
 R-VALUE OF INSULATION N/A

FLOORS SLAB ON GRADE
 DESCRIPTION OF ASSEMBLY 4" CONC. SLAB W/ VAPOR BARRIER ON 4" STONE
 U-VALUE OF TOTAL ASSEMBLY 0.38
 R-VALUE OF INSULATION 12
 HORIZONTAL / VERTICAL REQUIREMENT 12/7
 SLAB HEATED N/A

DESIGNER STATEMENT:
 TO THE BEST OF MY KNOWLEDGE AND BELIEF, THE DESIGN OF THIS BUILDING COMPLIES WITH THE THERMAL ENVELOPE REQUIREMENTS OF THE NORTH CAROLINA STATE BUILDING CODE, VOLUME R-Energy.

SIGNED:
 NAME: STEVEN URENA
 TITLE: ARCHITECT

ELECTRICAL SYSTEM AND EQUIPMENT
 METHOD OF COMPLIANCE: SEE ELECTRICAL DRAWINGS

MECHANICAL SYSTEMS, SERVICE SYSTEMS AND EQUIPMENT
 METHOD OF COMPLIANCE: SEE MECHANICAL DRAWINGS

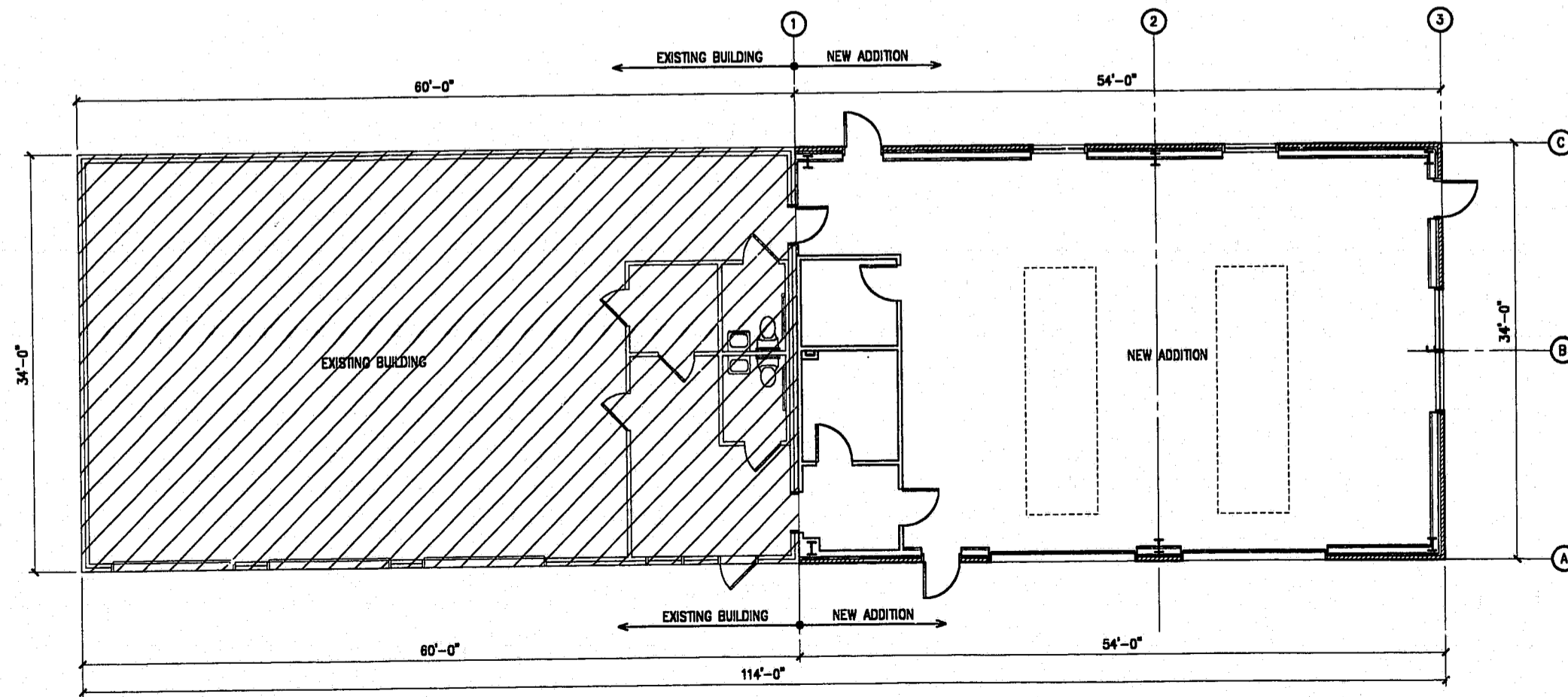

KEY PLAN
 SCALE: 1/8" = 1'-0"

BUILDING CODE SUMMARY COMMERCIAL FIT-UPS AND ALTERATION PROJECTS

NAME OF PROJECT: BRAKES PLUS ADDITION SUITE NUMBER: _____
 BUILDING NAME: BRAKES PLUS
 BUILDING ADDRESS: 5817 HOLLY SPRINGS RD., RALEIGH, NC
 OWNER: JOHN M. KANE PHONE: (919) 233-0015 FAX: (919) _____
 CONTACT PERSON: ROGER REAMS PHONE: (919) 782-1147 FAX: (919) 872-7782

DESIGNER OF RECORD:

NAME	LICENSE #	TELEPHONE #
ARCHITECTURAL: STEVEN M. URENA	4688	(919) (831-1868)
ELECTRICAL: ANDREW CLARK	SEAL	(919) (862-4443)
PLUMBING: N/A		() ()
MECHANICAL: DENNIS D. WELD	20714	(919) (881-8020)
STRUCTURAL: AAS BLDG. SYS.-WALTER R. MERRISON	20480	(282) (877-2131)
SPRINKLER-STANDPIPE: _____		() ()
FIRE ALARM: JOHN D. JOSHIN	1298	(919) (787-7407)
SLAB PLAN: RANDY MILLER	10793	(919) (891-1299)
SITE: _____		() ()

Description of proposed work:
 ADD NEW 54' X 34' BAY AREA TO EXISTING 60' X 34'
 BRAKES PLUS BUILDING.

BUILDING DATA

BUILDING OCCUPANCY: ASSEMBLY BUSINESS EDUCATIONAL MERCANTILE
 HAZARDOUS FACTORY-INDUSTRIAL INSTITUTIONAL (UNRESTRAINED)
 INSTITUTIONAL (RESTRAINED) USE CONDITION
 RESIDENTIAL STORAGE

CHANGING OCCUPANCY: ASSEMBLY BUSINESS EDUCATIONAL MERCANTILE
 HAZARDOUS FACTORY-INDUSTRIAL INSTITUTIONAL (UNRESTRAINED)
 INSTITUTIONAL (RESTRAINED) USE CONDITION
 RESIDENTIAL STORAGE

MIXED OCCUPANCY? YES NO SEPARATION: _____ HR.
 CONSTRUCTION TYPE: I () II () III () IV () V (UP) () VI (P) () VII (UP) ()
 MIXED CONSTRUCTION YES NO TYPE _____
 SPRINKLERED: YES NO (13 SR 130) _____
 PRIMARY FIRE DISTRICT? YES NO
 BUILDING HEIGHT: 38 FEET NUMBER OF STORES _____
 MEZZANINE: YES NO
 HIGH RISE BUILDING: YES NO

GROSS SQUARE FOOTAGE OF FIT-UP OR ALTERATION:

FLOOR	SQ. FT.	4TH FLOOR	SQ. FT.
EXISTING	2,040	5TH FLOOR	
NEW 1ST FLR	1,838	6TH FLOOR	
		7TH FLOOR	
TOTAL GROSS AREA:	3,878		SQ. FT.

FIRE RESISTANCE RATINGS

INTERIOR WALLS:	REQUIRED HOURS	DETAIL #	DESIGN NO.	DESIGN NO.
			FOR RATED PENETRATIONS	FOR RATED ASSEMBLIES
BEARING	N/A			
NON-BEARING	N/A			
TENANT SEPARATION	N/A			
CEILING-FLOORS ASSEMBLY:	N/A			
BEAMS:	N/A			
COLUMNS:	N/A			
CEILING-ROOF ASSEMBLY:	N/A			
VERTICAL SHAFTS:	N/A			
CHASES- P. E. M.:	N/A			
MIXED OCCUPANCY SEPARATION:	N/A			
TENANT SEPARATION:	N/A			

EXCEPTIONS TO FIRE RATINGS (CHECK CODE SECTION AND STATE REASON FOR EXCEPTIONS):

FOOTNOTES:
 1. ALL FIRE RATED WALLS SHALL BE DETAIL ON PLANS BY NATIONAL, BURNS, ETC. SHOW LISTED ON PLANS.
 2. CERTIFY CODE SECTION WHEN USING ANY SPECIAL EXCEPTIONS, ETC.
 3. EXISTING BUILDING SHALL BE AS SHOWN ON PLANS.
 4. DETAILS OR REPRODUCTIONS OF RATED ASSEMBLIES/PENETRATIONS SHALL BE INCORPORATED ON THE DRAWINGS.

LIFE SAFETY SYSTEM:
 EMERGENCY LIGHTING AND EXIT SIGNS YES NO
 FIRE ALARM AND SMOKE DETECTION SYSTEMS YES NO
 PANIC HARDWARE YES NO

EXIT REQUIREMENTS:
 DEAD END LIMIT-MAXIMUM CONDITION 20 FEET
 TRAVEL DISTANCE TO EXIT-MAXIMUM CONDITION 200 FEET
 NUMBER EXITS: _____
 TOTAL SQUARE FOOTAGE OF FLOOR 3,878 DIVIDED BY NET / SQ. FT. PER OCCUPANCY JOB = 38 TOTAL NUMBER OF PEOPLE ON FLOOR
 NUMBER OF DOORS PROVIDED 1 NUMBER OF DOORS REQUIRED 2

HAZARDOUS MATERIALS STORAGE:
 IF APPROPRIATE FOR THE PROPOSED OCCUPANCY, IDENTIFY COMPLETE DATA ON TYPES AND AMOUNTS OF MATERIALS TO BE STORED, PROCESSED, MANUFACTURED OR USED IN THE MANUFACTURING OF PRODUCTS IN THIS FACILITY. STATE IF SUCH MATERIALS ARE CORROSIVE, POISONOUS, UNDER PRESSURE IN A LIQUID OR GASEOUS STATE, INFLAMMABLE OR OTHER RELEVANT PROPERTIES. (REF. NCSCS SEC. 402 AND NFPA 30.)

PARKING SPACES: _____ REQUIRED _____ PROVIDED (EXISTING SEE SITE PLAN)
 HANDICAP SPACES: _____ PROVIDED (1/8" WIDE AND R7-8 SIGN)

SPECIAL APPROVAL BY DEPARTMENT OF INSURANCE OF BY LOCAL JURISDICTION DESCRIBED BELOW: _____

01-SP-004
APPROVED
 4/18/01
 TM 4-18-01