

- NOTES:
1. ALL CONSTRUCTION SHALL BE IN ACCORDANCE WITH THE TOWN OF CARY STANDARDS AND SPECIFICATIONS.
  2. EXISTING WETLANDS LOCATION TAKEN FROM SURVEY BY C.G. BAGLEY, PA.

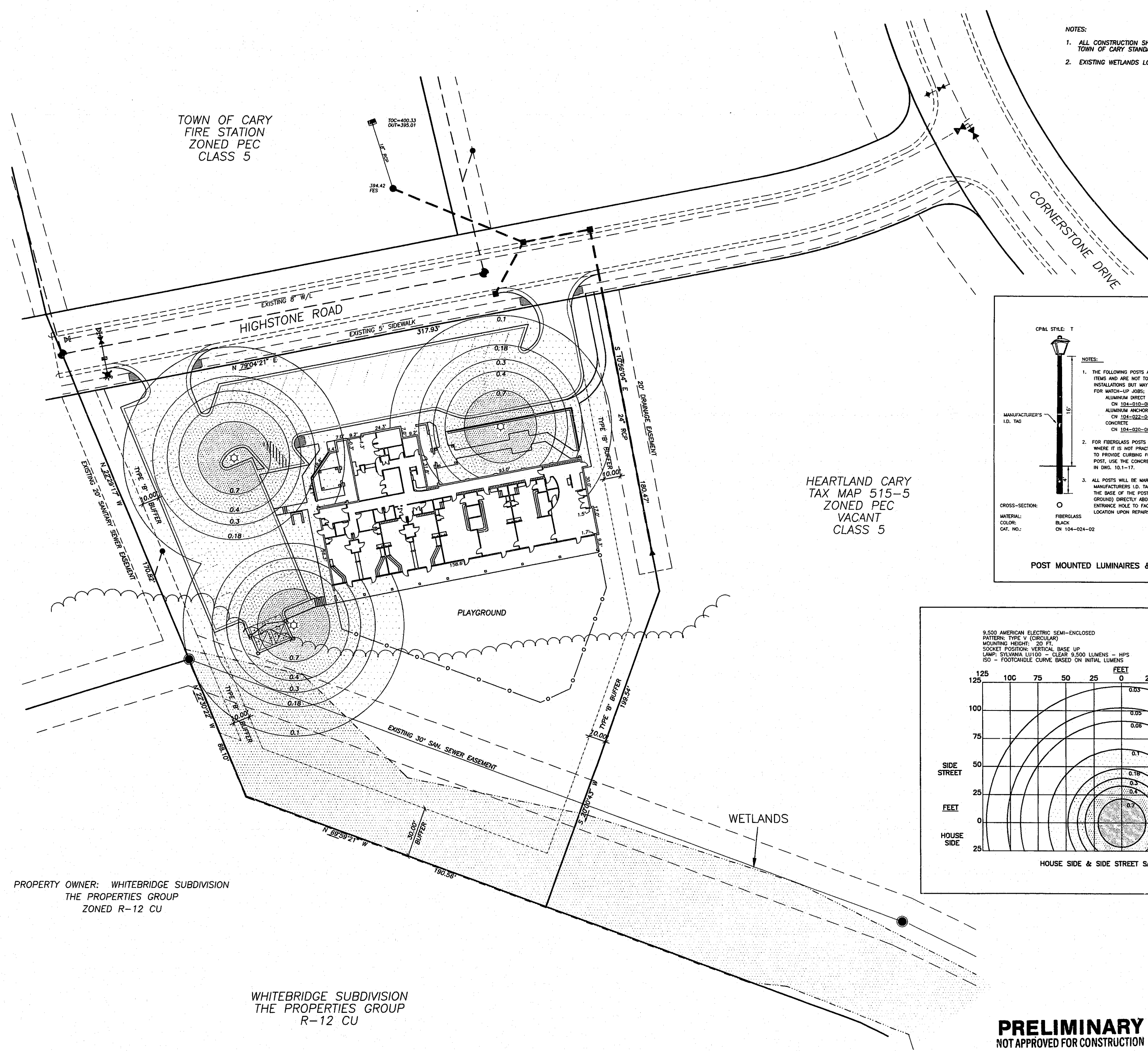

HEARTLAND CARY  
TAX MAP 515-5  
ZONED RMF-12 CU  
UNDER CONSTRUCTION

HEARTLAND CARY  
TAX MAP 515-5  
ZONED PEC  
VACANT  
CLASS 5

PROPERTY OWNER: WHITEBRIDGE SUBDIVISION  
THE PROPERTIES GROUP  
ZONED R-12 CU

WHITEBRIDGE SUBDIVISION  
THE PROPERTIES GROUP  
R-12 CU

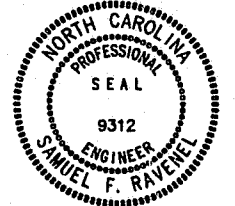
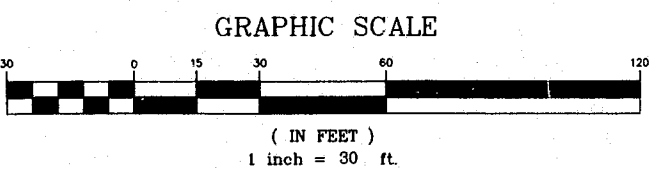
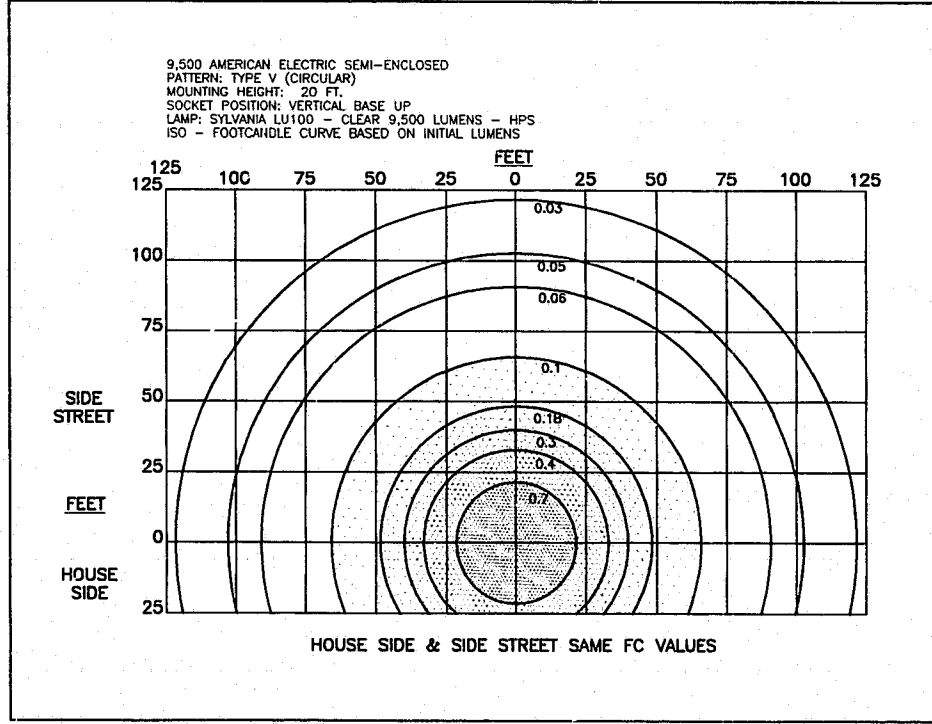
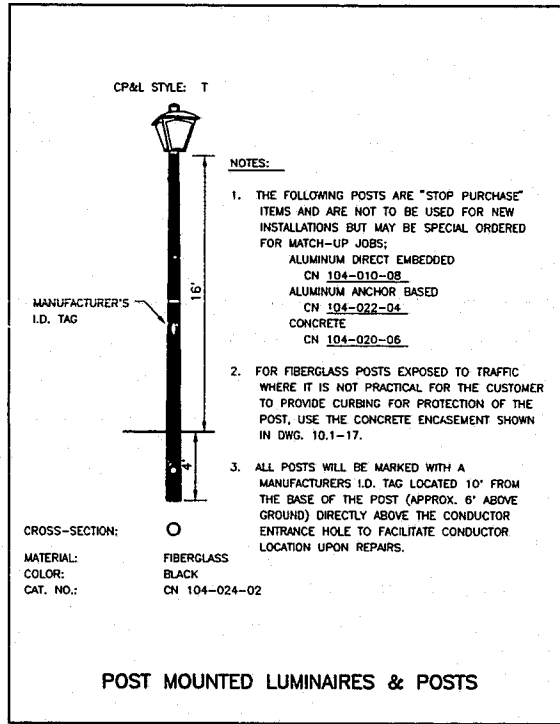

**PRELIMINARY**  
NOT APPROVED FOR CONSTRUCTION

**Withers & Ravenel**  
Engineering and Surveying, Inc.  
1149 Executive Circle, Cary NC 27511 Phone: 919-469-3340 Fax: 919-467-6008

Revisions			
No.	Description	Date	By
1	REVISIONS PER T.O.C. 1st REVIEW	1/25/95	AIR

**BRIGHT HORIZONS CHILDREN'S CENTER**

**SITE LIGHTING PLAN**

Designer SFR	Scale 1"=30'
Drawn By BDH/ATB	Date 12/29/94
Checked By SFR	Job No. 94136

CAD File  
94136.DWG  
Sheet No.  
**6** of 8