

PLANT LIST FOR BUCK JONES ROAD SHOPPING CENTER

QUAN	KEY	BOTANICAL NAME	COMMON NAME	SIZE/ROOT/REMARKS
	QP	Quercus phellos	Willow Oak	12" (Hfr. 1-1/2" cal.)
	PCB	Pyrus calleryana	Bradford Pear	10-12'
	LI	Lagerstroemia indica	Crape Myrtle (Pink)	8-10'
	SB	Salix babylonica	Weeping Willow	20 gal.
	PT	Pinus taeda	Loblolly Pine	3-4'
	MC	Myrica cerifera	Hax Myrtle	3 gal.
	JPN	Juniperus pfitzeriana 'compacta'	Nick's Compact Juniper	2 gal.
	JC	Juniperus conferta	Shore Juniper	1 gal.
	LS	Liriope spicata	Japanese Lily-turf	6-bib min.

PLANTING NOTES

KEY LETTERS REFER TO PLANT LIST. WHERE KEY LETTERS ARE CONNECTED TO A SINGLE PLANT, THE QUANTITY IS ONE.

GROUP PLANTINGS HAVE KEY LETTERS FOLLOWED BY THE QUANTITY OF THAT PLANT IN THAT PARTICULAR AREA OR GROUP.

QUANTITIES SHOWN FOR GROUND COVER PLANTING OR MASS PLANTING ARE FOR REFERENCE ONLY. EXACT QUANTITY TAKE-OFF IS THE RESPONSIBILITY OF THIS CONTRACTOR.

LOCATIONS FOR PROPOSED PLANT BEDS AND TREES CAN BE ESTABLISHED BY USING SCALED DIMENSIONS TAKEN FROM PLANTING PLAN. USE MALLS, GRIVES, BUILDINGS, ETC. AS REFERENCES.

ALL PLANTS SHALL BE COMPACT, UNIFORM, AND WELL GROWN. PLANTS SHALL NOT BE LOOSE, OPEN PLANTS.

ALL AREAS DISTURBED BY GRADING OPERATIONS AND UTILITY LINE PLACEMENT SHALL BE GRASSED.

ALL PLANTING BEDS SHALL RECEIVE A MINIMUM OF 4" APPROVED MULCH.

EXISTING AND PROPOSED TREES SHALL BE PRUNED AS INSTRUCTED BY LANDSCAPE ARCHITECT, AND AS DETAILED.

SYMBOLS: B-B-BALLED AND BURLAPPED; B-R--BARE ROOT; D/C--ON CENTER; SPR--SPREAD; CAL--CALIPER; CONT--CONTAINER GROWN; GAL--GALLON CONTAINER; S-BM--STACKED AND WRAPPED; S-LM--COVERED AND WRAPPED; G-GUTTER.

ALL PLANTS SHALL MEET OR EXCEED THE MINIMUM STANDARDS SET FORTH IN THE AMERICAN STANDARD FOR NURSERY STOCK BY THE AMERICAN ASSOCIATION OF NURSERYMEN, INC., WASHINGTON, D.C.

SOIL AND FERTILIZER REQUIREMENTS

AREA	PLANTING SOIL MIXTURE			FERTILIZER	LIME
	TOPSOIL	MOSS	MATURE		
Lawns				8-8-8 @ 30 lbs. per 1000 sq. ft.	40 lbs. per 1000 sq. ft.
Plant Pits Tree Pits	(5) parts	(1) part	(1) part	8-8-8 @ 1.5 lbs. per cu. yd.	40 lbs. per 1000 sq. ft.

GRASSING TYPES AREA SEEDING REQUIREMENTS

COMMON NAME	PROPORTION (WT. %)	MINIMUM PURITY (%)	MINIMUM SEED (%)	RATE OF SEEDING	RECOMMENDED SEASON
Kentucky 31 Fescue	70%	30%	80%	8 lbs. per 1000 sq. ft.	Sept. 1-Oct. 20 or April 15-July 3
Pennann Fescue	30%	80%	80%	2 lbs. per 1000 sq. ft.	Sept. 1-Oct. 20 or April 15-July 3
Alta Fescue (for overseeding)	100%	98%	80%	2 lbs. overseeding/seedling	Sept. 1-Oct. 20 or April 15-July 3

QUALITATIVE ANALYSIS OF TOPSOIL

ORGANIC CONTENT	CLAY CONTENT	pH VALUE
2% min.	60% max.	6-6.5

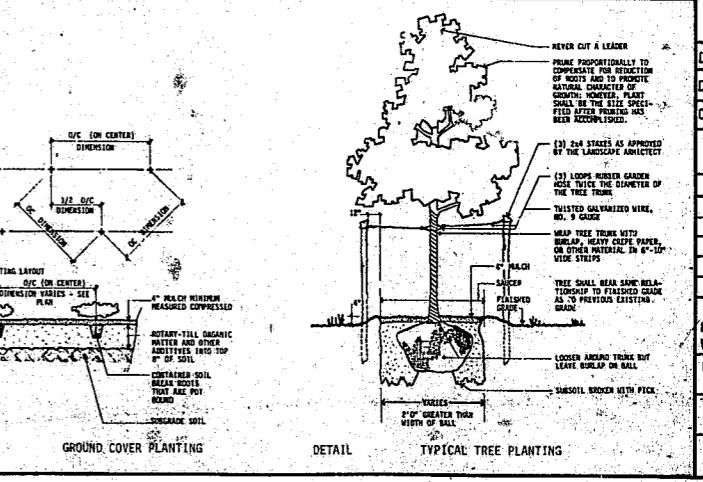
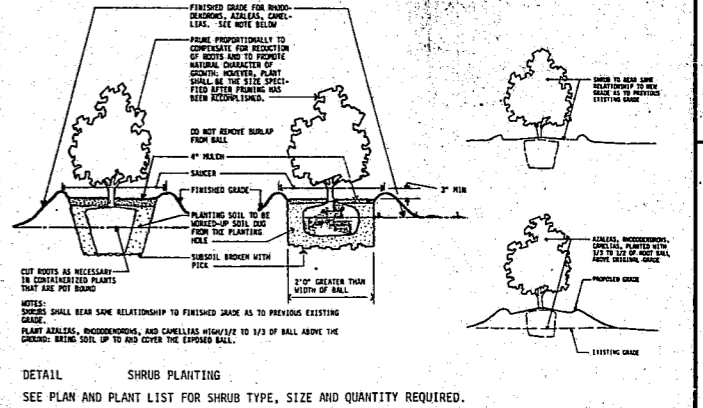

SITE DEVELOPMENT PLAN SHOWING PLANTING  
1"=50'-0"

PEIRSON & WHITMAN  
 INCORPORATED  
 CONSULTING ENGINEERS  
 -RALEIGH, N. C.

G. L. WILSON BUILDING COMPANY  
 STATESVILLE, N. C.

DESCRIPTION:  
 BUCK JONES ROAD SHOPPING CENTER  
 SITE DEVELOPMENT PLAN SHOWING  
 PLANTING

DATE: OCT. 1983  
 DRAWN BY: SDG  
 CHECKED BY:

REVISIONS	
NO.	DATE

SCALES  
 HORIZ.: AS SHOWN  
 VERT.: AS SHOWN  
 PROJ. NO. DIV. 0566 AC1  
 SHEET NO. 3 OF 4  
 DRAWING NO.