

LANDSCAPE SCHEDULE							
MARK	COMMON NAME BOTANICAL NAME	HEIGHT	SPREAD	CALIPER	ROOT	QUANTITY	RE-MARKS
⊗	LOBLOLLY PINE PINUS MAEDA	10'-12'	4'-5'	2 1/2"	B 4 D	3	
⊙	BRADFORD PEAR PYRUS BRADFORD	4'-6'	3'-4'	1 1/2"	B 4 B	24	
⊙	PHOTINIA PHOTINIA FRASERI	4'-4'			B 4 B	34	
•	YAUPOON HOLLY ILEX VOMITORIA	4'-4'			B 4 B	95	
⊙	ADAMS NEEDLE YUCCA YUCCA FILAMENTOSA	4'-4'			3 GAL	27	3/4" PLANT MIN
⊙	LILYTURF LIRIOPE VARIEGATA	4'-6"			1 GAL	100	PLANT 12" OC
•	CREeping JUNIPER JUNIPERUS PLUMOSA	12'-18"			B 4 B	110	
⊙	PAMPAS GRASS CORTADERIA SELLOANA	4'-4'			3 GAL	24	3/4" PLANT MIN
⊙	PLANTING BED						2" FINE BARK
⊙	GRASS						PER SPEC

SEEDING SPECS

All seed shall be certified by a state or federal seed certifying agency. All seed shall be tested within the 12 (12) months immediately preceding the planting of such material on this job. At least one bag for each kind of seed used shall be submitted with this proposal.

Grass seed shall be guaranteed by the dealer to be as follows:

Seed	Minimum	Maximum	Moisture
Common Bermudagrass (unhulled)	95%	98%	15
Tall Fescue (hulled)	97%	98%	15
Red Fescue (hulled)	97%	98%	15

Grass shall be planted as follows:

Seed	Rate	Planting Date
Common Bermudagrass	15-20 lbs/acre	January - March
Tall Fescue	8-12 lbs/acre	April - July
Red Fescue	40-60 lbs/acre	September - March
Tall Fescue (hulled)	25 lbs/acre	December - March

Soil pH shall be tested and adjusted to 6.0-6.5.

FERTILIZER:

All fertilizer shall be uniform in composition, free flowing and suitable for application with approved equipment. Fertilizer shall be delivered to the site fully labeled according to applicable state or federal regulations. Fertilizer shall be applied according to the label directions. Fertilizer application shall be as determined by approved soil tests. If soil tests are waived when there is insufficient time for complete tests, fertilizer shall be of a 1-2-2 ratio such as 5-10-10 and shall be applied at a rate of 500-1000 pounds per acre.

Soil shall be tested to a depth of 4 inches and work lime and fertilizer tests so as to bring the pH to 6.0-6.5. Apply seed according to specifications. Apply small grain straw mulch at a rate of 1/2 to 2 tons per acre.

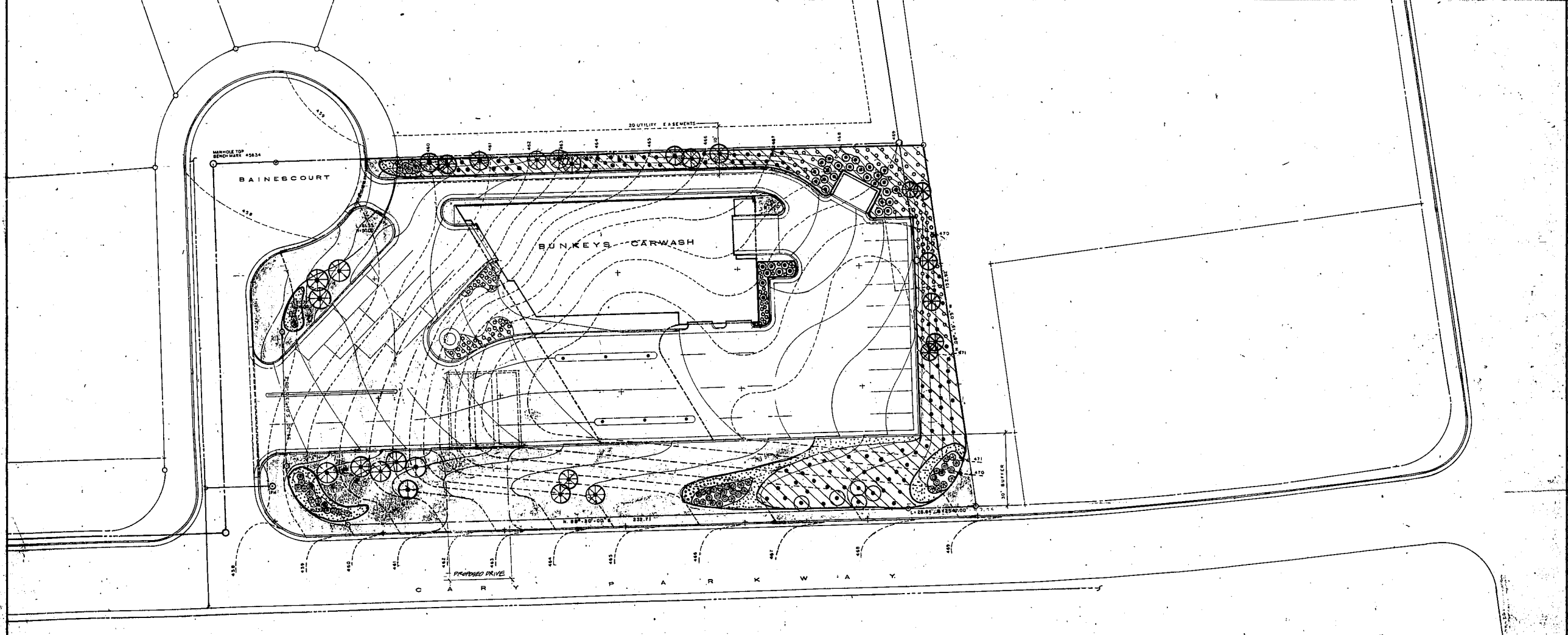
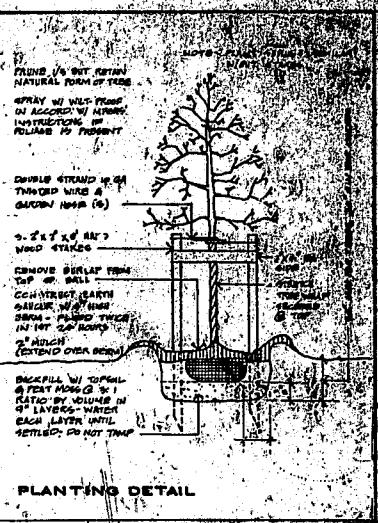

LAWRENCE S. LAWRENCE & ASSOCIATES
ARCHITECTS
1111 W. 10TH ST.
RALEIGH, N.C. 27603
919/881-1870

J. M. THOMPSON CO.
7101 WILKINSON RD.
RALEIGH, N.C.
919/881-1870

BUNKEY'S CARWASH
CARY, NORTH CAROLINA

