

CONSTRUCTION DRAWINGS FOR WALDO STREET TOWNES CARY, N.C. TOC PROJECT # 01-SP-037

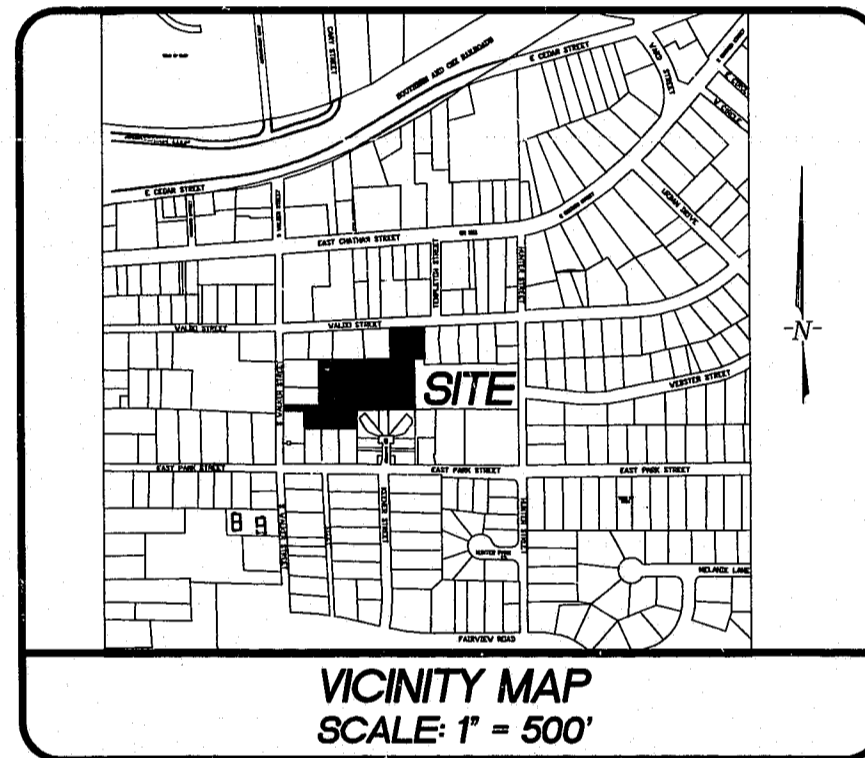

INDEX OF SHEETS

SITE PLAN	SHT 1
GRADING & STORM DRAINAGE PLAN	SHT 2
EROSION CONTROL PLAN	SHT 3
UTILITY PLAN	SHT 4
SANITARY SEWER PROFILES	SHT 5
LANDSCAPE PLAN	SHT 6
LIGHTING PLAN	SHT 7
EROSION CONTROL AND STORM DRAINAGE DETAILS	SHT 8
UTILITY DETAILS	SHT 9
SITE & ROADWAY DETAILS	SHT 10
FRONT ELEVATIONS	SHT A1
UNIT #A FLOOR PLANS & ELEVATIONS	SHT A3
UNIT #A OPTIONAL FRONTS	SHT A4
UNIT #C FLOOR PLANS & ELEVATIONS	SHT A6
UNIT #C OPTIONAL FRONTS	SHT A7

LEGEND

DESCRIPTION	EXISTING	PROPOSED
1' CONTOUR INTERVAL	-----	-----
5' CONTOUR INTERVAL	-----	-----
PROPERTY LINE	-----	-----
ROADWAY CENTERLINE	-----	-----
RIGHT OF WAY LIMITS	-----	-----
EASEMENT LINE	-----	-----
CURB & GUTTER	-----	-----
SANITARY SEWER FACILITIES	-----	-----
STORM SEWER FACILITIES	-----	-----
WATERLINE	-----	-----
FIRE HYDRANT ASSEMBLY	⊕	⊕
FENCING STRUCTURE	-----	-----
WOODSLINE	~~~~~	N/A
WATERWAYS	-----	N/A
SILT FENCING	N/A	* * * * *



PREPARED BY:

WITHERS & RAVENEL
ENGINEERING & SURVEYING, INC.

111 MACKENAN DRIVE
CARY, NORTH CAROLINA 27511
TELEPHONE: OFFICE (919) 469-3340
FAX No. (919) 467-6008

01-SP-037 01-MSU-007

APPROVED

BY: TC DATE: 6/14/01

BY: RS DATE: 7/10/01

TOWN OF CARY
DEVELOPMENT REVIEW GROUP

TOWN OF CARY
ENGINEERING DEPT.
REVIEWED BY: JFH For Streetlights
DATE: 8/3/01

OWNER / DEVELOPER

JEFF FIKE BUILDERS

2520 RELIANCE AVENUE, SUITE A
APEX, NORTH CAROLINA 27502
TELEPHONE: OFFICE (919) 363-4868
ATTN: JEFF FIKE